

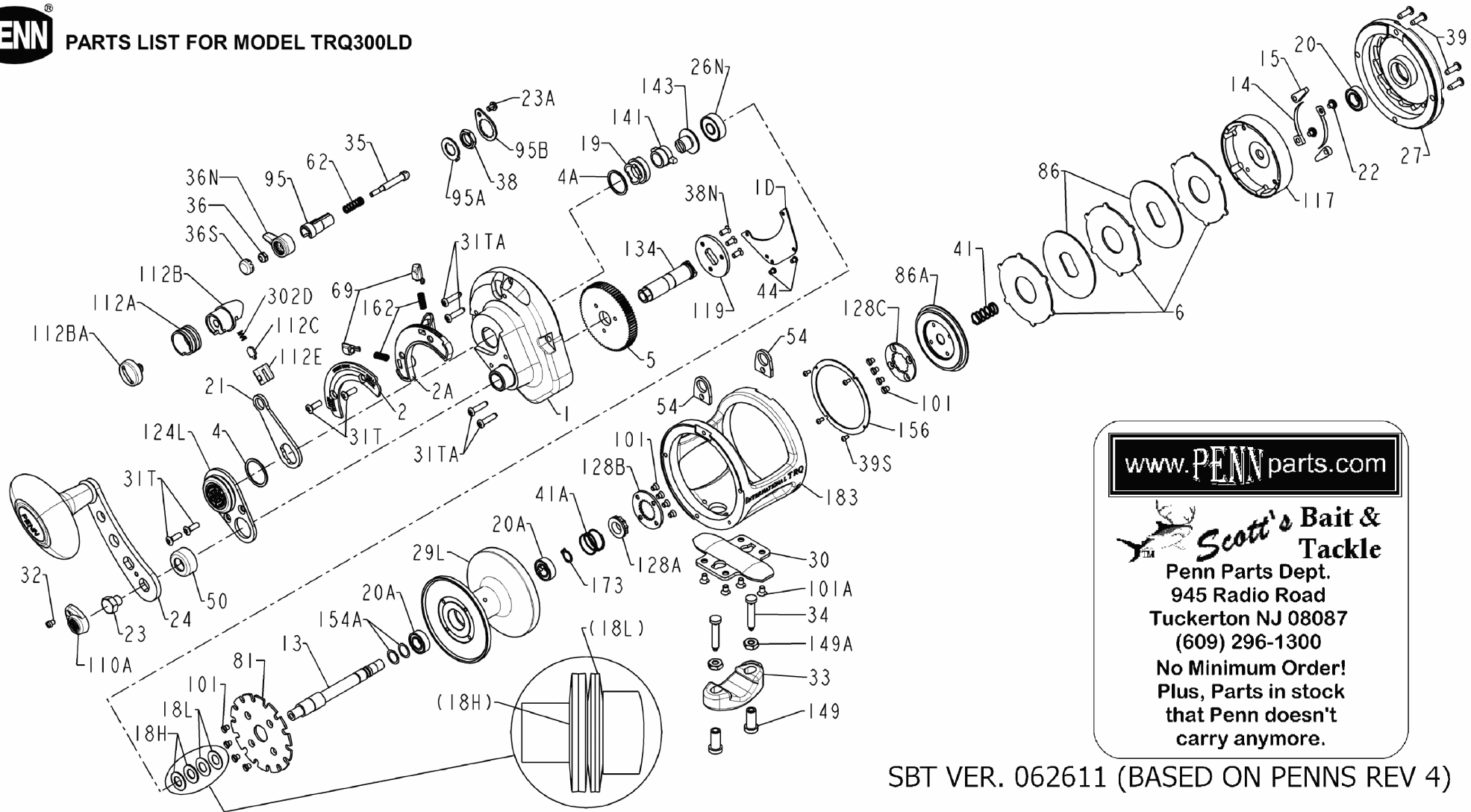

# PARTS LIST FOR MODEL TRQ300LD



[www.PENNparts.com](http://www.PENNparts.com)

**Scott's Bait & Tackle**  
 Penn Parts Dept.  
 945 Radio Road  
 Tuckerton NJ 08087  
 (609) 296-1300  
 No Minimum Order!  
 Plus, Parts in stock  
 that Penn doesn't  
 carry anymore.

SBT VER. 062611 (BASED ON PENNS REV 4)

## Penn Reel Parts list for:

## Model: TRQ300LD International Torque Leverdrag

KEY NO	PART NO.	DESCRIPTION	KEY NO	PART NO.	DESCRIPTION
1	1-300LD	RIGHT SIDE PLATE	44	44-300T	SCREW (2 REQUIRED)
1D	1D-300T	BACKING PLATE	50	50-25	GEAR STUD SHIELD
2	2-300LD	DRAG LEVER QUADRANT	54	54-16S	HARNESS LUG (2 REQUIRED)
2A	2A-300LD	DRAG LEVER RATCHET	**	54A016VS	HARNESS LUG PLUT (2 REQUIRED)
4	4-12LT	DRAG LEVER THRUST WASHER	62	62-300LD	CLICK SPRING
4A	4-300LD	CAM THRUST WASHER	69	69-12VS	LOCATING PIN (2 REQUIRED)
5	5-300LD	MAIN GEAR	81	81-16VS	CLICK RACHET PLATE
6	6-300LD	DRAG WASHER (3 REQUIRED)	86	86-300LD	METAL DRAG WASHER (2 REQUIRED)
13	13-300LD	PINION	86A	86A-300LD	DRAG BUSHING ASSEMBLY
14	14-300LD	DOG SPRING (2 REQUIRED)	95	95-300LD	CLICK BUSHING
15	15-50	DOG, ANTI-REVERSE (2 REQUIRED)	95A	95A-50	CLICK BUSHING WASHER
18H	18H-300LD	CLUTCH SPRING HEAVY (2 REQUIRED)	95B	95B-70	CLICK LOCKING PLATE
18L	18L-300LD	CLUTCH SPRING LIGHT (2 REQUIRED)	101	101-50S	MOUNTING SCREW (12 REQUIRED)
19	19-300LD	CAM	101A	101-80ST	STAND SCREW (4 REQUIRED)
20	20-6500	LEFT SIDE BALL BEARING	110A	110A-555	HANDLE NUT CAP
20A	20-722	SPOOL BALL BEARING (2 REQUIRED)	112A	112A-30VS	LEVER KNOB SLEEVE
21	21-300LD	DRAG LEVER	112B	112B-30VS	LEVER KNOB
22	22-109	SCREW, DOG SPRING (2 REQUIRED)	112BA	112B-70	LEVER KNOB SCREW
23	23-300LD	HANDLE SCREW	112C	112C-30VS	CLICK PLATE
23A	23-750	LOCK PLATE SCREW	112E	112E-30VS	LEVER CLICK HOUSING
24	24-300LD	HANDLE	117	117-300LD	DRAG HOUSING
26N	26N-25	RIGHT SIDE BALL BEARING	119	119-50	COUPLING PLATE
27	27-300LD	LEFT SIDE PLATE	124L	124L-300LD	BRIDGE COVER ASSEMBLY
29	29L-300LD	SPOOL	128A	128A-300LD	DRIVER
30	30-16VS	STAND	128B	128B-300LD	DRIVE PLATE
31T	31T-70	SCREW (4 REQUIRED)	128C	128C-300LD	DRIVER RETAINER
31TA	31TA-200T	SCREW R.S. (4 REQUIRED)	134	134-300LD	GEAR STUD
32	32-15	HANDLE CAP SCREW	141	141-300LD	CAM FOLLOWER
33	33N-113	ROD CLAMP	143	143-300LD	ADJUSTING SCREW
34	34-16VS	ROD CLAMP SCREW (2 REQUIRED)	149	149-45	ROD CLAMP NUT (2 REQUIRED)
35	35-300LD	CLICK TONGUE	149A	149-200	ROD CLAMP HEX NUT (2 REQUIRED)
36	36-700	CLICK BUTTON NUT	154A	154A-16VS	SPOOL SHIM (2 - OPTIONAL IF NEEDED)
36N	36N-50	CLICK BUTTON	156	156-300LD	DRAG HOUSING COVER
36S	36S-80ST	CLICK BUTTON CAP	162	162-50	LOCATING PIN SPRING (2 REQUIRED)
38	38-710	CLICK BUSHING NUT	173	173-300LD	RETAINING RING
38N	38N-7	COUPLING PLATE SCREW (3 REQUIRED)	183	183-300LD	FRAME
39	39-300LD	LEFT SIDE SCREW (4 REQUIRED)	183	183-300LDE	FRAME (FOR EUROPEAN MODELS)
39S	39S-965	DRAG COVER SCREW (4 REQUIRED)	302D	302D-525MAG	LEVER DRAG SPRING
41	41-15KG	DRAG SPRIN			
41A	41-300LD	DRIVE CLUTCH SPRING			

NOTE: Many of [www.pennparts.com](http://www.pennparts.com) schematics include changes that were either made by Penn, or errors found and corrected by our parts dept.

SBT VER. 062611 (BASED ON PENNS REV 4)