

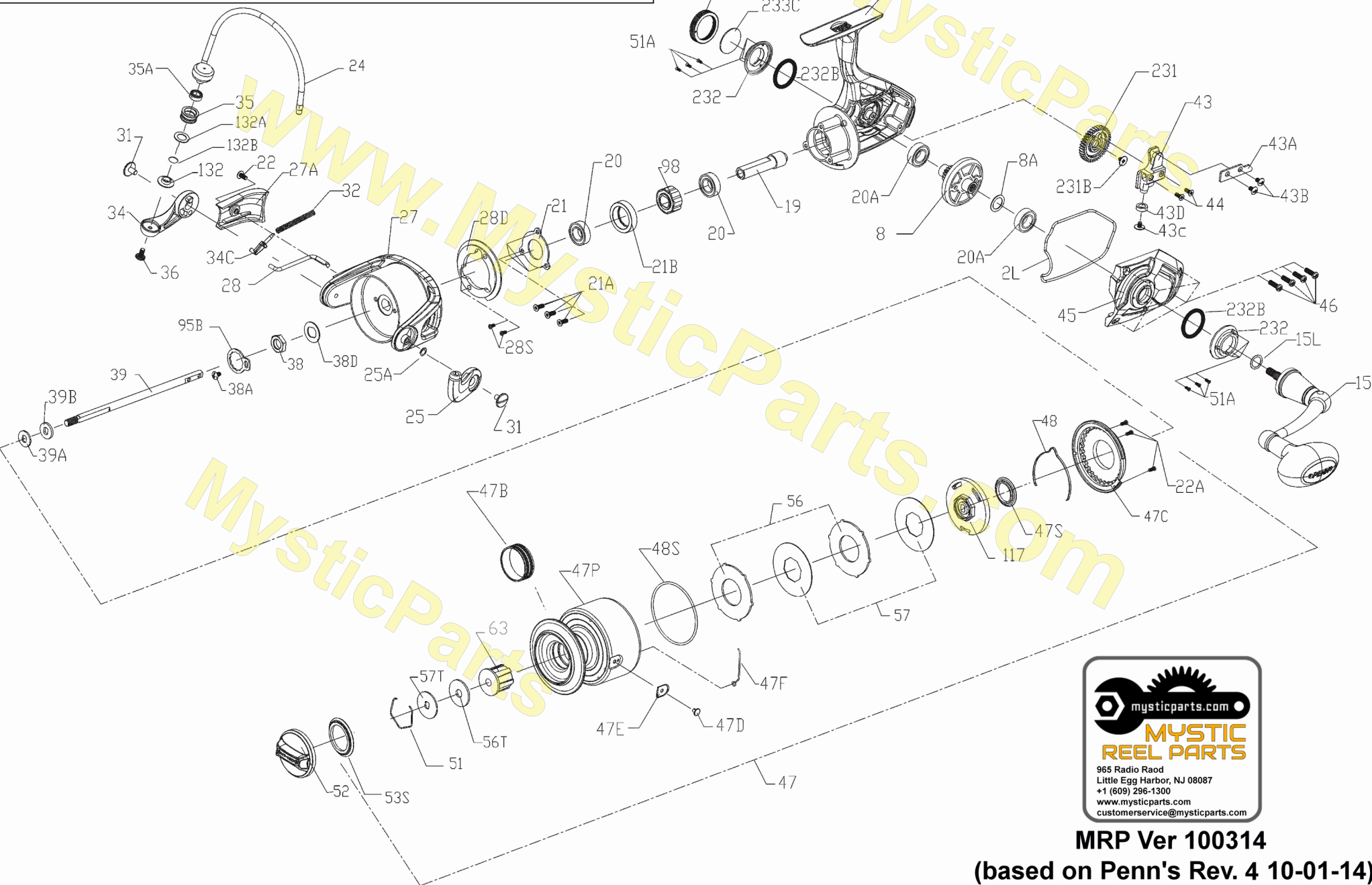

PARTS LIST FOR MODEL SSV5500

Design Change!
See notes on page 3
about these part numbers

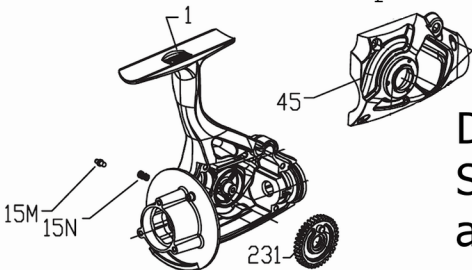

MRP Ver 100314
(based on Penn's Rev. 4 10-01-14)

Penn Reel Parts list for Model: SSV5500 Spinfisher V

KEY NO	PUREFISHING NO.	PENN PART NO.	DESCRIPTION
1	SEE PAGE 3		
2L	1277035	2L-SSV5500	HOUSING BODY SEAL
8	1277036	8-SSV5500	MAIN DRIVE GEAR
8A	1277037	8A-SSV5500	DRIVE GEAR SHIM WASHER (USES 1 OR 2)
15	1277038	15-SSV5500	HANDLE ASSEMBLY
15L	1292783	15L-SSV5500	HANDLE SEAL
19	1277041	19-SSV5500	PINION GEAR
20, 20A	SEE PAGE 3		
21	1277043	21-SSV5500	PINION BEARING RETAINER
21A	1277044	21A-SSV5500	PINION RETAINER SCREW (3 REQUIRED)
21B	1277045	21B-SSV5500	PINION BALL BEARING COLLAR
22	1277046	22-SSV5500	ROTOR COVER SCREW
22A	1277047	22A-SSV5500	DRAG COVER SCREW (3 REQUIRED)
24	1277048	24-SSV5500	BAIL ASSEMBLY
25	1277049	25-SSV5500	BAIL HOLDER (BAIL CAM)
25A	??	25A-SSV5500	SHIM
27	1277050	27-SSV5500	ROTOR
27A	1277051	27A-SSV5500	ROTOR COVER
28	1277052	28-SSV5500	BAIL TRIP LEVER
28D	1277053	28D-SSV5500	ROTOR BRAKE
28S	1277054	28S-SSV5500	ROTOR BRAKE SCREW (2 REQUIRED)
31	1277055	31-SSV5500	BAIL ARM SCREW (2 REQUIRED)
32	1277056	32-SSV5500	BAIL SPRING
34	1277057	34-SSV5500	BAIL ARM
34C	1277058	34C-SSV5500	PIVOT ARM
35	1277059	35-SSV5500	LINE ROLLER
35A	1277060	35A-SSV5500	LINE ROLLER BALL BEARING
36	1277061	36-SSV5500	LINE ROLLER SCREW
38	1277062	38-SSV5500	ROTOR NUT
38A	1277063	38A-SSV5500	ROTOR NUT LOCK PLATE SCREW (3 REQUIRED)
38D	1277064	38D-SSV5500	ROTOR WASHER
39	1277065	39-SSV5500	MAIN SPOOL SHAFT
39A	1277066	39A-SSV5500	SPOOL ADJUST WASHER (USES 1 OR 2)
39B	1277067	39B-SSV5500	MAIN SHAFT WASHER
43	1277068	43-SSV5500	OSCILLATION SLIDER (CROSSWIND BLOCK)
43A	1277069	43A-SSV5500	OSCILLATION SLIDER GUIDE (CROSSWIND PLATE)
43B	1277070	43B-SSV5500	CROSSWIND OSCILLATION SLIDER GUIDE SCREW (2 REQUIRED)

KEY NO	PUREFISHING NO.	PENN PART NO.	DESCRIPTION
43C	1277071	43C-SSV5500	CROSSWIND OSCILLATION SLIDER BUSHING SCREW
43D	1279457	43D-SSV3500	CROSSWIND OSCILLATION SLIDER BUSHING
44	1277072	44-SSV5500	MAIN SHAFT SCREW (2 REQUIRED)
45	SEE PAGE 3		
46	1277074	46-SSV5500	HOUSING / BODY COVER SCREW (4 REQUIRED)
47	1277075	47-SSV5500	SPOOL ASSEMBLY
47B	1277076	47B-SSV5500	SPOOL BAND
47C	1277077	47C-SSV5500	DRAG COVER
47D	1277078	47D-SSV5500	LINE CLIP
47E	1277079	47E-SSV5500	LINE CLIP BUSHING
47F	1277080	47F-SSV5500	LINE CLIP RETAINER
47P	1277081	47P-SSV5500	SPOOL, BARE
47S	1277082	47S-SSV5500	DRAG COVER / DRIVE PLATE SEAL
48	1277083	48-SSV5500	SPOOL CLICKER
48S	1277084	48S-SSV5500	DRAG COVER SEAL
51	1277085	51-SSV5500	DRAG WASHER RETAINING RING
51A	1277086	51A-SSV5500	BEARING RETAINER SCREW (6 REQUIRED)
52	1277087	52-SSV5500	DRAG KNOB ASSEMBLY
53S	1293252	53S-SSV5500	DRAG KNOB SEAL
56	1277088	56-SSV5500	DRAG FRICTION WASHER HT100 (2 REQUIRED)
56T	1277089	56T-SSV5500	DRAG FRICTION WASHER HT100
57	1277090	57-SSV5500	KEYED METAL DRAG WASHER (2 REQUIRED)
57T	1277091	57T-SSV5500	KEYED METAL DRAG WASHER
63	1277092	63-SSV5500	SPOOL BUSHING
95B	1277093	95B-SSV5500	ROTOR NUT LOCKING PLATE
98	1277094	98-SSV5500	CLUTCH / SLEEVE ASSEMBLY
117	1277095	117-SSV5500	DRAG DRIVE PLATE
132	1277096	132-SSV5500	LINE ROLLER COLLAR
132A	1277097	132A-SSV5500	LINE ROLLER WASHER
132B	??	132B-SSV5500	SHIM (MAY NOT BE IN ALL REELS)
231	SEE PAGE 3		
231B	SEE PAGE 3		
232	1277101	232-SSV5500	BEARING RETAINER (2 REQUIRED)
232B	1302502	232B-SSV3500	BEARING RETAINER O-RING (2 REQUIRED)
233A	1277103	233A-SSV5500	HANDLE CAP
233C	1277104	233C-SSV5500	HANDLE CAP WASHER
?? = FOUND IN REEL BUT NOT ON PENN'S SCHEMATIC			

List of parts related to design changes is on page 3 of the schematic

MYSTIC REEL PARTS REVISION!

NOTE:

Many of www.mysticparts.com schematics include changes that were either made by Penn, or errors found and corrected by our parts dept.

MRP Ver 100314 (Based on Penn's Rev. 4, 10-01-14)

MRP Ver 032924 (Parts List updated to clarify housing/gearing design changes sizing)

These parts below were removed by Rev 3, we are not yet sure why.

15M	1277039	15M-SSV5500	HANDLE CAP LOCK PIN (2 REQUIRED)
15N	1277040	15N-SSV5500	HANDLE CAP LOCK PIN SPRING (2 REQUIRED)

REV 3. Bearing number changes

20A 1277042 20A-SSV5500 BALL BEARING (4 REQUIRED)

We are assuming there were errors with the bearing part numbers on the schematic, rather than that they actually changed the bearings.

REV. 4 Bearings

20 1308090 20-CFT5000 BALL BEARING UPPER AND LOWER PINION BEARINGS (2 REQUIRED)
20A 1277042 20A-SSV5500 BALL BEARING HOUSING/MAIN GEAR BEARINGS (2 REQUIRED)

RECOMMEND TO USE THE REVISION 4 NUMBERS

***** DESIGN CHANGE WARNING *****

Early SSV reels when released had a slightly different housing, crosswind gear and housing cover

The diameter of the CW gear hole and post was CHANGED and the pin/pin hole diameters on the 45- cover were changed as well

THIS DESIGN CHANGE affects the housing, crosswind gear, and housing cover

MEASURE YOUR HOUSING/GEAR

At the post where the crosswind sits or the hole in the center of the crosswind gear.

Parts that you order MUST MATCH EACH OTHER

Some parts may no longer be available, so check all three parts for availability and matching size

******* BEFORE YOU PLACE AN ORDER! *******

MEASURE and CHECK STOCK FIRST! .23 peg (1/4") SIZE

1	1277034	1-SSV5500	HOUSING, BODY ASSEMBLY with .23 peg (1/4")
231	1277098	231-SSV5500	CROSSWIND OSCILLATION GEAR 0.23" I.D. (1/4")
45	1277073	45-SSV5500	HOUSING / BODY COVER to match (1/4")
231B	1307857	231B-SSV3500	CROSSWIND OSCILLATION GEAR SCREW (1/4")

MEASURE and CHECK STOCK FIRST! .309 peg (5/16")

1	NLA **	1-SSV5500	HOUSING, BODY ASSEMBLY with .309 peg (5/16")
231	NLA **	231-SSV5500	CROSSWIND OSCILLATION GEAR 1st run 0.309" I.D. (5/16")
45	NLA **	45-SSV5500	HOUSING / BODY COVER to match (5/16")
231B	1277100	231B-SSV5500	CROSSWIND OSCILLATION GEAR SCREW (5/16")

**** NLA = NOT AVAILABLE as of 2024 updates (design changes were first noted back in 2014)**

<https://www.mysticparts.com/PennParts/PennSSV5500.aspx>

page 3 of 3