

# 99 Silver Beach

schematic built by  
[www.pennparts.com](http://www.pennparts.com)  
based on parts lists

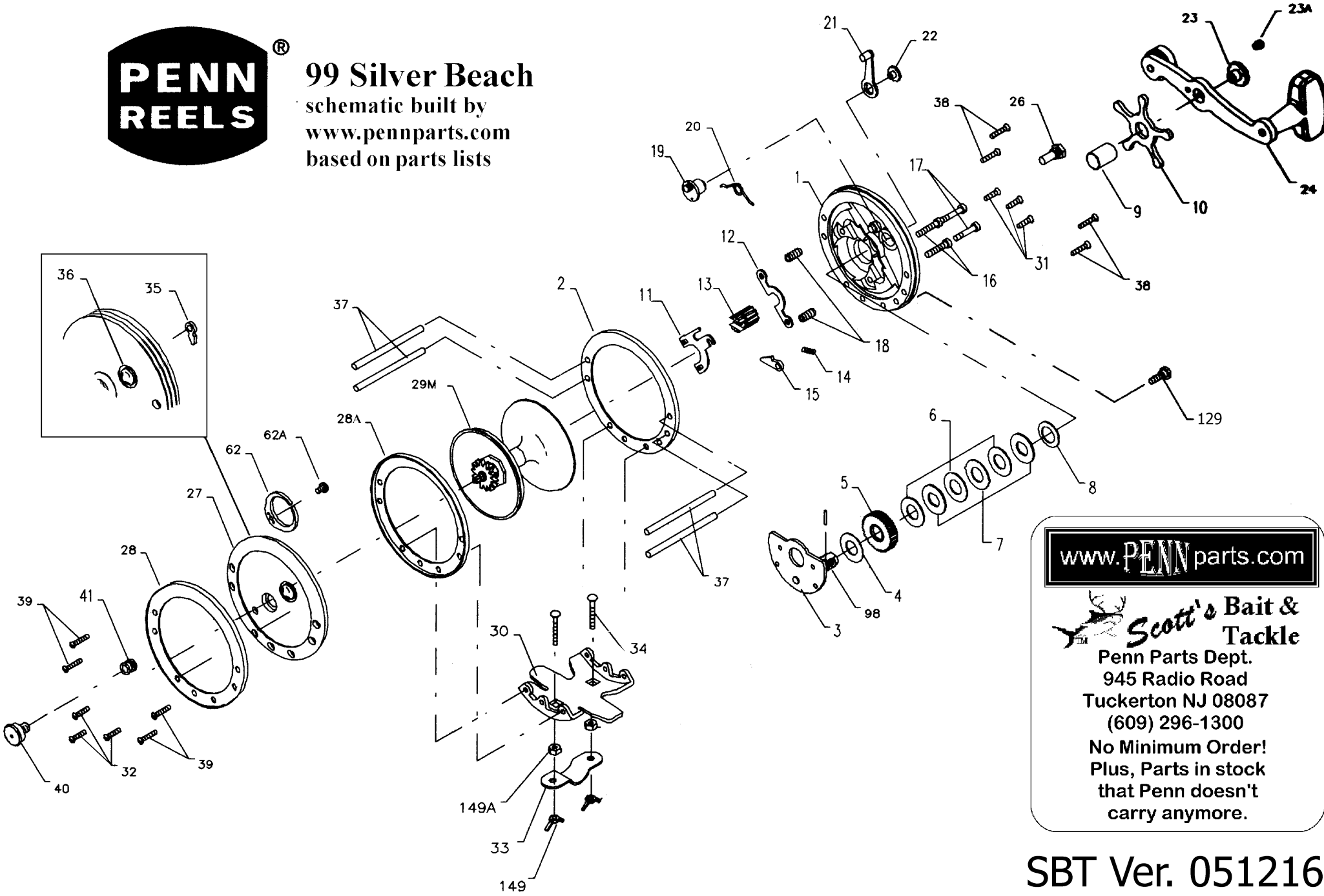

[www.PENNparts.com](http://www.PENNparts.com)

 **Scott's Bait & Tackle**

Penn Parts Dept.  
945 Radio Road  
Tuckerton NJ 08087  
(609) 296-1300

No Minimum Order!  
Plus, Parts in stock  
that Penn doesn't  
carry anymore.

SBT Ver. 051216

## Penn Reel Parts list for Model: 99 Silver Beach

KEY NO	PART NO.	DESCRIPTION	KEY NO	PART NO.	DESCRIPTION
1	1-99	R.S. PLATE	23	23-60	HANDLE SCREW
2	2-99	R.S. RING	23A	110-60	HANDLE LOCK SCREW
3	3-99	BRIDGE W/ SLEEVE	24	24-155	COMPLETE HANDLE
4	4-60	FIBER WASHER	25	25-60	KNOB, RIVET & OILER
5	5-60	MAIN GEAR	26	26-155	R.S. BEARING
6	6-60	DRAG WASHER	27	27-99	L.S.PLATE
7	7C-60	METAL DISC SET	28	28-99-O	UPPER L.S. RING
8	8-60	TENSION SPRING	28A	28-99	INNER L.S. RING
9	9-60	SPACING SLEEVE	29	29-99	PLASTIC SPOOL
10	10-60	STAR DRAG	29M	29M-99	METAL SPOOL
11	11-99	ECCENTRIC JACK	30	30-99	STAND
12	12-500	PINION YOKE	31	31-19	R.S. STAND SCREW (3 REQUIRED)
13	13-140	PINION (replaces old 13-99)	32	32-17	L.S. STAND SCREW (3 REQUIRED)
14	14-99	DOG SPRING	33	33-200	ROD CLAMP
15	15-99	DOG	34	34-200	CLAMP SCREW
16	16-60CH	LOWER BRIDGE SCREW	35	35-60	CLICK TONGUE
17	17-60CH	UPPER BRIDGE SCREW	36	36-60CH	CLICK BUTTON
18	18-60	CLUTCH SPRING	37	37-65	POST FRAME
19	19-99	ECCENTRIC	38	38-7	R.S. POST SCREW (4 REQUIRED)
20	20-60L	ECCENTRIC SPRING	39	39-3	L.S. POST SCREW (4 REQUIRED)
21	21-66	ECCENTRIC LEVER	40	40-60	L.S. BEARING
22	22-99	ECCENTRIC SCREW	41	41-60	SPRING
			129	129-200	TAKE-APART THUMB SCREW

NOTE: Many of [www.pennparts.com](http://www.pennparts.com) schematics include changes that were either made by Penn, or errors found and corrected by our parts dept.  
 SBT Ver. 051216