

PENN PARTS SCHEMATIC 545GS

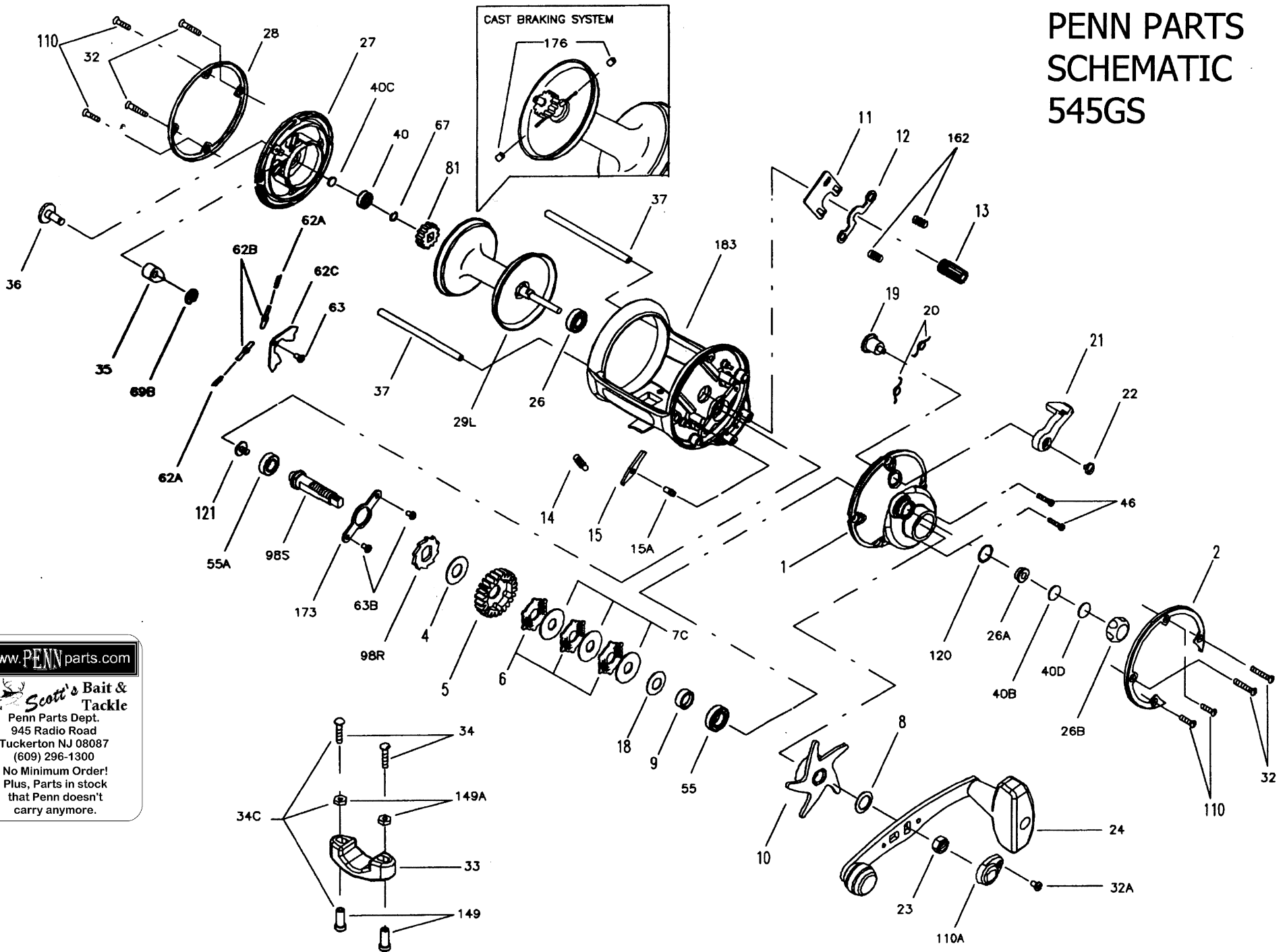

www.PENNparts.com

Scott's Bait & Tackle

Penn Parts Dept.
945 Radio Road
Tuckerton NJ 08087
(609) 296-1300

No Minimum Order!
Plus, Parts in stock
that Penn doesn't
carry anymore.

Penn Reel Parts list for:

Model: 545GS

| KEY PART | | | KEY PART | | |
|----------|----------|-------------------------------|----------|----------|---------------------------------|
| NO | NO. | DESCRIPTION | NO | NO. | DESCRIPTION |
| 1 | 1-555 | RIGHT SIDE PLATE | 34C | 34C-45 | ROD CLAMP SCREW W/ NUTS |
| 2 | 2-555 | RIGHT SIDE RING | 35 | 35-310N | CLICK TONGUE |
| 4 | 4-60 | FIBER WASHER | 36 | 36-555 | CLICK BUTTON |
| 5 | 5-525MAG | MAIN GEAR | 37 | 37-535 | FRAME POST (2 REQ.) |
| 6 | 6-525MAG | FRICTION DRAG WASHER (3 REQ.) | 40 | 40-320 | L.S. SPOOL BALL BEARING |
| 7C | 86-49L | METAL DRAG WASHER (3 REQ.) | 40B | 40C-555 | METAL THRUST WASHER |
| 8 | 8-60 | TENSION SPRING WASHER | 40C | 40C-310 | METAL THRUST WASHER |
| 9 | 9-555 | SPACING SLEEVE | 40D | 40D-555 | RUBBER THRUST WASHER |
| 10 | 10N-555 | DRAG STAR | 46 | 46-4300 | SIDE PLATE SCREW (2 REQ.) |
| 11 | 11-555 | ECCENTRIC JACK | 55 | 55-12H | BALL BEARING |
| 12 | 12-555 | PINION YOKE | 55A | 20-722 | BALL BEARING |
| 13 | 13-545 | PINION GEAR | 62A | 62-545 | CLICK SPRING (2 REQ.) |
| 14 | 14-330 | DOG SPRING | 62B | 62B-310 | CLICK PIN (2 REQ.) |
| 15 | 15-340 | DOG | 62C | 62C-310 | CLICK SPRING COVER |
| 15A | 158N-555 | DOG PIN | 63 | 63-500S | CLICK SPRING SCREW |
| 18 | 18-505 | TENSION SPRING WASHER | 63B | 63-330 | BEARING RETAINER SCREW (2 REQ.) |
| 19 | 19-555 | ECCENTRIC | 67 | 67-9 | LOCK RING |
| 20 | 20-155 | ECCENTRIC SPRING (2 REQ.) | 69B | 69B-600 | RETAINING RING |
| 21 | 21-310 | ECCENTRIC LEVER | 81 | 81-555 | CLICK RATCHET |
| 22 | 22-310 | ECCENTRIC SCREW | 98R | 98-555 | MAIN GEAR RATCHET |
| 23 | 23-555 | HANDLE NUT | 98S | 134-555 | GEAR STUD |
| 24 | 24-555 | HANDLE | 110 | 110-50 | SIDE PLATE SHORT SCREW (4 REQ.) |
| 26 | 26-25 | R.S. SCREW BALL BEARING | 110A | 110A-555 | HANDLE NUT LOCK CAP |
| 26A | 26-555 | RIGHT SIDE BUSHING | 120 | 120-113H | O-RING |
| 26B | 26B-555 | SPOOL TENISION CONTROL CAP | 121 | 121-555 | BEARING SCREW |
| 27 | 27-545 | LEFT SIDE PLATE | 149 | 149-45 | ROD CLAMP NUT (2 REQ.) |
| 28 | 28-555 | LEFT SIDE RING | 149A | 149-200 | ROD CLAMP HEX NUT (2 REQ.) |
| 29L | 29L-545 | ALUMINUM SPOOL ASSEMBLY | 162 | 162-130 | CLUTCH SPRING (2 REQ.) |
| 32 | 32-310 | FRAME POST SCREW (4 REQ.) | 173 | 173-555 | BEARING RETAINER |
| 32A | 32-15 | HANDLE LOCK SCREW | 176 | 176-555 | CASTING BRAKES (2 REQ.) |
| 33 | 33-113 | ROD CLAMP | 183 | 183N-545 | FRAME |
| 34 | 34-45 | ROD CLAMP SCREW (2 REQ.) | | | |

NOTE: Many of www.pennparts.com schematics include changes that were either made by Penn, or errors found and corrected by our parts dept.