

* parts not to scale, some redrawn

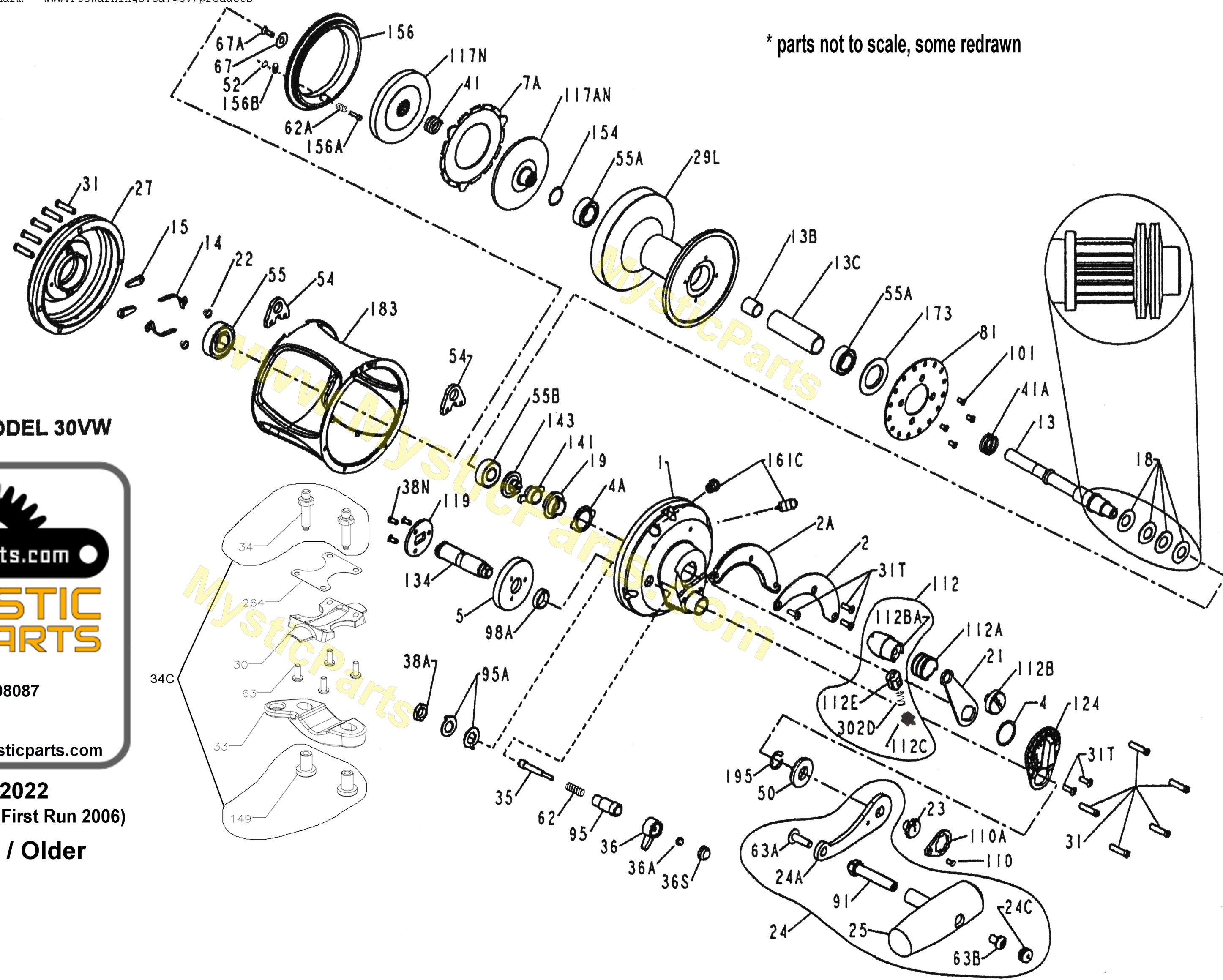

PARTS LIST FOR MODEL 30VW

mysticparts.com
MYSTIC REEL PARTS
 965 Radio Raod
 Little Egg Harbor, NJ 08087
 +1 (609) 296-1300
 www.mysticparts.com
 customerservice@mysticparts.com

MRP Ver 062022
 (based on Penn's Rev 0 First Run 2006)
30VW Before / Older

Penn Reel Parts list for Model: 30VW (Before Design Changes)

KEY	PENN PART	PUREFISHING	DESCRIPTION	KEY	PENN PART	PUREFISHING	DESCRIPTION
NO	PART #	PART #		NO	PART #	PART #	
1	1-30VS	1180415	RIGHT SIDE PLATE ASSEMBLY	62	62-50	1184022	CLICK SPRING
2	2-30VS	1180592	QUADRANT RING	62A	62-545	1184029	CLICK SPRING
2A	2A-30VS	1180655	QUADRANT SPACER	63	63-30T	1184045	STAND SCREWS (4 REQUIRED)
4	4-12LT	1180748	CAM THRUST WASHER	63A	63A-50	1184056	SCREW
4A	4-30VS	1180752	CAM BUSHING	63B	63-50	1184046	SCREW
5	5-30VW	1190952	MAIN GEAR	67	67-70	1184106	PINION GEAR WASHER
7A	7A-30VS	1181032	METAL DRAG WASHER	67A	67A-70	1184111	PLATE SCREW
13	13-30VW	1191099	PINION GEAR	81	81-50	1184204	RATCHET
13B	13B-70	1181371	PINION GEAR SLEEVE	91	91N-50	1184304	HANDLE RIVET
13C	13B-30VSW	1181367	SPOOL SLEEVE	95	95-70	1184307	CLICK TONGUE BUSHING
14	14-50	1181391	DOG SPRING (2 REQUIRED)	95C	95A-50	1184311	CLICK BUSHING WASHER
15	15-50	1181425	DOG (2 REQUIRED)	98A	98A-30VW	1192706	GEAR STUD SPACER
18	18-30	1181610	DISC CLUTCH SPRING (4 REQUIRED)	101	101-30	1184403	RATCHET PLATE SCREW (4 REQUIRED)
19	19-30VS	1181643	ECCENTRIC CAM	110	110-50	1184436	SCREW
21	21-30VS	1181828	ECCENTRIC LEVER	110A	110A-50	1184441	LOCKING PLATE
22	22-109	1181912	DOG SPRING SCREW (2 REQUIRED)	112	112-30VS	1184456	ECCENTRIC LEVER KNOB ASSEMBLY
23	23-114	1181945	HANDLE SCREW (2 REQUIRED)	112A	112A-30VS	1184460	KNOB SLEEVE
24	24N-30TW	1181970	HANDLE COMPLETE	112B	112B-70	1184464	ECCENTRIC KNOB SCREW
24C	24C-50M	1191334	HANDLE KNOB CAP	112C	112C-30VS	1192712	DRAG CLICK PLATE
25	25-50M	1206099	HANDLE KNOB	112E	112E-30VS	1192713	CLICK PLATE HOUSING
27	27-30VW	1191376	L.S. PLATE ASSEMBLY	117A	117AN-50S	1184495	DRIVE PLATE W/ DRAG WASHER
29L	29L-30VSW	1182487	SPOOL	117D	117N-50S	1184507	DRIVE PLATE W/ DRAG WASHER
30	<i>See design changes below</i>			119	119-50	1192268	COUPLING PLATE
31	31T-80	1182701	SIDE PLATE SCREW, LONG (10 REQUIRED)	124	124L-30VS	1184548	BRIDGE COVER ASSEMBLY
31T	31T-70	1182700	SHORT SCREW (5 REQUIRED)	134	134-30VW	1192309	GEAR STUD
33	33-70	1182753	ROD CLAMP	141	141-30VS	1184652	CAM FOLLOWER
34	<i>See design changes below</i>			143	143-16VS	1184670	PRESET SCREW
34C	<i>See design changes below</i>			149	149-70	1184703	ROD CLAMP NUT (2 REQUIRED)
35	35-70	1182902	CLICK TONGUE	154	154-80	1184719	INNER DRAG PLATE SHIM
36	36N-50	1183047	CLICK BUTTON	156	156-30VS	1184736	DRAG COVER
36A	36-700	1183014	CLICK BUTTON NUT	156A	156A-30VS	1184752	LOCK PIN
36C	36C-30VSW	1191712	CLICK BUTTON ASSEMBLY	156B	156B-30VS	1184756	LOCK PLATE
36S	36S-80ST	1183051	CLICK BUTTON CAP	161	161-30VS	1184786	LOCATING PIN BUSHING (2 REQUIRED)
38A	38-710	1183157	CLICK BUSHING NUT	173B	173-50VS	1184838	BEARING RETAINER
38N	38N-7	1183171	SCREW (3 REQUIRED)	183	<i>See design changes below</i>		
41	41-2.5FR	1183332	BEARING SPRING	195	195-40	1184955	RETAINING RING (2 REQUIRED)
41A	41-70	1183328	DRAG SPRING	264	<i>See design changes below</i>		
50	50-30VW	1191965	SHIELD	302D	302D-525MAG	1185255	MAGNET SPRING (2 REQUIRED)
52	52-910	1183840	RETAINING RING				
54	54-30T	1183852	HARNES LUG (2 REQUIRED)				
55	55-80	1183878	BALL BEARING				
55A	55-80ST	1183879	BALL BEARING (2 REQUIRED)				
55B	20-704	1181790	BALL BEARING				

MYSTIC REEL PARTS REVISION!

NOTE: Many of www.mysticparts.com schematics include changes that were either made by Penn, or errors found and corrected by our parts dept.
MRP Ver 062022 (based on Penn's Rev 0 from 2006 First run)

DESIGN CHANGES AND CORRECTIONS (REV 0)

KEY	PENN PART	PUREFISHING	DESCRIPTION
NO	PART #	PART #	
	DO NOT USE THIS 7 digit NUMBER		
30	30-30VS OLDER	4491554	STAND, HALF MOON CUTOUTS (older version is NOT available)
264	264-30VS OLDER	4492542	STAND GASKET, HALF MOON CUTOUTS (older version is NOT available)
183	183-30VW OLDER	4492738	TUBE FRAME Original with screw holes for older studs 34-70 (not available)

THESE 3 PART NUMBERS WERE REDESIGNED in their Rev 00 thru 6 schematics
PENN DID NOT ASSIGN THE NEW PARTS NEW 7 DIGIT #S !! So be careful

THE ORIGINAL PARTS ARE NOT AVAILABLE.

IF THE PARTS IN THE DRAWING DO NOT MATCH YOUR REEL, SEE THE 30VW_after SCHEMATIC OF the NEWER VERSION
THIS IS IMPORTANT AS THE STUD SCREWS ARE ALSO OF A DIFFERENT DESIGN

Older style studs that screw UP into the frame

33C	33C-70	1182771	Rod Clamp Kit Clamp/Studs/Nuts/Wrench (Older Version)
34	34-70	1182793	CLAMP SCREW, SCREW UP STYLE (2 REQUIRED)
34C	34C-70	1182865	ROD CLAMP SCREW W/NUT, SCREW UP STYLE NUT

After the 1st run they changed over the design to drop in studs, so major parts changes from rev 00 thru rev 6