



PARTS LIST FOR MODEL 30VSW

www.PENNparts.com

Scott's Bait & Tackle

Penn Parts Dept.
945 Radio Road
Tuckerton NJ 08087
(609) 296-1300

No Minimum Order!
Plus, Parts in stock
that Penn doesn't
carry anymore.

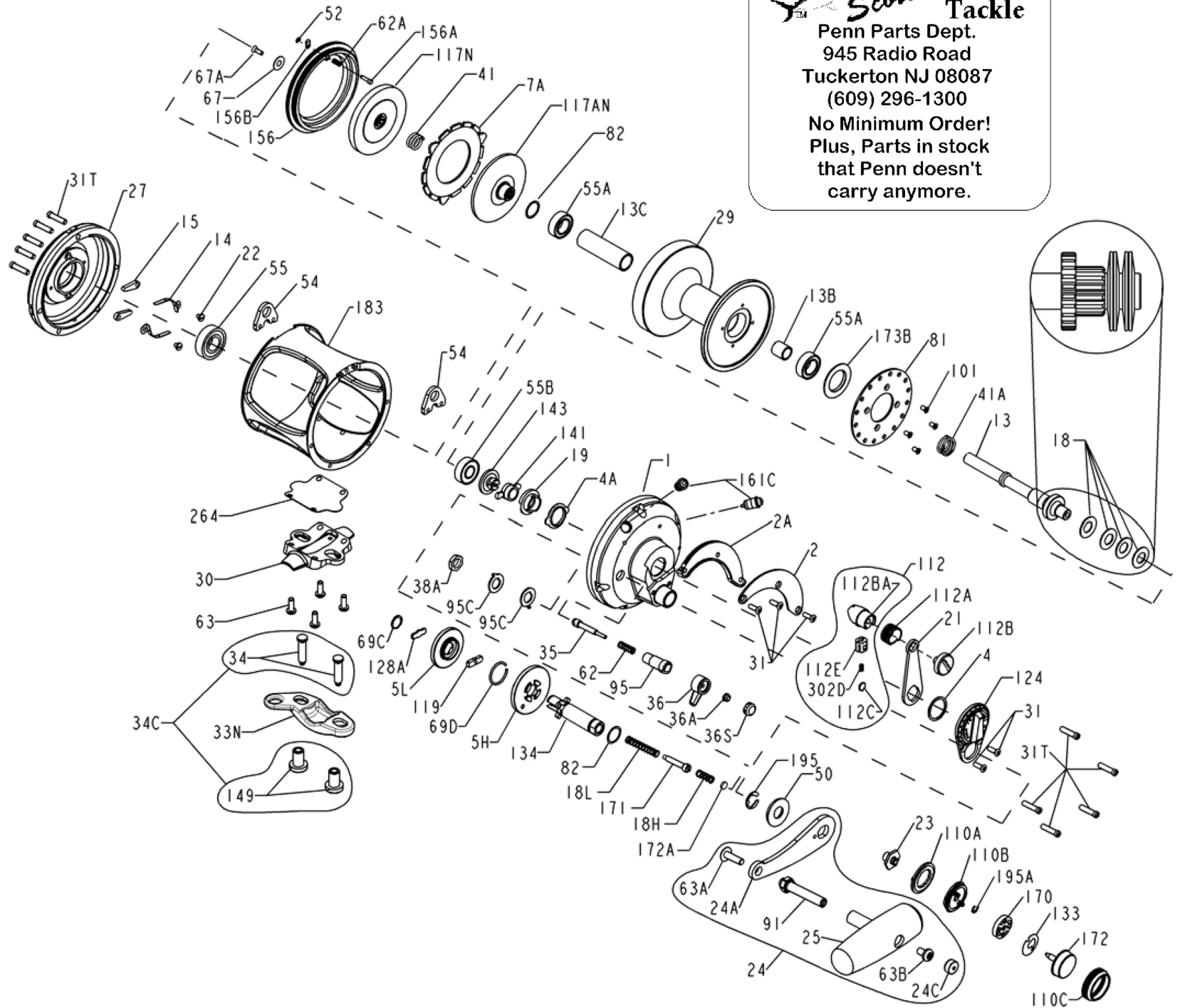

Penn Reel Parts list for: Model: 30VSW (NEWER) International V 2-speed

KEY PART			KEY PART		
NO	NO.	DESCRIPTION	NO	NO.	DESCRIPTION
1	1-30VS	RIGHT SIDE PLATE ASSEMBLY	63	63-30T	STAND SCREWS (4 REQ.)
2	2-30VS	QUADRANT RING	63A	63A-50	SCREW
2A	2A-30VS	QUADRANT SPACER	63B	63-50	SCREW
4	4-12LT	CAM THRUST WASHER	67	67-70	PINION GEAR WASHER
4A	4-30VS	CAM BUSHING	67A	67A-70	PLATE SCREW
5H	5-30VSHS	MAIN GEAR HIGH-SPEED	69	69-30VS	LOCATING PIN (2 REQ.)
5L	5-30VSLS	MAIN GEAR LOW-SPEED	69C	195-24KG	RETAINING RING
7A	7A-30VS	METAL DRAG WASHER	69D	69C-245	RETAINING RING (2 REQ.)
13	13-30VSW	PINION GEAR	81	81-50	RATCHET
13B	13B-70	PINION GEAR SLEEVE	82	154-80	SHIM (2 REQ.)
13C	13B-30VSW	SPOOL SLEEVE	91	91N-50	HANDLE RIVET
14	14-50	DOG SPRING (2 REQ.)	95	95-70	CLICK TONGUE BUSHING
15	15-50	DOG (2 REQ.)	95C	95A-50	CLICK BUSHING WASHER
18	18-30	DISC CLUTCH SPRING (4 REQ.)	101	101-30	RATCHET PLATE SCREW (11 REQ.)
18H	18H-30VS	SHIFT SPRING (HEAVY)	110A	110A-30VS	RING
18L	18L-30VS	SHIFT SPRING (LIGHT)	110B	110B-30VS	SHIFT BASE
19	19-30VS	ECCENTRIC CAM	110C	110C-30VS	SHIFT BUTTON RETAINER
21	21-30VS	ECCENTRIC LEVER	112	112-30VS	ECCENTRIC LEVER KNOB ASSEMBLY
22	22-109	DOG SPRING SCREW (2 REQ.)	112A	112A-30VS	KNOB SLEEVE
23	23-30VS	HANDLE SCREW (2 REQ.)	112B	112B-70	ECCENTRIC KNOB SCREW
24	24-30VS	HANDLE COMPLETE	112BA	112B-30VS	DRAG LEVER KNOB
24C	24C-50M	HANDLE KNOB CAP	112C	112C-30VS	DRAG CLICK PLATE
25	25-50M	HANDLE KNOB	112E	112E-30VS	DRAG CLICK PLATE HOUSING
27	27-30VS	L.S. PLATE ASSEMBLY	117A	117AN-50S	DRIVE PLATE W/ DRAG WASHER
29L	29L-30VSW	SPOOL	117D	117N-50S	DRIVE PLATE W/ DRAG WASHER
30	30-30VS	STAND	119	119-24KG	COUPLING PLATE
31	31T-70	SHORT SCREW (5 REQ.)	124	124L-30VS	BRIDGE COVER ASSEMBLY
31T	31-80VS	SIDE PLATE SCREW (10 REQ.)	128A	128A-24KG	LOW GEAR DRIVE SHIFT PLATE
33	33N-70	ROD CLAMP	133	133-30VS	RETAINING PLATE
34	34-70VS	CLAMP SCREW (2 REQ.)	134	134-30VS	GEAR STUD
34C	34C-70VS	ROD CLAMP SCREW W/NUT	141	141-30VS	CAM FOLLOWER
35	35-70	CLICK TONGUE	143	143-16VS	PRESET SCREW
36	36N-50	CLICK BUTTON	149	149-70	ROD CLAMP NUT (2 REQ.)
36A	36-700	CLICK BUTTON NUT	156	156-30VS	DRAG COVER
36S	36S-80ST	CLICK BUTTON CAP	156A	156A-30VS	LOCK PIN
38A	38-710	CLICK BUSHING NUT	156B	156B-30VS	LOCK PLATE
41	41-2.5FR	BEARING SPRING	161	161C-30VSW	LOCATING PIN BUSHING (2 REQ.)
41A	41-70	DRAG SPRING	170	170-30VS	CATCH ASSEMBLY
50	50-50VS	SHIELD	171	171-30VS	SHIFT PLUNGER
52	52-910	RETAINING RING	172	172-30VS	SHIFT BUTTON (LOW)
54	54-30T	HARNES LUG (2 REQ.)	172A	172B-30VS	SPRING SPACER
55	55-80	BALL BEARING	173B	173-50VS	BEARING RETAINER
55A	55-80ST	BALL BEARING (2 REQ.)	183	183N-30VSW	TUBE FRAME
55B	20-704	BALL BEARING	195	195-40	RETAINING RING (2 REQ.)
62	62-50	CLICK SPRING	195A	67-30VS	RETAINING RING
62A	62-545	CLICK SPRING	264	264-30VS	STAND GASKET

NOTE: Many of www.pennparts.com schematics include changes that were either made by Penn, or errors found and corrected by our parts dept.
SBT Ver. 060615