

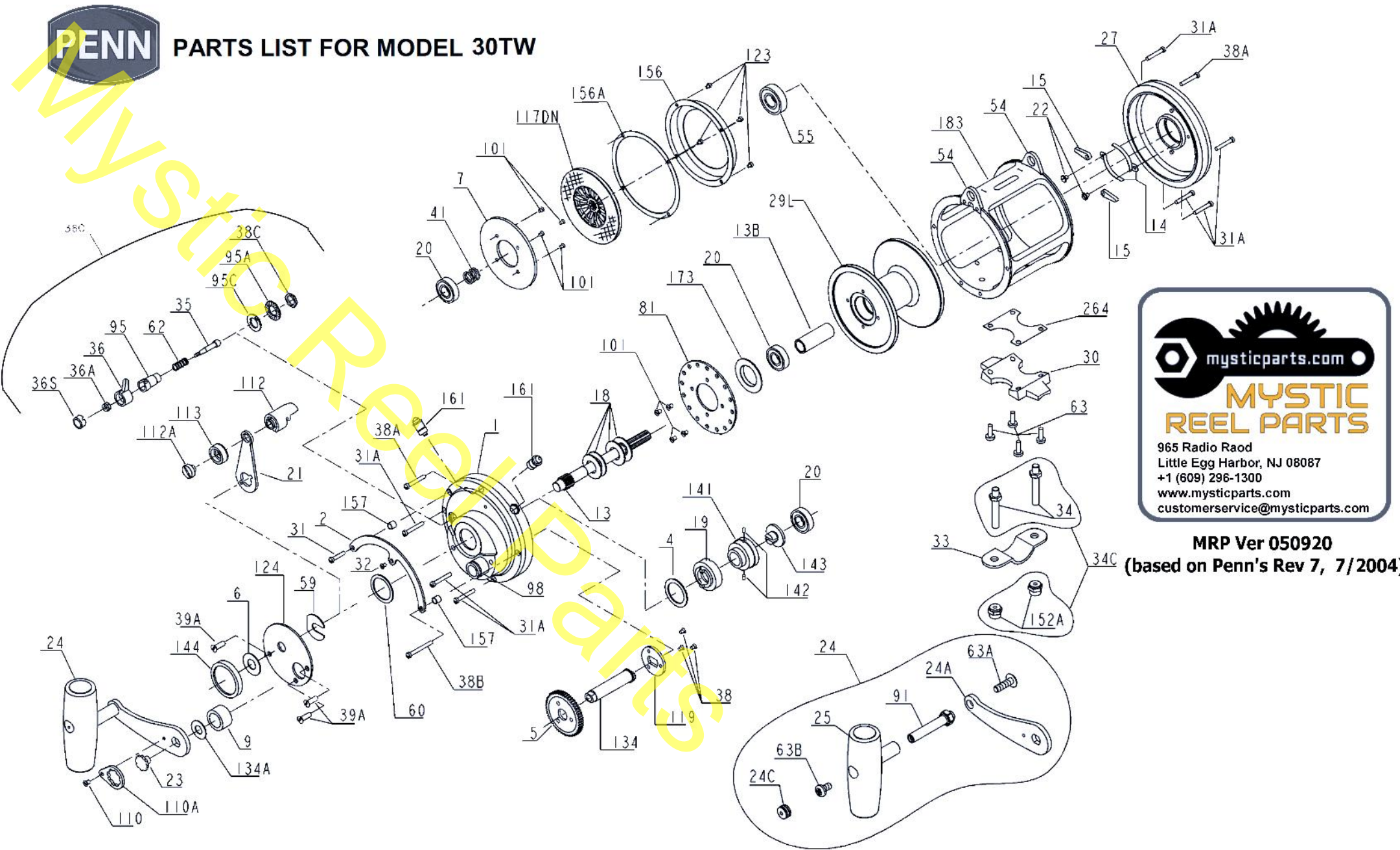

PARTS LIST FOR MODEL 30TW



mysticparts.com
MYSTIC REEL PARTS
 965 Radio Raod
 Little Egg Harbor, NJ 08087
 +1 (609) 296-1300
 www.mysticparts.com
 customerservice@mysticparts.com

MRP Ver 050920
(based on Penn's Rev 7, 7/2004)

Penn Reel Parts list for Model: 30TW INTERNATIONAL II SPEED

KEY	PUREFISHING	PENN PART		KEY	PUREFISHING	PENN PART	
<u>NO</u>	<u>7DIG#</u>	<u>NO.</u>	<u>DESCRIPTION</u>	<u>NO</u>	<u>7DIG#</u>	<u>NO.</u>	<u>DESCRIPTION</u>
** plate design change see pg 3							
2	1180591	2-30	QUADRANT RIN	55	1183878	55-80	L.S. BEARING
4	1180751	4-30	CAM THRUST WASHER	59	1183976	59-50	SLOTTED WASHER
5	1180825	5-50W	MAIN GEAR	60	1183983	60-50	BACKING WASHER
6	1180915	6-155	SPACER WASHER	62	1184022	62-50	CLICK SPRING
7	1181003	7-30	METAL DRAG WASHER	63	1184045	63-30T	STAND SCREWS (4 REQ.)
9	1181139	9-30	SPACER SLEEVE	69	1184116	69-50	LOCATING PIN (2 REQ.)
13	1181289	13-30TW	PINION GEAR	69B	1184125	69B-50	RETAINING RING (2 REQ.)
13B	1181366	13B-30TW	SPOOL SLEEVE	81	1184204	81-50	RATCHET
14	1181391	14-50	DOG SPRING (2 REQ.)	95	1184306	95-50	CLICK TONGUE BUSHING
15	1181425	15-50	DOG (2 REQ.)	95A	1184310	95A-20	CLICK BUSHING WASHER
18	1181611	18-30TW	DISC CLUTCH SPRING (4 REQ.)	95C	1184311	95A-50	CLICK BUSHING WASHER
19	1181644	19-30W	ECCENTRIC CAM	101	1184403	101-30	DRIVE PLATE SCREW (8 REQ.)
20	1181790	20-704	BALL BEARING (3 REQ.)	110	1184436	110-50	HANDLE LOCK SCREW
21	1181826	21-30	ECCENTRIC LEVER	110A	1184441	110A-50	HANDLE LOCKING PLATE
22	1181912	22-109	DOG SPRING SCREW (2 REQ.)	112	1184457	112-50	ECCENTRIC LEVER KNOB
23	1181945	23-114	HANDLE SCREW	112A	1184461	112A-50	ECCENTRIC KNOB SCREW
** HANDLE COMPONENTS SEE PAGE 3							
27	1182158	27-30T	L.S. PLATE ASSEMBLY	113	1184466	113-50	ECCENTRIC LEVER CAP
29L	1182486	29L-30TW	SPOOL	117	1184502	117DN-30	DRIVE PLATE W/DRAG WASHER
30	1182601	30-20T	STAND	119	1192268	119-50	COUPLING PLATE
31	1182699	31T-20	SHORT QUADRANT SCREW	123	1184531	123-50	DRAG COVER SCREW (4REQ.)
31A	1182701	31T-80	FRAME SCREW (7 REQ.)	124	1184537	124-30	BRIDGE COVER
32	1182707	32-14CH	CENTER QUADRANT SCREW	*	1184553	125-30	CAM HOUSING
33	1182755	33-114	ROD CLAMP	134	1184615	134-50	GEAR STUD
*	1182779	33R-114	RINGED ROD CLAMP	134A	1184629	134A-50	GEAR STUD WASHER
** frame design change studs diff diameters pg 3							
36A	1183014	36-700	CLICK BUTTON NUT	141	1184651	141-30	CAM FOLLOWER
36S	1183051	36S-80ST	CLICK BUTTON CAP	142	1184663	142-50	CAM FOLLOWER PIN (2 REQ.)
38	1183134	38-7 (38N-7)	COUPLING PLATE SCREW (3 REQ.)	143	1184671	143-30	ADJUSTING SCREW
38A	1183173	38T-50	FRAME SCREW (2 REQ.)	144	1184685	144-50	PRESET KNOB
38B	1183174	38T-80	LONG QUADRANT SCREW	*	1184716	154-30	SHIM, SPOOL SHAFT
38C	1183157	38-710	CLICK BUSHING NUT	156	1184735	156-30T	DRAG COVER
41	1183325	41-50	L.S. BEARING SPRING	156A	1184751	156A-30	GASKET F/DRAG COVER
*	1183586	46A-704	CAM HOUSING SCREW	157	1184764	157-50	QUADRANT SPACER BUSHING (2 REQ.)
54	1183852	54-30T	HARNESS LUG (2 REQ.)	*** 161 - 162 see pg 3			
				173	1192386	173-30T	SPOOL BUSHING
				183	1184880	183-30TW	TUBE FRAME
				264	1185227	264-30T	STAND GASKET

MYSTIC REEL PARTS REVISION!

NOTE:

Many of www.mysticparts.com schematics include changes that were either made by Penn, or errors found and corrected by our parts dept.

MRP Ver 050920 (based on Penn's Rev 7, 7/2004)

* Not Shown

pg 2

30T and 30TW Plate Change and Clicker Redesign

KEY NO	PUREFISHING 7DIG#	PENN PART NO.	DESCRIPTION	KEY NO	PUREFISHING 7DIG#	PENN PART NO.	DESCRIPTION
<u>OLDER DESIGN</u>				<u>NEWER DESIGN</u>			
1	1180413	1-30T	RIGHT SIDE PLATE ASSEMBLY	1	1180414	1-30TN	RIGHT SIDE PLATE ASSEMBLY
*	---	3-30	BRIDGE				(BRIDGE NOW PART OF PLATE)
35	---	35-50	CLICK TONGUE	35	1182900	35-50N	CLICK TONGUE
36	---	36-50	CLICK BUTTON	36	1183047	36N-50	CLICK BUTTON
---	---	---	---	*	1183037	36C-50	CLICK BUTTON COMPLETE ASSEMBLY
39A	1183188	39-50	COVER SCREW (3 REQ.)	39A	1183244	39A-80S	COVER SCREW (3 REQ.)
				98	1184324	98-30TN	BRIDGE BUSHING

NOTES: Key 39A cover screws are a different length due to plate differences
 The 36C-50 click button assembly can be used on the older plates
 There are photos of the plates and clicker parts in the www.mysticparts.com website for comparison

7/32" diameter threaded head, 7/32" thinner stud 1 5/8" long				1/4" diameter threaded head, thicker stud			
34	1182787	34-30T	CLAMP SCREW (ONLY)	34	1182790	34-50T	CLAMP SCREW (ONLY)
34C	---	34C-30T	ROD CLAMP SCREW W/NUT	34C	1182864	34C-50T	ROD CLAMP SCREW W/NUT
152A	---	152A-30T	ROD CLAMP ACORN NUT (2 REQ.)	152A	1184713	152A-50T	ROD CLAMP ACORN NUT (2 REQ.)
also compatible parts from 10KG to older 30T							
??	34-975	COMPATIBLE TO		NOTE: PENN DID NOT CHANGE THE 183 FRAME NUMBERS			
1191645	34c-10KG	WHICH DIAMETER		TO REPRESENT THE DESIGN CHANGE OF THE STUDS			
??	149-45	OF STUD?????? ONLINE DOES NOT SAY		to THICKER = STURDIER, they just used the same part number			
				so if purchasing a frame, enquire about the stud holes			

161	1184788	161-50	LOCATING PIN BUSHING (2 REQ.)	161C	1184793	161C-70	LOCATING PIN ASSEMBLY (2 REQ)
162	1184795	162-50	LOCATING PIN SPRING (2 REQ.)				** replaces 161 and 162

<u>ORIGINAL HANDLE SETUP</u>				<u>NEWER SOFT GRIP HANDLE SETUP</u>			
24	n/a	24-30TW	HANDLE COMPLETE ERGO PLASTIC	24	1181970	24-N30TW	HANDLE COMPLETE SOFT GRIP KNOB
24A	1206000	24-30TW-1	HANDLE BLANK ONLY	24A	1206000	24-30TW-1	HANDLE BLANK ONLY
24C	1182091	24C-50	HANDLE KNOB CAP PLASTIC	24C	1191334	24C-50M	HANDLE KNOB CAP (RUBBER FOR ERGO)
25	1182103	25-50	HANDLE KNOB, PLASTIC	25	1191345	25-50M	HANDLE KNOB, SOFT GRIP, CHROME STUD
63A	1184056	63A-50	SCREW, LONG SCREW	25	1206009	25S-50M	HANDLE KNOB, SOFT GRIP, STAINLESS STUD
63B	1184046	63-50	SCREW, SHORT SCREW	63A		63A-50	SCREW, LONG SCREW
91	n/a	91-50	HANDLE RIVET	63B		63-50	SCREW, SHORT SCREW
				91	1184304	91N-50	HANDLE RIVET

20 AND 30 Internationals - Generations of Drag Design Changes

We put together this table to try and make clearer the design changes that have occurred in these drag systems over time

REEL #	1ST GEN		2ND GEN		3RD GEN	
	ASBESTOS WASHER	DRIVE PLATE	ASBESTOS WASHER/PLATE	DRIVE PLATE (CHANGED)	HT100 WASHER/PLATE	DRIVE PLATE
20	6-30	117-30	6/1-30	117-30	6/1-30	117-30
30	6-30	117-30	6/1-30	117-30	6/1-30	117-30
30T	6-30	117-80	6/1-30	117-30	6/1-30	117-30
30TW	6-30	117-80	6/1-30	117-30	6/1-30	117-30
30SW	6-30	117-80	6/1-30	117-30	6/1-50	117-30
	<p>The drive plate on this version was two pieces screwed together that the donut drag washer sat on.</p>		<p>This generation the drive plate became a flatter surface, the washer is on it's own plate and the two plates ride against each other.</p>		<p>Drag washer changed to HT100 material</p>	
REEL #	4TH GEN		5TH GEN		6TH GEN	
	HT100 WASHER/PLATE	DRIVE PLATE	HT100 WASHER ON DRIVE PLATE		DURA-DRAG WASHER ON DRIVE PLATE	
20	6A-30	117-30	117D-30		117DN-30	
30	6A-30	117-30	117D-30		117DN-30	
30T	6A-30	117-30	117D-30		117DN-30	
30TW	6A-30	117-30	117D-30		117DN-30	
30SW	6A-30	117-30	117D-30		117DN-30	
	<p>I suspect no actual change here except part number</p>		<p>Washer plate and drive plate now become one unit w/HT100 washer</p>		<p>Drag washer changed to Dura-Drag lubed material</p>	