

www.PENNparts.com

Scott's Bait & Tackle

Penn Parts Dept.  
945 Radio Road  
Tuckerton NJ 08087  
(609) 296-1300

No Minimum Order!  
Plus, Parts in stock  
that Penn doesn't  
carry anymore.

# Penn Schematic 245LD

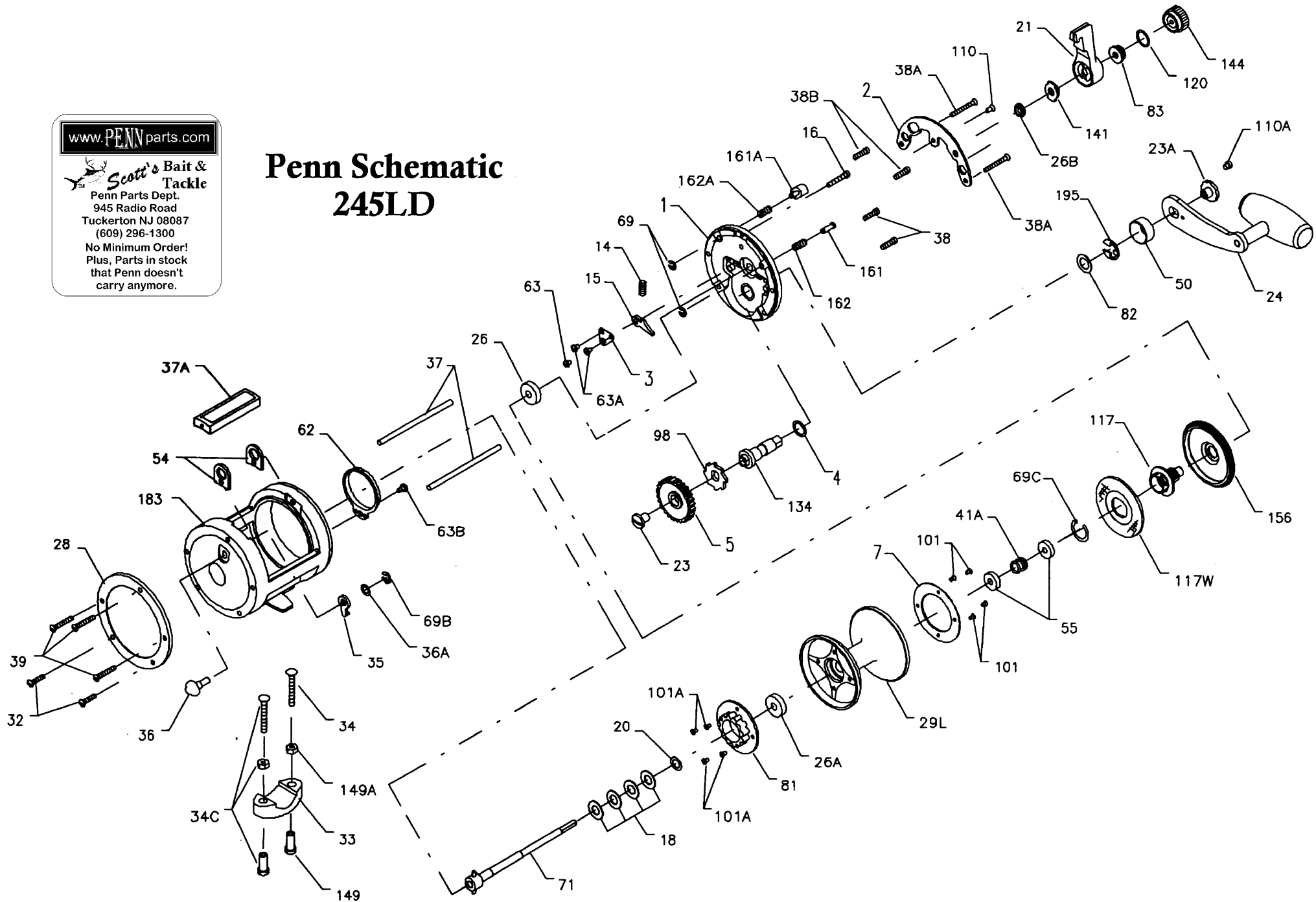

## Penn Reel Parts list for:

Model: 245LD

KEY PART			KEY PART		
NO	NO.	DESCRIPTION	NO	NO.	DESCRIPTION
1	1-245	RIGHT SIDE PLATE ASSEMBLY	50	50-40	GEAR STUD COVER
2	2-40	QUADRANT RING	54	54-113	HARNES LUG (2 REQ.)
3	3-40	DOG BRIDGE	55	55-6	R.S. SPOOL BAIL BEARING (2 REQ.)
4	4-40	GEAR STUD WASHER	62	62-40	CLICK SPRING
5	5-45	MAIN GEAR	63	63-349	LOWER DOG BRIDGE SCREW
7	7-40	METAL DRAG WASHER	63A	63-500S	UPPER DOG BRIDGE SCREW (2 REQ.)
14	14-40	DOG SPRING	63B	63-500S	CLICK SPRING SCREW
15	15-40	DOG	69	69B-50	RETAINING RING (2 REQ.)
16	16-9	TOP R.S. PLATE SCREW	69B	69B-600	CLICK BUTTON RETAINING RING
18	18-40	CLUTCH DISC SPRING	69C	69C-245	RETAINING RING
20	20-40	THRUST WASHER	71	71-40	SPINDLE SPOOL ASSEMBLY
21	21-245	DRAG LEVER ASSEMBLY	81	81-40	CLICK RATCHET
23	23-6CH	GEAR MOUNTING SCREW	82	82-40	HANDLE SHIM
23A	23-114	HANDLE SCREW ASSEMBLY	83	83-245	PRESET COLLAR
24	24-40P	HANDLE ASSEMBLY	98	98-40	MAIN GEAR RATCHET
26	26N-40	R.S. PLATE BALL BEARING	101	101-30	MAIN DRAG WASHER SCREW (4 REQ.)
26A	26-40	L.S. SPOOL BEARING	101A	101-30	CLICK RATCHET SCREW (4 REQ.)
26B	26-45	R.S. BUSHING	110	110-50	QUADRANT RING SCREW
28	28-40	LEFT SIDE RING	110A	110-60	HANDLE LOCK SCREW
29L	29L-245	SPOOL ASSEMBLY	117	117-245	DRIVE PLATE ASSEMBLY
32	32-310	LOWER L.S. RING SCREW (2 REQ.)	117W	117W-245	DRIVE PLATE WASHER
33	33-113	ROD CLAMP	120	120-245	O-RING
*	33R-200	RINGED ROD CLAMP	134	134-40	GEAR STUD
34	34-45	ROD CLAMP SCREW (2 REQ.)	141	141-245	LEVER CAM FOLLOWER
35	35-40	CLICK TONGUE	144	144-40	PRESET KNOB
36	36N-209	CLICK BUTTON	149	149-45	ROD CLAMP NUT (2 REQ.)
36A	36A-40	CLICK BUTTON WASHER	149A	149-200	HEX NUT (2 REQ.)
37	37-40	FRAME POST	156	156-245	DRAG COVER
37A	37A-245	TOP SPACER BAR	161	161-25	FREE SPOOL BUTTON SPRING
38	39-5	LOWER R.S. PLATE SCREW (2 REQ.)	161A	161-40	STRIKE BUTTON ASSEMBLY
38A	38-40	R.S. POST SCREW (2 REQ.)	162	162-50	FREE SPOOL BUTTON SPRING
38B	32-22	UPPER R.S. PLATE SCREW (2 REQ.)	162A	162-50	STRIKE BUTTON SPRING
39	39-9	L.S. POST SCREW (3 REQ.)	183	183-245	FRAME ASSEMBLY
41A	41A-45	BEARING SPRING	195	195-40	GEAR STUD RETAINING RING

\*NOT SHOWN

NOTE: Many of [www.pennparts.com](http://www.pennparts.com) schematics include changes that were either made by Penn, or errors found and corrected by our parts dept.