

Design Change!
See notes on page 3
about these part numbers

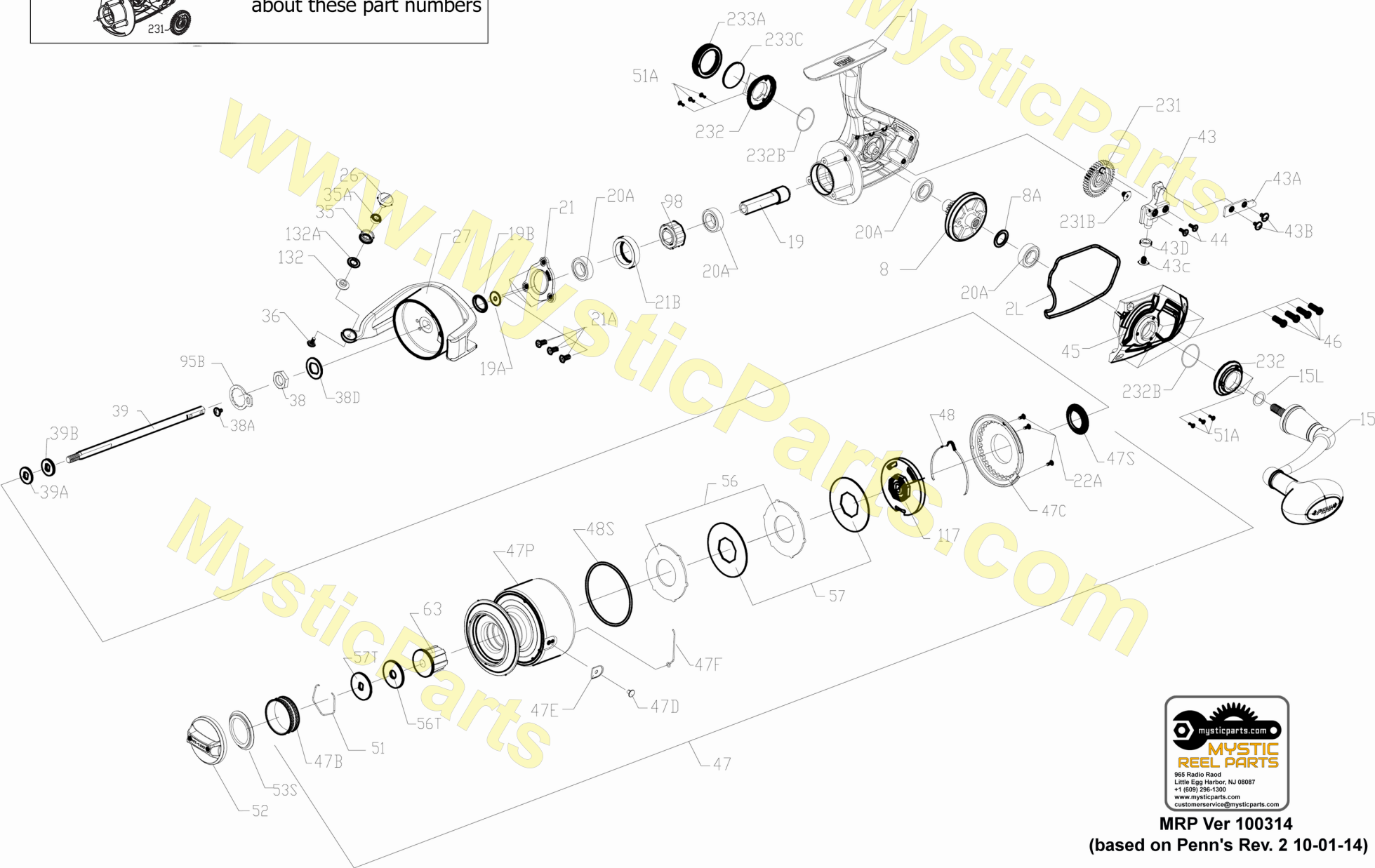

PARTS LIST FOR MODEL SSV6500BLS

1292946



MRP Ver 100314

(based on Penn's Rev. 2 10-01-14)

Penn Reel Parts list for Model: SSV6500BLS Spinfisher V Bail-less

KEY NO	PUREFISHING NO.	PENN PART NO.	DESCRIPTION	KEY NO	PUREFISHING NO.	PENN PART NO.	DESCRIPTION
1	see page 3			46	1277074	46-SSV5500	HOUSING / BODY COVER SCREW (4 REQUIRED)
2L	1277035	2L-SSV5500	HOUSING BODY SEAL	47	1314300	47-SSV6500BLS	SPOOL ASSEMBLY
8	1277036	8-SSV5500	MAIN DRIVE GEAR	47B	1277076	47B-SSV5500	SPOOL BAND
8A	1277037	8A-SSV5500	DRIVE GEAR SHIM WASHER (USES 1 OR 2)	47C	1277077	47C-SSV5500	DRAG COVER
15	1277038	15-SSV5500	HANDLE ASSEMBLY	47D	1277078	47D-SSV5500	LINE CLIP
15L	1292783	15L-SSV5500	HANDLE SEAL	47E	1277079	47E-SSV5500	LINE CLIP BUSHING
19	1277041	19-SSV5500	PINION GEAR	47F	1277112	47F-SSV6500	LINE CLIP RETAINER
19A	1314711	19A-SSV6500BLS	PINION GEAR WASHER	47P	1314301	47P-SSV6500BLS	SPOOL, BARE
19B	1313704	19B-SSV6500BLS	PINION GEAR SEAL	47S	1277082	47S-SSV5500	DRAG COVER / DRIVE PLATE SEAL
20	see page 3			48	1277083	48-SSV5500	SPOOL CLICKER
21	1313705	21-SSV6500BLS	PINION BEARING RETAINER	48S	1277084	48S-SSV5500	DRAG COVER SEAL
21A	1277044	21A-SSV5500	PINION RETAINER SCREW (3 REQUIRED)	51	1277085	51-SSV5500	DRAG WASHER RETAINING RING
21B	1277045	21B-SSV5500	PINION BALL BEARING COLLAR	51A	1277086	51A-SSV5500	BEARING RETAINER SCREW (6 REQUIRED)
22A	1277047	22A-SSV5500	DRAG COVER SCREW (3 REQUIRED)	52	1277114	52-SSV6500	DRAG KNOB ASSEMBLY
26	1313706	26-SSV6500BLS	LINE SLIDER	53S	1293252	53S-SSV5500	DRAG KNOB SEAL
27	1313707	27-SSV6500BLS	ROTOR	56	1277088	56-SSV5500	DRAG FRICTION WASHER HT100 (2 REQUIRED)
35	1313708	35-SSV6500BLS	LINE ROLLER	56T	1277089	56T-SSV5500	DRAG FRICTION WASHER HT100
35A	1277060	35A-SSV5500	LINE ROLLER BALL BEARING	57	1277090	57-SSV5500	KEYED METAL DRAG WASHER (2 REQUIRED)
36	1277061	36-SSV5500	LINE ROLLER SCREW	57T	1277091	57T-SSV5500	KEYED METAL DRAG WASHER
38	1277062	38-SSV5500	ROTOR NUT	63	1277092	63-SSV5500	SPOOL BUSHING
38A	1277063	38A-SSV5500	ROTOR NUT LOCK PLATE SCREW (3 REQUIRED)	95B	1277093	95B-SSV5500	ROTOR NUT LOCKING PLATE
38D	1277064	38D-SSV5500	ROTOR WASHER	98	1277094	98-SSV5500	CLUTCH / SLEEVE ASSEMBLY
39	1277065	39-SSV5500	MAIN SPOOL SHAFT	117	1277095	117-SSV5500	DRAG DRIVE PLATE
39A	1277066	39A-SSV5500	SPOOL ADJUST WASHER (USES 1 OR 2)	132	1277096	132-SSV5500	LINE ROLLER COLLAR
39B	1277067	39B-SSV5500	MAIN SHAFT WASHER	132A	1277097	132A-SSV5500	LINE ROLLER WASHER
43	1277068	43-SSV5500	OSCILLATION SLIDER (CROSSWIND BLOCK)	231	see page 3		
43A	1277069	43A-SSV5500	OSCILLATION SLIDER GUIDE (CROSSWIND PLATE)	231B	1277100	231B-SSV5500	CROSSWIND OSCILLATION GEAR SCREW
43B	1277070	43B-SSV5500	CROSSWIND OSCILLATION SLIDER GUIDE SCREW (2 REQUIRE	232	1277115	232-SSV6500	BEARING RETAINER (2 REQUIRED)
43C	1277071	43C-SSV5500	CROSSWIND OSCILLATION SLIDER BUSHING SCREW	232B	1302502	232B-SSV3500	BEARING RETAINER O-RING (2 REQUIRED)
43D	1279457	43D-SSV3500	CROSSWIND OSCILLATION SLIDER BUSHING	233A	1277103	233A-SSV5500	HANDLE CAP
44	1277072	44-SSV5500	MAIN SHAFT SCREW (2 REQUIRED)	233C	1277104	233C-SSV5500	HANDLE CAP WASHER
45	see page 3						

MYSTIC REEL PARTS REVISION!

NOTE:

Many of www.mysticparts.com schematics include changes that were either made by Penn, or errors found and corrected by our parts dept.

MRP Ver 100314 (Based on Penn's Rev. 2, 10-01-14)

REV 1. Bearing number changes				REV. 2 Bearings			
20A	1277042	20A-SSV5500	BALL BEARING (4 REQUIRED)	20	1308090	20-CFT5000	BALL BEARING (2 REQUIRED)
				20A	1277042	20A-SSV5500	BALL BEARING (2 REQUIRED)
We are assuming there were errors with the bearing part numbers on the schematic, rather than that they actually changed the bearings.				RECOMMEND TO USE THE REVISION 4 NUMBERS			

*****Design change after first run				1	1313703	1-SSV6500BLS	HOUSING, BODY ASSEMBLY with .23 peg
Early SSV6500BLS run had a slightly different housing and crosswind gear				231	1277098	231-SSV5500	CROSSWIND OSCILLATION GEAR 0.23" I.D.
The diameter of the hole in the crosswind was almost 3/8". Later runs, the crosswind gear and the pin in the housing that it sits on must have been changed.				45	1314299	45-SSV6500BLS	HOUSING / BODY COVER
The current gear I.D. is .23" just under 1/4", current housing matches it.				1	n/a	1-SSV6500BLS	HOUSING, BODY ASSEMBLY with .309 peg
Current = Pennparts.com inventory from Penn as of 10/3/14				231	n/a	231-SSV6500LL	CROSSWIND OSCILLATION GEAR 1st run 0.309" I.D.
				45	n/a	45-SSV6500BLS	HOUSING / BODY COVER