

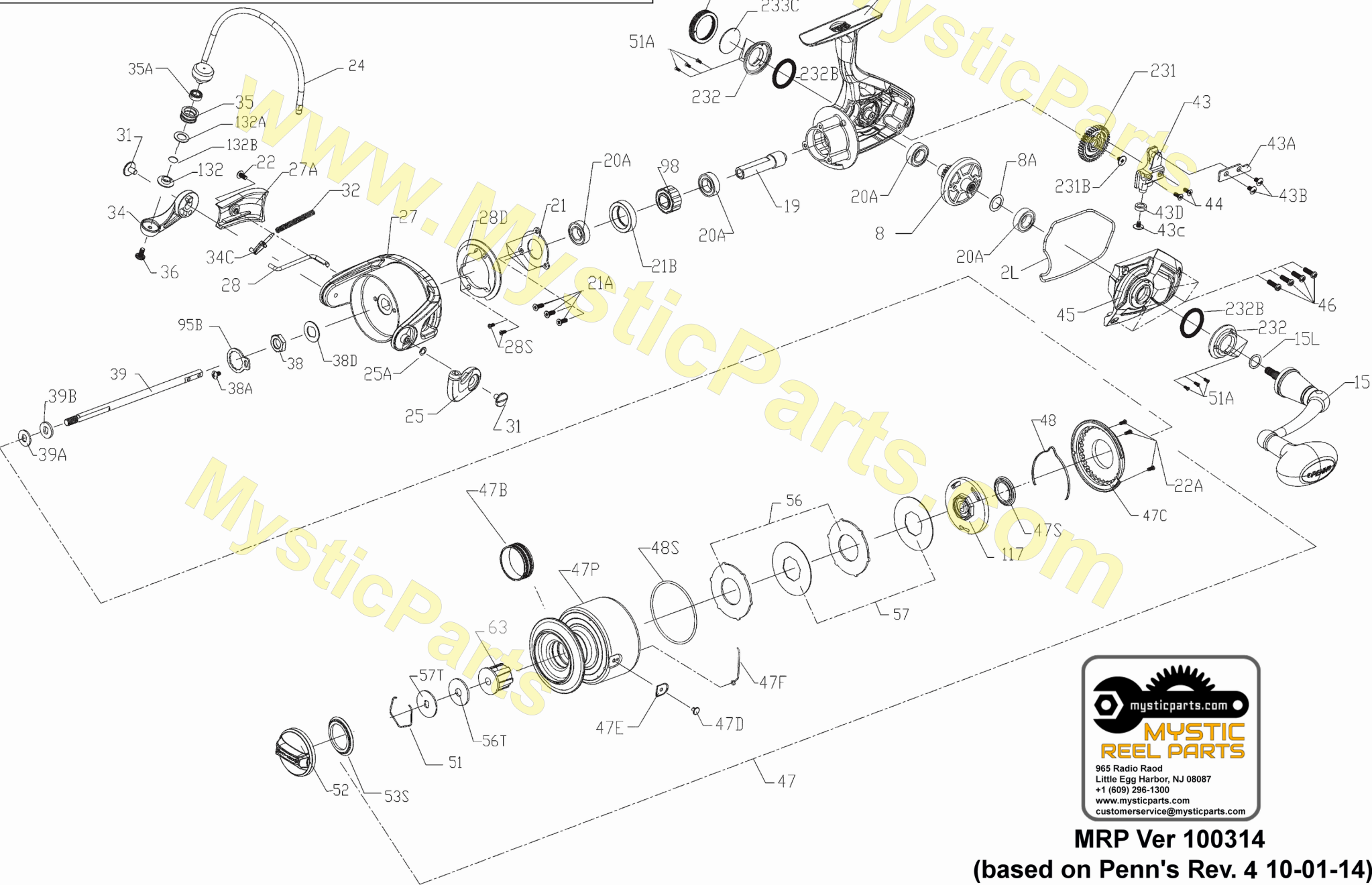

PARTS LIST FOR MODEL SSV5500

Design Change!
See notes on page 3
about these part numbers

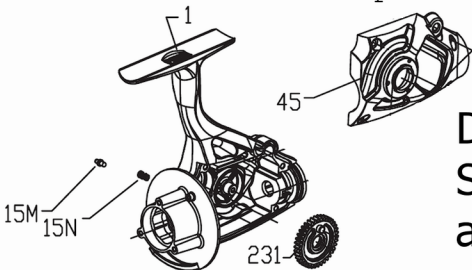

MRP Ver 100314
(based on Penn's Rev. 4 10-01-14)

Penn Reel Parts list for Model: SSV5500 Spinfisher V

KEY NO	PUREFISHING NO.	PENN PART NO.	DESCRIPTION	KEY NO	PUREFISHING NO.	PENN PART NO.	DESCRIPTION
1	see page 3			43C	1277071	43C-SSV5500	CROSSWIND OSCILLATION SLIDER BUSHING SCREW
2L	1277035	2L-SSV5500	HOUSING BODY SEAL	43D	1279457	43D-SSV3500	CROSSWIND OSCILLATION SLIDER BUSHING
8	1277036	8-SSV5500	MAIN DRIVE GEAR	44	1277072	44-SSV5500	MAIN SHAFT SCREW (2 REQUIRED)
8A	1277037	8A-SSV5500	DRIVE GEAR SHIM WASHER (USES 1 OR 2)	45	see page 3		
15	1277038	15-SSV5500	HANDLE ASSEMBLY	46	1277074	46-SSV5500	HOUSING / BODY COVER SCREW (4 REQUIRED)
15L	1292783	15L-SSV5500	HANDLE SEAL	47	1277075	47-SSV5500	SPOOL ASSEMBLY
19	1277041	19-SSV5500	PINION GEAR	47B	1277076	47B-SSV5500	SPOOL BAND
20, 20A	see page 3			47C	1277077	47C-SSV5500	DRAG COVER
21	1277043	21-SSV5500	PINION BEARING RETAINER	47D	1277078	47D-SSV5500	LINE CLIP
21A	1277044	21A-SSV5500	PINION RETAINER SCREW (3 REQUIRED)	47E	1277079	47E-SSV5500	LINE CLIP BUSHING
21B	1277045	21B-SSV5500	PINION BALL BEARING COLLAR	47F	1277080	47F-SSV5500	LINE CLIP RETAINER
22	1277046	22-SSV5500	ROTOR COVER SCREW	47P	1277081	47P-SSV5500	SPOOL, BARE
22A	1277047	22A-SSV5500	DRAG COVER SCREW (3 REQUIRED)	47S	1277082	47S-SSV5500	DRAG COVER / DRIVE PLATE SEAL
24	1277048	24-SSV5500	BAIL ASSEMBLY	48	1277083	48-SSV5500	SPOOL CLICKER
25	1277049	25-SSV5500	BAIL HOLDER (BAIL CAM)	48S	1277084	48S-SSV5500	DRAG COVER SEAL
25A	??	25A-SSV5500	SHIM	51	1277085	51-SSV5500	DRAG WASHER RETAINING RING
27	1277050	27-SSV5500	ROTOR	51A	1277086	51A-SSV5500	BEARING RETAINER SCREW (6 REQUIRED)
27A	1277051	27A-SSV5500	ROTOR COVER	52	1277087	52-SSV5500	DRAG KNOB ASSEMBLY
28	1277052	28-SSV5500	BAIL TRIP LEVER	53S	1293252	53S-SSV5500	DRAG KNOB SEAL
28D	1277053	28D-SSV5500	ROTOR BRAKE	56	1277088	56-SSV5500	DRAG FRICTION WASHER HT100 (2 REQUIRED)
28S	1277054	28S-SSV5500	ROTOR BRAKE SCREW (2 REQUIRED)	56T	1277089	56T-SSV5500	DRAG FRICTION WASHER HT100
31	1277055	31-SSV5500	BAIL ARM SCREW (2 REQUIRED)	57	1277090	57-SSV5500	KEYED METAL DRAG WASHER (2 REQUIRED)
32	1277056	32-SSV5500	BAIL SPRING	57T	1277091	57T-SSV5500	KEYED METAL DRAG WASHER
34	1277057	34-SSV5500	BAIL ARM	63	1277092	63-SSV5500	SPOOL BUSHING
34C	1277058	34C-SSV5500	PIVOT ARM	95B	1277093	95B-SSV5500	ROTOR NUT LOCKING PLATE
35	1277059	35-SSV5500	LINE ROLLER	98	1277094	98-SSV5500	CLUTCH / SLEEVE ASSEMBLY
35A	1277060	35A-SSV5500	LINE ROLLER BALL BEARING	117	1277095	117-SSV5500	DRAG DRIVE PLATE
36	1277061	36-SSV5500	LINE ROLLER SCREW	132	1277096	132-SSV5500	LINE ROLLER COLLAR
38	1277062	38-SSV5500	ROTOR NUT	132A	1277097	132A-SSV5500	LINE ROLLER WASHER
38A	1277063	38A-SSV5500	ROTOR NUT LOCK PLATE SCREW (3 REQUIRED)	132B	??	132B-SSV5500	SHIM (MAY NOT BE IN ALL REELS)
38D	1277064	38D-SSV5500	ROTOR WASHER	231	see page 3		
39	1277065	39-SSV5500	MAIN SPOOL SHAFT	231B	1277100	231B-SSV5500	CROSSWIND OSCILLATION GEAR SCREW
39A	1277066	39A-SSV5500	SPOOL ADJUST WASHER (USES 1 OR 2)	232	1277101	232-SSV5500	BEARING RETAINER (2 REQUIRED)
39B	1277067	39B-SSV5500	MAIN SHAFT WASHER	232B	1302502	233B-SSV3500	BEARING RETAINER O-RING (2 REQUIRED)
43	1277068	43-SSV5500	OSCILLATION SLIDER (CROSSWIND BLOCK)	233A	1277103	233A-SSV5500	HANDLE CAP
43A	1277069	43A-SSV5500	OSCILLATION SLIDER GUIDE (CROSSWIND PLATE)	233C	1277104	233C-SSV5500	HANDLE CAP WASHER
43B	1277070	43B-SSV5500	CROSSWIND OSCILLATION SLIDER GUIDE SCREW (2 REQUIRED)	?? = FOUND IN REEL BUT NOT ON PENN'S SCHEMATIC			

List of parts related to design changes is on page 3 of the schematic

MYSTIC REEL PARTS REVISION!

NOTE:

Many of www.mysticparts.com schematics include changes that were either made by Penn, or errors found and corrected by our parts dept.

MRP Ver 100314 (Based on Penn's Rev. 4, 10-01-14)

These parts below were removed by Rev 3, we are not yet sure why.

15M	1277039	15M-SSV5500	HANDLE CAP LOCK PIN (2 REQUIRED)
15N	1277040	15N-SSV5500	HANDLE CAP LOCK PIN SPRING (2 REQUIRED)

REV 3. Bearing number changes

20A 1277042 20A-SSV5500 BALL BEARING (4 REQUIRED)

We are assuming there were errors with the bearing part numbers on the schematic, rather than that they actually changed the bearings.

REV. 4 Bearings

20 1308090 20-CFT5000 BALL BEARING (2 REQUIRED)
20A 1277042 20A-SSV5500 BALL BEARING (2 REQUIRED)

RECOMMEND TO USE THE REVISION 4 NUMBERS

*****Design change after first run

Early SSV5500 run had a slightly different housing and crosswind gear
The diameter of the hole in the crosswind was almost 3/8". Later runs, the crosswind gear and the pin in the housing that it sits on must have been changed.
The current gear I.D. is .23" just under 1/4", current housing matches it.

Current = Pennparts.com inventory from Penn as of 10/3/14

1	1277034	1-SSV5500	HOUSING, BODY ASSEMBLY
231	1277098	231-SSV5500	CROSSWIND OSCILLATION GEAR 0.23" I.D.
45	1277073	45-SSV5500	HOUSING / BODY COVER
1	n/a	1-SSV5500	HOUSING, BODY ASSEMBLY with .309 peg
231	n/a	231-SSV5500	CROSSWIND OSCILLATION GEAR 1st run 0.309" I.D.
45	n/a	45-SSV5500	HOUSING / BODY COVER