

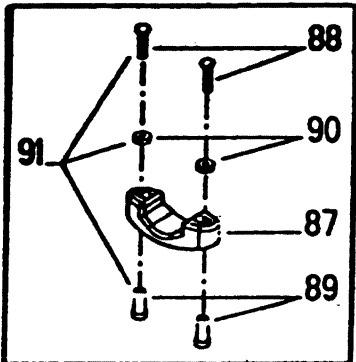

# PENN PARTS SCHEMATIC 895LC

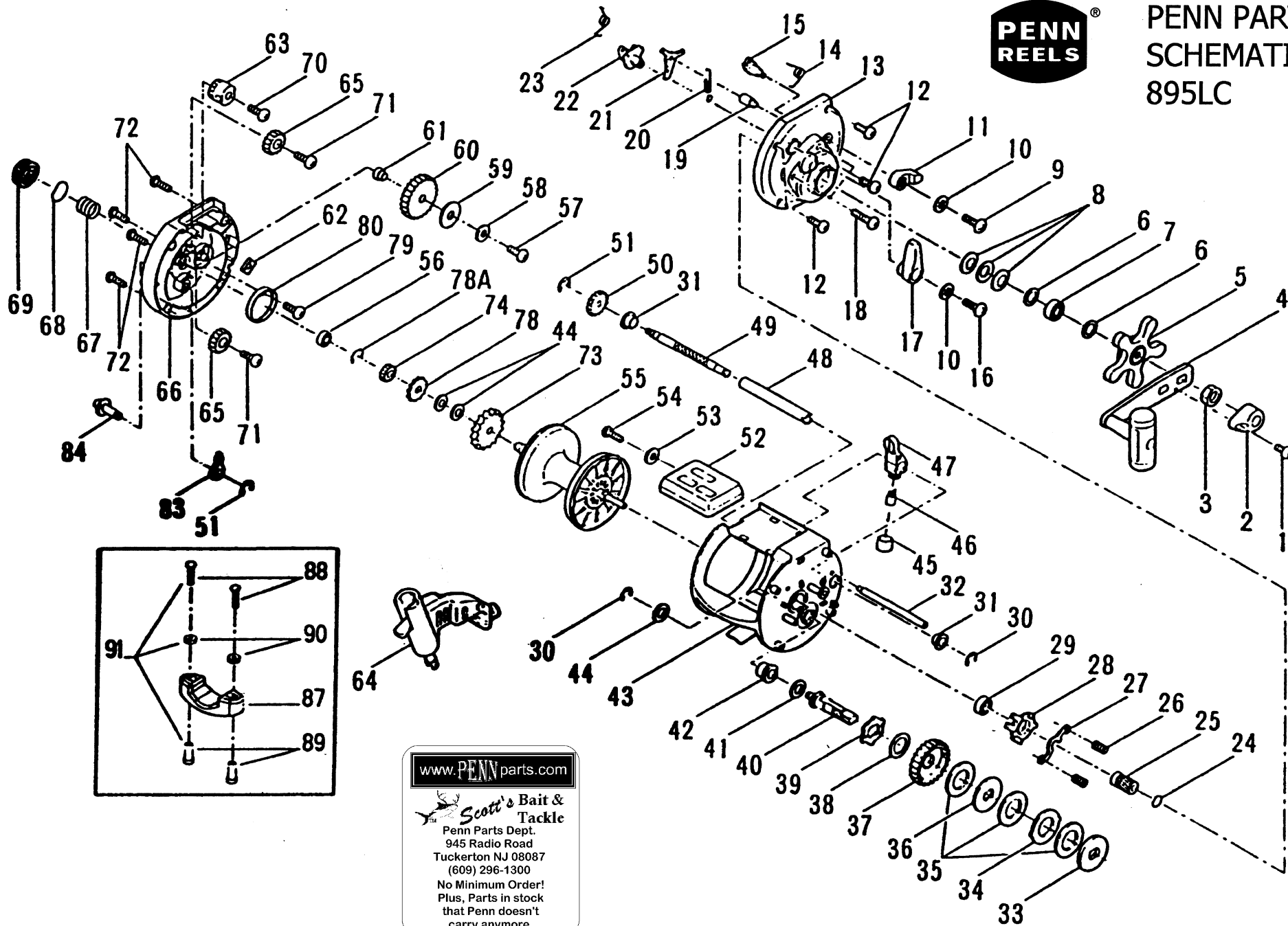

[www.PENNparts.com](http://www.PENNparts.com)  
Scott's Bait & Tackle  
Penn Parts Dept.  
945 Radio Road  
Tuckerton NJ 08087  
(609) 296-1300  
No Minimum Order!  
Plus, Parts in stock  
that Penn doesn't  
carry anymore.

## Penn Reel Parts list for:

## Model: 895LC Reel w/Line Counter

| KEY PART<br>NO NO. | DESCRIPTION                 | KEY PART<br>NO NO. | DESCRIPTION               |
|--------------------|-----------------------------|--------------------|---------------------------|
| 1 32-875           | HANDLE LOCK SCREW           | 44 98C-895         | SPACING WASHERS (3 REQ.)  |
| 2 110A-895         | HANDLE NUT CAP              | 45 48-875          | PAWL COVER SCREW          |
| 3 23-895           | HANDLE NUT                  | 46 47-875          | PAWL                      |
| 4 24-895           | HANDLE ASSEMBLY             | 47 46-875          | LINE GUIDE                |
| 5 10-895           | DRAG STAR ASSEMBLY          | 48 50-895          | WORM SHAFT SHEILD         |
| 6 9-895            | SPACING WASHERS (2 REQ.)    | 49 42-895          | WORM SHAFT                |
| 7 26-895           | R.S. PLATE BEARING          | 50 45-895          | WORM GEAR                 |
| 8 8A-895           | DISC SPRINGS (3 REQ.)       | 51 42B-875         | RETAINING RINGS (2 REQ.)  |
| 9 22-875           | ECCENTRIC SCREW             | *52 303-895        | CONTROL BOX ASM. (FEET)   |
| 10 22A-875         | ECCENTRIC WASHERS (2 REQ.)  | *52 303-895M       | CONTROL BOX ASM. (METRIC) |
| 11 21A-895         | DIRECT DRIVE LEVER          | 53 304-875         | FLAT WASHER               |
| 12 39A-895         | MOUNTING SCREWS (3 REQ.)    | 54 305-875         | CONTROL BOX SCREW         |
| 13 1-895           | R.S. PLATE                  | 55 29-895          | SPOOL ASSEMBLY            |
| 14 104-895         | DIRECT DRIVE SPRING         | 56 55A-875         | L.S. SPOOL BEARING        |
| 15 19C-895         | DIRECT DRIVE ECCENTRIC      | 57 39B-875         | MOUNTING SCREW            |
| 16 22-875          | ECCENTRIC SCREW             | 58 304A-875        | FLAT WASHER               |
| 17 21-895          | ECCENTRIC LEVER             | 59 64A-895         | IDLER SPACER              |
| 18 39B-895         | MOUNTING SCREW              | 60 64-895          | IDLER GEAR                |
| 19 158-895         | RATCHET DOG PIN             | 61 64B-895         | IDLER GEAR BUSHING        |
| 20 14-895          | RATCHET DOG SPRING          | 62 96-875          | LINE STORAGE CLIP         |
| 21 15-895          | RATCHET DOG                 | 63 306-895         | CONTROL BOX GEAR          |
| 22 19-895          | ECCENTRIC                   | 64 302-875         | DOGEY WHEEL ASSEMBLY      |
| 23 20-895          | ECCENTRIC SPRING            | 65 306A-895        | IDLER GEAR (2 REQ.)       |
| 24 40-895          | THRUST WASHER               | 66 27-895          | L.S. PLATE                |
| 25 13-895          | PINION GEAR ASSEMBLY        | 67 41-875          | L.S. BEARING SPRING       |
| 26 18-875          | CLUTCH SPRINGS (2 REQ.)     | 68 41C-875         | THRUST WASHER             |
| 27 12-895          | PINION YOKE                 | 69 40A-875         | L.S. BEARING CAP          |
| 28 11-895          | ECCENTRIC JACK              | 70 39C-895         | MOUNTING SCREW            |
| 29 55-895          | R.S. SPOOL BEARING          | 71 63B-875         | MOUNTING SCREWS (2 REQ.)  |
| 30 98D-875         | RETAINING RIGNS (2 REQ.)    | 72 39-895          | MOUNTING SCREWS (4 REQ.)  |
| 31 43-895          | WORM BEARINGS (2 REQ.)      | 73 66A-895         | SPOOL GEAR A              |
| 32 58-895          | LINE GUIDE                  | 74 66B-895         | SPOOL GEAR B              |
| 33 86-895          | METAL DRAG WASHER           | 78 81-895          | CLICK RATCHET             |
| 34 7-895           | EAR DRAG WASHER             | 78A 67-875         | RETAINING RING            |
| 35 6-895           | DRAG WASHER HT-100 (3 REQ.) | 79 63A-875         | MOUNTING SCREW            |
| 36 86A-895         | METAL DRAG WASHER           | 80 62-875          | CLICK SPRING              |
| 37 5-895           | MAIN GEAR                   | 83 35-875          | CLICK TONGUE              |
| 38 4-895           | FIBER WASHER                | 84 36-875          | CLICK BUTTON              |
| 39 98R-895         | RATCHET ASSEMBLY            | 87 33-113          | ROD CLAMP                 |
| 40 98S-895         | GEAR STUD                   | 88 34-45           | CLAMP SCREWS (2 REQ.)     |
| 41 98A-895         | GEAR STUD WASHER            | 89 149-45          | ROD CLAMP NUTS (2 REQ.)   |
| 42 98B-895         | GEAR STUD BEARING           | 90 149-200         | HEX NUTS (2 REQ.)         |
| 43 183-895         | FRAME ASSEMBLY              | 91 34C-45          | ROD CLAMP SCREW W/ NUTS   |

\* Order Control Box in "Feet" or "Metric" according to model

NOTE: Many of [www.pennparts.com](http://www.pennparts.com) schematics include changes that were either made by Penn, or errors found and corrected by our parts dept.

The 303B-875 battery is confirmed to be a Panasonic CR2032.

### QUICK INSTALLATION INSTRUCTIONS:

Remove the handle side of the reel and slide out the spool.

There is one screw and a flat washer holding the control box on one side of it, remove these.

Push the control box sideways to slide it off of the frame.

Turn the box upside down, and remove the 6 screws to access the battery.

THE PANASONIC CR2032 BATTERY CAN BE FOUND AT MOST PHARMACIES.