

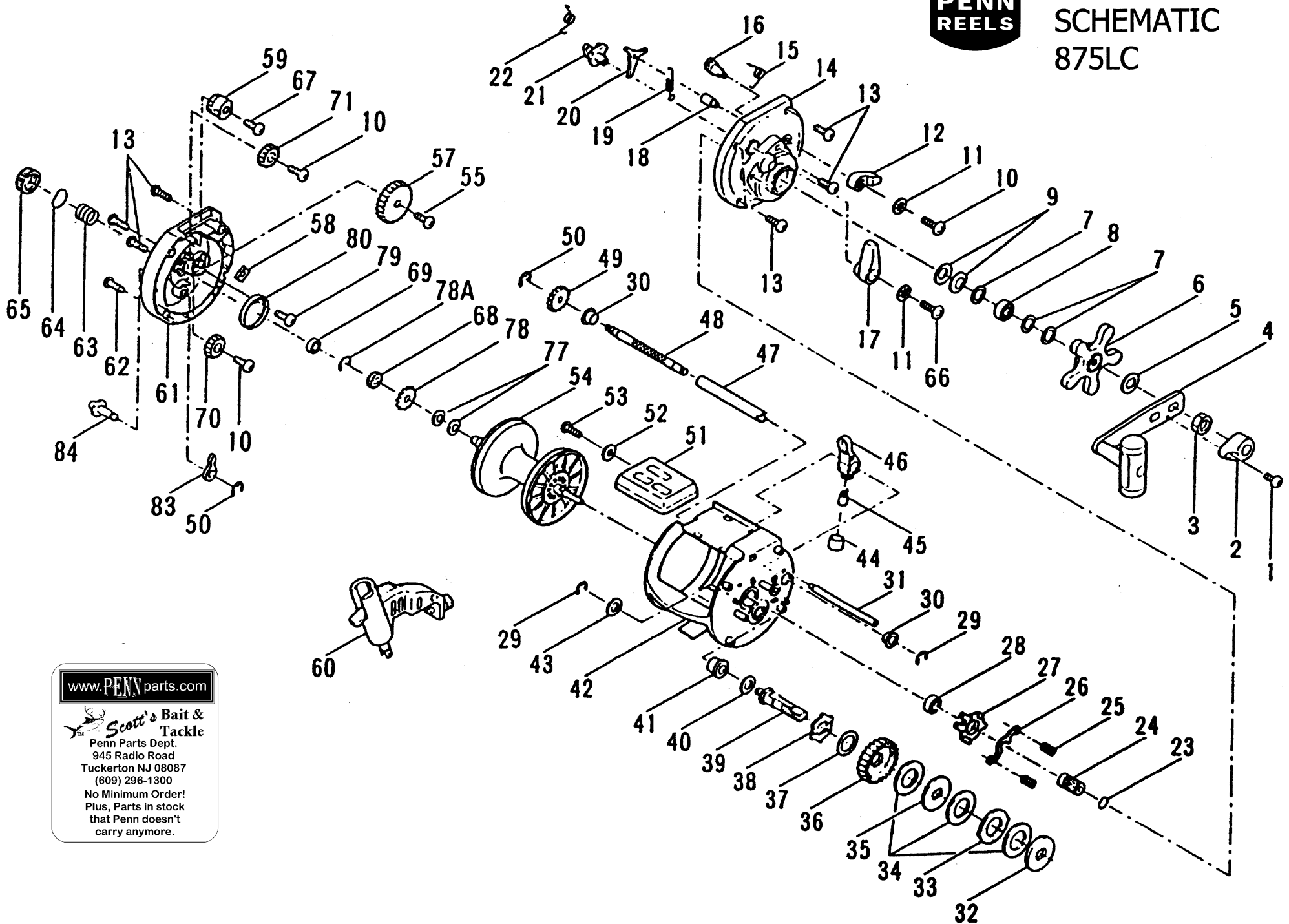

PENN PARTS SCHEMATIC 875LC



www.PENNparts.com

Scott's Bait & Tackle

Penn Parts Dept.
945 Radio Road
Tuckerton NJ 08087
(609) 296-1300

No Minimum Order!
Plus, Parts in stock
that Penn doesn't
carry anymore.

Penn Reel Parts list for:

Model: 875LC Reel w/Line Counter

KEY PART			KEY PART		
NO	NO.	DESCRIPTION	NO	NO.	DESCRIPTION
1	32-875	HANDLE LOCK SCREW	40	98A-875	GEAR STUD WASHER
2	110A-875	HANDLE NUT CAP	41	98B-875	GEAR STUD BEARING
3	23-875	HANDLE NUT	42	183-875	FRAME
4	24-875	HANDLE ASSEMBLY	43	98C-875	GEAR STUD WASHER
5	8-875	THRUST WASHER	44	48-875	PAWL COVER SCREW
6	10-875	DRAG STAR ASSEMBLY	45	47-875	PAWL
7	9-875	SPACING WASHERS (3 REQ.)	46	46-875	LINE GUIDE
8	20-722	R.S. PLATE BEARING	47	50-875	WORM SHAFT SHEILD
9	8A-875	DISC SPRINGS (2 REQ.)	48	42-875	WORM SHAFT
10	22-875	MOUNTING SCREWS (3 REQ.)	49	45-875	WORM SHAFT GEAR
11	22A-875	ECCENTRIC WASHERS (2 REQ.)	50	42B-875	RETAINING RINGS (2 REQ.)
12	21A-875	DIRECT DRIVE	*51	303-875	CONTROL BOX ASM. (FEET)
13	39A-875	MOUNTING SCREW	*51	303-875M	CONTROL BOX ASM. (METRIC)
14	1-875	R.S. PLATE	52	304-875	FLAT WASHER
15	104-875	DIRECT DRIVE SPRING	53	305-875	CONTROL BOX SCREW
16	19C-875	DIRECT DRIVE ECCENTRIC	54	29-875	SPOOL ASSEMBLY
17	21-875	ECCENTRIC LEVER	55	39B-875	MOUNTING SCREW
18	158-875	DOG PIN	57	64-875	IDLER GEAR
19	14-875	DOG SPRING	58	96-875	LINE STORAGE CLIP
20	15-875	DOG	59	306-875	CONTROL BOX GEAR
21	19-875	ECCENTRIC	60	302-875	BOGEY WHEEL ASSEMBLY
22	20-875	ECCENTRIC SPRING	61	27-875	L.S. PLATE
23	40-875	THRUST WASHER	62	39-875	MOUNTING SCREW
24	13-875	PINION GEAR	63	41-875	L.S. BEARING SPRING
25	18-875	CLUTCH SPRING (2 REQ.)	64	41C-875	THRUST WASHER
26	12-875	PINION YOKE	65	40A-875	L.S. BEARING CAP
27	11-875	ECCENTRIC JACK	66	63B-875	ECCENTRIC SCREW
28	55-875	SPOOL BEARING	67	63-875	GEAR MOUNTING SCREW
29	98D-875	RETAINING RINGS (2 REQ.)	68	66-875	SPOOL GEAR
30	43-875	WORM BEARINGS (2 REQ.)	69	55A-875	SPOOL BALL BEARING
31	58-875	LINE GUIDE POST	70	64A-875	IDLER GEAR A
32	86-875	METAL DRAG WASHER	71	64B-875	IDLER GEAR B
33	7-875	EAR DRAG WASHER	77	81A-875	CLICK RATCHET SPACERS (2 REQ.)
34	6-875	DRAG WASHER HT-100 (3 REQ.)	78	81-875	CLICK RATCHET
35	86A-875	METAL DRAG WASHER	78A	67-875	RETAINING RING
36	5-875	MAIN GEAR	79	63A-875	MOUNTING SCREW
37	4-875	FIBRE WASHER	80	62-875	CLICK SPRING
38	98R-875	RATCHET ASSEMBLY	83	35-875	CLICK TONGUE
39	98S-875	GEAR STUD	84	36-875	CLICK BUTTON

* Order Control Box in "Feet" or "Metric" according to model

NOTE: Many of www.pennparts.com schematics include changes that were either made by Penn, or errors found and corrected by our parts dept.

The 303B-875 battery is confirmed to be a Panasonic CR2032.

QUICK INSTALLATION INSTRUCTIONS:

Remove the handle side of the reel and slide out the spool.

There is one screw and a flat washer holding the control box on one side of it, remove these.

Push the control box sideways to slide it off of the frame.

Turn the box upside down, and remove the 6 screws to access the battery.

THE PANASONIC CR2032 BATTERY CAN BE FOUND AT MOST PHARMACIES.