

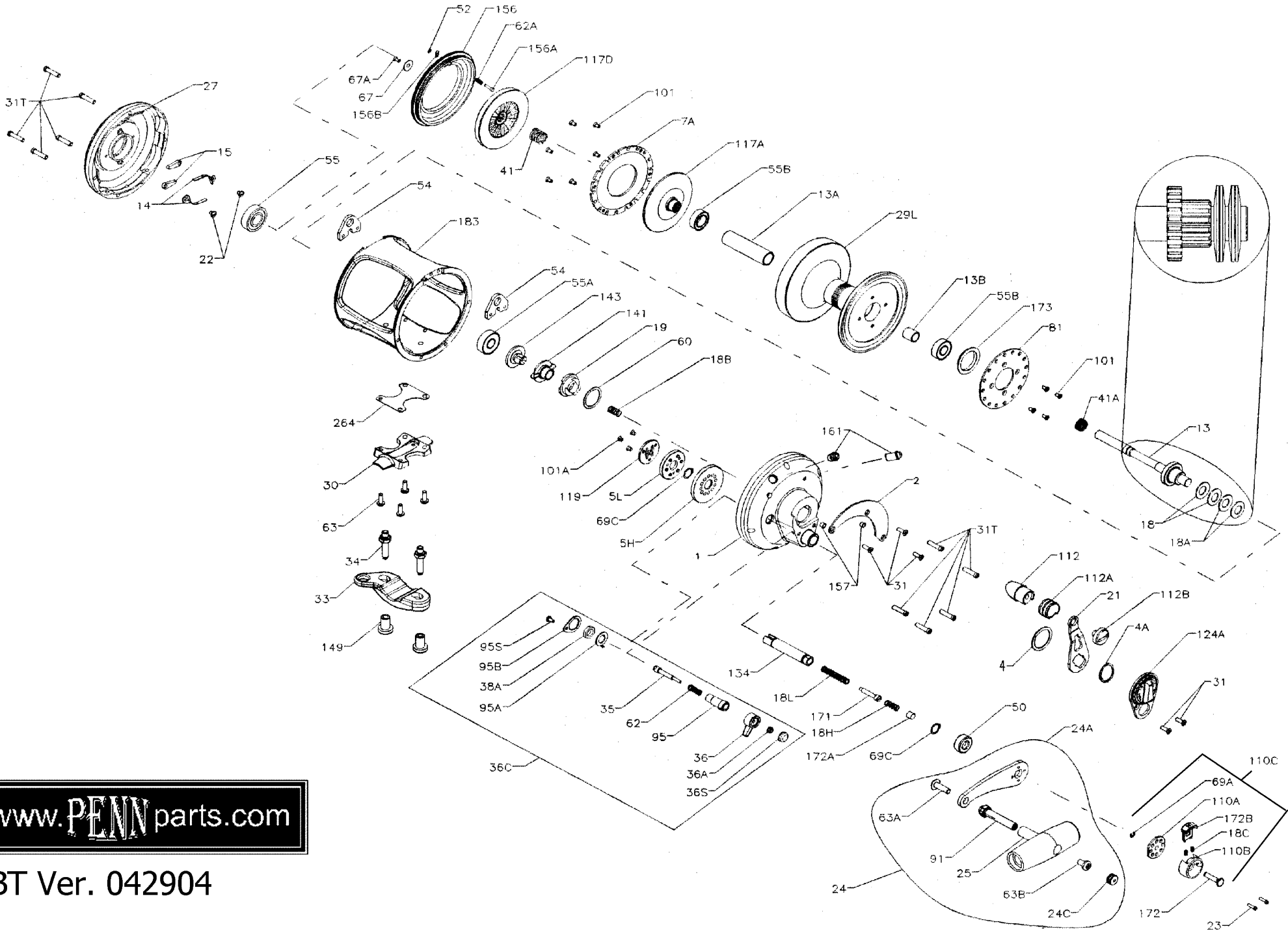

# PARTS LIST FOR MODEL 50VSW 2003 First Run models - Rev. 1



[www.PENNparts.com](http://www.PENNparts.com)

SBT Ver. 042904

## Penn Reel Parts list for:

## Model: 50VSW 2003 Models and older

KEY PART			KEY PART		
NO	NO.	DESCRIPTION	NO	NO.	DESCRIPTION
1	1-50VS	RIGHT SIDE PLATE ASSEMBLY	63	63-30T	STAND SCREWS (4 REQ.)
2	2-50VS	QUADRANT RING	63A	63A-50	SCREW
4	4-70	CAM THRUST WASHER	63B	63-50	SCREW
4A	4A-70	CAM TEFLON WASHER	67	67-70	PINION GEAR WASHER
5H	5-50VS-HS	MAIN GEAR HIGH-SPEED	67A	67A-70	RETAINING SCREW
5L	5-50VS-LS	MAIN GEAR LOW-SPEED	69	69-50	LOCATING PIN (2 REQ.)
7A	7A-50VS	METAL DRAG WASHER	69A	69B-30S	RETAINING RING
13	13-50	PINION GEAR	69B	69B-50	RETAINING RING (2 REQ.)
13B	13B-70	PINION GEAR SLEEVE	69C	69C-30S	RETAINING RING (2 REQ.)
13C	13C-50VS	RETAINING RING	81	81-50	RATCHET
14	14-50	DOG SPRING (2 REQ.)	88	88-70	PRESET KNOB BALL
15	15-50	DOG (2 REQ.)	88A	18C-15KG	PRESET KNOB SPRING
18	18-50TW	DISC CLUTCH SPRING (4 REQ.)	91	91N-50	HANDLE RIVET
18C	18C-15KG	SHIFT BUTTON SPRING (2 REQ.)	95	95-70	CLICK TONGUE BUSHING
18H	18H-15KG	SHIFT SPRING (HEAVY)	95A	95B-70	RETAING PLATE
18L	18L-15KG	SHIFT SPRING (LIGHT)	95C	95A-50	CLICK BUSHING WASHER
19	19-50VS	ECCENTRIC CAM	95S	46A-704	RETAINING PLATE SCREW
21	21-50VS	ECCENTRIC LEVER	101	101-30	RATCHET PLATE SCREW (11 REQ.)
22	22-109	DOG SPRING SCREW	101A	101-50S	COUPLING PLATE SCREW (3 REQ.)
23	23-15KG	HANDLE SCREW (2 REQ.)	110A	110A-15KG	HANDLE LOCKING PLATE
24	24-30S	HANDLE COMPLETE	110B	110B-15KG	SHIFT HOUSING
24C	24C-50	HANDLE KNOB CAP	112	112-70	ECCENTRIC LEVER KNOB
25	25-50	HANDLE KNOB	112A	112A-70	KNOB SLEEVE
27	27-50VS	L.S. PLATE ASSEMBLY	112B	112B-70	ECCENTRIC KNOB SCREW
29L	29L-50VSW	SPOOL	117A	117A-70	RETAINING PLATE W/DRAG WASHER
30	30-50T	STAND	117D	117D-70	DRIVE PLATE W/ DRAG WASHER
31	31T-70	SHORT SCREW (5 REQ.)	119	119-15KG	COUPLING PLATE
31T	31T-80	SIDE PLATE SCREW (10 REQ.)	124	124-50VS	BRIDGE COVER
33	33-70	ROD CLAMP	128	128-50S	LOW GEAR PINS (6 REQ.)
34	34-70	CLAMP SCREW (2 REQ.)	134	134-50VS	GEAR STUD
34C	34C-70	ROD CLAMP SCREW W/NUT	141	141-50VS	CAM FOLLOWER
35	35-70	CLICK TONGUE	143	143-50VS	PRESET SCREW
36	36-50	CLICK BUTTON	144	144-70	PRESET KNOB
36A	36-700	CLICK BUTTON NUT	149	149-70	ROD CLAMP NUT (2 REQ.)
36S	36S-80ST	CLICK BUTTON CAP	156	156-50VS	DRAG COVER
41	41-50	BEARING SPRING	157	157S-12LT	QUADRANT SPACER BUSHING (2 REQ.)
41A	41-70	DRAG SPRING	161	161-50	LOCATING PIN BUSHING (2 REQ.)
50	50N-30S	SHIELD	162	162-50	LOCATING PIN SPRING (2 REQ.)
54	54-50T	HARNES LUG (2 REQ.)	171	171-15KG	SHIFT PLUNGER
55	55-80	BALL BEARING	172	172-15KG	SHIFT BUTTON (LOW)
55A	55-50	BALL BEARING	172A	172A-50VS	SPRING SPACER
55B	55-80ST	BALL BEARING (2 REQ.)	172B	172B-15KG	SHIFT BUTTON (HIGH)
60	60-50	BACKING WASHER	183	183-50VSW	TUBE FRAME
62	62-50	CLICK SPRING	264	264-30T	STAND GASKET

NOTE: Many of [www.pennparts.com](http://www.pennparts.com) schematics include changes that were either made by Penn, or errors found and corrected by our parts dept.  
SBT Ver. 4/29/04

KEEP THIS JUST FOR REFERENCE - IT'S NOT ONLINE