

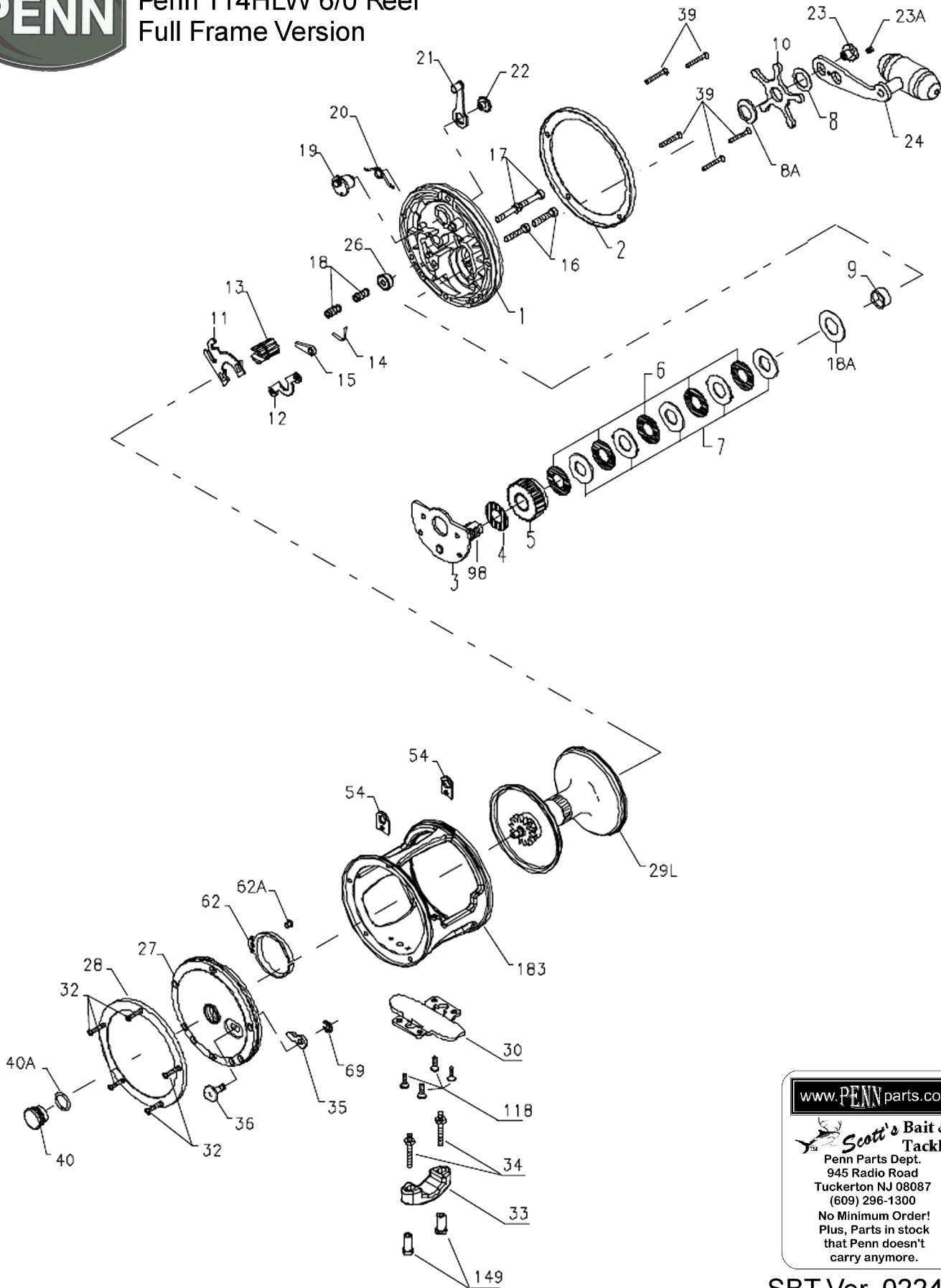

Penn 114HLW 6/0 Reel Full Frame Version



www.PENNparts.com

Scott's Bait & Tackle
Penn Parts Dept.
945 Radio Road
Tuckerton NJ 08087
(609) 296-1300
No Minimum Order!
Plus, Parts in stock
that Penn doesn't
carry anymore.

Penn Reel Parts list for Model: 114HLW w/full frame

KEY NO	PART NO.	DESCRIPTION	KEY NO	PART NO.	DESCRIPTION
1	1-114H	HANDLE SIDE PLATE	23	23-116	HANDLE SCREW
2	2N-114H	HANDLE SIDE RING	23A	110-60	HANDLE LOCK SCREW
3	3-114H	BRIDGE W/SLEEVE	24	24-57	HANDLE
4	4-115	FIBER WASHER	26	26-116	HANDLE SIDE BEARING
5	5-115	MAIN GEAR	27	27N-114H	NON-HANDLE SIDE PLATE
6	6-115	DRAG WASHER (5 REQUIRED)	28	2N-114	NON-HANDLE SIDE RING
7	7C-115	METAL DRAG WASHER SET	29	29L-114HLW	SPOOL
8	8-114	TENSION SPRING (SET OF 2)	30	30-114HL	STAND
8A	8-115	TENSION SPRING	32	32-21	NON-HANDLE SIDE SCREW (5 REQUIRED)
9	9-114H	SPACING SLEEVE	33	33-340	ROD CLAMP
10	10-114	STAR DRAG WHEEL	34	34-114HLW	ROD CLAMP SCREW (2 REQUIRED)
11	11-114	ECCENTRIC JACK	35	35-114	CLICK TONGUE
12	12-114	PINION YOKE	36	36-114H	CLICK BUTTON
13	13-114H	PINION	39	39-12	HANDLE SIDE PLATE SCREW (5 REQUIRED.)
14	14-114	DOG SPRING	40	40-114HL	NON-HANDLE SIDE BEARING
15	15-114H	DOG	40A	120-114H	NON-HANDLE SIDE BEARING O-RING
16	16-114	LOWER BRIDGE SCREW (2 REQUIRED.)	54	54-114	HARNESS LUG (2 REQUIRED.)
17	17-114	UPPER BRIDGE SCREW (2 REQUIRED.)	62	62-114	CLICK SPRING
18	18-114	CLUTCH SPRING (2 REQUIRED.)	62A	63-209	CLICK SPRING SCREW
18A	18-114H	SPRING DISK	69	69B-600	RETAINING RING
19	19-114	ECCENTRIC	98	98-114	GEAR SLEEVE
20	20-114	ECCENTRIC SPRING	118	118-80	STAND SCREWS (4 REQUIRED.)
21	21-114	ECCENTRIC LEVER	149	149-45	ROD CLAMP NUT (2 REQUIRED.)
22	23-60	ECCENTRIC SCREW	183	183-114HLW-T	FRAME

NOTE: Many of www.pennparts.com schematics include changes that were either made by Penn, or errors found and corrected by our parts dept.

SBT VER 101213

CHANGES: 33R-114 RINGED METAL CLAMP WAS REMOVED - DOES NOT FIT THIS VERSION