

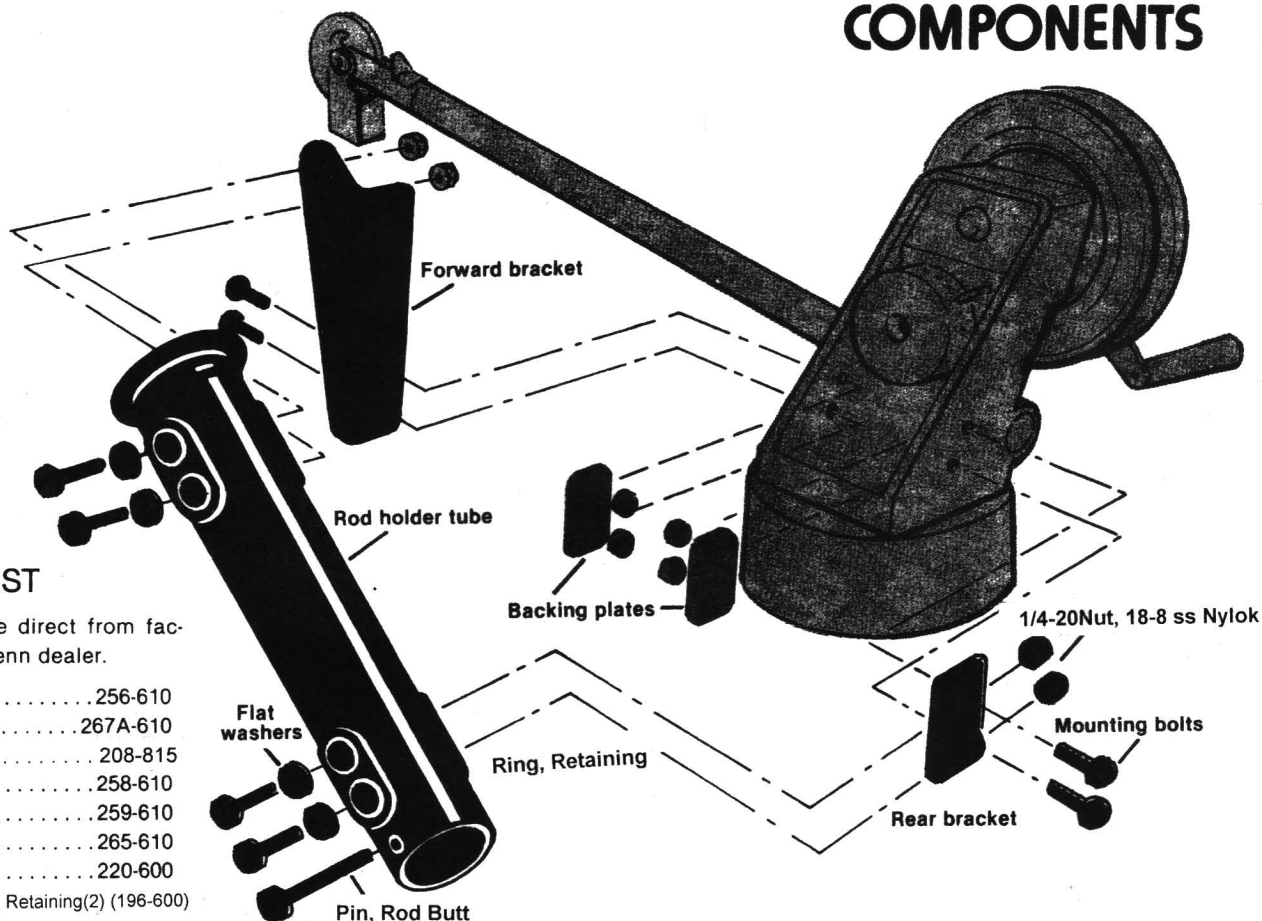

# ReadyStrike<sup>T.M.</sup> 610RH rod holder

## COMPONENTS



### COMPONENTS LIST

All components available direct from factory or from your local Penn dealer.

Rod holder tube	256-610
Mounting bolts (8)	267A-610
1/4-20Nut, 18-8 ss Nylok(8)	208-815
Forward bracket	258-610
Rear bracket	259-610
Backing plates (2)	265-610
Flat washers (4)	220-600
Pin, Rod Butt (182-610) / Ring, Retaining(2) (196-600)	

## TEMPLATES

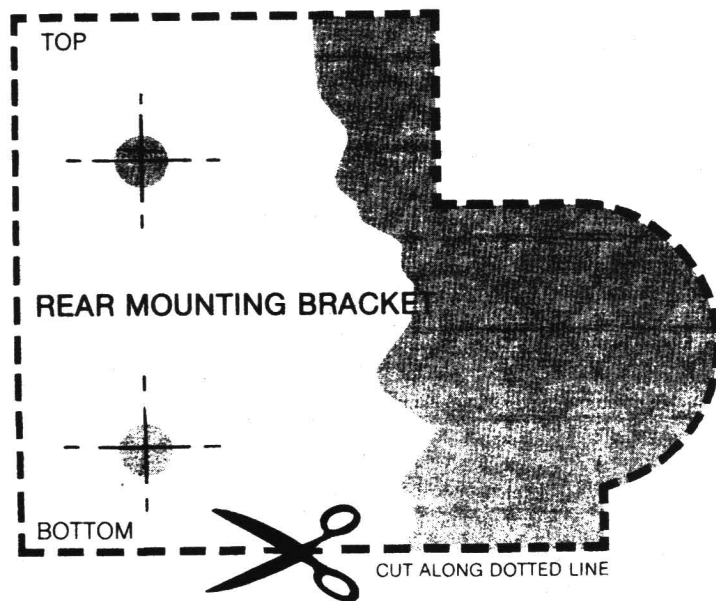
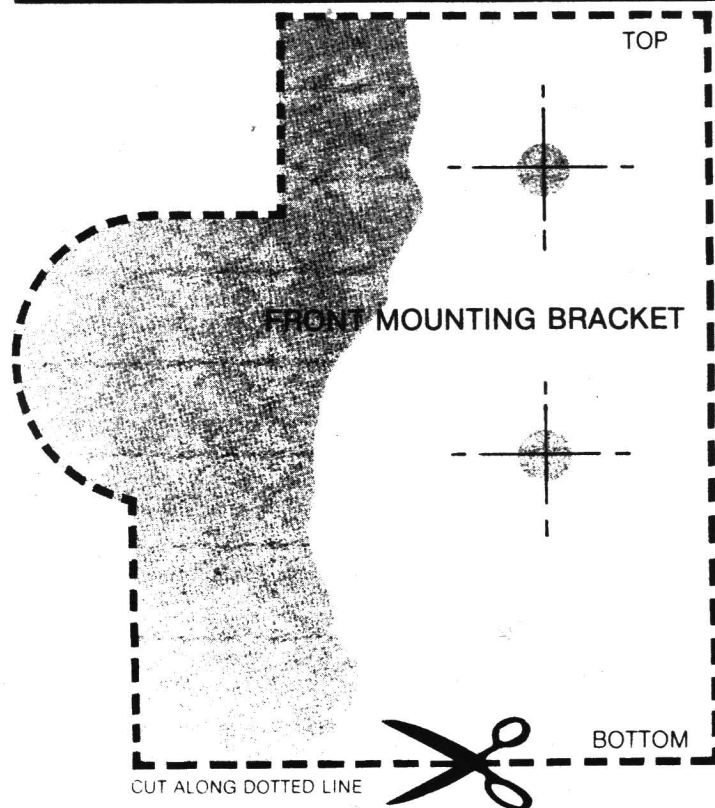

# MOUNTING INSTRUCTIONS

**1.** Carefully read instructions from step 1 through step 10 before mounting rod holder. If holes already exist in Fathom-Master® frame, proceed to step 6.

**2.** Cut out the two templates for the forward and rear bracket holes, being careful to cut directly on template lines. Do not cut out the small circles where holes are to be drilled.

**3.** Tape proper template on front and back of Fathom-Master® frame. Use the shaded side as reference to align template edge with frame edge.

**4.** For accurate installation, use a center punch, awl or small, sharp nail to make two punch holes in each template where indicated by "crosshairs" in middle of small circles.

Do not use a large nail or other makeshift instruments for this step.

**5.** Remove templates and with a 1/4" drill, use the four punch holes as references to drill two 1/4" holes in each side of the Fathom-Master® frame.

*Hint:* For the most accurate installation, first use a 1/8" bit to drill "pilot" holes after making the punch holes. Then use a 1/4" bit to drill the holes for the mounting brackets.

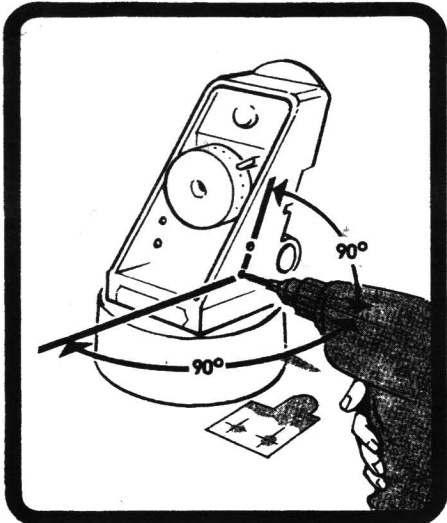

FIG. 1

**Caution:** Be sure to drill perpendicular (90° angle) to frame, as in fig. 1. Insert a scrap piece of thin wood, masonite or similar material inside the Fathom-Master® frame to protect it when the drill comes through.

**6.** Attach forward and rear mounting brackets using two bolts and two self-locking nuts on each bracket. For easiest installation, a 7/16" box or open end wrench is recommended rather than an adjustable wrench. Before screwing the nuts on the bolts, position the two backing plates on the inside of the Fathom-Master® frame, as in fig. 2.

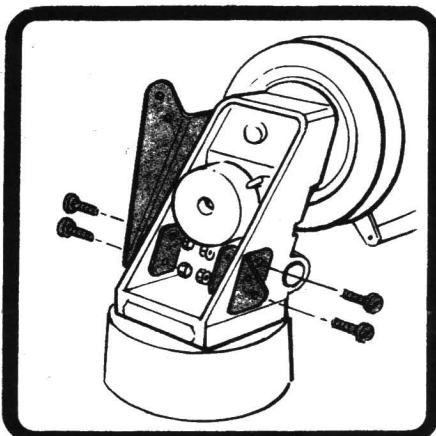

FIG. 2

Do not tighten the nuts, since some free play may be needed for adjustment while securing the rod holder later.

**7.** Take two bolts and put a flat washer on each one. *Note:* These washers have a round edge and a sharp edge. For best results, position washers so that the round edge will press against the rod holder tube.

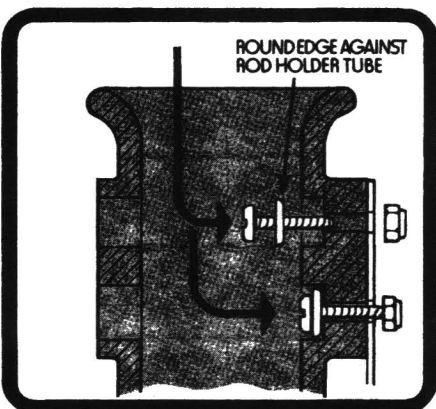

FIG. 3

Insert the bolts with washers through the holes on the upper end of the rod holder tube, as in fig. 3.

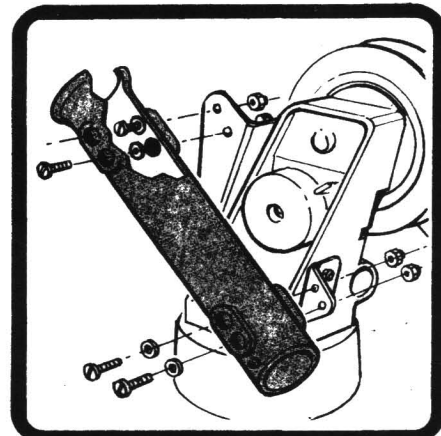

FIG. 4

**8.** While holding the bolts and washers in the rod holder tube, insert them through the holes at the top of the forward mounting bracket and attach with two self-locking nuts, as in fig. 4. Repeat for lower end of rod holder tube and rear mounting bracket. Again, do not tighten nuts to bolts until later.

**9.** Before final tightening, position the forward and rear brackets so their bottom edges are parallel to the bottom of the Fathom-Master® frame. Doing so will assure the neatest installation of the rod holder.

First tighten the nuts and bolts holding the mounting brackets to the frame. Then tighten the nuts and bolts connecting the mounting brackets to the rod holder tube. Tighten all nuts and bolts uniformly, but be careful not to overtighten and risk stripping the threads.

**10.** If desired, insert the gimbal bolt through the lower tube end and tighten with the remaining self-locking nut. Again, be careful not to overtighten. This nut will be properly tightened when it bears down only slightly on the rod holder tube.

## WARRANTY

### LIMITED WARRANTY

Penn Fishing Tackle Mfg. Co. warrants your rod holder to be free from breakage and defects in materials and workmanship for a period of one year from date of purchase. This warranty does not cover damage or malfunctions caused by accident, abuse or normal expected wear. If your rod holder has a defect within terms of the warranty, you should return it to us by U.P.S. or insured Parcel Post at the address indicated below. Include or send under separate cover a letter of explanation. We will replace your rod holder only, at our option, without further cost to you. If, however, we determine after inspection that replacement is not covered by provisions of this warranty, the rod holder will be replaced at reasonable charge.

ALL WARRANTIES WHICH MAY BE IMPLIED BY OPERATION OF LAW, INCLUDING BUT NOT LIMITED TO WARRANTIES OF MERCHANTABILITY AND WARRANTIES OF FITNESS FOR ANY PARTICULAR PURPOSE, SHALL BE LIMITED TO ONE YEAR FROM THE DATE OF PURCHASE. IN NO EVENT SHALL PENN FISHING TACKLE MFG CO. BE LIABLE FOR CONSEQUENTIAL OR SPECIAL DAMAGES FOR BREACH OF THIS WARRANTY OR ANY OTHER WARRANTY WHICH MAY BE IMPLIED BY LAW.

SOME STATES DO NOT ALLOW LIMITATIONS ON HOW LONG AN IMPLIED WARRANTY LASTS, AND SOME STATES DO NOT ALLOW THE EXCLUSION OF CONSEQUENTIAL OR SPECIAL DAMAGES. SO THE ABOVE LIMITATION AND/OR EXCLUSION MAY NOT APPLY TO YOU.

THIS WARRANTY GIVES YOU SPECIFIC LEGAL RIGHTS, AND YOU MAY ALSO HAVE OTHER RIGHTS WHICH VARY FROM STATE TO STATE.

Penn Fishing Tackle Mfg. Co. reserves the right to discontinue models and make changes in prices and design specifications without notice.

Penn Reels policy of ongoing research may necessitate design changes to bring you product performance improvement.

PENN FISHING TACKLE MFG. CO. 3028 W. Hunting Park Avenue Philadelphia, Pa. 19132