

How To Adjust The Centrifugal Brake On The Fathom Star Drag

Your Fathom SD is equipped with a 6 pin adjustable centrifugal brake system that can be set to fit every fishing condition. 2 brake blocks (12 & 16) or 3 brake blocks (25N, 30 & 40) should be activated from the factory. Follow these simple steps to adjust your reel:

- 1.) Remove the three screws (A)
- 2.) Remove the left side plate (B)
- 3.) Activate or de-activate the brake blocks by pushing them inwards or pulling them outwards from the spool center.

- (C) shows an active brake block
(D) shows a de-activated brake block

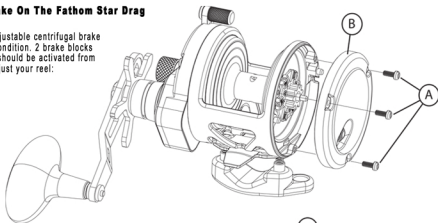

A Fathom SD Reel with all break blocks ACTIVATED has more braking power and is less likely to backlash (if thumbed properly). However, the increased braking power also means shorter casts.

With all break blocks DE-ACTIVATED there is less friction stopping the spool, and therefore an increase in casting distance. However, this also increases the probability of backlash.

Novice anglers are recommended to ACTIVATE all break blocks when casting the Fathom Star Drag.

