

**PENN<sup>®</sup>** MODEL PGV 1000

[www.PENNparts.com](http://www.PENNparts.com)

*Scott's* Bait & Tackle  
 Penn Parts Dept.  
 945 Radio Road  
 Tuckerton NJ 08087  
 (609) 296-1300  
 No Minimum Order!  
 Plus, Parts in stock  
 that Penn doesn't  
 carry anymore.

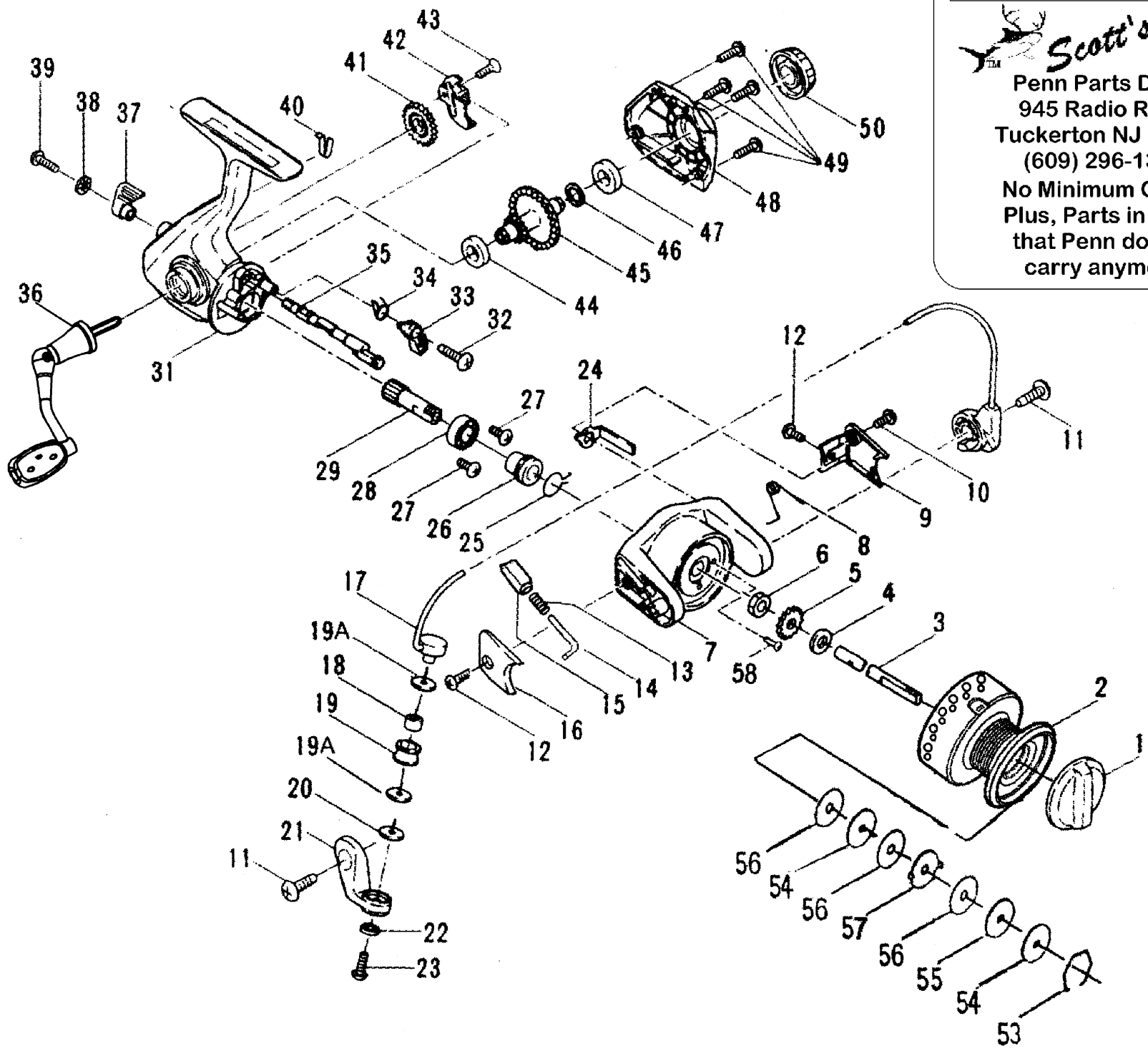

# Penn Reel Parts list for Model: VPG1000 PowerGraph 5

KEY PART	KEY PART	KEY PART	KEY PART		
NO	NO.	DESCRIPTION	NO	NO.	DESCRIPTION
1	52-1000V	DRAG KNOB ASM. W/ SPRING	31	1-1000V	HOUSING
2	47-1000V	SPOOL ASSEMBLY	32	3-1000	DOG MOUNTING SCREW
3	39-1000	SPOOL SHAFT	33	4-1000	ANTI-REVERSE DOG
4	60-1000	THRUST WASHER	34	4A-1000	DOG SPRING
5	40B-1000	CLICK RATCHET	35	6A-1000	ECCENTRIC SHAFT
6	38-1000	ROTOR NUT	36	15-1000V	HANDLE ASSEMBLY
7	27-1000V	ROTOR CUP	37	6E-1000V	ECCENTRIC LEVER
8	106-1000P	CAM LEVER SPRING	38	6G-1000	THRUST WASHER
9	227-1000V	CAM LEVER COVER	39	6F-1000	ECC. LEVER MOUNTING SCREW
10	50-1000	COVER SCREW	40	6D-1000	ECC. SHAFT SPRING
11	31A-1000	TRIP ARM SCREWS (2 REQ.)	41	231-1000	CROSSWIND GEAR
12	28B-1000	CAM LEVER MTG. SCREWS (2 REQ.)	42	43-1000	CROSSWIND GEAR BLOCK
13	34C-1000P	PIVOT	43	44-1500	CROSSWIND BLOCK SCREW
14	34B-1000P	PIVOT SHAFT	44	2B-1000	HOUSING BUSHING
15	34D-1000P	PIVOT GUIDE	45	8-1000P	MAIN GEAR
16	27A-1000V	BAIL PIVOT COVER	46	8A-3000	MAIN GEAR SHIM
17	24-1000P	BAIL WIRE ASSEMBLY	47	2B-1500	COVER BUSHING
18	** See below	LINE ROLLER BUSHING	48	45-1000V	HOUSING COVER
19	** See below	LINE ROLLER	49	46-1000	COVER SCREWS (3 REQ.)
19A	35B-1000P	LINE ROLLER TEFLON WASHER (2 REQ.)	50	233-1000V	BEARING COVER
20	132-1000	ROLLER WASHER	**51	48-1000P	SPOOL CLICK TONGUE
21	34-1000V	BAIL ARM	**51A	49-103CS	CLICK TONGUE SPRING
22	36A-103	LOCK WASHER	**52	22-103CS	CLICK TONGUE SCREW
23	36-1000	BAIL STUD SCREW	53	51-1000	DRAG RETAINING RING
24	28A-1000P	TRIP CAM LEVER	54	57-1000	KEYED DRAG WASHER (2 REQ.)
25	230-1000	SILENT DOG SPRING	55	52A-1000	DRAG WASHER (THICK)
26	19A-1000	PINION SPACER	56	6-1000	TEFLONG DRAG WASHER (3 REQ.)
27	23-1000	BEARING MTG. SCREWS (2 REQ.)	57	58-1000	EAR DRAG WASHER
28	20-1000	BALL BEARING	58	38A-1000	ROTOR NUT LOCKING SCREW
29	19-1000	PINION GEAR			

\*\* NOT SHOWN

NOTE: Many of [www.pennparts.com](http://www.pennparts.com) schematics include changes that were either made by Penn, or errors found and corrected by our parts dept.

SBT Ver. 080507

Line Roller/Ball Bearing Parts:

19\*\*35-1000V Line Roller 5/16" I.D. (came as original, but is NOT available)

This can be replaced with 35-1000 line roller (4/16" I.D.)

paired with either a 35A-1000 bushing or 35A-8500J ball bearing

18\*\*35A-1000V Line Roller Bushing (Replaces the ball bearing in the original reels - fits the 35-1000V Line Roller)

Note that this bushing DOES NOT fit on the 35-1000 replacement roller

see bushing/bearing notes above