



mysticparts.com

MYSTIC REEL PARTS

965 Radio Road
Little Egg Harbor, NJ 08087
1-609-296-1300
mail@mysticparts.com

MRP Ver. 090111

(based on Penn's Rev. 8, 7-27-11)



PARTS LIST FOR MODELS TRQS9-G (Gold)

REEL PART NO'S 1227759

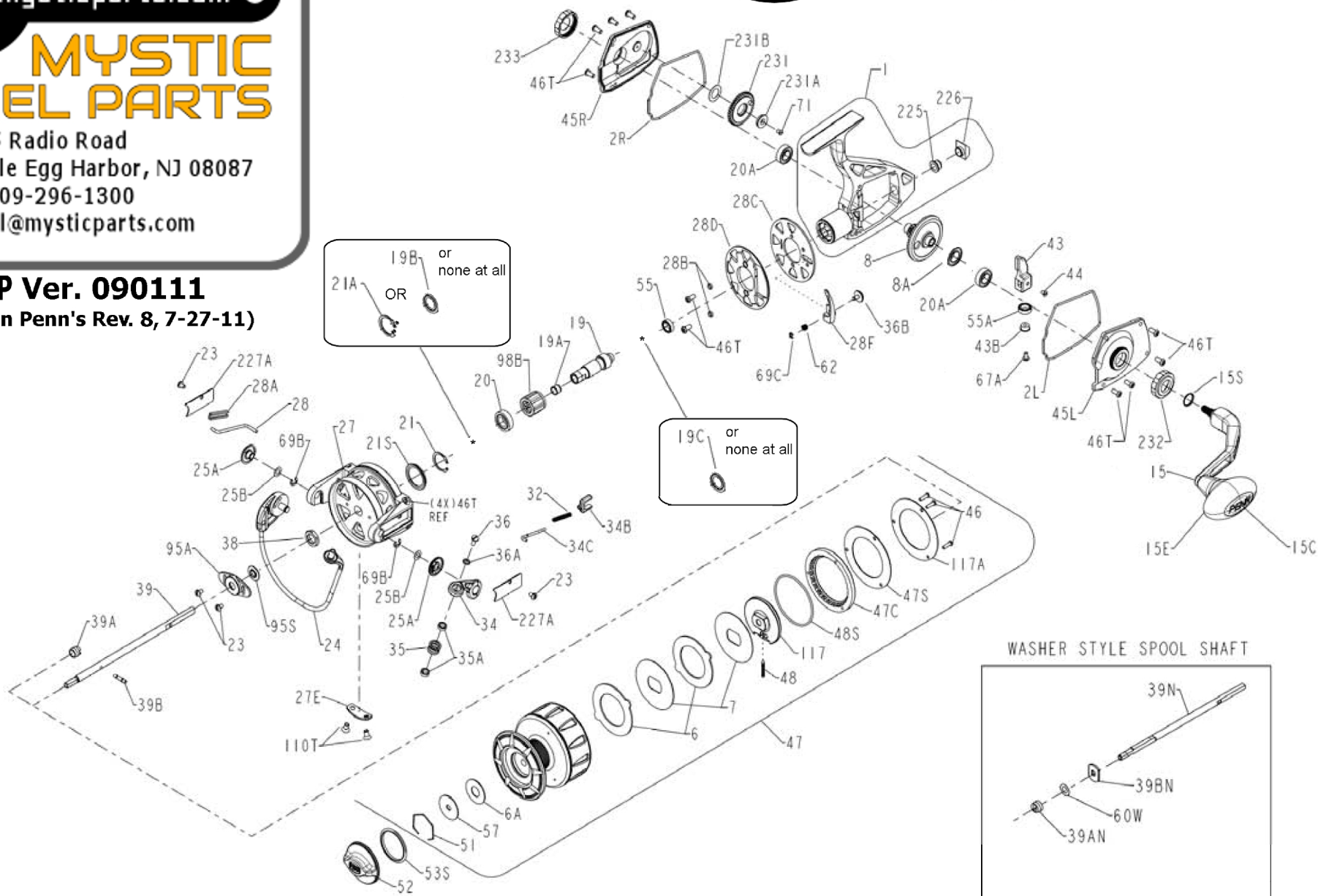

19B or none at all
21A OR

19C or none at all

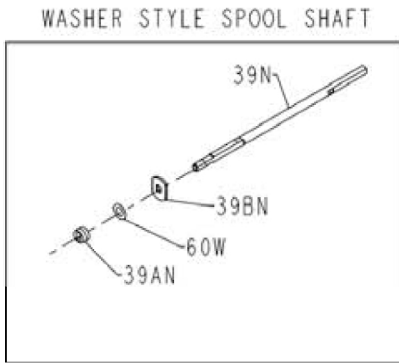

Penn Reel Parts list for:

Model: TRQS9 (Gold)

KEY NO	Penn Part #	PureFishing Part #	DESCRIPTION	KEY NO	Penn Part #	PureFishing Part #	DESCRIPTION
1	1-TS7G	1200325	HOUSING ARM (GOLD)	39A	39A-TS7	1205721	LOCATING PIN SEAL
2L	2L-TS7	1200326	LEFT HOUSING GASKET	39B	39B-760	1191765	LOCATING PIN
2R	2R-TS7	1200327	RIGHT HOUSING GASKET	43	43-TS7	1191815	CROSSWIND BLOCK
6	6-950M	1190981	EARRED DRAG WASHER (2 REQ)	43B	43B-TS7	1192690	C.W. BEARING PILOT
6A	6-309	1180917	DRAG WASHER	44	44-TS7	1225769	CROSSWIND SCREW
7	7-TS7	1192588	KEYED DRAG WASHER (2 REQ)	45L	45L-TS9G	1200416	L.S. COVER (GOLD)
8	8-TS7	1192589	GEAR ASSEMBLY	45R	45R-TS7G	1200348	R.S. COVER (GOLD)
15	15-TS7G	1200329	HANDLE ASM. (GOLD)	46	46-4300	1183567	DRIVE COVER SCREW (3 REQ)
15C	15C-TS7	1226716	HANDLE KNOB CAP	46T	46T-TS7	1191914	SCREW (14 REQ)
15E	15E-TS7	1229393	HANDLE SEAL	47	47-TS9G	1200418	SPOOL ASSEMBLY (GOLD)
15S	15S-TS7	1200419	HANDLE SEAL	47C	47C-TS7	1192691	DRAG COVER
19	19-TS7	1200330	PINION	47S	47S-TS7	1191959	DRAG SEAL
19A	19A-TS7	1192606	PINION BUSHING	48	48-5600	1183710	CLICK TONGUE ASSEMBLY
20	20-TS7	1191260	PINION BALL BEARING	48S	48S-TS7	1211091	O-RING
20A	20A-TS7	1191263	GEAR BALL BEARING (2 REQ)	51	51-8000CV2	1245795	SPRING RETAINER RING
21	21-TS7	1192641	RETAINING RING	52	52-TS7G	1200352	DRAG KNOB ASM (GOLD)
21S	21S-TS7	1191276	ROTOR SEAL	53S	53S-TS7	1211093	DRAG KNOB SEAL
23	23-750	1181953	COVER SCREW (2 REQ)	55	55-TS7	1192029	BALL BEARING
24	24-TS9	1191330	BAIL WIRE ASSEMBLY	55A	55A-TS7	1203081	BALL BEARING
25A	25A-TS7	1200331	BAIL BUSHING (2 REQ)	57	57-760	1192695	DRAG (METAL, KEYED) WASHER
25B	25B-TS7	1200332	BAIL WASHER (2 REQ)	62	62-TS7	1200353	TRIP SWITCH SPRING
27	27-TS9G	1200409	ROTOR ASSEMBLY (GOLD)	67A	67A-70	1184111	SCREW
27E	27E-TS9	1200410	BALANCE WEIGHT	69B	69B-4400	1184128	RETAINING RING (2 REQ)
28	28-TS7	1200336	TRIP LEVER	69C	69B-50	1184125	RETAINING RING
28A	28A-TS7	1200337	TRIP LEVER GUIDE	71	71-TS7	1200354	FLAT HEAD SCREW
28B	28B-TS7	1200338	FRICTION RING BUSHING (2 REQ)	95A	95A-TS7	1192704	ROTOR NUT COVER
28C	28C-TS9G	1200412	ROTOR FLANGE (GOLD)	95S	95S-TS7	1192188	SPOOL SHAFT SEAL
28D	28D-TS9	1200413	FRICTION RING	98B	98B-760	1200355	CLUTCH BEARING
28F	28F-TS9	1200414	TRIP RAMP	110T	110T-50	1184449	SCREW (2 REQ)
32	32-950M	1182741	BAIL SPRING	117	117-TS7	1242923	DRIVE PLATE
34	34-TS7	1191639	BAIL ARM ASSEMBLY	117A	117A-TS7	1192717	SEAL COVER
34B	34B-TS7	1200343	PIVOT SUPPORT	225	225-TS7	1192739	REAR BUSHING
34C	34C-760	1191658	PIVOT ARM	226	226-TS7	1192470	REAR CAP
35	35-TS7	1205239	LINE ROLLER	227A	227A-TS7G	1200357	ARM COVER (GOLD) (2 REQ)
35A	35A-950M	1182951	BALL BEARING (2 REQ)	231	231-TS7	1192740	CROSSWIND GEAR ASM
36	36-750	1183016	LINE ROLLER SCREW	231A	231A-TS7	1192741	CROSSWIND GEAR BUSHING
36A	36A-TS5	1221606	LOCK WASHER	231B	231B-TS7	1192742	CROSSWIND GEAR WASHER
36B	36-TS7	1200344	TRIP SWITH	232	232-TS7G	1200359	OPEN BEARING COVER (GOLD)
38	38-9500	1183160	ROTOR NUT	233	233-TS7G	1200361	HOUSING ARM (BLACK)
39	39-TS7	1192686	SPOOL SHAFT				

FOUND IN REEL BUT NOT ON ORIGINAL SCHEMATICS

21A	21A-TS7	??	SHIM, C-SHAPED W/FINGERS
19B	19B-TS7	??	SHIM, ROUND, INSTEAD OF 21A

In some reels we found 21A, others 19B, some no shim

19C	19C-TS7	??	SHIM, ROUND, F/LOW BEARING
-----	---------	----	----------------------------

Again, in some reels there was a 19C shim, others, none

8A	8A-TS7	1229050	SHIM, MAIN GEAR (USES 0 to 3)
----	--------	---------	-------------------------------

WASHER STYLE SPOOL SHAFT

39N	39N-TS7	1251997	SPOOL SHAFT
39AN	39AN-TS7	1251999	DRIVE PLATE SEAL
39BN	39B-TS7	1241979	LOCATING WASHER
60W	60W-TS7	1242146	SPOOL SHIM

MYSTIC REEL PARTS REVISION!

NOTE:

Many of www.mysticparts.com schematics include changes that were either made by Penn, or errors found and corrected by our parts dept.

MRP Ver 090111 (based on Penn's Rev. 8 7-27-11)