

www.PENNparts.com

Scott's Bait & Tackle

Penn Parts Dept.
945 Radio Road
Tuckerton NJ 08087
(609) 296-1300

No Minimum Order!
Plus, Parts in stock
that Penn doesn't
carry anymore.

SBT Ver. 090111

(based on Penn's Rev. 2, 7-27-11)

PENN

PARTS LIST FOR MODELS TRQS7-BBLS (Bailless Rotor)

REEL PART NO. 1227752

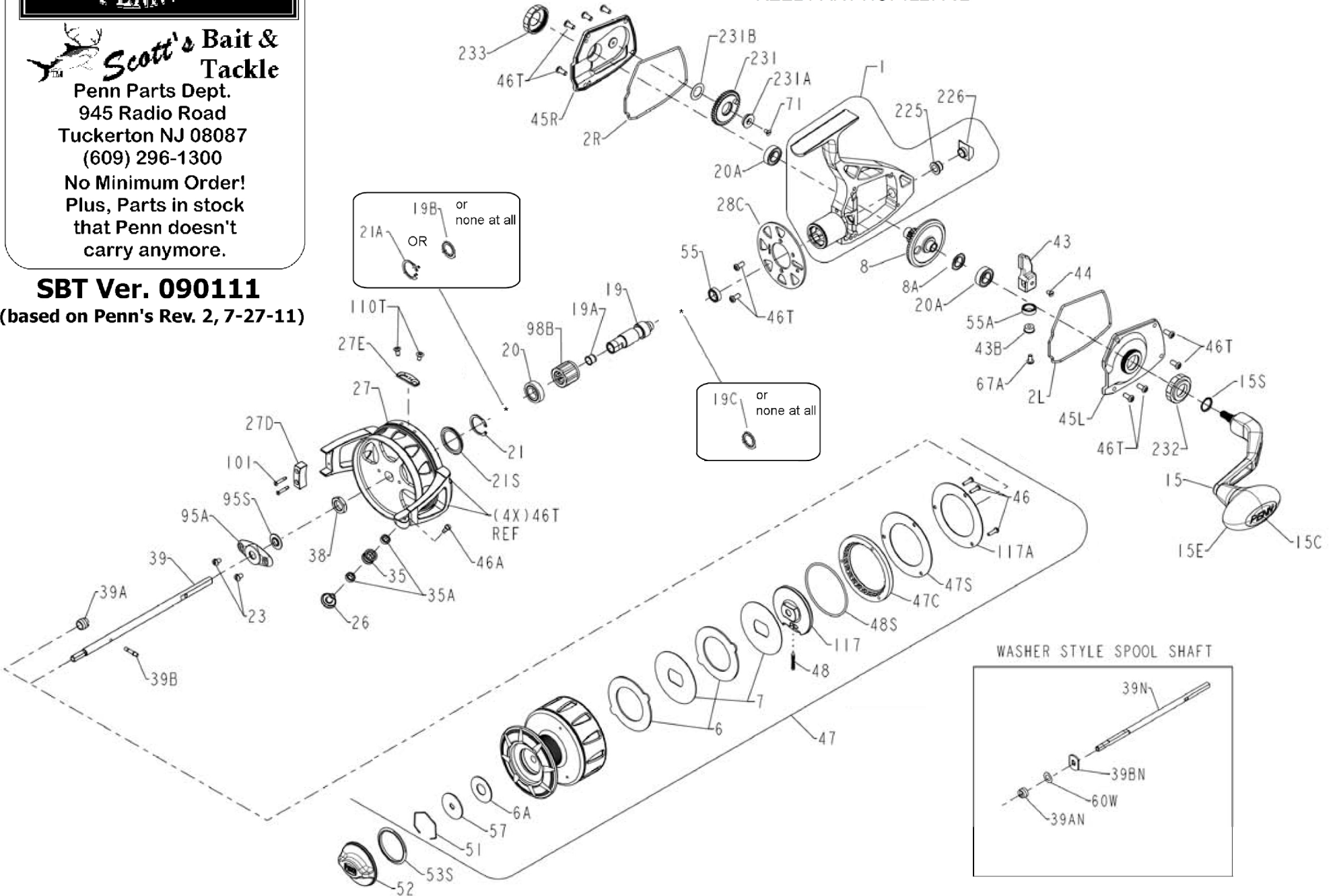

WASHER STYLE SPOOL SHAFT

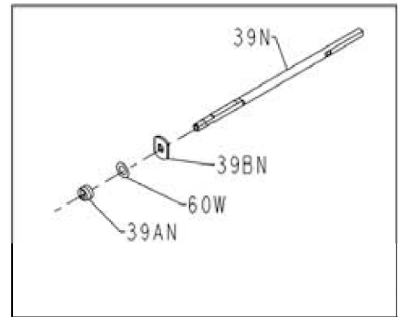

Penn Reel Parts list for Model: TRQS7-BBLS (Black) (Bail-less Rotor)

KEY	Penn	PureFishing	DESCRIPTION	KEY	Penn	PureFishing	DESCRIPTION
NO	Part #	Part #		NO	Part #	Part #	
1	1-TS7B	1200324	HOUSING ARM (BLACK)	45R	45R-TS7B	1200347	R.S. COVER (BLACK)
2L	2L-TS7	1200326	LEFT HOUSING GASKET	46	46-4300	1183567	DRIVE COVER SCREW (3 REQ)
2R	2R-TS7	1200327	RIGHT HOUSING GASKET	46A	46-TS5M	1225782	LINE ROLLER SCREW
6	6-950M	1190981	EARRED DRAG WASHER (2 REQ)	46T	46T-TS7	1191914	SCREW (14 REQ)
6A	6-309	1180917	DRAG WASHER	47	47-TS7B	1200349	SPOOL ARM (BLACK)
7	7-TS7	1192588	KEYED DRAG WASHER (2 REQ)	47C	47C-TS7	1192691	DRAG COVER
8	8-TS7	1192589	GEAR ASSEMBLY	47S	47S-TS7	1191959	DRAG SEAL
15	15-TS7B	1200328	HANDLE ASM. (BLACK)	48	48-5600	1183710	CLICK TONGUE ASSEMBLY
15C	15C-TS7	1226716	HANDLE KNOB CAP	48S	48S-TS7	1211091	O-RING
15E	15E-TS7	1229393	HANDLE SEAL	51	51-8000CV2	1245795	SPRING RETAINER RING
15S	15S-TS7	1200419	HANDLE SEAL	52	52-TS7B	1200351	DRAG KNOB ASM (BLACK)
19	19-TS7	1200330	PINION	53S	53S-TS7	1211093	DRAG KNOB SEAL
19A	19A-TS7	1192606	PINION BUSHING	55	55-TS7	1192029	BALL BEARING
20	20-TS7	1191260	PINION BALL BEARING	55A	55A-TS7	1203081	BALL BEARING
20A	20A-TS7	1191263	GEAR BALL BEARING (2 REQ)	57	57-760	1192695	DRAG (METAL, KEYED) WASHER
21	21-TS7	1192641	RETAINING RING	67A	67A-70	1184111	SCREW
21S	21S-TS7	1191276	ROTOR SEAL	71	71-TS7	1200354	FLAT HEAD SCREW
23	23-750	1181953	COVER SCREW (2 REQ)	95A	95A-TS7	1192704	ROTOR NUT COVER
26	26-TS7MB	1225787	ROLLER STUD (BLACK)	95S	95S-TS7	1192188	SPOOL SHAFT SEAL
27	27-TS7MB	1225799	ROTOR ASSEMBLY (BLACK)	98B	98B-760	1200355	CLUTCH BEARING
27D	27E-TS7M	1225788	BAILLESS BALANCE WEIGHT	101	101-TS5M	1225783	SCREW (2 REQ)
27E	27E-TS7	1200335	BALANCE WEIGHT	110T	110T-50	1184449	SCREW (2 REQ)
28C	28C-TS7B	1200339	ROTOR FLANGE (BLACK)	117	117-TS7	1242923	DRIVE PLATE
35	35-TS7	1205239	LINE ROLLER	117A	117A-TS7	1192717	SEAL COVER
35A	35A-950M	1182951	BALL BEARING (2 REQ)	225	225-TS7	1192739	REAR BUSHING
38	38-9500	1183160	ROTOR NUT	226	226-TS7	1192470	REAR CAP
39	39-TS7	1192686	SPOOL SHAFT	231	231-TS7	1192740	CROSSWIND GEAR ASM
39A	39A-TS7	1205721	LOCATING PIN SEAL	231A	231A-TS7	1192741	CROSSWIND GEAR BUSHING
39B	39B-760	1191765	LOCATING PIN	231B	231B-TS7	1192742	CROSSWIND GEAR WASHER
43	43-TS7	1191815	CROSSWIND BLOCK	232	232-TS7B	1200358	OPEN BEARING COVER (BLACK)
43B	43B-TS7	1192690	C.W. BEARING PILOT	233	233-TS7B	1200360	CLOSED BEARING COVER (BLACK)
44	44-TS7	1225769	CROSSWIND SCREW				
45L	45L-TS7B	1200345	L.S. COVER (BLACK)				

FOUND IN REEL BUT NOT ON ORIGINAL SCHEMATICS

21A	21A-TS7	??	SHIM, C-SHAPED W/FINGERS
19B	19B-TS7	??	SHIM, ROUND, INSTEAD OF 21A

In some reels we found 21A, others 19B, some no shim

19C	19C-TS7	??	SHIM, ROUND, F/LOW BEARING
-----	---------	----	----------------------------

Again, in some reels there was a 19C shim, others, none

8A	8A-TS7	1229050	SHIM, MAIN GEAR (USES 0 to 3)
----	--------	---------	-------------------------------

WASHER STYLE SPOOL SHAFT

39N	39N-TS7	1251997	SPOOL SHAFT
39AN	39AN-TS7	1251999	DRIVE PLATE SEAL
39BN	39B-TS7	1241979	LOCATING WASHER
60W	60W-TS7	1242146	SPOOL SHIM

MYSTIC REEL PARTS REVISION!

NOTE:

Many of www.mysticparts.com schematics include changes that were either made by Penn, or errors found and corrected by our parts dept.

MRP Ver 090111 (based on Penn's Rev. 8 7-27-11)