



# PARTS LIST FOR MODEL SSVI6500LL

1481279



965 Radio Raod  
Little Egg Harbor, NJ 08087  
+1 (609) 296-1300  
www.mysticparts.com  
customerservice@mysticparts.com

**MRP Ver 102118**

(based on Penn's Rev 00 04-11-18)

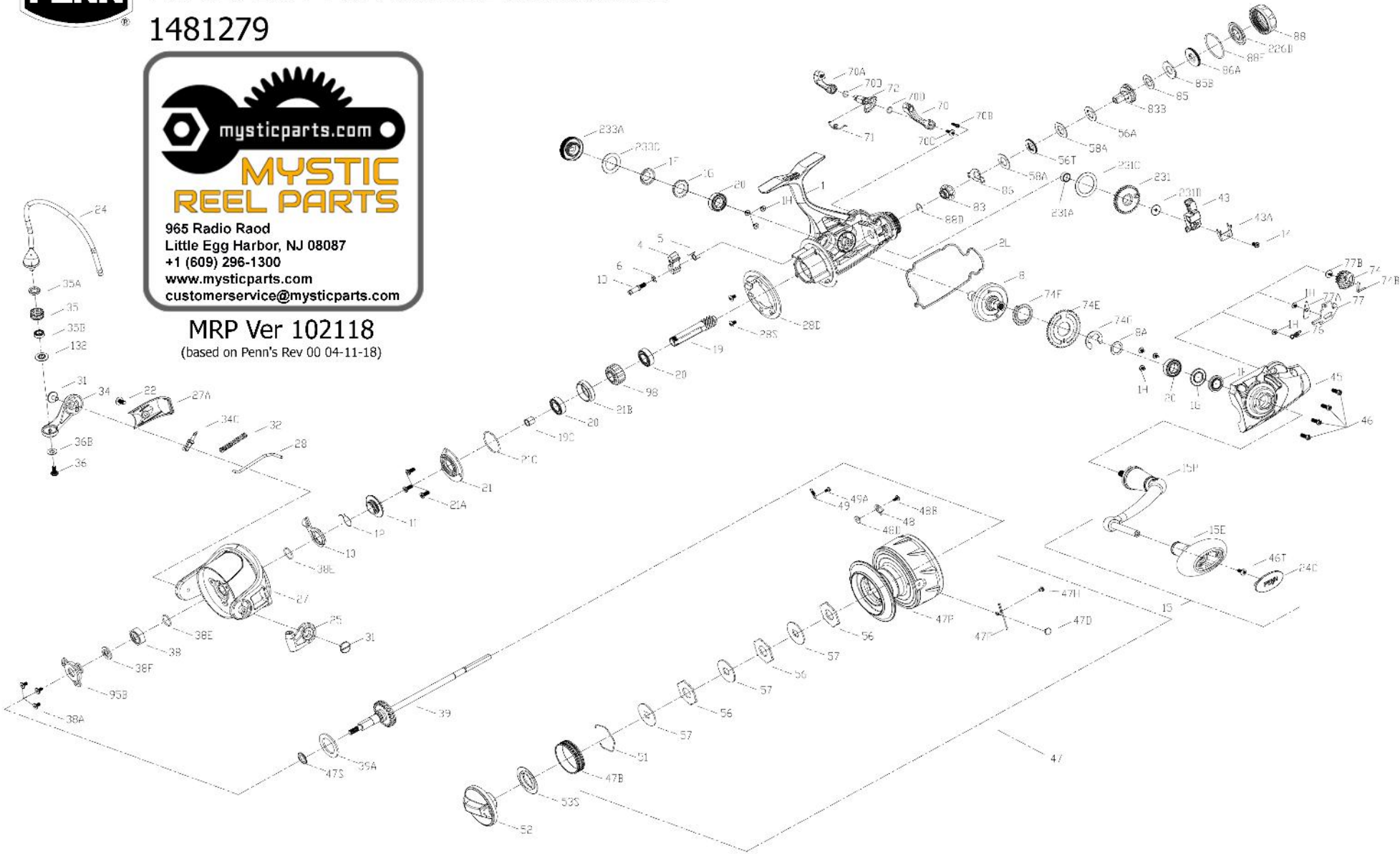

**Penn Reel Parts list for Model: SSVi6500LL Spinfisher VI Live Liner (1481279)**

KEY	PUREFISHING	PART	KEY	PUREFISHING	PART	DESCRIPTION
NO	NO	NO.	NO	NO	NO.	DESCRIPTION
1	1494745	1-SSVi6500LL	39	1494757	39-SSVi6500LL	MAIN SHAFT
1D	1277140	1D-SSV7500	39A	1494758	39A-SSVi6500LL	WASHER
1F	1419019	1F-SLA5500	43	1494759	43-SSVi6500LL	OSCILLATION SLIDER (CROSSWIND BLOCK)
1G	1419020	1G-SLA5500	43A	1494760	43A-SSVi6500LL	SLIDER RETAINER PLATE
1H	1418957	1H-SLA3500	45	1494761	45-SSVi6500LL	BODY COVER ASSEMBLY
2L	1494746	2L-SSVi6500LL	46	1277074	46-SSV5500	BODY COVER SCREW (2 REQUIRED)
4	1389459	4-CLA6000	47	1494763	47-SSVi6500LL	SPOOL ASSEMBLY
5	1339474	5-CLA5000	47B	1277076	47B-SSV5500	SPOOL BAND
6	1277144	6-SSV7500	47D	1494765	47D-SSVi6500LL	LINE CLIP
8	1494747	8-SSVi6500LL	47F	1277080	47F-SSV5500	LINE CLIP RETAINER
8A	1277037	8A-SSV5500	47H	1294638	49A-CLA2000	SCREW, FOR SPOOL CLICK SPRING
10	1419936	10-CLA6000	47P	1494765	47P-SSVi6500LL	SPOOL (BARE)
11	1419028	11-SLA5500	47S	1494699	47S-SSVi2500LL	SPOOL SEAL
12	1339487	12-SLA5500	48	1385578	48-CLA3000	SPOOL CLICK PLATE
14	1276992	14-SSV6500LL	48B	1385581	48B-CLA3000	SPOOL CLICKER SPRING SCREW
<b>15</b>	<b>All handle components, see page 3</b>					
19	1494751	19-SSVi6500LL	48D	1385579	48D-CLA3000	SPOOL CLICKER SPACER RING
19C	1419023	19C-SLA5500	49	1385580	49-CLA3000	SPRING
20	1308090	20-CFT5000	49A	1341547	49A-SSV7500LC	SCREW
21	1419025	21-SLA5500	51	1447925	51-CFTii5000	DRAG WASHER RETAINER
21A	1277154	21A-SSV7500	52	1494766	52-SSVi6500LL	DRAG KNOB ASSEMBLY
21B	1419024	21B-SLA5500	53S	1447927	53S-CFTii5000	DRAG KNOB SEAL
21C	1385684	21C-CLA8000	56	1339557	56-CLA5000	DRAG FRICTION WASHER (3 REQUIRED)
22	1276928	22-SSV3500	56A	1494767	56A-SSVi6500LL	FRICTION WASHER (REAR)
24	1494752	24-SSVi6500LL	56T	1494768	56T-SSVi65000LL	DRAG WASHER (REAR) (dual sided ht100/metal - square key hole)
25	1339500	25-CLA5000	57	1339558	57-CLA5000	KEYED METAL DRAG WASHER (3 REQUIRED)
27	1494754	27-SSVi6500LL	58A	1494769	58A-SSVi6500LL	EARRED METAL DRAG WASHER (REAR) (2 REQUIRED)
27A	1494755	27A-SSVi6500LL	70	1494770	70-SSVi6500LL	LEVER, LEFT
28	1494756	28-SSVi6500LL	70A	1494771	70A-SSVi6500LL	LEVER, RIGHT
28D	1457402	28D-SLAiii6500HS	70B	1277128	70B-SSV6500LL	SCREW, FOR DRAG SWITCH LEVER
28S	1277063	38A-SSV5500	70C	1277003	70C-SSV4500LL	SCREW, FOR RIGHT DRAG SWITCH LEVER
31	1277055	31-SSV5500	70D	1494708	70D-SSVi2500LL	O-RING (2 REQUIRED)
32	1389467	32-CLA6000	71	1494772	71-SSVi6500LL	SPRING
34	1389468	34-CLA6000	72	1494773	72-SSVi6500LL	SWITCH CAM
34C	1389469	34C-CLA6000	74	1494774	74-SSVi6500LL	CAM GEAR
35	1457403	35-SLAiii6500HS	74B	1494775	74B-SSVi6500LL	SPRING
35A	1457404	35A-SLAiii6500HS	74E	1494776	74E-SSVi6500LL	GEAR
35B	1377606	35A-BTLii8000LC	74F	1494777	74F-SSVi6500LL	SPRING
36	1422399	36-SLA9500	74G	1277014	74G-SSV4500LL	E-CLIP, FOR THREE PAWL LEVER
36B	1417809	36B-CLA6000	76	1494778	76-SSVi6500LL	LIVE LINER CLAW SPRING
38	1419051	38-SLA5500	77	1494779	77-SSVi6500LL	STOP CLAW
38A	1119121	20C-7000AF	77A	1494780	77A-SSVi6500LL	PLATE
38E	1418958	38E-SLA3500	77B	1289972	77B-SSV4500LL	SCREW, FOR DRAG COVER
38F	1419052	38F-SLA5500	83	1494781	83-SSVi6500LL	RATCHET

**83B SUPPORT ASSEMBLY - SEE PG 3 NOTES**

Mystic Reel Parts

KEY	PUREFISHING	PART	
NO	NO	NO.	DESCRIPTION
85B	1494784	85B-SSVi6500LL	EARRED METAL WASHER
86	1494785	86-SSVi6500LL	SPRING
86A	1494786	86A-SSVi6500LL	NUT
88	1494787	88-SSVi6500LL	KNOB
88D	1494788	88D-SSVi6500LL	RETAINER
88E	1494789	88E-SSVi6500LL	O-RING
95B	1419009	95B-SLA3500	ROTOR NUT LOCKING PLATE
98	1277094	98-SSV5500	CLUTCH/SLEEVE ASSEMBLY

KEY	PUREFISHING	PART	
NO	NO	NO.	DESCRIPTION
132	1457405	132-SLAiii6500HS	LINE ROLLER COLLAR
226B	1494790	226A-SSVi6500LL	SEAL (REAR)
231	1389600	231-CLA6000	OSCILLAION GEAR (CROSSWIND GEAR)
231A	1339566	231A-CLA5000	OSCILLATION GEAR BUSHING
231B	1277100	231B-SSV5500	OSCILLATION GEAR SCREW
231C	1389603	231C-CLA6000	OSCILLATION GEAR WASHER
233A	1419075	233A-SLA5500	HANDLE CAP
233C	1419076	233C-SLA5500	HANDLE CAP WASHER

#### HANDLE COMPONENTS

15	1494748	15-SSVi6500LL	HANDLE ASSEMBLY (RUBBER FOOTBALL KNOB)
15E	1494749	15E-SSVi6500LL	HANDLE KNOB (METAL)
15P	1494750	15P-SSVi6500LL	SUB-HANDLE ASSEMBLY
24C	1494753	24C-SSVi6500LL	HANDLE KNOB CAP (FOR METAL KNOB)
46T	1494762	46T-SSVi6500LL	SCREW

#### NOTES

<b>83B</b>	<b>1494782</b>	<b>83B-SSVi6500LL</b>	<b>SUPPORT ASSEMBLY (SEE SPRING BELOW)</b>
*	??	83B-SSVi6500LL-1	SUPPORT PIECE BY ITSELF, WE ASSIGNED THIS NUMBER
83C	??	83C-SSVi2500LL	SPRING FOUND ON ASSEMBLY, WE ASSIGNED THIS NUMBER
83D??	??	83D-SSVi6500LL	KEYED RETAINING WASHER, WE ASSIGNED THIS NUMBER

**83B is only available as an assembly at this time. The other #s are temporary and not available.**

#### **MYSTIC REEL PARTS REVISION!**

##### NOTE:

Many of www.mysticparts.com schematics include changes that were either made by Penn, or errors found and corrected by our parts dept.  
MRP Ver 102118 (Based on Penn's Rev. 00 , 04-1-18)