

Design Change!  
See notes on page 3  
about these part numbers

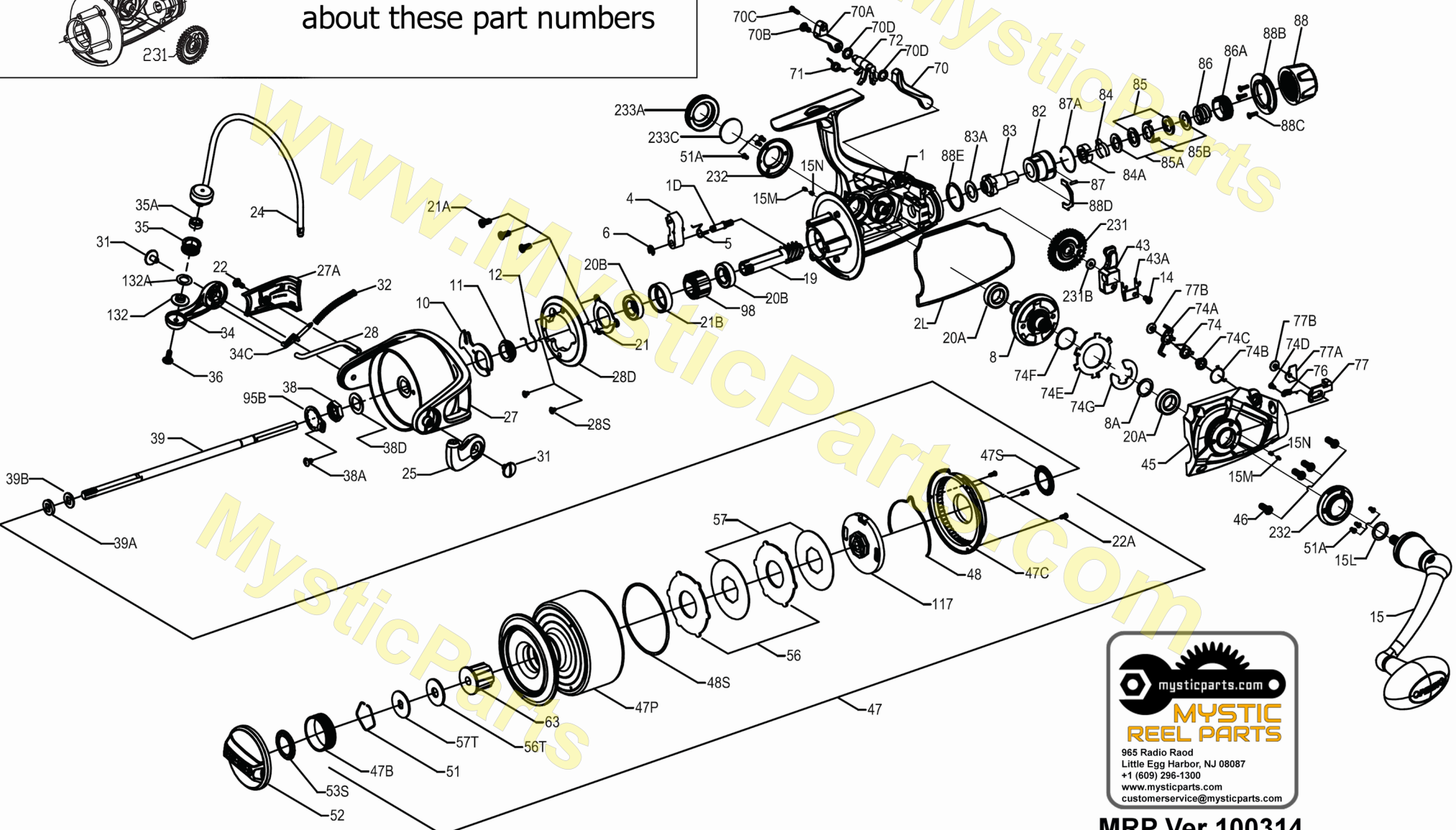

# PARTS LIST FOR MODEL SSV8500LL



**MRP Ver 100314**  
**(based on Penn's Rev. 5 10-01-14)**

# Penn Reel Parts list for Model: SSV8500LL Spinfisher V Live Liner

KEY	PUREFISHING	PENN PART		KEY	PUREFISHING	PENN PART	
NO	NO.	NO.	DESCRIPTION	NO	NO.	NO.	DESCRIPTION
<b>1</b>	<b>SEE PAGE 3</b>						
1D	1277140	1D-SSV7500	A/R PAWL POST	38D	1277168	38D-SSV7500	ROTOR WASHER
2L	1277216	2L-SSV8500LL	HOUSING BODY SEAL	39	1277219	39-SSV8500LL	MAIN SPOOL SHAFT
4	1277199	4-SSV8500	A/R PAWL	39A	1277170	39A-SSV7500	SPOOL ADJUST WASHER (USES 1 OR 2)
5	1277143	5-SSV7500	A/R PAWL SPRING	39B	1277171	39B-SSV7500	MAIN SHAFT WASHER
6	1277144	6-SSV7500	RETAINER CLIP	43	1277220	43-SSV8500LL	OSCILLATION SLIDER (CROSSWIND BLOCK)
8	1277217	8-SSV8500LL	MAIN DRIVE GEAR	43A	1277221	43A-SSV8500LL	OSCILLATION SLIDER GUIDE (CROSSWIND PLATE)
8A	1277146	8A-SSV7500	DRIVE GEAR SHIM WASHER (USES 1 OR 2)	<b>45</b>	<b>SEE PAGE 3</b>		
10	1277147	10-SSV7500	A/R PAWL HOLDER	46	1277176	46-SSV7500	HOUSING / BODY COVER SCREW (4 REQUIRED)
11	1277148	11-SSV7500	A/R BUSHING	47	1277223	47-SSV8500LL	SPOOL ASSEMBLY
12	1277149	12-SSV7500	A/R BUSHING SPRING	47B	1277208	47B-SSV8500	SPOOL BAND
14	1276992	14-SSV6500LL	OSCILLATION SLIDER RETAINER SCREW	47C	1277178	47C-SSV7500	DRAG COVER
15	1277150	15-SSV7500	HANDLE ASSEMBLY	47P	1277224	47P-SSV8500LL	SPOOL, BARE
15L	1292784	15L-SSV7500	HANDLE SEAL	47S	1277082	47S-SSV5500	DRAG COVER / DRIVE PLATE SEAL
15M	1276922	15M-SSV3500	HANDLE CAP LOCK PIN (2 REQUIRED)	48	1277181	48-SSV7500	SPOOL CLICKER
15N	1277040	15N-SSV5500	HANDLE CAP LOCK PIN SPRING (2 REQUIRED)	48S	1277182	48S-SSV7500	DRAG COVER SEAL
19	1277218	19-SSV8500LL	PINION GEAR	51	1277085	51-SSV5500	DRAG WASHER RETAINING RING
<b>20A, 20B</b>	<b>SEE PAGE 3</b>			51A	1277183	51A-SSV7500	BEARING RETAINER SCREW (6 REQUIRED)
21	1277153	21-SSV7500	PINION BEARING RETAINER	52	1277211	52-SSV8500	DRAG KNOB ASSEMBLY
21A	1277154	21A-SSV7500	PINION RETAINER SCREW (3 REQUIRED)	53S	1293253	53S-SSV7500	DRAG KNOB SEAL
21B	1277155	21B-SSV7500	PINION BALL BEARING COLLAR	56	1277185	56-SSV7500	DRAG FRICTION WASHER HT100 (2 REQUIRED)
22	1277046	22-SSV5500	ROTOR COVER SCREW	56T	1277089	56T-SSV5500	DRAG FRICTION WASHER HT100
22A	1277047	22A-SSV5500	DRAG COVER SCREW (3 REQUIRED)	57	1277186	57-SSV7500	KEYED METAL DRAG WASHER (2 REQUIRED)
24	1277200	24-SSV8500	BAIL ASSEMBLY	57T	1277187	57T-SSV7500	KEYED METAL DRAG WASHER
25	1277157	25-SSV7500	BAIL HOLDER (BAIL CAM)	63	1277212	63-SSV8500	SPOOL BUSHING
27	1277201	27-SSV8500	ROTOR	70	1277225	70-SSV8500LL	LIVE LINER DRAG SWITCH LEVER (LEFT)
27A	1277202	27A-SSV8500	ROTOR COVER	70A	1277226	70A-SSV8500LL	LIVE LINER DRAG SWITCH LEVER (RIGHT)
28	1277203	28-SSV8500	BAIL TRIP LEVER	70B	1277128	70B-SSV6500LL	LIVE LINER DRAG SWITCH LEVER SCREW
28D	1277204	28D-SSV8500	ROTOR BRAKE	70C	1277003	70C-SSV4500LL	LIVE LINER DRAG SWITCH LEVER SCREW
28S	1277054	28S-SSV5500	ROTOR BRAKE SCREW (2 REQUIRED)	70D	1277004	70D-SSV4500LL	LIVE LINER DRAG SWITCH LEVER SEAL (2 REQUIRED)
31	1277055	31-SSV5500	BAIL ARM SCREW (2 REQUIRED)	71	1277227	71-SSV8500LL	LIVE LINER LEVER SPRING
32	1277162	32-SSV7500	BAIL SPRING	72	1277228	72-SSV8500LL	LIVE LINER DRAG SWITCH CAM
34	1277163	34-SSV7500	BAIL ARM	74	1277007	74-SSV4500LL	LIVE LINER TRIP LEVER (A)
34C	1277164	34C-SSV7500	PIVOT ARM	74A	1277229	74A-SSV8500LL	LIVE LINER TRIP LEVER (B)
35	1277165	35-SSV7500	LINE ROLLER	74B	1277009	74B-SSV4500LL	LIVE LINER TRIP LEVER SPRING
35A	1277060	35A-SSV5500	LINE ROLLER BALL BEARING	74C	1277010	74C-SSV4500LL	LIVE LINER TRIP LEVER BUSHING
36	1277166	36-SSV7500	LINE ROLLER SCREW	74D	1277011	74D-SSV4500LL	LIVE LINER STOP CLAW SPRING SCREW
38	1277167	38-SSV7500	ROTOR NUT	74E	1277230	74E-SSV8500LL	LIVE LINER THREE PAWL LEVER
38A	1277063	38A-SSV5500	ROTOR NUT LOCK PLATE SCREW	74F	1277231	74F-SSV8500LL	LIVE LINER THREE PAWL LEVER SPRING
				74G	1277232	74G-SSV8500LL	LIVE LINER THREE PAWL LEVER E-CLIP

KEY NO	PUREFISHING NO.	PENN PART NO.	DESCRIPTION
76	1277134	76-SSV6500LL	LIVE LINER CLAW SPRING
77	1277233	77-SSV8500LL	LIVE LINER STOP CLAW
77A	1277234	77A-SSV8500LL	LIVE LINER PLATE
77B	1289972	77B-SSV4500LL	LIVE LINER PLATE SCREW (3 REQUIRED)
82	1277235	82-SSV8500LL	REAR DRAG HOUSING
83	1277236	83-SSV8500LL	REAR DRAG RATCHET
83A	1277237	83A-SSV8500LL	REAR DRAG RATCHET WASHER
84	1277238	84-SSV8500LL	REAR DRAG CLICKER
84A	1277239	84A-SSV8500LL	REAR DRAG CLICKER RETAINER
85	1277240	85-SSV8500LL	REAR DRAG WASHER (2 REQUIRED)
85A	1277241	85A-SSV8500LL	REAR DRAG KEYED WASHER (2 REQUIRED)
85B	1277242	85B-SSV8500LL	REAR DRAG EARED WASHER
86	1277243	86-SSV8500LL	REAR DRAG SPRING
86A	1277244	86A-SSV8500LL	REAR DRAG NUT
87	1277027	87-SSV4500LL	REAR DRAG KNOB CLICKER
87A	1277245	87A-SSV8500LL	REAR DRAG KNOB CLICKER RING
88	1277246	88-SSV8500LL	REAR DRAG KNOB
88B	1277247	88B-SSV8500LL	REAR DRAG KNOB RING
88C	1277248	88C-SSV8500LL	REAR DRAG KNOB RING SCREW (3 REQUIRED)
88D	1277249	88D-SSV8500LL	REAR DRAG KNOB RETAINER
88E	1277250	88E-SSV8500LL	REAR DRAG KNOB SEAL

KEY NO	PUREFISHING NO.	PENN PART NO.	DESCRIPTION
95B	1277189	95B-SSV7500	ROTOR NUT LOCKING PLATE
98	1277190	98-SSV7500	CLUTCH / SLEEVE ASSEMBLY
117	1277191	117-SSV7500	DRAG DRIVE PLATE
132	1277192	132-SSV7500	LINE ROLLER COLLAR
132A	1277097	132A-SSV5500	LINE ROLLER WASHER
<b>231 SEE PAGE 3</b>			
<b>231B SEE PAGE 3</b>			
232	1277214	232-SSV8500	BEARING RETAINER (2 REQUIRED)
233A	1277196	233A-SSV7500	HANDLE CAP
233C	1277197	233C-SSV7500	HANDLE CAP WASHER

**MYSTIC REEL PARTS REVISION!**

**NOTE:**

Many of www.mysticparts.com schematics include changes that were either made by Penn, or errors found and corrected by our parts dept.

MRP Ver 100314 (Based on Penn's Rev. 5, 10-01-14)

**MRP Ver 032924 (Parts List updated to clarify housing/gearing design changes sizing)**

**REV 3. Bearing number changes**

20A	1277152	20A-SSV7500	BALL BEARING (4 REQUIRED)
-----	---------	-------------	---------------------------

We are assuming there were errors with the bearing part numbers on the schematic, rather than that they actually changed the bearings.

**REV. 5 Bearings**

20A	1277152	20A-SSV7500	BALL BEARING (2 REQUIRED)
20B	1344681	20B-SSV7500	BALL BEARING, SEALED (2 REQUIRED)

**RECOMMEND TO USE THE REVISION 4 NUMBERS**

**\*\*\*\*\* DESIGN CHANGE WARNING \*\*\*\*\***

Early SSV reels when released had a slightly different housing, crosswind gear and housing cover

The diameter of the CW gear hole and post was CHANGED and the pin/pin hole diameters on the 45- cover were changed as well

THIS DESIGN CHANGE affects the housing, crosswind gear, and housing cover

**MEASURE YOUR HOUSING/GEAR**

At the post where the crosswind sits or the hole in the center of the crosswind gear.

**Parts that you order MUST MATCH EACH OTHER**

Some parts may no longer be available, so check all three parts for availability and matching size

**\*\*\*\*\* BEFORE YOU PLACE AN ORDER! \*\*\*\*\***

**MEASURE and CHECK STOCK FIRST! .23 peg (1/4") SIZE**

1	1277215	1-SSV8500LL	HOUSING, BODY ASSEMBLY with .23 peg (1/4")
231	1277213	231-SSV8500	CROSSWIND OSCILLATION GEAR 0.23" I.D. (1/4")
45	1277222	45-SSV8500LL	HOUSING / BODY COVER to match (1/4")
231B	1307857	231B-SSV3500	CROSSWIND OSCILLATION GEAR SCREW (1/4")

**MEASURE and CHECK STOCK FIRST! .309 peg (5/16")**

1	NLA **	1-SSV6500	HOUSING, BODY ASSEMBLY with .309 peg (5/16")
231	NLA **	231-SSV5500	CROSSWIND OSCILLATION GEAR 1st run 0.309" I.D. (5/16")
45	NLA **	45-SSV6500	HOUSING / BODY COVER to match (5/16")
231B	1277100	231B-SSV5500	CROSSWIND OSCILLATION GEAR SCREW (5/16")

**NOTE: We never received or saw anything for this SSV8500LL reel in 5/16" 2014 - 2024**

**\*\* NLA = NOT AVAILABLE as of 2024 updates (design changes were first noted back in 2014)**