

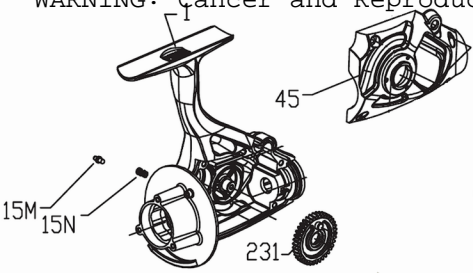

PARTS LIST FOR MODEL SSV6500LL

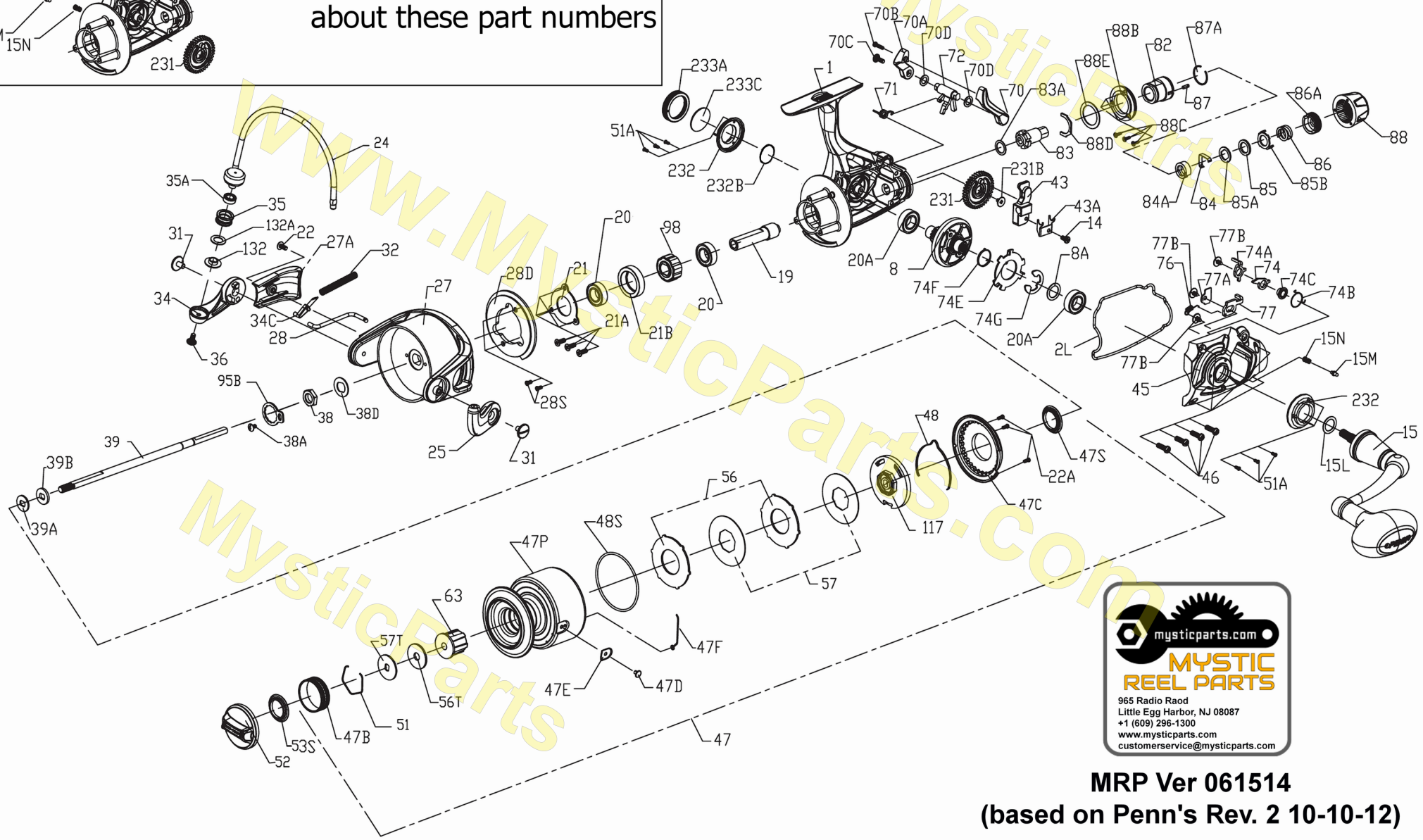

Design Change!
See notes on page 3
about these part numbers



MRP Ver 061514
(based on Penn's Rev. 2 10-10-12)

Penn Reel Parts list for Model: SSV6500LL Spinfisher V Live Liner

KEY NO	PUREFISHING NO.	PENN PART NO.	DESCRIPTION
1	SEE PAGE 3		
2L	1277117	2L-SSV6500LL	HOUSING BODY SEAL
8	1277118	8-SSV6500LL	MAIN DRIVE GEAR
8A	1277037	8A-SSV5500	DRIVE GEAR SHIM WASHER (USES 1 OR 2)
14	1276992	14-SSV6500LL	OSCILLATION SLIDER RETAINER SCREW
15	1277038	15-SSV5500	HANDLE ASSEMBLY
15L	1292783	15L-SSV5500	HANDLE SEAL
15M	1277039	15M-SSV5500	HANDLE CAP LOCK PIN (2 REQUIRED)
15N	1277040	15N-SSV5500	HANDLE CAP LOCK PIN SPRING (2 REQUIRED)
19	1277119	19-SSV6500LL	PINION GEAR
20, 20A	SEE PAGE 3		
21	1277043	21-SSV5500	PINION BEARING RETAINER
21A	1277044	21A-SSV5500	PINION RETAINER SCREW (3 REQUIRED)
21B	1277045	21B-SSV5500	PINION BALL BEARING COLLAR
22	1277046	22-SSV5500	ROTOR COVER SCREW
22A	1277047	22A-SSV5500	DRAG COVER SCREW (3 REQUIRED)
24	1277106	24-SSV6500	BAIL ASSEMBLY
25	1277049	25-SSV5500	BAIL HOLDER (BAIL CAM)
27	1277107	27-SSV6500	ROTOR
27A	1277108	27A-SSV6500	ROTOR COVER
28	1277052	28-SSV5500	BAIL TRIP LEVER
28D	1277109	28D-SSV6500	ROTOR BRAKE
28S	1277054	28S-SSV5500	ROTOR BRAKE SCREW (2 REQUIRED)
31	1277055	31-SSV5500	BAIL ARM SCREW (2 REQUIRED)
32	1277056	32-SSV5500	BAIL SPRING
34	1277057	34-SSV5500	BAIL ARM
34C	1277058	34C-SSV5500	PIVOT ARM
35	1277059	35-SSV5500	LINE ROLLER
35A	1277060	35A-SSV5500	LINE ROLLER BALL BEARING
36	1277061	36-SSV5500	LINE ROLLER SCREW
38	1277062	38-SSV5500	ROTOR NUT
38A	1277063	38A-SSV5500	ROTOR NUT LOCK PLATE SCREW (3 REQUIRED)
38D	1277064	38D-SSV5500	ROTOR WASHER
39	1277120	39-SSV6500LL	MAIN SPOOL SHAFT
39A	1277066	39A-SSV5500	SPOOL ADJUST WASHER (USES 1 OR 2)
39B	1277067	39B-SSV5500	MAIN SHAFT WASHER
43	1277121	43-SSV6500LL	OSCILLATION SLIDER (CROSSWIND BLOCK)
43A	1277122	43A-SSV6500LL	OSCILLATION SLIDER GUIDE (CROSSWIND PLATE)
45	SEE PAGE 3		
46	1277074	46-SSV5500	HOUSING / BODY COVER SCREW (4 REQUIRED)
47	1277124	47-SSV6500LL	SPOOL ASSEMBLY
47B	1277076	47B-SSV5500	SPOOL BAND
47C	1277077	47C-SSV5500	DRAG COVER
47D	1277078	47D-SSV5500	LINE CLIP
47E	1277079	47E-SSV5500	LINE CLIP BUSHING
47F	1277112	47F-SSV6500	LINE CLIP RETAINER
47P	1277125	47P-SSV6500LL	SPOOL, BARE
47S	1277082	47S-SSV5500	DRAG COVER / DRIVE PLATE SEAL
48	1277083	48-SSV5500	SPOOL CLICKER

KEY NO	PUREFISHING NO.	PENN PART NO.	DESCRIPTION
48S	1277084	48S-SSV5500	DRAG COVER SEAL
51	1277085	51-SSV5500	DRAG WASHER RETAINING RING
51A	1277086	51A-SSV5500	BEARING RETAINER SCREW (6 REQUIRED)
52	1277114	52-SSV6500	DRAG KNOB ASSEMBLY
53S	1293252	53S-SSV5500	DRAG KNOB SEAL
56	1277088	56-SSV5500	DRAG FRICTION WASHER HT100 (2 REQUIRED)
56T	1277089	56T-SSV5500	DRAG FRICTION WASHER HT100
57	1277090	57-SSV5500	KEYED METAL DRAG WASHER (2 REQUIRED)
57T	1277091	57T-SSV5500	KEYED METAL DRAG WASHER
63	1277092	63-SSV5500	SPOOL BUSHING
70	1277126	70-SSV6500LL	LIVE LINER DRAG SWITCH LEVER (LEFT)
70A	1277127	70A-SSV6500LL	LIVE LINER DRAG SWITCH LEVER (RIGHT)
70B	1277128	70B-SSV6500LL	LIVE LINER DRAG SWITCH LEVER SCREW
70C	1277003	70C-SSV4500LL	LIVE LINER DRAG SWITCH LEVER SCREW
70D	1301987	70D-SSV6500LL	LIVE LINER DRAG SWITCH LEVER SEAL (2 REQUIRED)
71	1277129	71-SSV6500LL	LIVE LINER LEVER SPRING
72	1277130	72-SSV6500LL	LIVE LINER DRAG SWITCH CAM
74	1322919	74-SSV6500LL	LIVE LINER TRIP LEVER (A)
74A	1277131	74A-SSV6500LL	LIVE LINER TRIP LEVER (B)
74B	1322920	74B-SSV6500LL	LIVE LINER TRIP LEVER SPRING
74C	1277010	74C-SSV4500LL	LIVE LINER TRIP LEVER BUSHING
74E	1277132	74E-SSV6500LL	LIVE LINER THREE PAWL LEVER
74F	1277133	74F-SSV6500LL	LIVE LINER THREE PAWL LEVER SPRING
74G	1277014	74G-SSV4500LL	LIVE LINER THREE PAWL LEVER E-CLIP
76	1277134	76-SSV6500LL	LIVE LINER CLAW SPRING
77	1277135	77-SSV6500LL	LIVE LINER STOP CLAW
77A	1277136	77A-SSV6500LL	LIVE LINER PLATE
77B	1289972	77B-SSV4500LL	LIVE LINER PLATE SCREW (3 REQUIRED)
82	1277017	82-SSV4500LL	REAR DRAG HOUSING
83	1277137	83-SSV6500LL	REAR DRAG RATCHET
83A	1277019	83A-SSV4500LL	REAR DRAG RATCHET WASHER
84	1277020	84-SSV4500LL	REAR DRAG CLICKER
84A	1277021	84A-SSV4500LL	REAR DRAG CLICKER RETAINER
85	1277022	85-SSV4500LL	REAR DRAG WASHER
85A	1277023	85A-SSV4500LL	REAR DRAG KEYED WASHER
85B	1277024	85B-SSV4500LL	REAR DRAG EARED WASHER
86	1277025	86-SSV4500LL	REAR DRAG SPRING
86A	1277026	86A-SSV4500LL	REAR DRAG NUT
87	1277027	87-SSV4500LL	REAR DRAG KNOB CLICKER
87A	1277028	87A-SSV4500LL	REAR DRAG KNOB CLICKER RING
88	1277029	88-SSV4500LL	REAR DRAG KNOB
88B	1277030	88B-SSV4500LL	REAR DRAG KNOB RING
88C	1277031	88C-SSV4500LL	REAR DRAG KNOB RING SCREW (3 REQUIRED)
88D	1277032	88D-SSV4500LL	REAR DRAG KNOB RETAINER
88E	1277033	88E-SSV4500LL	REAR DRAG KNOB SEAL
95B	1277093	95B-SSV5500	ROTOR NUT LOCKING PLATE
98	1277094	98-SSV5500	CLUTCH / SLEEVE ASSEMBLY

List of parts related to design changes is on page 3 of the schematic

KEY NO	PUREFISHING NO.	PENN PART NO.	DESCRIPTION
117	1277095	117-SSV5500	DRAG DRIVE PLATE
132	1277096	132-SSV5500	LINE ROLLER COLLAR
132A	1277097	132A-SSV5500	LINE ROLLER WASHER
231 SEE PAGE 3			
231B SEE PAGE 3			
232	1277115	232-SSV6500	BEARING RETAINER (2 REQUIRED)
232B	1302502	232B-SSV3500	BEARING RETAINER O'RING (2 REQUIRED)
233A	1277103	233A-SSV5500	HANDLE CAP
233C	1277104	233C-SSV5500	HANDLE CAP WASHER

KEY NO	PUREFISHING NO.	PENN PART NO.	DESCRIPTION
--------	-----------------	---------------	-------------

These parts below were removed by Rev 5, we are not yet sure why.

15M	1277039	15M-SSV5500	HANDLE CAP LOCK PIN (2 REQUIRED)
15N	1277040	15N-SSV5500	HANDLE CAP LOCK PIN SPRING (2 REQUIRED)

MYSTIC REEL PARTS REVISION!

NOTE:
 Many of www.mysticparts.com schematics include changes that were either made by Penn, or errors found and corrected by our parts dept.
 MRP Ver 100314 (Based on Penn's Rev. 5, 10-01-14) 70D, 74 AND 74B PART NUMBERS CORRECTED BY PENN
 MRP Ver 032924 (Parts List updated to clarify housing/gearing design changes sizing)

DESIGN CHANGES

REV 3. Bearing number changes				REV. 5 Bearings			
20A	1277042	20A-SSV5500	BALL BEARING (4 REQUIRED)	20	1308090	20-CFT5000	BALL BEARING (2 REQUIRED)
We are assuming there were errors with the bearing part numbers on the schematic, rather than that they actually changed the bearings.				20A	1277042	20A-SSV5500	BALL BEARING (2 REQUIRED)
				RECOMMEND TO USE THE REVISION 5 NUMBERS			

******* DESIGN CHANGE WARNING *******

Early SSV reels when released had a slightly different housing, crosswind gear and housing cover

The diameter of the CW gear hole and post was CHANGED and the pin/pin hole diameters on the 45- cover were changed as well

THIS DESIGN CHANGE affects the housing, crosswind gear, and housing cover

MEASURE YOUR HOUSING/GEAR

At the post where the crosswind sits or the hole in the center of the crosswind gear.

Parts that you order MUST MATCH EACH OTHER

Some parts may no longer be available, so check all three parts for availability and matching size

******* BEFORE YOU PLACE AN ORDER! *******

MEASURE and CHECK STOCK FIRST! .23 peg (1/4") SIZE			
1	1277116	1-SSV6500LL	HOUSING, BODY ASSEMBLY with .23 peg (1/4")
231	1277098	231-SSV5500	CROSSWIND OSCILLATION GEAR 0.23" I.D. (1/4")
45	1277123	45-SSV6500LL	HOUSING / BODY COVER to match (1/4")
231B	1307857	231B-SSV3500	CROSSWIND OSCILLATION GEAR SCREW (1/4")

MEASURE and CHECK STOCK FIRST! .309 peg (5/16")			
1	NLA **	1-SSV6500LL	HOUSING, BODY ASSEMBLY with .309 peg (5/16")
231	NLA **	231-SSV5500	CROSSWIND OSCILLATION GEAR 1st run 0.309" I.D. (5/16")
45	NLA **	45-SSV6500LL	HOUSING / BODY COVER to match (5/16")
231B	1277100	231B-SSV5500	CROSSWIND OSCILLATION GEAR SCREW (5/16")

**** NLA = NOT AVAILABLE as of 2024 updates (design changes were first noted back in 2014)**

<https://www.mysticparts.com/PennParts/PennSSV6500LL.aspx>