

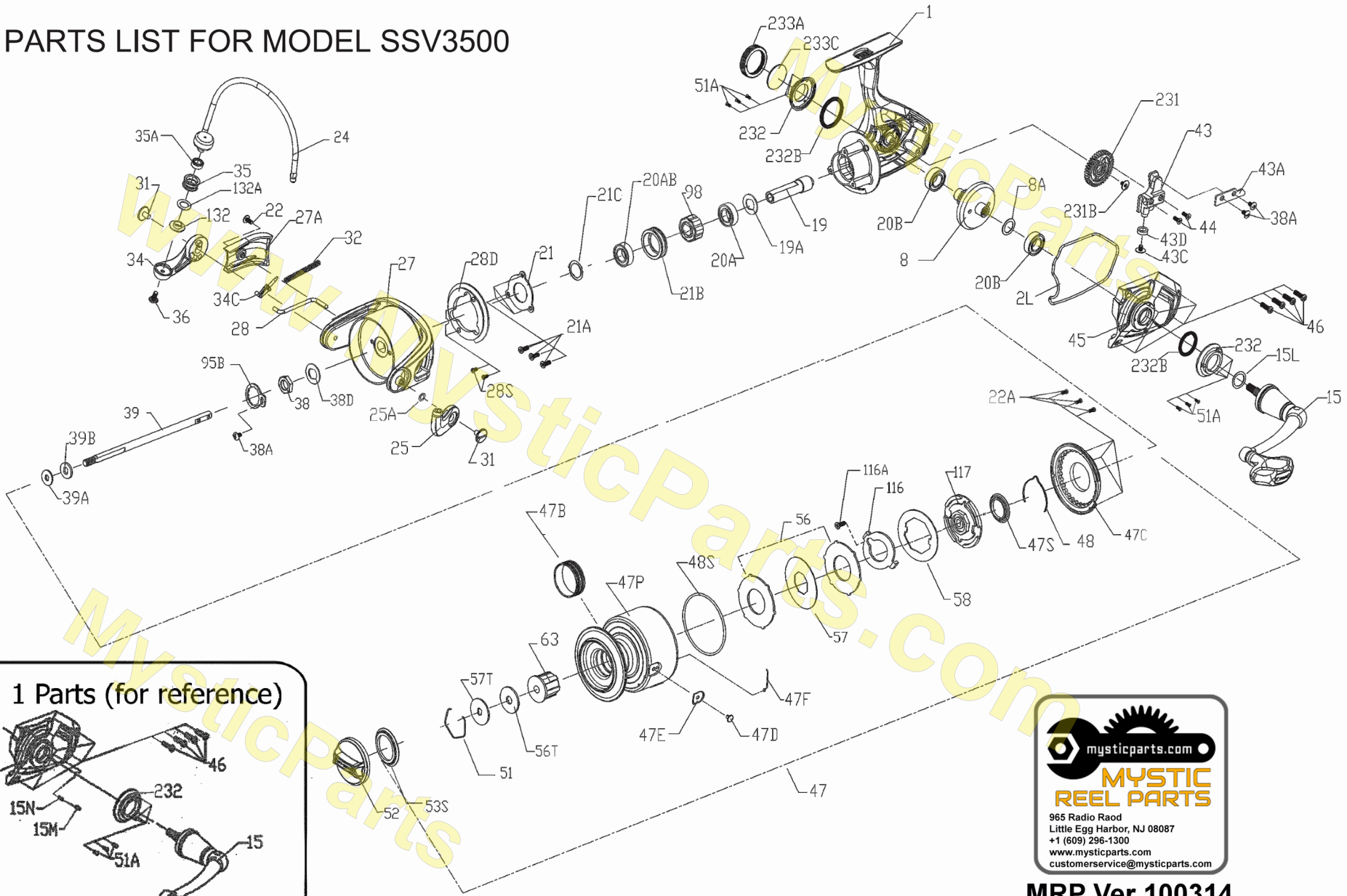

PARTS LIST FOR MODEL SSV3500



Rev. 1 Parts (for reference)

15N
15M
232
45
46
51A
15

mysticparts.com
MYSTIC REEL PARTS
965 Radio Road
Little Egg Harbor, NJ 08087
+1 (609) 296-1300
www.mysticparts.com
customerservice@mysticparts.com

MRP Ver 100314
(based on Penn's Rev. 6 10-01-14)

Penn Reel Parts list for Model: SSV3500 Spinfisher V

KEY	PUREFISHING	PENN PART	
NO	NO.	NO.	DESCRIPTION
1	SEE PAGE 3		
2L	1276798	2L-SSV3500	HOUSING BODY SEAL
8	1276919	8-SSV3500	MAIN DRIVE GEAR
8A	1276920	8A-SSV3500	DRVE GEAR SHIM WASHER
15	1276921	15-SSV3500	HANDLE ASSEMBLY
15L	1292782	15L-SSV3500	HANDLE SEAL
19	1276923	19-SSV3500	PINION GEAR
19A	1277424	19A-SSV3500	PINION GEAR WASHER
20A	SEE PAGE 3		
20B	SEE PAGE 3		
20AB	SEE PAGE 3		
21	1276925	21-SSV3500	PINION BEARING RETAINER
21A	1276926	21A-SSV3500	PINION RETAINER SCREW (3 REQUIRED)
21B	1276927	21B-SSV3500	PINION BALL BEARING COLLAR
21C	??	21C-SSV3500	SHIM
22	1276928	22-SSV3500	ROTOR COVER SCREW
22A	1277047	22A-SSV5500	DRAG COVER SCREW (3 REQUIRED)
24	1276929	24-SSV3500	BAIL ASSEMBLY
25	1276930	25-SSV3500	BAIL HOLDER (BAIL CAM)
25A	??	25A-SSV3500	SHIM, SMALL DIAMETER
27	1276931	27-SSV3500	ROTOR
27A	1276932	27A-SSV3500	ROTOR COVER
28	1276933	28-SSV3500	BAIL TRIP LEVER
28D	1276934	28D-SSV3500	ROTOR BRAKE
28S	1276935	28S-SSV3500	ROTOR BRAKE SCREW (2 REQUIRED)
31	1276936	31-SSV3500	BAIL ARM SCREW (2 REQUIRED)
32	1276937	32-SSV3500	BAIL SPRING
34	1276938	34-SSV3500	BAIL ARM
34C	1277058	34C-SSV5500	PIVOT ARM
35	1276939	35-SSV3500	LINE ROLLER
35A	1276940	35A-SSV3500	LINE ROLLER BALL BEARING
36	1277061	36-SSV5500	LINE ROLLER SCREW
38	1276941	38-SSV3500	ROTOR NUT
38A	1277063	38A-SSV5500	ROTOR NUT LOCK PLATE SCREW (3 REQUIRED)
38D	1276942	38D-SSV3500	ROTOR WASHER
39	1276943	39-SSV3500	MAIN SPOOL SHAFT
39A	1276944	39A-SSV3500	SPOOL ADJUST WASHER
39B	1276945	39B-SSV3500	MAIN SHAFT WASHER
43	1276946	43-SSV3500	OSCILLATION SLIDER (CROSSWIND BLOCK)

KEY	PUREFISHING	PENN PART	
NO	NO.	NO.	DESCRIPTION
43A	1276947	43A-SSV3500	OSCILLATION SLIDER GUIDE (CROSSWIND PLATE)
43C	1277071	43C-SSV5500	CROSSWIND OSCILLATION SLIDER BUSHING SCREW
43D	1279457	43D-SSV3500	CROSSWIND OSCILLATION SLIDER BUSHING
44	1277072	44-SSV5500	MAIN SHAFT SCREW (2 REQUIRED)
45	SEE PAGE 3		
46	1276949	46-SSV3500	HOUSING / BODY COVER SCREW (4 REQUIRED)
47	1276950	47-SSV3500	SPOOL ASSEMBLY
47B	1276951	47B-SSV3500	SPOOL BAND
47C	1276952	47C-SSV3500	DRAG COVER
47D	1276953	47D-SSV3500	LINE CLIP
47E	1276954	47E-SSV3500	LINE CLIP BUSHING
47F	1276955	47F-SSV3500	LINE CLIP RETAINER
47P	1276956	47P-SSV3500	SPOOL, BARE
47S	1277082	47S-SSV5500	DRAG COVER / DRIVE PLATE SEAL
48	1276957	48-SSV3500	SPOOL CLICKER
48S	1276958	48S-SSV3500	DRAG COVER SEAL
51	1276959	51-SSV3500	DRAG WASHER RETAINING RING
51A	1277086	51A-SSV5500	BEARING RETAINER SCREW (6 REQUIRED)
52	1276960	52-SSV3500	DRAG KNOB ASSEMBLY
53S	1293250	53S-SSV3500	DRAG KNOB SEAL
56	1276961	56-SSV3500	DRAG FRICTION WASHER HT100 (2 REQUIRED)
56T	1276962	56T-SSV3500	DRAG FRICTION WASHER HT100
57	1276963	57-SSV3500	KEYED METAL DRAG WASHER
57T	1276964	57T-SSV3500	KEYED METAL DRAG WASHER
58	1290705	58-SSV3500	EARED METAL DRAG WASHER
63	1276965	63-SSV3500	SPOOL BUSHING
95B	1277093	95B-SSV5500	ROTOR NUT LOCKING PLATE
98	1276966	98-SSV3500	CLUTCH / SLEEVE ASSEMBLY
116	1279458	116-SSV3500	KEYED DRAG WASHER LOCK PLATE
116A	1279509	116A-SSV3500	KEYED DRAG WASHER LOCK PLATE SCREW
117	1276967	117-SSV3500	DRAG DRIVE PLATE
132	1277096	132-SSV5500	LINE ROLLER COLLAR
132A	1277097	132A-SSV5500	LINE ROLLER WASHER
231	SEE PAGE 3		
231B	SEE PAGE 3		
232	1276970	232-SSV3500	BEARING RETAINER (2 REQUIRED)
232B	1302502	232B-SSV3500	BEARING RETAINER O-RING (2 REQUIRED)
233A	1276972	233A-SSV3500	HANDLE CAP
233C	1276973	233C-SSV3500	HANDLE CAP WASHER

List of parts related to design changes on Page 3

MYSTIC REEL PARTS REVISION!

NOTE:

Many of www.mysticparts.com schematics include changes that were either made by Penn, or errors found and corrected by our parts dept.

MRP Ver 100314 (Based on Penn's Rev. 6, 10-01-14)

MRP Ver 032924 (Parts List updated to clarify housing/gearing design changes sizing)

page 2 of 3

15M,15N REMOVED (NOT PURCHASABLE?)

15M	1276922	15M-SSV3500	HANDLE CAP LOCK PIN (2 REQUIRED)
15N	1277040	15N-SSV3500	HANDLE CAP LOCK PIN SPRING (2 REQUIRED)

Design Changes

Rev. 4 CHANGED BEARING INFORMATION ----- >

20A	1276924	20A-SSV3500 BALL BEARING (2 REQUIRED)
		THIS WAS UPPER AND LOWER PINION BEARING
20B	1192619	20B-3000SG BALL BEARING (2 REQUIRED)

We are assuming there were errors with the bearing part numbers on the schematic, rather than that they actually changed the bearings.

Revision 6 Bearings

20A	1276924	20A-SSV3500	BALL BEARING
20AB	1308051	20A-CFT3000	UPPER PINION BALL BEARING
20B	1317496	20B-SSV3500	BALL BEARING (2 REQUIRED)

RECOMMEND TO USE THE REVISION 6 NUMBERS

******* DESIGN CHANGE WARNING *******

Early SSV reels when released had a slightly different housing, crosswind gear and housing cover

The diameter of the CW gear hole and post was CHANGED and the pin/pin hole diameters on the 45- cover were changed as well

THIS DESIGN CHANGE affects the housing, crosswind gear, and housing cover

MEASURE YOUR HOUSING/GEAR

At the post where the crosswind sits or the hole in the center of the crosswind gear.

Parts that you order MUST MATCH EACH OTHER

Some parts may no longer be available, so check all three parts for availability and matching size

******* BEFORE YOU PLACE AN ORDER! *******

MEASURE and CHECK STOCK FIRST! .23 peg (1/4") SIZE

1	1276797	1-SSV3500	HOUSING, BODY ASSEMBLY with .23 peg (1/4")
231	1276968	231-SSV3500	CROSSWIND OSCILLATION GEAR 0.23" I.D. (1/4")
45	1276948	45-SSV3500	HOUSING / BODY COVER to match (1/4")
231B	1307857	231B-SSV3500	CROSSWIND OSCILLATION GEAR SCREW (1/4")

MEASURE and CHECK STOCK FIRST! .309 peg (5/16")

1	NLA **	1-SSV3500	HOUSING, BODY ASSEMBLY with .309 peg (5/16")
231	NLA **	231-SSV3500	CROSSWIND OSCILLATION GEAR 1st run 0.309" I.D. (5/16")
45	NLA **	45-SSV3500	HOUSING / BODY COVER to match (5/16")
231B	1277100	231B-SSV5500	CROSSWIND OSCILLATION GEAR SCREW (5/16")

NOTE: We never received or saw anything for this SSV3500 reel in 5/16" 2014 - 2024

**** NLA = NOT AVAILABLE as of 2024 updates (design changes were first noted back in 2014)**

<https://www.mysticparts.com/PennParts/PennSSV3500.aspx>

