



PARTS LIST FOR MODEL SLAMMERIV5500BLS

SLAiv5500BLS (1545765) (BAIL LESS)

mysticparts.com
MYSTIC REEL PARTS
965 Radio Road
Little Egg Harbor, NJ 08087
+1 (609) 296-1300
www.mysticparts.com
customerservice@mysticparts.com

MRP Ver. 053122

(based on Penn's Rev. 01 4-21-21)

USE THE BLUE PARTS AND NOTES marked "(BAIL-LESS)" or "(BAILED VERSION)" TO CONVERT EITHER WAY USING BOTH SLAiv5500BLS and SLAiv5500 Schematics On the MRP versions the drawings will have these parts circled in BLUE

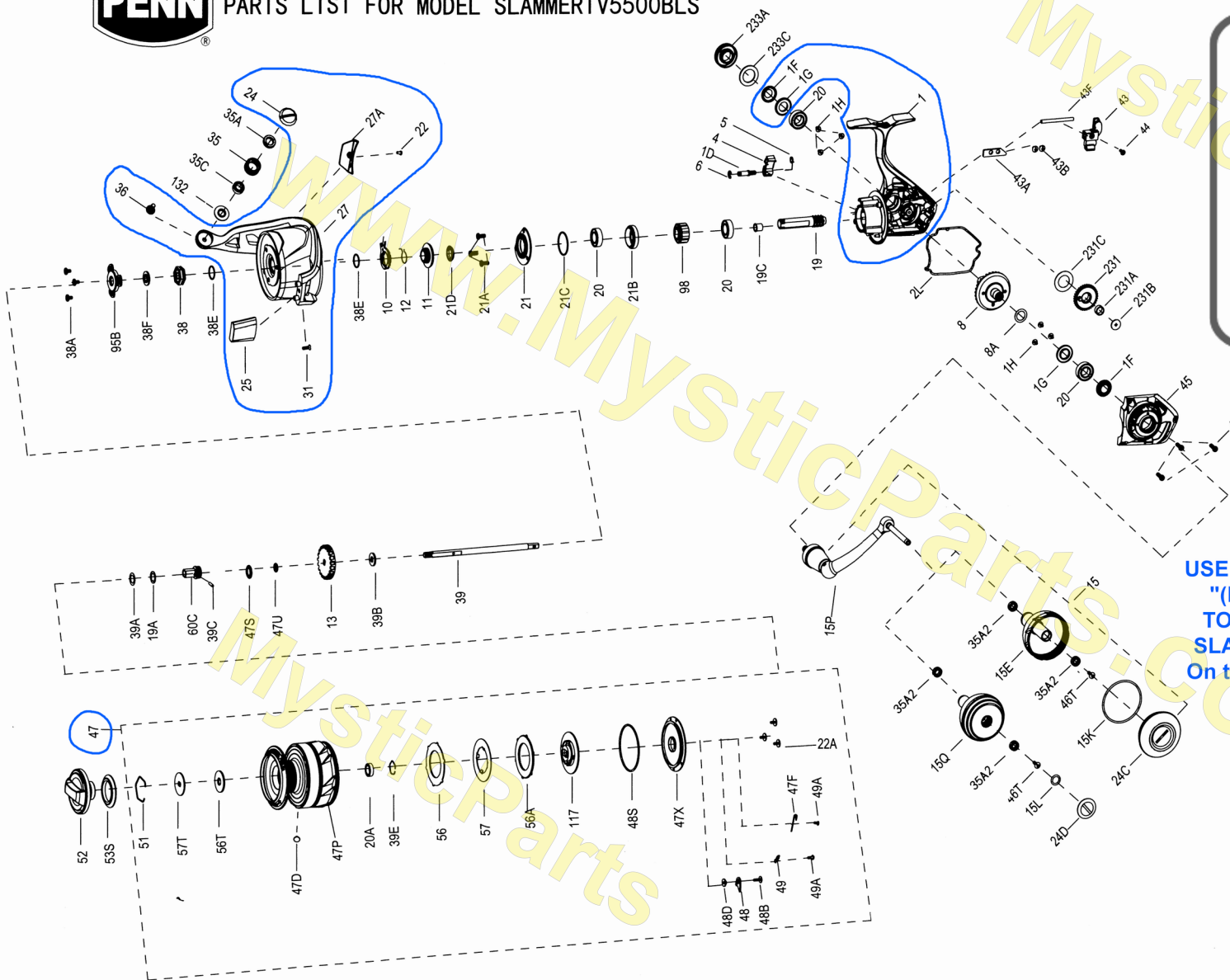

Penn Reel Parts list for Model: SLAiv5500BLS (1545765) (BAIL LESS) - SLAMMER iv SPINNING

** AUTOMATIC BAIL TRIP **

KEY PUREFISHING PART				KEY PUREFISHING PART			
NO	NO	NO.	DESCRIPTION	NO	NO	NO.	DESCRIPTION
1	1559308	1-SLAiv5500BLS	BODY/HOUSING (BAIL-LESS)	39B	1277067	39B-SSV5500	WASHER, FOR MAIN SHAFT BELOW CLICK GEAR
1D	1277140	1D-SSV7500	A/R PAWL POST	39C	1559276	39C-SLAiv5500	PIN
1E SLOPE - NOT USED ON (BAIL-LESS) VERSION				39E	1559277	39E-SLAiv5500	RETAINER
1F	1559313	1F-SLAiv5500BLS	BODY BALL BEARING SEAL (2 REQUIRED) (BAIL-LESS)	43	1419030	43-SLA5500	OSCILLATION SLIDER (CROSSWIND BLOCK)
1G	1559314	1G-SLAiv5500BLS	BODY SIDE SEAL LOCK PLATE (2 REQUIRED) (BAIL-LESS)	43A	1339536	43A-CLA5000	OSCILLATION SLIDER GUIDE
1H	1418957	1H-SLA3500	BODY SIDE SCREW (6 REQUIRED)	43B	1559161	43B-SLAiv2500	SCREW, AT ROTOR COVER AND CROSSWIND PLATE (2 REQUIRED)
2L	1419035	2L-SLA5500	BODY SEAL	43F	1339537	43F-CLA5000	GUIDE SHAFT
4	1339473	4-CLA5000	A/R PAWL POST	44	1277072	44-SSV5500	SCREW, FOR MAIN SHAFT
5	1339474	5-CLA5000	PAWL SPRING	45	1559278	45-SLAiv5500	BODY COVER ASSEMBLY
6	1277144	6-SSV7500	RETAINER CLIP	46	1277074	46-SSV5500	BODY COVER SCREW (3 REQUIRED)
8	1419034	8-SLA5500	DRIVE GEAR (MAIN GEAR) (CNC)	47	1559315	47-SLAiv5500BLS	SPOOL ASSEMBLY (BAIL-LESS)
8A	1277037	8A-SSV5500	DRIVE GEAR SHIM WASHER	47D	1259574	10-7000AF	LINE HOOK
10	1339476	10-CLA5000	A/R PAWL HOLDER	47F	1419067	47F-SLA5500	LINE CLIP RETAINER
11	1559262	11-SLAiv5500	A/R BUSHING	47P	1559316	47P-SLAiv5500BLS	SPOOL (BARE) (BAIL-LESS)
12	1339487	12-CLA5000	A/R BUSHING SPRING	47S	1559281	47S-SLAiv5500	SPOOL SEAL
13	1419053	13-SLA5500	CLICK GEAR	47U	1525247	47U-CLAi5000	DRAG COVER SEAL
19	1419022	19-SLA5500	PINION GEAR (CNC) (BRASS)	47X	1559282	47X-SLAiv5500	DRAG COVER
19A	1277424	19A-SLA3500	WASHER, AT PINION AND SPOOL SUPPORT SLEEVE (2 REQUIRED)	48	1419069	48-SLA5500	SPOOL CLICK PLATE
19C	1419023	19C-SLA5500	PINION GEAR BUSHING	48B	1419156	48B-SLA9500	SPOOL CLICKER SPRING SCREW
20	1308090	20-CFT5000	BALL BEARING (4 REQUIRED)	48D	1385579	48D-CLA3000	SPOOL CLICKER SPACER RING
20A	1385530	20A-CLA3000	SEALED BALL BEARING	48S	1276958	48S-SSV3500	SEAL, FOR DRAG COVER
21	1559266	21-SLAiv5500	BALL BEARING RETAINER	49	1385580	49-CLA3000	SPRING
21A	1277154	21A-SSV7500	RETAINER SCREW (3 REQUIRED)	49A	1559283	49A-SLAiv5500	SCREW (2 REQUIRED)
21B	1419024	21B-SLA5500	PINION BALL BEARING COLLAR	51	1277085	51-SSV5500	DRAG WASTER RETAINER
21C	1385684	21C-CLA8000	O-RING	52	1559284	52-SLAiv5500	DRAG KNOB ASSEMBLY
21D	1559267	21D-SLAiv5500	SEAL	53S	1339555	53S-CLA5000	DRAG KNOB SEAL
22	1385651	22A-CLA2000	ROTOR COVER SCREW (BAIL-LESS)	56	1419060	56-SLA5500	DRAG FRICTION WASHER
22A	1496533	22A-SLA7500	DRAG COVER SCREW (3 REQUIRED)	56A	1419062	56A-SLA5500	DRAG FRICTION WASHER
24	1559311	24-SLAiv5500BLS	BAIL ASSEMBLY (BAIL-LESS)	56T	1277089	56T-SSV5500	DRAG FRICTION WASHER
25	1559310	25-SLAiv5500BLS	BAIL HOLDER (BAIL-LESS)	57	1559285	57-SLAiv5500	KEYED DRAG WASHER
27	1559312	27-SLAiv5500BLS	ROTOR (BAIL-LESS)	57T	1419058	57T-SLA5500	KEYED DRAG WASHER
27A	1559309	27A-SLAiv5500BLS	ROTOR COVER (BAIL-LESS)	60C	1559286	60C-SLAiv5500	SPOOL SUPPORT SLEEVE
28 LEVER, 28D BRAKE AND 28S BRAKE SCREW - NOT USED ON BAIL-LESS VERSION				95B	1419009	95B-SLA3500	ROTOR NUT LOCKING PLATE
31	1447691	44A-SLAiii8500HS	BAIL ARM SCREW (2 REQUIRED) (BAIL-LESS)	98	1277094	98-SSV5500	CLUTCH/SLEEVE ASSEMBLY
32 SPRING, 34 BAIL ARM, 34C PIVOT ARM - NOT USED ON BAIL-LESS VERSION				117	1559287	117-SLAiv5500	DRAG DRIVE PLATE
35	1457403	35-SLAiii6500HS	LINE ROLLER	132	1457405	132-SLAiii6500HS	LINE ROLLER COLLAR
35A	1457404	35A-SLAiii6500HS	LINE ROLLER BUSHING	231	1419021	231-SLA5500	OSCILLAION GEAR (CROSSWIND GEAR)
35C	1559273	35C-SLAiv5500	LINE ROLLER BALL BEARING	231A	1339566	231A-CLA5000	OSCILLATION GEAR BUSHING
36	1191699	36-3000SG	LINE ROLLER SCREW (BAIL-LESS) corrected #	231B	1525918	231B-CLAi5000	OSCILLATION GEAR SCREW
38	1419051	38-SLA5500	ROTOR NUT	231C	1339525	39A-CLA5000	OSCILLATION GEAR WASHER
38A SEE PROBLEMS FOUND PAGE 3				233A	1559288	233A-SLAiv5500	HANDLE CAP
38E	1418958	38E-SLA3500	PINION GEAR SEAL	233C	1419076	233C-SLA5500	HANDLE CAP WASHER
38F	1419052	38F-SLA5500	ROTOR-MAIN SHAFT SEAL				
39	1559274	39-SLAiv5500	MAIN SHAFT				
39A	1559275	39A-SLAiv5500	WASHER, FOR SPOOL SHAFT SLEEVE				

NOTE: MYSTIC REEL PARTS REVISION!

Many of www.mysticparts.com schematics include changes that were either made by Penn, or errors found and corrected by our parts dept.

MRP Ver. 053122 (based on Penn's Rev. 01 4-21-21)

See Page 3 for all handle components

HANDLE ASSEMBLY AND COMPONENT INFO FOR THE TWO TYPES OF HANDLES

METAL KNOB HANDLE COMPONENTS

KEY	PUREFISHING PART			DESCRIPTION
NO	NO	NO.		
15	1559263	15-SLAiv5500		HANDLE ASSEMBLY (METAL KNOB)
15E	1559264	15E-SLAiv5500		HANDLE KNOB (METAL)
15K	1419073	15K-SLA5500		HANDLE KNOB CAP SEAL
15P	1422395	15P-SLA5500		SUB-HANDLE ASSEMBLY
24C	1559269	24C-SLAiv5500		HANDLE KNOB CAP (FOR METAL KNOB)
35A2	1377606	35A-BTLI8000LC		KNOB BALL BEARING (2 REQUIRED)
46T	1277046	22-SSV5500		SCREW

FOAM KNOB HANDLE COMPONENTS

KEY	PUREFISHING PART			DESCRIPTION
NO	NO	NO.		
15	N/A	N/A		FOAM HANDLE NOT AVAILABLE PRE-ASSEMBLED
15Q	1559265	15E-SLAiv5500		HANDLE KNOB (FOAM)
15L	??	15L-CLA5000		HANDLE KNOB SEAL (THICKER / LARGER) ** SEE NOTES BELOW! **
15P	1422395	15P-SLA5500		SUB-HANDLE ASSEMBLY
24D	1417808	24C-CLA5000		HANDLE KNOB CAP (FOR FOAM KNOB)
35A2	1377606	35A-BTLI8000LC		KNOB BALL BEARING (2 REQUIRED)
46T	1277046	22-SSV5500		SCREW

15L NOTES:

Penn's rev00 schematics list the 15L as 15L-cftii3000 on SLAiv SIZES 5500 THRU 6500HS (INCORRECT PART#)

15L-CFTii3000 are much smaller and thinner than the seal that was found on the 24C-CLA5000 caps during disassembly.

We could not identify an existing Penn number to match it to, so we have assigned the number as 15L-CLA5000 Seal (Thicker/Larger)

PROBLEMS FOUND AND CORRECTED

38A	4426326	24-ORRA-S10	SCREW (3 REQUIRED) ** INCORRECT PART NUMBER DO NOT USE
	1277063	38A-SSV5500	SCREW (3 REQUIRED) ** USE THIS PART
36	4422399	36-SLA9500	LINE ROLLER SCREW ** TOO LONG, DO NOT USE! ** wrong # on rev01
36	1191699	36-3000SG	LINE ROLLER SCREW (BAIL-LESS) use this

BAIL TO BAIL-LESS SLAiv5500 TO SLAiv5500BLS CONVERSION AND VISA VERSA

USE THE BLUE PARTS AND NOTES marked "(BAIL-LESS)" or "(BAILED VERSION)" TO CONVERT

ON THE SLAiv5500BLS and SLAiv5500 drawings these parts will be circled in BLUE

USE BOTH SCHEMATICS WHEN YOU ARE DOING EITHER CONVERSION SO YOU HAVE THE REFERENCES