



PARTS LIST FOR MODEL SLAMMERIV5500

SLAiv5500 (1545764) (BAILED VERSION)

mysticparts.com
MYSTIC REEL PARTS
965 Radio Road
Little Egg Harbor, NJ 08087
+1 (609) 296-1300
www.mysticparts.com
customerservice@mysticparts.com

MRP Ver. 053122
(based on Penn's Rev. 00 4-20-21)

USE THE BLUE PARTS AND NOTES marked
"(BAIL-LESS)" or "(BAILED VERSION)"
TO CONVERT EITHER WAY USING BOTH
SLAiv5500BLS and SLAiv5500 Schematics
On the MRP versions the drawings will have
these parts circled in BLUE

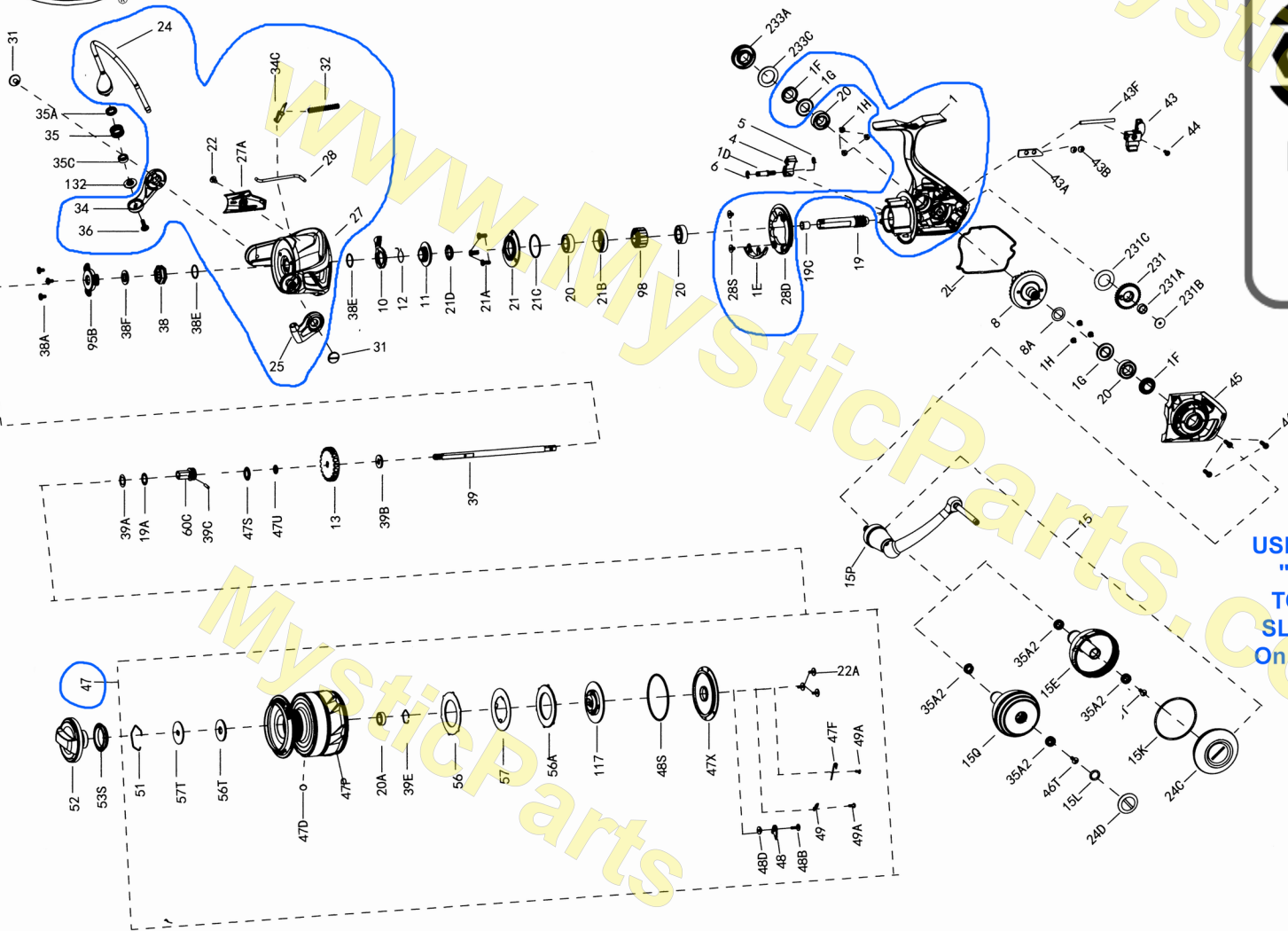

Penn Reel Parts list for Model: SLAiv5500 (1545764) (BAILED VERSION) SLAMMER iv SPINNING

** AUTOMATIC BAIL TRIP **

KEY	PUREFISHING PART			KEY	PUREFISHING PART		
NO	NO	NO.	DESCRIPTION	NO	NO	NO.	DESCRIPTION
1	1559261	1-SLAiv5500	BODY/HOUSING (BAILED VERSION)	39	1559274	39-SLAiv5500	MAIN SHAFT
1D	1277140	1D-SSV7500	A/R PAWL POST	39A	1559275	39A-SLAiv5500	WASHER, FOR SPOOL SHAFT SLEEVE
1E	1419026	1E-SLA5500	BODY SLOPE (BAILED VERSION)	39B	1277067	39B-SSV5500	WASHER, FOR MAIN SHAFT BELOW CLICK GEAR
1F	1419019	1F-SLA5500	BODY BALL BEARING SEAL (2 REQUIRED) (BAILED VERSION)	39C	1559276	39C-SLAiv5500	PIN
1G	1419020	1G-SLA5500	BODY SIDE SEAL LOCK PLATE (2 REQUIRED) (BAILED VERSION)	39E	1559277	39E-SLAiv5500	RETAINER
1H	1418957	1H-SLA3500	BODY SIDE SCREW (6 REQUIRED)	43	1419030	43-SLA5500	OSCILLATION SLIDER (CROSSWIND BLOCK)
2L	1419035	2L-SLA5500	BODY SEAL	43A	1339536	43A-CLA5000	OSCILLATION SLIDER GUIDE
4	1339473	4-CLA5000	A/R PAWL POST	43B	1559161	43B-SLAiv2500	SCREW, AT ROTOR COVER AND CROSSWIND PLATE (2 REQUIRED)
5	1339474	5-CLA5000	PAWL SPRING	43F	1339537	43F-CLA5000	GUIDE SHAFT
6	1277144	6-SSV7500	RETAINER CLIP	44	1277072	44-SSV5500	SCREW, FOR MAIN SHAFT
8	1419034	8-SLA5500	DRIVE GEAR (MAIN GEAR) (CNC)	45	1559278	45-SLAiv5500	BODY COVER ASSEMBLY
8A	1277037	8A-SSV5500	DRIVE GEAR SHIM WASHER	46	1277074	46-SSV5500	BODY COVER SCREW (3 REQUIRED)
10	1339476	10-CLA5000	A/R PAWL HOLDER	47	1559279	47-SLAiv5500	SPOOL ASSEMBLY (BAILED VERSION)
11	1559262	11-SLAiv5500	A/R BUSHING	47D	1259574	10-7000AF	LINE HOOK
12	1339487	12-CLA5000	A/R BUSHING SPRING	47F	1419067	47F-SLA5500	LINE CLIP RETAINER
13	1419053	13-SLA5500	CLICK GEAR	47P	1559280	47P-SLAiv5500	SPOOL (BARE) (BAILED VERSION)
19	1419022	19-SLA5500	PINION GEAR (CNC) (BRASS)	47S	1559281	47S-SLAiv5500	SPOOL SEAL
19A	1277424	19A-SLA3500	WASHER, AT PINION AND SPOOL SUPPORT SLEEVE (2 REQUIRED)	47U	1525247	47U-CLAi5000	DRAG COVER SEAL
19C	1419023	19C-SLA5500	PINION GEAR BUSHING	47X	1559282	47X-SLAiv5500	DRAG COVER
20	1308090	20-CFT5000	BALL BEARING (4 REQUIRED)	48	1419069	48-SLA5500	SPOOL CLICK PLATE
20A	1385530	20A-CLA3000	SEALED BALL BEARING	48B	1419156	48B-SLA9500	SPOOL CLICKER SPRING SCREW
21	1559266	21-SLAiv5500	BALL BEARING RETAINER	48D	1385579	48D-CLA3000	SPOOL CLICKER SPACER RING
21A	1277154	21A-SSV7500	RETAINER SCREW (3 REQUIRED)	48S	1276958	48S-SSV3500	SEAL, FOR DRAG COVER
21B	1419024	21B-SLA5500	PINION BALL BEARING COLLAR	49	1385580	49-CLA3000	SPRING
21C	1385684	21C-CLA8000	O-RING	49A	1559283	49A-SLAiv5500	SCREW (2 REQUIRED)
21D	1559267	21D-SLAiv5500	SEAL	51	1277085	51-SSV5500	DRAG WASTER RETAINER
22	1276928	22-SSV3500	ROTOR COVER SCREW (BAILED VERSION)	52	1559284	52-SLAiv5500	DRAG KNOB ASSEMBLY
22A	1496533	22A-SLA7500	DRAG COVER SCREW (3 REQUIRED)	53S	1339555	53S-CLA5000	DRAG KNOB SEAL
24	1559268	24-SLAiv5500	BAIL WIRE (BAILED VERSION)	56	1419060	56-SLA5500	DRAG FRICTION WASHER
25	1339500	25-CLA5000	BAIL HOLDER (BAILED VERSION)	56A	1419062	56A-SLA5500	DRAG FRICTION WASHER
27	1559270	27-SLAiv5500	ROTOR (BAILED VERSION)	56T	1277089	56T-SSV5500	DRAG FRICTION WASHER
27A	1559271	27A-SLAiv5500	ROTOR COVER (BAILED VERSION)	57	1559285	57-SLAiv5500	KEYED DRAG WASHER
28	1559272	28-SLAiv5500	ROTOR TRIP LEVER (BAILED VERSION)	57T	1419058	57T-SLA5500	KEYED DRAG WASHER
28D	1339509	28D-CLA5000	ROTOR BRAKE (BAILED VERSION)	60C	1559286	60C-SLAiv5500	SPOOL SUPPORT SLEEVE
28S	1339512	28S-CLA5000	ROTOR BRAKE SCREW (2 REQUIRED) (BAILED VERSION)	95B	1419009	95B-SLA3500	ROTOR NUT LOCKING PLATE
31	1277055	31-SSV5500	BAIL ARM SCREW (2 REQUIRED)	98	1277094	98-SSV5500	CLUTCH/SLEEVE ASSEMBLY
32	1389467	32-CLA6000	BAIL SPRING (BAILED VERSION)	117	1559287	117-SLAiv5500	DRAG DRIVE PLATE
34	1525241	34-CLAi5000	BAIL ARM (BAILED VERSION)	132	1457405	132-SLAiii6500HS	LINE ROLLER COLLAR
34C	1389469	34C-CLA6000	PIVOT ARM (BAILED VERSION)	231	1419021	231-SLA5500	OSCILLAION GEAR (CROSSWIND GEAR)
35	1457403	35-SLAiii6500HS	LINE ROLLER	231A	1339566	231A-CLA5000	OSCILLATION GEAR BUSHING
35A	1457404	35A-SLAiii6500HS	LINE ROLLER BUSHING	231B	1525918	231B-CLAi5000	OSCILLATION GEAR SCREW
35C	1559273	35C-SLAiv5500	LINE ROLLER BALL BEARING	231C	1339525	39A-CLA5000	OSCILLATION GEAR WASHER
36	1422399	36-SLA9500	LINE ROLLER SCREW (BAILED VERSION)	233A	1559288	233A-SLAiv5500	HANDLE CAP
38	1419051	38-SLA5500	ROTOR NUT	233C	1419076	233C-SLA5500	HANDLE CAP WASHER
38A	SEE PROBLEMS FOUND PAGE 3						
38E	1418958	38E-SLA3500	PINION GEAR SEAL				
38F	1419052	38F-SLA5500	ROTOR-MAIN SHAFT SEAL				

NOTE: MYSTIC REEL PARTS REVISION!

Many of www.mysticparts.com schematics include changes that were either made by Penn, or errors found and corrected by our parts dept.

MRP Ver. 053122 (based on Penn's Rev. 00 4-20-21)

See Page 3 for all handle components

HANDLE ASSEMBLY AND COMPONENT INFO FOR THE TWO TYPES OF HANDLES

METAL KNOB HANDLE COMPONENTS

KEY	PUREFISHING PART			DESCRIPTION
NO	NO	NO.		
15	1559263	15-SLAiv5500		HANDLE ASSEMBLY (METAL KNOB)
15E	1559264	15E-SLAiv5500		HANDLE KNOB (METAL)
15K	1419073	15K-SLA5500		HANDLE KNOB CAP SEAL
15P	1422395	15P-SLA5500		SUB-HANDLE ASSEMBLY
24C	1559269	24C-SLAiv5500		HANDLE KNOB CAP (FOR METAL KNOB)
35A2	1377606	35A-BTLIi8000LC		KNOB BALL BEARING (2 REQUIRED)
46T	1277046	22-SSV5500		SCREW

FOAM KNOB HANDLE COMPONENTS

KEY	PUREFISHING PART			DESCRIPTION
NO	NO	NO.		
15	N/A	N/A		FOAM HANDLE NOT AVAILABLE PRE-ASSEMBLED
15Q	1559265	15E-SLAiv5500		HANDLE KNOB (FOAM)
15L	??	15L-CLA5000		HANDLE KNOB SEAL (THICKER / LARGER) ** SEE NOTES BELOW! **
15P	1422395	15P-SLA5500		SUB-HANDLE ASSEMBLY
24D	1417808	24C-CLA5000		HANDLE KNOB CAP (FOR FOAM KNOB)
35A2	1377606	35A-BTLIi8000LC		KNOB BALL BEARING (2 REQUIRED)
46T	1277046	22-SSV5500		SCREW

15L NOTES:

Penn's rev00 schematics list the 15L as 15L-cftii3000 on SLAiv SIZES 5500 THRU 6500HS (INCORRECT PART#)

15L-CFTii3000 are much smaller and thinner than the seal that was found on the 24C-CLA5000 caps during disassembly.

We could not identify an existing Penn number to match it to, so we have assigned the number as 15L-CLA5000 Seal (Thicker/Larger)

PROBLEMS FOUND AND CORRECTED

38A	1126326	24-ORRA-519	SCREW (3 REQUIRED) ** INCORRECT PART NUMBER DO NOT USE
	1277063	38A-SSV5500	SCREW (3 REQUIRED) ** USE THIS PART

BAIL TO BAIL-LESS SLAiv5500 TO SLAiv5500BLS CONVERSION AND VISA VERSA

USE THE BLUE PARTS AND NOTES marked "(BAIL-LESS)" or "(BAILED VERSION)" TO CONVERT

ON THE SLAiv5500BLS and SLAiv5500 drawings these parts will be circled in BLUE

USE BOTH SCHEMATICS WHEN YOU ARE DOING EITHER CONVERSION SO YOU HAVE THE REFERENCES