

MysticParts

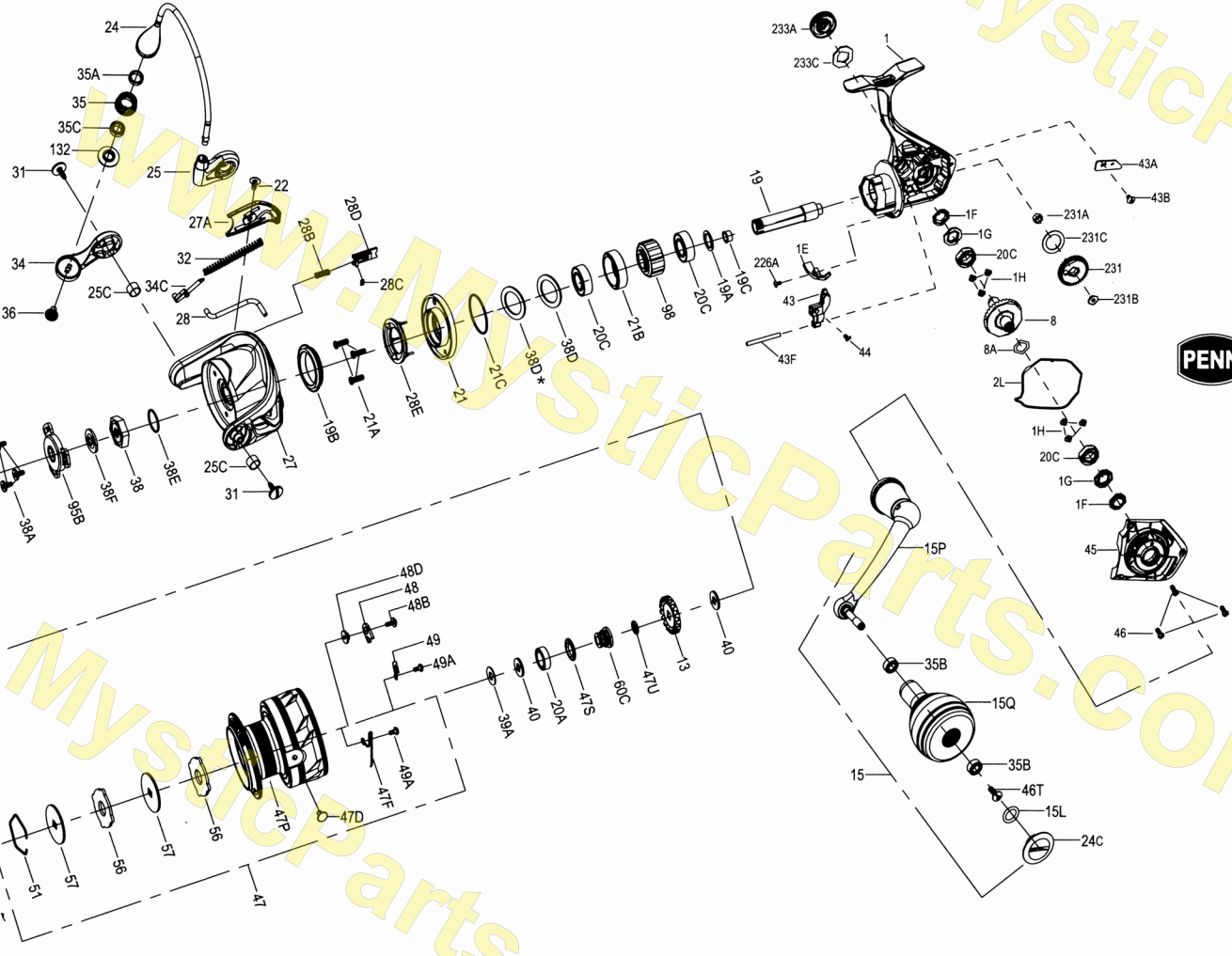

PARTS LIST FOR MODEL SLAMMER IV 2500  
**SLAiv2500 (1545759)**

mysticparts.com  
**MYSTIC REEL PARTS**  
965 Radio Road  
Little Egg Harbor, NJ 08087  
+1 (609) 296-1300  
www.mysticparts.com  
customerservice@mysticparts.com

**MRP Ver. 053122**  
(based on Penn's Rev. 00 4-20-21)

Penn Reel Parts list for Model: SLAiv2500 (1545759) SLAMMER iv SPINNING

\*\* AUTOMATIC BAIL TRIP \*\*

KEY	PUREFISHING	PART	
NO	NO	NO	DESCRIPTION
1	1559037	1-SLAiv2500	BODY/HOUSING
1E	1525142	1E-CLAIi2000	BODY SLOPE
1F	1418955	1F-SLA3500	BODY BALL BEARING SEAL (2 REQUIRED)
1G	1418956	1G-SLA3500	BODY SIDE SEAL LOCK PLATE (2 REQUIRED)
1H	1418957	1H-SLA3500	BODY SIDE SCREW (6 REQUIRED)
2L	1559038	2L-SLAiv2500	BODY SEAL
8	1418972	8-SLA3500	DRIVE GEAR (MAIN GEAR) (CNC BRASS TECH) 6.2:1
8A	1418973	8A-SLA3500	DRIVE GEAR SHIM WASHER
13	1418974	13-SLA3500	CLICK GEAR
19	1559151	19-SLAiv2500	PINION GEAR (CNC BRASS TECH) 6.2:1
19A	1277424	19A-SLA3500	WASHER, AT PINION AND SPOOL SUPPORT SLEEVE (2 REQUIRED)
19B	1559267	19B-SLAiv5500	SEAL
19C	1418978	19C-SLA3500	PINION GEAR BUSHING
20A	1385530	20A-CLA3000	BEARING, FOR SPOOL SHAFT
<b>20B / 20C SEE PAGE 3 ERROR NOTES!</b>			
21	1559152	21-SLA iv2500	BALL BEARING RETAINER
21A	1418980	21A-SLA3500	RETAINER SCREW (3 REQUIRED)
21B	1525147	21B-CLAIi2000	PINION BALL BEARING COLLAR
21C	1385605	21C-CLA2000	BODY HEAD SEAL
22	1092845	22-CLA2000	SCREW, FOR ROTOR COVER
24	1559153	24-SLAiv2500	BAIL WIRE
25	1527948	25-CLAIi2500	BAIL HOLDER
25C	1188261	25C-CLA2000	BAIL HOLDER
27	1559154	27-SLAiv2500	ROTOR
27A	1559155	27A-SLAiv2500	ROTOR COVER
28	1525175	28-CLAIi2500	ROTOR TRIP LEVER
28B	1346982	28B-CLA2000	SPRING
28C	1385547	28C-CLA3000	ROTOR BRAKE SEAL
28D	1525152	28D-CLAIi2000	ROTOR BRAKE (RECTANGULAR)
28E	1559156	28E-SLAiv2500	ROTOR BRAKE SLICE (ROUND)
31	1385619	31-CLAIi1000	BAIL ARM SCREW (2 REQUIRED)
32	1525910	32-CLAIi2000	BAIL SPRING
34	1525153	34-CLAIi2000	BAIL ARM
34C	1385621	34C-CLA2000	PIVOT ARM
35	1559157	35-SLAiv2500	LINE ROLLER
35A	1474155	35A-SLAiii3500	LINE ROLLER BUSHING
35C	1525199	35C-CLAIi3000	LINE ROLLER BALL BEARING
36	1389419	36-CLA2000	LINE ROLLER SCREW
38	1418993	38-SLA3500	ROTOR NUT
38A	1385554	38A-CLA2000	SCREW, FOR ROTOR NUT COVER (3 REQUIRED)
38D	1559205	38D-SLAiv3500	WASHER, AT UPPER PINION BEARING (THIN)
38D *	1257343	38D-SLA3500	WASHER, AT UPPER PINION BEARING ABOVE THIN ONE (THICK)

\* This appears to be the only reel with two 38D washers

See Page 3 for all handle components

KEY	PUREFISHING	PART	
NO	NO	NO	DESCRIPTION
38E	1418958	38E-SLA3500	PINION GEAR SEAL
38F	1418959	38F-SLA3500	ROTOR-MAIN SHAFT SEAL
39	1559158	39-SLAiv2500	MAIN SHAFT
39A	1494694	39A-SSVi2500LL	WASHER, FOR SPOOL SHAFT SLEEVE
40	1422917	40-SLA3500	WASHER, FOR CLICK GEAR (2 REQUIRED)
43	1559159	43-SLAiv2500	OSCILLATION SLIDER (CROSSWIND BLOCK)
43A	1559160	43A-SLAiv2500	SLIDER RETAINER PLATE
43B	1559161	43B-SLAiv2500	SCREW
43F	1559162	43F-SLAiv2500	GUIDE SHAFT
44	1525911	44-CLAIi3000	SCREW
45	1559163	45-SLAiv2500	BODY COVER ASSEMBLY
46	1385567	46-CLA3000	BODY COVER SCREW (3 REQUIRED)
47	1559164	47-SLAiv2500	SPOOL ASSEMBLY
47D	1276953	47D-SSV3500	LINE HOOK
47F	1385637	47F-CLA2000	LINE CLIP RETAINER
47P	1559165	47P-SLAiv2500	SPOOL (BARE)
47S	1494699	47S-SSVi2500LL	SPOOL SEAL
47U	1494700	47U-SSVi2500LL	DRAG COVER SEAL
48	1385578	48-CLA3000	SPOOL CLICK PLATE
48B	1385581	48B-CLA3000	SPOOL CLICKER SPRING SCREW
48D	1385579	48D-CLA3000	SPOOL CLICKER SPACER RING
49	1385580	49-CLA3000	SPRING, FOR SPOOL CLICKER
49A	1341547	49A-SSV7500LC	SCREW, FOR SPOOL CLICKER SPRING (2 REQUIRED)
51	1277085	51-SSV5500	DRAG WASTER RETAINER
<b>52 See Page 3 knob options</b>			
53S	1447888	53S-CFTi3000	DRAG KNOB SEAL
56	1385584	56-CLA3000	DRAG FRICTION WASHER (2 REQUIRED)
57	1525213	57-CLAIi3000	KEYED DRAG WASHER (2 REQUIRED)
60C	1559167	60C-SLAiv2500	SPOOL SUPPORT SLEEVE
95B	1419009	95B-SLA3500	ROTOR NUT LOCKING PLATE
98	1559168	98-SLAiv2500	CLUTCH/SLEEVE ASSEMBLY
132	1525167	132- CLAIi2000	LINE ROLLER COLLAR
226A	1525914	226A-CLAIi3000	SCREW
231	1559169	231-SLAiv2500	OSCILLAION GEAR (CROSSWIND GEAR)
231A	1385595	231A-CLA2000	OSCILLATION GEAR BUSHING
231B	1307857	231B-SSV3500	OSCILLATION GEAR SCREW
231C	1559170	231C-SLAiv2500	OSCILLATION GEAR WASHER
233A	1559216	233A-SLAiv3500	HANDLE CAP
233C	1419016	233C-SLA3500	HANDLE CAP WASHER

NOTE: MYSTIC REEL PARTS REVISION!

Many of www.mysticparts.com schematics include changes that were either made by Penn, or errors found and corrected by our parts dept.

MRP Ver. 053122 (based on Penn's Rev. 00 4-20-21)

## HANDLE ASSEMBLY AND COMPONENT INFO

### FOAM KNOB HANDLE COMPONENTS

KEY NO	PUREFISHING NO	PART NO	DESCRIPTION
15	1559149	15-SLAiv2500	HANDLE ASSEMBLY (ROUND FOAM KNOB)
<b>15Q</b>	<b>1559150</b>	<b>15Q-SLAiv2500</b>	<b>HANDLE KNOB (ROUND FOAM) ** this is what came on handle assembly as of rev00 1st release **</b>
<b>15L</b>	<b>N/A</b>	<b>15L-CLA5000</b>	<b>HANDLE KNOB CAP SEAL ** use this part number **</b>
15P	1422394	15P-SLA3500	SUB-HANDLE ASSEMBLY
24C	1417808	24C-CLA5000	HANDLE KNOB CAP (FOR ROUND FOAM KNOB)
35B	1418393	35B-CLA3000	BALL BEARING (2 REQUIRED)
46T	1341500	3-SSV7500LC	SCREW

#### 15 and 15Q NOTES:

Penn's rev00 schematics list the 15 handle assembly on both SLAiv2500 and SLAiv2500 CONFIRMED by reel comparison apart from a typo where they listed it as 3500 size (fixed) the 1559149 is confirmed to be 15-SLAiv2500 on handles off of both reels

15Q knob on the SLAiv2500HS rev00 was listed as 15Q-CLAIi4000 (Metal Knob) and is compatible to the handle

So it is possible that later releases of the SLAiv2500HS reel may have the metal knob on the handle, but would need a different # for the full assembly

**15Q 1552554 15Q-CLAIi4000 HANDLE KNOB (ROUND METAL VERSION) \*\* LISTED SEPARATELY ON REV00 \*\***

#### 15L NOTES:

Penn's rev00 schematics list the 15L as 15L-CLA2000 on SLAiv2500, SLAiv2500HS, SLAiv3500, SLAiv4500 & SLAiv4500HS (INCORRECT PART#)

15L-CLA2000 are much smaller and thinner than the seal that was found on the 24C-CLA3000 caps during disassembly.

We could not identify an existing Penn number to match it to, so we have assigned the number as **15L-CLA5000** Seal (Thicker/Larger)

### PROBLEMS FOUND AND CORRECTED

38A	<del>4449424</del>	<del>20C-7000AF</del>	<del>SCREW (3 REQUIRED) ** INCORRECT PART NUMBER DO NOT USE</del>
	1277063	38A-SSV5500	SCREW (3 REQUIRED) ** USE THIS PART
20C	1385532	20C-CLA3000	BEARING, TWO ON PINION, TWO ON EITHER SIDE OF MAIN GEAR (4 REQUIRED)

WAS 20B ON ORIGINAL PENN REV00 SCHEMATIC, MRP CALLS IT 20C TO MATCH THE PART PREFIX

## DRAG KNOB OPTIONS

For the SLAiv2500, SLAiv2500HS and SLAiv2500DX

The drag knobs ARE interchangeable

KEY NO	PUREFISHING NO	PART NO	DESCRIPTION
52	1559166	52-SLAiv2500	DRAG KNOB ASSEMBLY (Gold Text HT-100)
52	1559177	52-SLAiv2500HS	DRAG KNOB ASSEMBLY (Gold Text, HT-100 & "Less/More" Arrows)
52	1559191	52-SLAiv2500DX	DRAG KNOB ASSEMBLY (Silver Text, HT-100)

The differences in the knobs are cosmetic

Tested on reels and they do work on all SLAiv2500 sizes

## LINKS

PARTS: <https://www.mysticparts.com/PennParts/PennSLAiv2500.aspx>

HS Conversion Parts:  
<https://www.mysticparts.com/PennParts/Parts/CONVERSION/SLAiv2500to2500HSinfo.aspx>