

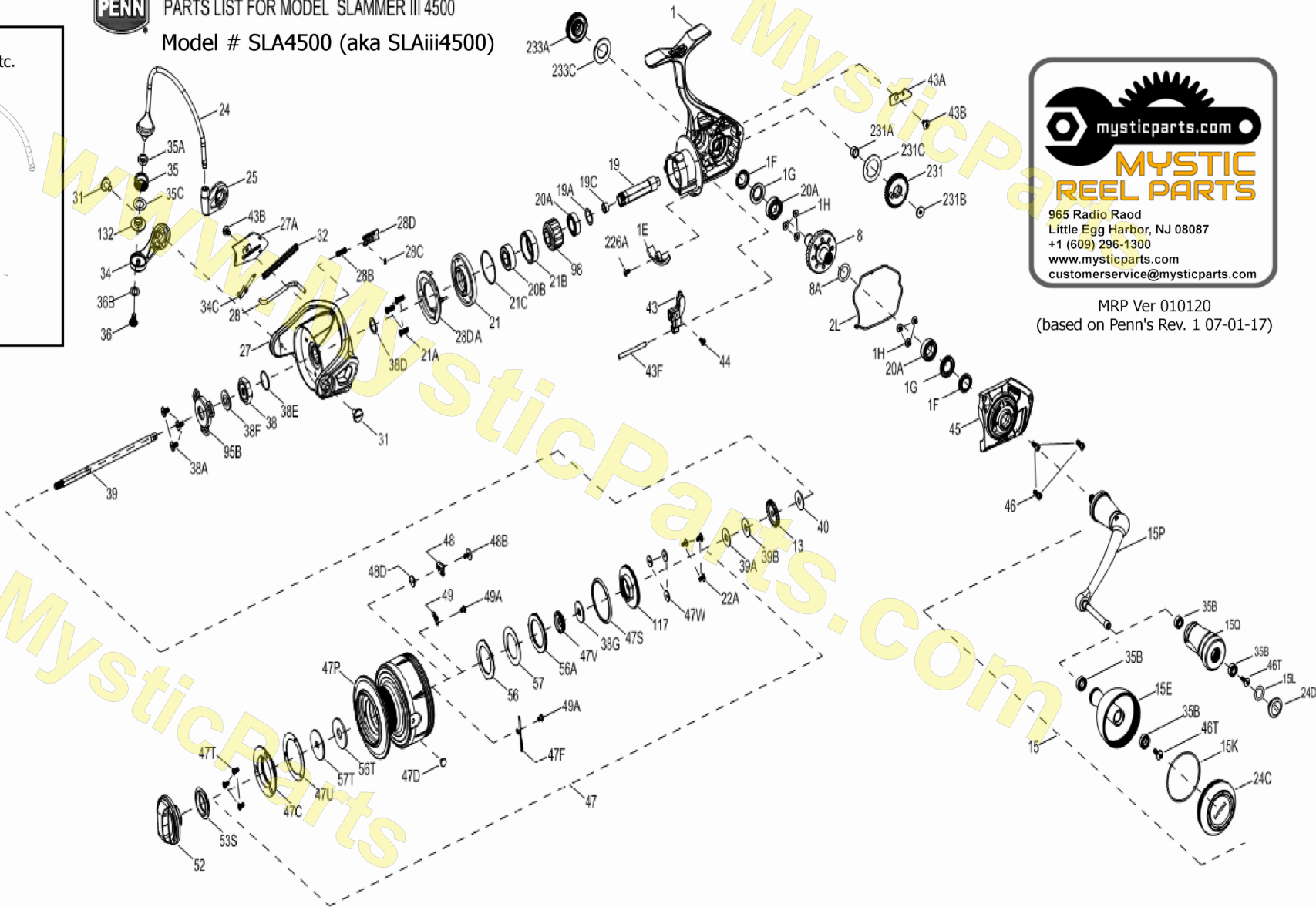

PARTS LIST FOR MODEL SLAMMER III 4500

Model # SLA4500 (aka SLAiii4500)

ORIGINAL BAIL SETUP
With different bail, roller etc.
Bushing only version

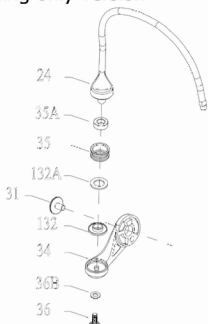

**MYSTIC
REEL PARTS**

965 Radio Raod
Little Egg Harbor, NJ 08087
+1 (609) 296-1300
www.mysticparts.com
customerservice@mysticparts.com

MRP Ver 010120
(based on Penn's Rev. 1 07-01-17)

Penn Reel Parts list for Model: SLA4500 (SLAiii4500) SLAMMER iii SPINNING (AUTOMATOIC BAIL TRIP)

KEY PUREFISHING PART				KEY PUREFISHING PART			
NO	NO	NO	DESCRIPTION	NO	NO	NO	DESCRIPTION
1	1418970	1-SLA4500	BODY/HOUSING	43	1418996	43-SLA3500	OSCILLATION SLIDER (CROSSWIND BLOCK)
1E	1418954	1E-SLA3500	BODY SLOPE	43A	1418997	43A-SLA3500	SLIDER RETAINER PLATE
1F	1418955	1F-SLA3500	BODY BALL BEARING SEAL (2 REQUIRED)	43B	1277070	43B-SSV5500	OSCILLATION SLIDER GUIDE SCREW (2 REQUIRED)
1G	1418956	1G-SLA3500	BODY SIDE SEAL LOCK PLATE (2 REQUIRED)	43F	1418998	43F-SLA3500	GUIDE SHAFT
1H	1418957	1H-SLA3500	BODY SIDE SCREW (6 REQUIRED)	44	1126275	44-CLA2000	SCREW
2L	1418971	2L-SLA3500	BODY SEAL	45	1419000	45-SLA4500	BODY COVER ASSEMBLY
8	1418972	8-SLA3500	DRIVE GEAR (MAIN GEAR)	46	1385567	46-CLA3000	BODY COVER SCREW (3 REQUIRED)
8A	1418973	8A-SLA3500	DRIVE GEAR SHIM WASHER	47	1419002	47-SLA4500	SPOOL ASSEMBLY
13	1418974	13-SLA3500	CLICK GEAR	47C	1385571	47C-CLA3000	DRAG COVER
15 ALL HANDLE COMPONENTS SEE PG 3				47D	1276953	47D-SSV3500	LINE HOOK
19	1418977	19-SLA3500	PINION GEAR	47F	1385637	47F-CLA2000	LINE CLIP RETAINER
19A	1277424	19A-SLA3500	PINION GEAR WASHER	47P	1419005	47P-SLA4500	SPOOL (BARE)
19C	1418978	19C-SLA3500	PINION GEAR BUSHING	47S	1418965	47S-SLA3500	SPOOL SEAL
20A	PART CORRECTED SEE CHANGES LIST NEXT PAGE			47T	1341544	47T-SSV7500LC	REAR COVER SCREW (3 REQUIRED)
20B	1385531	20B-CLA3000	SEALED BALL BEARING	47U	1418960	47U-SLA3500	DRAG COVER SEAL
21	1418979	21-SLA3500	BALL BEARING RETAINER	47V	1418963	47V-SLA3500	SEALED NUT
21A	1418980	21A-SLA3500	RETAINER SCREW (3 REQUIRED)	47W	1418966	47W-SLA3500	PROTECTIVE WASHER (3 REQUIRED)
21B	1385535	21B-CLA3000	PINION BALL BEARING COLLAR	48	1385578	48-CLA3000	SPOOL CLICK PLATE
21C	1418981	21C-SLA3500	BODY HEAD SEAL	48B	1385581	48B-CLA3000	SPOOL CLICKER SPRING SCREW
22A	1418982	22A-SLA3500	DRAG COVER SCREW (3 REQUIRED)	48D	1385579	48D-CLA3000	SPOOL CLICKER SPACER RING
24 ALL BAIL WIRE COMPONENTS SEE PG 3				49	1259579	49-7000AF	SPRING
27	1418987	27-SLA4500	ROTOR	49A	1294638	49A-CLA2000	SCREW (2 REQUIRED)
27A	1418989	27A-SLA4500	ROTOR COVER	52	1419007	52-SLA3500	DRAG KNOB ASSEMBLY
28	1418991	28-SLA4500	ROTOR TRIP LEVER	53S	1385583	53S-CLA3000	DRAG KNOB SEAL
28B	1346982	28B-CLA2000	SPRING	56	1418961	56-SLA3500	DRAG FRICTION WASHER
28C	1385547	28C-CLA3000	ROTOR BRAKE SEAL	56A	1418962	56A-SLA3500	DRAG FRICTION WASHER
28D	1385545	28D-CLA3000	ROTOR BRAKE (RECTANGULAR)	56T	1277089	56T-SSV5500	DRAG FRICTION WASHER
28DA	1418967	28D-SLA3500	ROTOR BRAKE (ROUND)	57	1419008	57-SLA3500	KEYED DRAG WASHER
31	1276936	31-SSV3500	BAIL ARM SCREW (2 REQUIRED)	57T	1276985	57T-SSV4500	KEYED DRAG WASHER
32	1385549	32-CLA3000	BAIL SPRING	95B	1419009	95B-SLA3500	ROTOR NUT LOCKING PLATE
34	1385550	34-CLA3000	BAIL ARM	98	1276966	98-SSV3500	CLUTCH/SLEEVE ASSEMBLY
34C	1385551	34C-CLA3000	PIVOT ARM	117	1419010	117-SLA3500	DRAG DRIVE PLATE
38	1418993	38-SLA3500	ROTOR NUT	132	1277096	132-SSV5500	LINE ROLLER COLLAR
38A	1119121	20C-7000AF	SCREW (3 REQUIRED)	132A	1277098	132A-SSV5500	LINE ROLLER WASHER
38D	1257343	38D-SLA3500	ROTOR WASHER	226A	1385651	226A-CLA2000	REAR COVER SCREW (3 REQUIRED)
38E	1418958	38E-SLA3500	PINION GEAR SEAL	231	1419014	231-SLA4500	OSCILLAION GEAR (CROSSWIND GEAR)
38F	1418959	38F-SLA3500	ROTOR-MAIN SHAFT SEAL	231A	1385595	231A-CLA2000	OSCILLATION GEAR BUSHING
38G	1418964	38G-SLA3500	SPOOL-MAIN SHAFT SEAL	231B	1307857	231B-SSV3500	OSCILLATION GEAR SCREW
39	1418995	39-SLA4500	MAIN SHAFT	231C	1385594	231C-CLA2000	OSCILLATION GEAR WASHER
				233A	1419015	233A-SLA3500	HANDLE CAP
				233C	1419016	233C-SLA3500	HANDLE CAP WASHER

KEY PUREFISHING PART

NO NO NO DESCRIPTION

METAL KNOB HANDLE COMPONENTS			
15	1418975	15-SLA3500	HANDLE ASSEMBLY (METAL KNOB)
15E	1418976	15E-SLA3500	HANDLE KNOB (METAL)
15K	1418968	15K-SLA3500	HANDLE KNOB CAP SEAL
15P	1422394	15P-SLA3500	SUB-HANDLE ASSEMBLY
24C	1418985	24C-SLA3500	HANDLE KNOB CAP (FOR METAL KNOB)
35B	1418393	35B-CLA3000	BALL BEARING (2 REQUIRED)
46T	1341500	3-SSV7500LC	SCREW

KEY PUREFISHING PART

NO NO NO DESCRIPTION

FOAM KNOB HANDLE COMPONENTS			
15	NA	NA	FOAM HANDLE NOT AVAILABLE PRE-ASSEMBLED
15Q	1417805	15E-CLA3000	HANDLE KNOB (FOAM)
15L	1417804	15L-CLA2000	HANDLE KNOB SEAL
15P	1422394	15P-SLA3500	SUB-HANDLE ASSEMBLY
24D	1417806	24C-CLA3000	HANDLE KNOB CAP (FOR FOAM KNOB)
35B	1418393	35B-CLA3000	BALL BEARING (2 REQUIRED)
46T	1341500	3-SSV7500LC	SCREW

BAIL WIRE, LINE ROLLER PARTS CHANGED FOR REV 1

ORIGINAL W/JUST BUSHINGS

24	1418984	24-SLA4500	BAIL WIRE
35	1276939	35-SSV3500	LINE ROLLER
35A	1418992	35A-SLA3500	LINE ROLLER BUSHING
132	1277096	132-SSV5500	LINE ROLLER COLLAR
132A	1277097	132A-SSV5500	LINE ROLLER WASHER
36	1277061	36-SSV5500	LINE ROLLER SCREW
36B	1417809	36B-CLA6000	BAIL ARM SCREW WASHER (OLD 36B-CLA5000)
25	1385539	25-CLA3000	BAIL HOLDER

NEWER W/BALL BEARING/BUSHING COMBO

24	1474157	24-SLAiii4500	BAIL WIRE
35	1474154	35-SSViii3500	LINE ROLLER
35A	1474155	35A-SLAiii3500	LINE ROLLER BUSHING
35C	1385552	35A-CLA3000	LINE ROLLER BALL BEARING
132	1474156	132-SLAiii3500	LINE ROLLER COLLAR
NO 132A ON THE NEWER SETUP			
36	1277061	SAME PART	
36B	1417809	SAME PART	
25	1385539	SAME PART	

PROBLEMS FOUND WHEN TAKING NEW EARLY REELS APART:

39A	1276944	39A-SSV3500	SPOOL ADJUST WASHER, PLASTIC
39B	1276945	39B-SSV3500	MAIN SHAFT WASHER, METAL
40	1422917	40-SLA3500	WASHER, PLASTIC

39B AND 40 ON THE SLA3500 AND SLA4500 REELS WERE IN REVERSED POSITIONS

THE 39B METAL WASHER WAS FOUND BELOW THE 13 RATCHET ON THE SHAFT INSTEAD OF ABOVE IT

39A THERE MAY BE MORE OF THESE PLASTIC SHIM WASHERS THAN SHOWN ON THE DIAGRAM

POSITIONING MAY ALSO BE ALTERED AS THEY SHIM IT TO GET THE SPOOL TO A SPECIFIC POSITION ON THE SHAFT

CHANGES AND CORRECTIONS:

20A	1385532	20C-CLA3000	SEALED BALL BEARING (3 REQUIRED)
		CORRECTED	

The original schematic listed 20A-CLA3000 which is TOO SMALL - DO NOT USE IT

found after release of rev 1 schematic and added notes 11/19/19

we will update this if they correct the part in their bins

MYSTIC REEL PARTS REVISION!

NOTE:

Many of www.mysticparts.com schematics include changes that were either made by Penn, or errors found and corrected by our parts dept.

MRP Ver 010120 (based on Penn's Rev. 1 07-01-17)