



PARTS LIST FOR MODEL FATHOM SD 25N
REEL PART NO. 1238444

www.PENNparts.com

Scott's Bait & Tackle

Penn Parts Dept.
945 Radio Road
Tuckerton NJ 08087
(609) 296-1300

No Minimum Order!
Plus, Parts in stock
that Penn doesn't
carry anymore.

SBT Ver. 073016

(based on Penn's Rev 4, 10/13/2014)

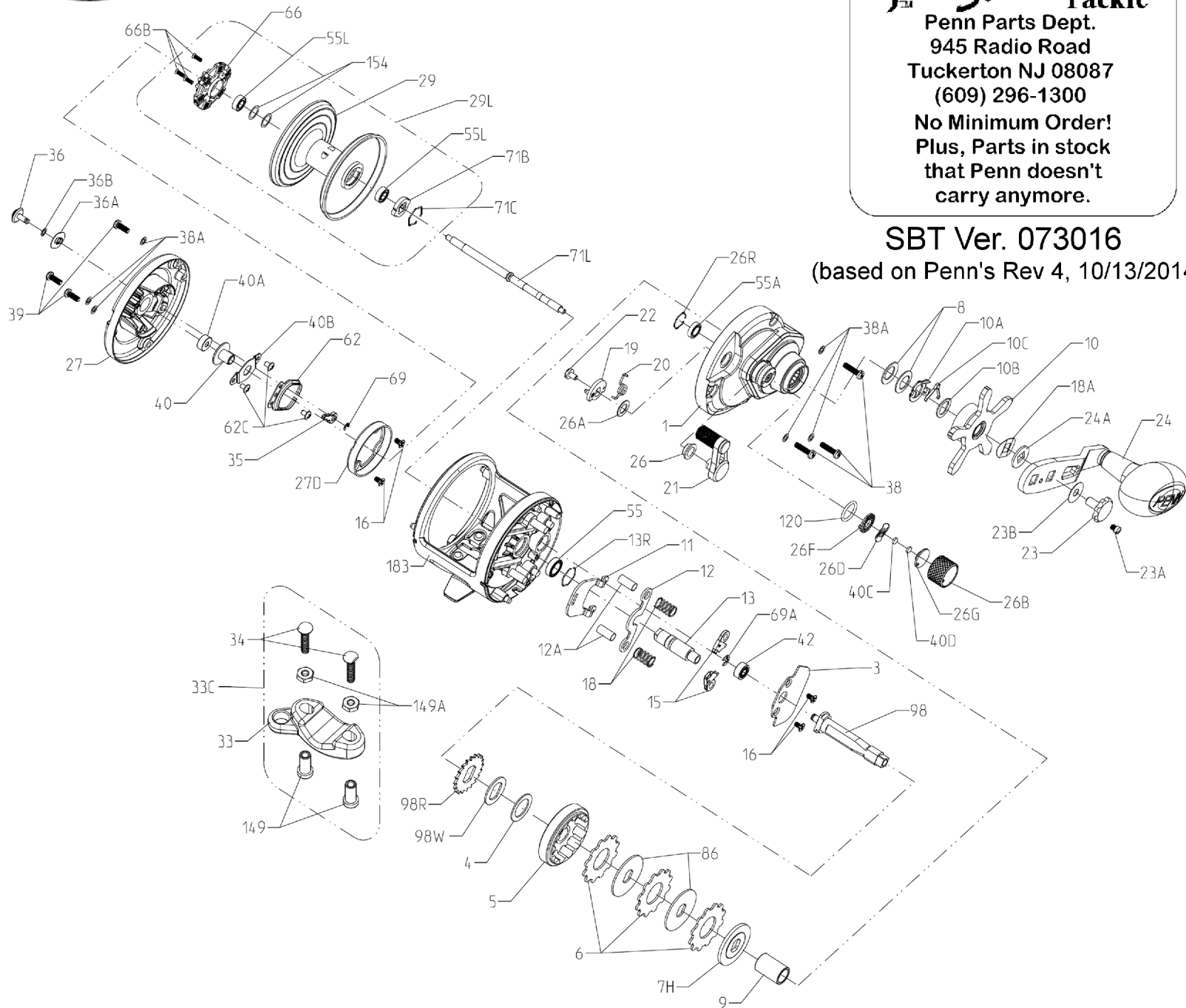

Penn Reel Parts list for:

| KEY | PUREFISHING | PENN PART | |
|-----|-------------|-------------|---|
| NO | PART # | NO. | DESCRIPTION |
| 1 | 1242812 | 1-FTHSD25N | RIGHT SIDE PLATE ASSEMBLY |
| 3 | 1242817 | 3-FTHSD25N | BRIDGE |
| 5 | 1242789 | 5-FTHSD12 | MAIN GEAR |
| 6 | 1237037 | 6-TRQ40 | DRAG WASHER, TABBED HT 100 (3 REQUIRED) |
| 7H | 1242788 | 7H-FTHSD12 | HEAVY METAL DRAG WASHER |
| 8 | 1188709 | 8-FTH20LW | SPRING WASHER (2 REQUIRED) |
| 9 | 1188708 | 9-FTH20LW | SPACING SLEEVE |
| 10 | 1188713 | 10-FTH20LW | STAR DRAG |
| 10A | 1188711 | 10A-FTH20LW | STAR CLICK RETAINER |
| 10B | 1188710 | 10B-FTH20LW | STAR CLICK WASHER |
| 10C | 1188712 | 10C-525MAG2 | STAR CLICK SPRING |
| 11 | 1242818 | 11-FTHSD25N | ECCENTRIC JACK |
| 13 | 1242790 | 13-FTHSD12 | PINION GEAR |
| 13R | 1229364 | 13R-TRQ40 | RETAINING RING |
| 15 | 1188675 | 15-FTH20LW | DOG |
| 16 | 1188676 | 16-FTH20LW | BRIDGE SCREW (4 REQUIRED) |
| 18 | 1188677 | 18-FTH20LW | PINION YOKE SPRING (2 REQUIRED) |
| 18A | 1188714 | 18A-FTH20LW | KEYED SPRING WASHER |
| 19 | 1188691 | 19-FTH20LW | ECCENTRIC |
| 20 | 1242806 | 20-FTHSD12 | ECCENTRIC SPRING |
| 21 | 1242831 | 21-FTHSD25N | ECCENTRIC LEVER |
| 22 | 1188690 | 22-FTH20LW | ECCENTRIC SCREW |
| 23 | 1208117 | 23-FTH20LW | HANDLE SCREW |
| 23A | 1188717 | 23A-FTH20LW | HANDLE LOCK SCREW |
| 23B | 1207784 | 23B-FTH20LW | HANDLE SCREW WASHER |
| 24 | 1242787 | 24-FTHSD12 | HANDLE |
| 24A | 1188715 | 24A-FTH20LW | HANDLE THRUST WASHER |
| 26 | 1188692 | 26-FTH20LW | BUSHING |
| 26A | 1242792 | 26A-FTHSD12 | WASHER |
| 26B | 1208114 | 26B-FTH20LW | SPOOL TENSION CONTROL CAP |
| 26D | 1125769 | 26D-525MAG2 | SPOOL TENSION CLICK SPRING |

Model: FTHSD25N FATHOM 25N Star Drag

| KEY | PUREFISHING | PENN PART | |
|-----|-------------|--------------|------------------------------|
| NO | PART # | NO. | DESCRIPTION |
| 26F | 1125768 | 26F-525MAG2 | SPOOL TENSION RATCHET, INNER |
| 26G | 1125772 | 26G-525MAG2 | SPOOL TENSION RATCHET, OUTER |
| 26R | 1214654 | 26R-525MAG2 | RETAINING RING |
| 27 | 1242813 | 27-FTHSD25N | LEFT SIDE PLATE |
| 27D | 1242794 | 27D-FTHSD12 | CENTRIFUGAL BRAKE PATH |
| 29 | 1242814 | 29-FTHSD25N | SPOOL SUB-ASSEMBLY |
| 29L | 1242837 | 29L-FTHSD25N | SPOOL COMPLETE ASSEMBLY |
| 33 | 1182754 | 33N-113 | ROD CLAMP |
| 33C | 1229936 | 33C-TRQ40 | ROD CLAMP KIT |
| 34 | 1182788 | 34-45 | ROD CLAMP SCREW |
| 34C | 1182862 | 34C-45 | ROD CLAMP SCREW W/NUTS |
| 35 | 1188656 | 35-FTH20LW | CLICK TONGUE |
| 36 | 1242819 | 36-FTHSD25N | CLICK BUTTON |
| 36A | 1208113 | 36A-FTH20LW | CLICK WASHER |
| 36B | 1188651 | 36B-FTH20LW | CLICK PVC WASHER |
| 38 | 1188698 | 38-FTH20LW | SCREW M3X12 (3 REQUIRED) |
| 38A | 1188649 | 38A-FTH20LW | FLAT WASHER (6 REQUIRED) |
| 39 | 1188638 | 39-FTH20LW | SCREW M3X8 (3 REQUIRED) |
| 40 | 1230004 | 40-TRQ40 | BALL BEARING |
| 40A | 1242804 | 40A-FTHSD12 | BEARING |
| 40B | 1242805 | 40B-FTHSD12 | PROTECTOR BEARING |
| 40C | 1208115 | 40C-525MAG2 | WASHER, METAL THRUST |
| 40D | 1125771 | 40D-525MAG2 | WASHER, RUBBER THRUST |
| 42 | 1188661 | 40-FTH20LW | BALL BEARING |
| 55 | 1214665 | 55-525MAG2 | BALL BEARING |
| 55A | 1214666 | 55A-525MAG2 | BALL BEARING 6X10X2.5 |
| 55L | 1192031 | 55L-965 | BALL BEARING (2 REQUIRED) |
| 62 | 1188664 | 62-FTH20LW | CLICK SPRING |
| 62C | 1188654 | 62C-FTH20LW | SCREW M26.X4 (3 REQUIRED) |
| 66 | 1242797 | 66-FTHSD12 | CENTRIFUGAL BRAKE |
| 66B | 1242798 | 66B-FTHSD12 | SCREW (3 REQUIRED) |

| | | | | | | | |
|-----|---------|--------------|--------------------------------|------|---------|--------------|---------------------------------|
| 69 | 1188657 | 69-FTH20LW | RETAINER 2X5 | 98R | 1242800 | 98R-FTHSD12 | ANTI-REVERSE RATCHET |
| 69A | 1188659 | 69A-FTH20LW | RETAINER 3X7 (3 REQUIRED) | 98W | 1242801 | 98W-FTHSD12 | RATCHET THRUST WASHER |
| 71B | 1230226 | 71B-TRQ40 | SPOOL DRIVER | 120 | 1184522 | 120-113H | O'RING |
| 71C | 1230227 | 71C-TRQ40 | RETAINING RING | 149 | 1184702 | 149-45 | ROD CLAMP LONG NUT (2 REQUIRED) |
| 71L | 1242815 | 71L-FTHSD25N | SPOOL SHAFT | 149A | 1184706 | 149-200 | HEX NUT (2 REQUIRED) |
| 86 | 1184251 | 86-49L | DRAG WASHER KEYED (2 REQUIRED) | 154 | 1242803 | 154-FTHSD12 | SHIM (AS NEEDED) |
| 98 | 1188700 | 98-FTH20LW | MAIN GEAR SHAFT | 183 | 1242816 | 183-FTHSD25N | FRAME |

NOTE: Many of www.pennparts.com schematics include changes that were either made by Penn, or errors found and corrected by our parts dept.
SBT Ver. 073016 (Based on Penn's Rev 4, 10/31/14)

4 1180775 4-349 FIBER WASHER (Rev 0 Schematic typo had listed 4-60, but this was incorrect)

BELOW PENN CHANGED THE DESIGN ON LATER MANUFACTURING RUNS:

AS PER REV 0 Penn schematics:

12 1181271 12-555 PINION YOKE (brass)
12A 1208062 12A-FTH20LW YOKE POST BUSHING (2 REQUIRED)

Opening in yoke measures .263" and brass yoke is .043" thick

Diameter of screw holes was ALSO changed, so if changing to the yoke, you must also change the bushings.

**Increased thickness in the yoke in later reels sits better/snugger in the groove of the #13 pinion, so there is less slop in shifting eccentric

AS PER REV 4 Penn schematics:

12 1318919 12-FTHSD12 PINION YOKE (stainless)
12A 1372972 12A-FTHSD12 YOKE POST BUSHING (2 REQUIRED)

Opening in yoke measures .253" and stainless? yoke is .063" thick**