



PARTS LIST FOR MODEL  
FATHOM 25N LD2  
REEL PART NO. I292932



**MYSTIC REEL PARTS**  
965 Radio Road  
Little Egg Harbor, NJ 08087  
+1 (609) 296-1300  
www.mysticparts.com  
customerservice@mysticparts.com

**MRP Ver 052423**  
(based on Penn's Rev 3 9-9-19)

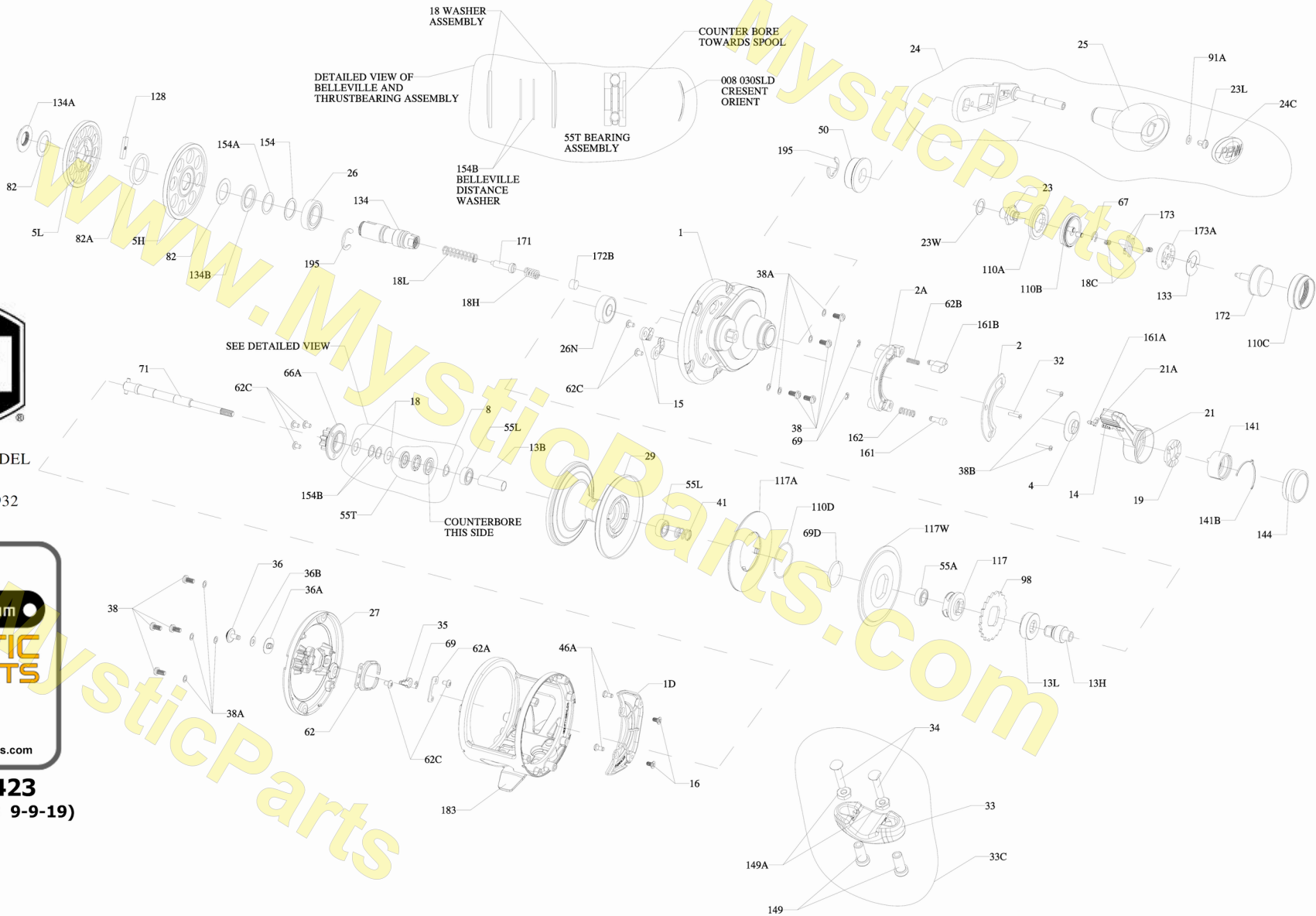

Penn Reel Parts list for Model: Fathom Leverdrag FTH25NLD2 (GUN SMOKE / GOLD) 1292932

KEY NO	PENN PART #	PUREFISHING PART #	DESCRIPTION	KEY NO	PENN PART #	PUREFISHING PART #	DESCRIPTION
1	1-FTH25NLD2	1309859	HANDLE SIDE PLATE	26	26-TRQ40NLD2	1265023	BALL BEARING
1D	1D-FTH25NLD2	1309864	BRIDGE	26N	26N-25	1182145	BALL BEARING
2	2-TRQ30LD2SMK	1264972	QUADRANT RING (GUN SMOKE)	27	27-FTH25NLD2	1309872	NON-HANDLE SIDE PLATE
2A	2A-TRQ30LD2	1364976	DRAG LEVER RATCHET	29	29-FTH25NLD2	1309877	SPOOL (GUN SMOKE/GOLD)
4	4-TRQ15LD2	1264978	LEVER WASHER	32	32-TRQ15LD2S	1265049	SCREW, FLAT HEAD (SILVER)
5H	5-FTH25NLD2HS	1264981	MAIN GEAR HIGH SPEED	<b>33, 33c, 34, 149, 149A See PG 3</b>			
5L	5-FTH25NLD2LS	1264982	MAIN GEAR LOW SPEED	35	35-FTH20LW	1188656	CLICK TONGUE
8	8-30SLD	1257843	SPRING WASHER	36	36-FTHSD12	1242796	CLICK BUTTON
13B	13B-FTH25NLD2	1309867	SPOOL SLEEVE	36A	36A-FTH20LW	1208113	CLICK WASHER
13H	13-FTH25NLD2HS	1264993	HIGH SPEED PINION	36B	36B-FTH20LW	1188651	SPACER, CLICK BUTTON
13L	13-FTH25NLD2LS	1264994	LOW SPEED PINION	38	38-FTH15LD	1309885	SCREW (8 REQUIRED)
14	14-535	1181406	SPRING, DRAG LEVER PIN	38A	38A-FTH20LW	1188649	FLAT WASHER (8 REQUIRED)
15	15-TRQ40	1229374	DOG ASSEMBLY (2 REQUIRED)	38B	38-TRQ40NLD2S	1265055	SCREW (2 REQUIRED)
16	16-FTH20LW	1188686	BRIDGE SCREW (2 REQUIRED)	41	41-TRQ40NLD2	1265056	SPRING, DRAG DISENGAGING
18	18-TRQ40NLD2	1265001	WASHER, SPRING (2 REQUIRED)	<b>46A SEE NOTES PG 3</b>			
18C	18C-15KG	1181632	SPRING SHIFT BUTTON (2 REQUIRED)	50	50-FTH30LD2	1309888	GEAR SHIELD
18H	18H-30SLD2	1265002	SPRING	55A	55A-50SLD	1238912	BALL BEARING (NON-HANDLE SIDE PLATE)
18L	18L-30SLD2	1265003	SPRING	55L	55L-FTH20LD2	1286985	BALL BEARING (SPOOL) (2 REQUIRED)
<b>19 SEE NOTES PG 3</b>				55T	55T-30SLD	1238913	BEARING ASSEMBLY
21	21-TRQ30LD2SMK	1265007	LEVER DRAG (GUN SMOKE)	62	62-FTH20LW	1188664	CLICK SPRING
21A	21A-TRQ30LD2	1265011	LEVER/QUADRANT SPACER	62A	62A-FTH20LW	1188653	GUARD FOR CLICK SPRING
23	23-12VS	1229458	HANDLE SCREW	62B	62-TRQ40	1236596	SPRING, STRICK BUTTON
23L	23L-750	1191283	HANDLE KNOB SCREW	62C	62C-FTH20LW	1188654	SCREW (7 REQUIRED)
23W	23W-TRQ40NLD2	1286986	HANDLE NUT WASHER	66A	66A-FTHLD	1265059	CLICK RATCHET
24	24-TRQ30LD2SMK	1277510	HANDLE ASSEMBLY (GUN SMOKE/GOLD)	67	67-30VS	1184105	RETAINING RING
24C	24C-66	1191335	HANDLE KNOB CAP	<b>69 69B SEE NOTES PG 3</b>			
25	25-TRQ40	1240293	HANDLE KNOB	69D	69D-FTH15LD	1265060	RETAINING RING, DRAG

KEY	PENN	PUREFISHING	
NO	PART #	PART #	DESCRIPTION
71	71-FTH25NLD2	1309891	SPOOL SPINDLE
82	82-TRQ40NLD2	1265070	WASHER, TEFLON (2 REQUIRED)
82A	82A-30SLD2	1265071	WASHER, TEFLON
91A	91A-TRQ40NLD2	1277514	HANDLE KNOB WASHER
98	98-FTH40NLD2	1265073	DOG RATCHET
110A	110A-12VS	1230438	RING, HANDLE SCREW LOCKING
110B	110B-TRQ40NLD2B	1265074	BASE ASSEMBLY (BLACK)
110C	110C-12VSB	1265075	RETAINER, SHIFT BUTTON (BLACK)
110D	110D-FTH15LD2	1309895	RETAINING RING
117	117-FTH15LD2	1265076	DRIVE PLATE
117A	117A-FTH25NLD2	1309898	DRAG WASHER (ASSEMBLY)
117W	117W-FTH25NLD2	1309901	DRAG WASHER, METAL
128	128-30SLD2	1265084	SHIFT KEY
133	133-12VS	1230583	PLATE, RETAINING
134	134-30SLD2	1265085	GEAR STUD
134A	134A-30SLD2	1265086	GEAR STUD NUT
134B	134B-30SLD2	1265087	WASHER, SUPPORT GEAR STUD
141	141-TRQ15LD2	1265088	CAM FOLLOWER

KEY	PENN	PUREFISHING	
NO	PART #	PART #	DESCRIPTION
141B	141B-TRQ15LD2	1265089	SPRING, PRESET KNOB
144	144-TRQ15LD2B	1265090	PRESET KNOB (BLACK)
149	149-45	1184702	ROD CLAMP NUT (2 REQUIRED)
149A	149-200	1184706	ROD CLAMP HEX NUT (2 REQUIRED)
154	154-TRQ40NLD2	1265092	GEAR STUD SHIM (AS REQUIRED)
154A	154A-TRQ40NLD2	1306668	GEAR STUD SHIM .004 (AS REQUIRED)
<b>154B SEE NOTES PG 3</b>			
161	161-TRQ40NLD2	1265097	LOCATING BUTTON
161A	161A-TRQ15LD2	1265098	PIN, LEVER CLICK
161B	161B-TRQ40NLD2	1265099	STRIKE BUTTON
<b>162 SEE PAGE 3 NOTES</b>			
171	171-30SLD2	1265101	PLUNGER GEAR SHIFT
172	172-12VSB	1265102	SHIFT BUTTON ASSEMBLY (BLACK)
172B	172B-30VS	1184831	SPACER
173	173-12VS	1192384	CATCH, SHIFTER (2 REQUIRED)
173A	173A-12VS	1230664	HOLDER, CATCH
183	183-FTH25NLD2	1309906	FRAME ASSEMBLY
195	195-40	1184955	GEAR STUD RET. E-RING (2 REQUIRED)

### Changes / Corrections

19	19-TRQ15LD2	1265004	DRAG CAM (rev 1 )
	<b>19-TRQ30LD2</b>	<b>1296247</b>	<b>DRAG CAM (rev 3)</b>
	<i>19-TRQ15LD2 IS THE SAME AS 19-TRQ30LD2 AND 19-TRQ40LD2</i>		
<b>46A</b>	<del>46A-4300</del>	<del>1183585</del>	<del>SCREW, COVER (2 REQUIRED) ERROR on REV0</del>
	<b>46A-FTH15LD2</b>	<b>1507714</b>	<b>SCREW, COVER (2 REQUIRED) REV 3 - ** USE THIS PART! **</b>
<b>69</b>	<b>69-FTH20LW</b>	<b>1188657</b>	<b>RETAINING RING (3 REQUIRED)</b>
69B	69B-50	1184125	RETAINING - ERROR REV0 use 69-FTH20LW
<b>162</b>	<del>162-50</del>	<del>1184795</del>	<del>SPRING - Rev 1 Error</del>
	<b>162-TRQ40NLD2</b>	<b>1318280</b>	<b>SPRING - REV 3 - ** USE THIS PART! **</b>

### 154B THERE ARE TWO OF THESE WITH TWO DIFFERENT THICKNESSES

154B	154B-FTH25NLD2	1309903	BELLEVILLE DISTANCE WASHER THICKER (1 REQUIRED)
			MEASURES: OD X ID X TH (MM): 8.27 X 6.22 X .23
154B	154B-FTH40NLD2	1309904	BELLEVILLE DISTANCE WASHER THINNER (1 REQUIRED)
			MEASURES: OD X ID X TH (MM): 8.27 X 6.22 X .09

### CLAMP COMPONENTS

33C	33C-TRQ40NLD2	1290731	ROD CLAMP KIT
33	33-TRQ	1290729	ROD CLAMP ALUMINUM
34	34-45	1182788	ROD CLAMP SCREW (2 REQUIRED)
149	149-45	1184702	ROD CLAMP NUT (2 REQUIRED)
149A	149-200	1184706	ROD CLAMP HEX NUT (2 REQUIRED)

### **MYSTIC REEL PARTS REVISION!**

NOTE: Many of www.mysticparts.com schematics include changes that were either made by Penn, or errors found and corrected by our parts dept.  
MRP Ver 052423 (based on Penn's Rev 3 9-9-19)