

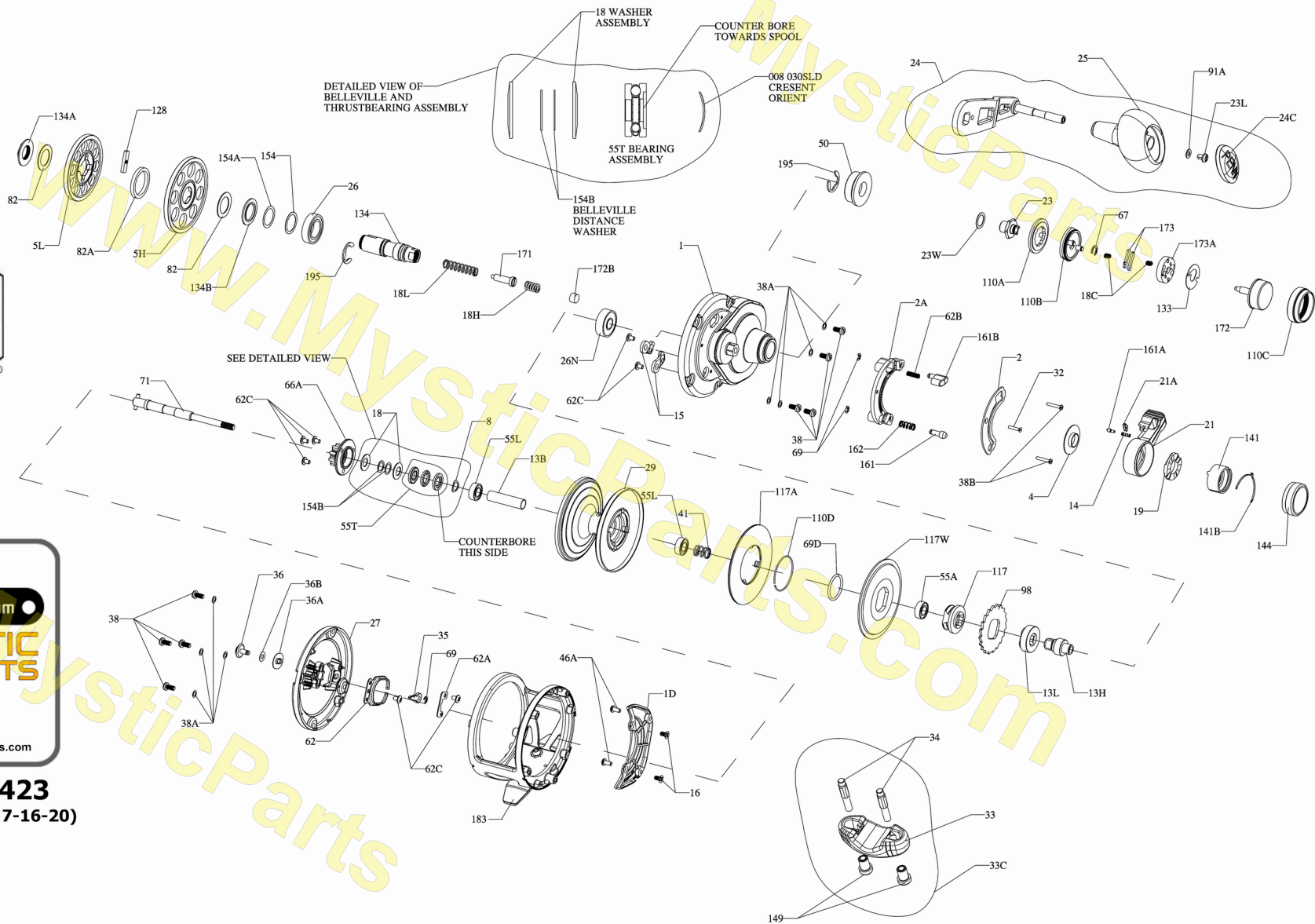

PARTS LIST FOR MODEL
FATHOM 15XN LD2
REEL PART NO. 1525512



MRP Ver 052423
(based on Penn's Rev 1 7-16-20)



Penn Reel Parts list for Model: Fathom Leverdrag FTH15XNLD2 (GUN SMOKE / GOLD) 1525512

KEY NO	PENN PART #	PUREFISHING PART #	DESCRIPTION	KEY NO	PENN PART #	PUREFISHING PART #	DESCRIPTION
1	1-FTH15XNLD2	1541514	HANDLE SIDE PLATE	26	26-TRQ40NLD2	1265023	BALL BEARING
1D	1D-FTH25NLD2	1309864	BRIDGE	26N	26N-25	1182145	BALL BEARING
2	2-TRQ30LD2SMK	1264972	QUADRANT RING (GUN SMOKE)	27	27-FTH15XNLD2	154516	NON-HANDLE SIDE PLATE
2A	2A-TRQ30LD2	1264976	DRAG LEVER RATCHET	29	29-FTH15XNLD2	154517	SPOOL (GUN SMOKE/GOLD)
4	4-TRQ15LD2	1264978	LEVER WASHER	32	32-TRQ15LD2S	1265049	SCREW, FLAT HEAD (SILVER)
5H	5-FTH25NLD2HS	1264981	MAIN GEAR HIGH SPEED	33, 33c, 34, 149, 149A CLAMP PARTS SEE PG 3			
5L	5-FTH25NLD2LS	1264982	MAIN GEAR LOW SPEED	35	35-FTH20LW	1188656	CLICK TONGUE
8	8-30SLD	1257843	SPRING WASHER	36	36-FTHSD12	1242796	CLICK BUTTON
13B	13B-FTH15XNLD2	1541515	SPOOL SLEEVE	36A	36A-FTH20LW	1208113	CLICK WASHER
13H	13-FTH25NLD2HS	1264993	HIGH SPEED PINION	36B	36B-FTH20LW	1188651	SPACER, CLICK BUTTON
13L	13-FTH25NLD2LS	1264994	LOW SPEED PINION	38	38-FTH15LD	1309885	SCREW (6 REQUIRED)
14	14-535	1181406	SPRING, DRAG LEVER PIN	38A	38A-FTH20LW	1188649	FLAT WASHER (6 REQUIRED)
15	15-TRQ40	1229374	DOG ASSEMBLY (2 REQUIRED)	38B	38-TRQ40NLD2S	1265055	SCREW (2 REQUIRED)
16	16-FTH20LW	1188686	BRIDGE SCREW (2 REQUIRED)	41	41-TRQ40NLD2	1265056	SPRING, DRAG DISENGAGING
18	18-TRQ40NLD2	1265001	WASHER, SPRING (2 REQUIRED)	46A SEE PAGE 3 NOTES			
18C	18C-15KG	1181632	SPRING SHIFT BUTTON (2 REQUIRED)	50	50-FTH30LD2	1309888	GEAR SHIELD
18H	18H-30SLD2	1265002	SPRING	55A	55A-50SLD	1238912	BALL BEARING (NON-HANDLE SIDE PLATE)
18L	18L-30SLD2	1265003	SPRING	55L	55L-FTH20LD2	1286985	BALL BEARING (SPOOL) (2 REQUIRED)
19 SEE PAGE 3 NOTES				55T	55T-30SLD	1238913	BEARING ASSEMBLY
21	21-TRQ30LD2SMK	1265007	LEVER DRAG (GUN SMOKE)	62	62-FTH20LW	1188664	CLICK SPRING
21A	21A-TRQ30LD2	1265011	LEVER/QUADRANT SPACER	62A	62A-FTH20LW	1188653	GUARD FOR CLICK SPRING
23	23-12VS	1229458	HANDLE SCREW	62B	62-TRQ40	1236596	SPRING, STRICK BUTTON
23L	23L-750	1191283	HANDLE KNOB SCREW	62C	62C-FTH20LW	1188654	SCREW (4 REQUIRED)
23W	23W-TRQ40NLD2	1286986	HANDLE NUT WASHER	66A	66A-FTHLD	1265059	CLICK RATCHET
24	24-TRQ30LD2SMK	1277510	HANDLE ASSEMBLY (GUN SMOKE/GOLD)	67	67-30VS	1184105	RETAINING RING
24C	24C-66	1191335	HANDLE KNOB CAP	69	69-FTH20LW	1188657	RETAINING
25	25-TRQ40	1240293	HANDLE KNOB	69D	69D-FTH15LD	1265060	RETAINING RING, DRAG

MysticParts.com

KEY	PENN	PUREFISHING	
NO	PART #	PART #	DESCRIPTION
71	71-FTH15XNLD2	1541518	SPOOL SPINDLE
82	82-TRQ40NLD2	1265070	WASHER, TEFLON (2 REQUIRED)
82A	82A-30SLD2	1265071	WASHER, TEFLON
91A	91A-TRQ40NLD2	1277514	HANDLE KNOB WASHER
98	98-FTH40NLD2	1265073	DOG RATCHET
110A	110A-12VS	1230438	RING, HANDLE SCREW LOCKING
110B	110B-TRQ40NLD2B	1265074	BASE ASSEMBLY (BLACK)
110C	110C-12VSB	1265075	RETAINER, SHIFT BUTTON (BLACK)
110D	110D-FTH15LD2	1309895	RETAINING RING
117	117-FTH15LD2	1309896	DRIVE PLATE
117A	117A-FTH25NLD2	1309898	DRAG WASHER (ASSEMBLY)
117W	117W-FTH25NLD2	1309901	DRAG WASHER, METAL
128	128-30SLD2	1265084	SHIFT KEY
133	133-12VS	1230583	PLATE, RETAINING
134	134-30SLD2	1265085	GEAR STUD
134A	134A-30SLD2	1265086	GEAR STUD NUT
134B	134B-30SLD2	1265087	WASHER, SUPPORT GEAR STUD

KEY	PENN	PUREFISHING	
NO	PART #	PART #	DESCRIPTION
141	141-TRQ15LD2	1265088	CAM FOLLOWER
141B	141B-TRQ15LD2	1265089	SPRING, PRESET KNOB
144	144-TRQ15LD2B	1265090	PRESET KNOB (BLACK)
154	154-TRQ40NLD2	1265092	GEAR STUD SHIM (AS REQUIRED)
154A	154A-TRQ40NLD2	1306668	GEAR STUD SHIM .004 (AS REQUIRED)
154B SEE NOTES PG 3			
161	161-TRQ40NLD2	1265097	LOCATING BUTTON
161A	161A-TRQ15LD2	1265098	PIN, LEVER CLICK
161B	161B-TRQ40NLD2	1265099	STRIKE BUTTON
162 SEE PAGE 3 NOTES			
171	171-30SLD2	1265101	PLUNGER GEAR SHIFT
172	172-12VSB	1265102	SHIFT BUTTON ASSEMBLY (BLACK)
172B	172B-30VS	1184831	SPACER
173	173-12VS	1192384	CATCH, SHIFTER (2 REQUIRED)
173A	173A-12VS	1230664	HOLDER, CATCH
183	183-FTH15XNLD2	1541519	FRAME ASSEMBLY
195	195-40	1184955	GEAR STUD RET. E-RING

Changes / Corrections

19	19-TRQ15LD2	1265004	DRAG CAM (rev 1)
	19-TRQ30LD2	1296247	DRAG CAM (rev 3)
	<i>19-TRQ15LD2 IS THE SAME AS 19-TRQ30LD2 AND 19-TRQ40LD2</i>		
46A	46A-4300	4483585	SCREW, COVER (2 REQUIRED) ERROR on REV0
	46A-FTH15LD2	1507714	SCREW, COVER (2 REQUIRED) REV 3 - ** USE THIS PART! **
162	462-50	4484795	SPRING - Rev 1 Error
	162-TRQ40NLD2	1318280	SPRING - REV 3 - ** USE THIS PART! **

154B THERE ARE TWO OF THESE WITH TWO DIFFERENT THICKNESSES

154B	154B-FTH25NLD2	1309903	BELLEVILLE DISTANCE WASHER THICKER (1 REQUIRED)
			MEASURES: OD X ID X TH (MM): 8.27 X 6.22 X .23
154B	154B-FTH40NLD2	1309904	BELLEVILLE DISTANCE WASHER THINNER (1 REQUIRED)
			MEASURES: OD X ID X TH (MM): 8.27 X 6.22 X .09

CLAMP COMPONENTS

33C	33C-TRQ15XNLD2	1517024	ROD CLAMP KIT
33	33-TRQ	1290729	ROD CLAMP ALUMINUM
34	34-TRQ15XNLD2	1501007	ROD CLAMP SCREW (7/8in) (2 REQUIRED)
149	149-TRQ15	1230616	ROD CLAMP NUT (2 REQUIRED)

MYSTIC REEL PARTS REVISION!

NOTE: Many of www.mysticparts.com schematics include changes that were either made by Penn, or errors found and corrected by our parts dept.
MRP Ver 052423 (based on Penn's Rev 1 7-16-20)