

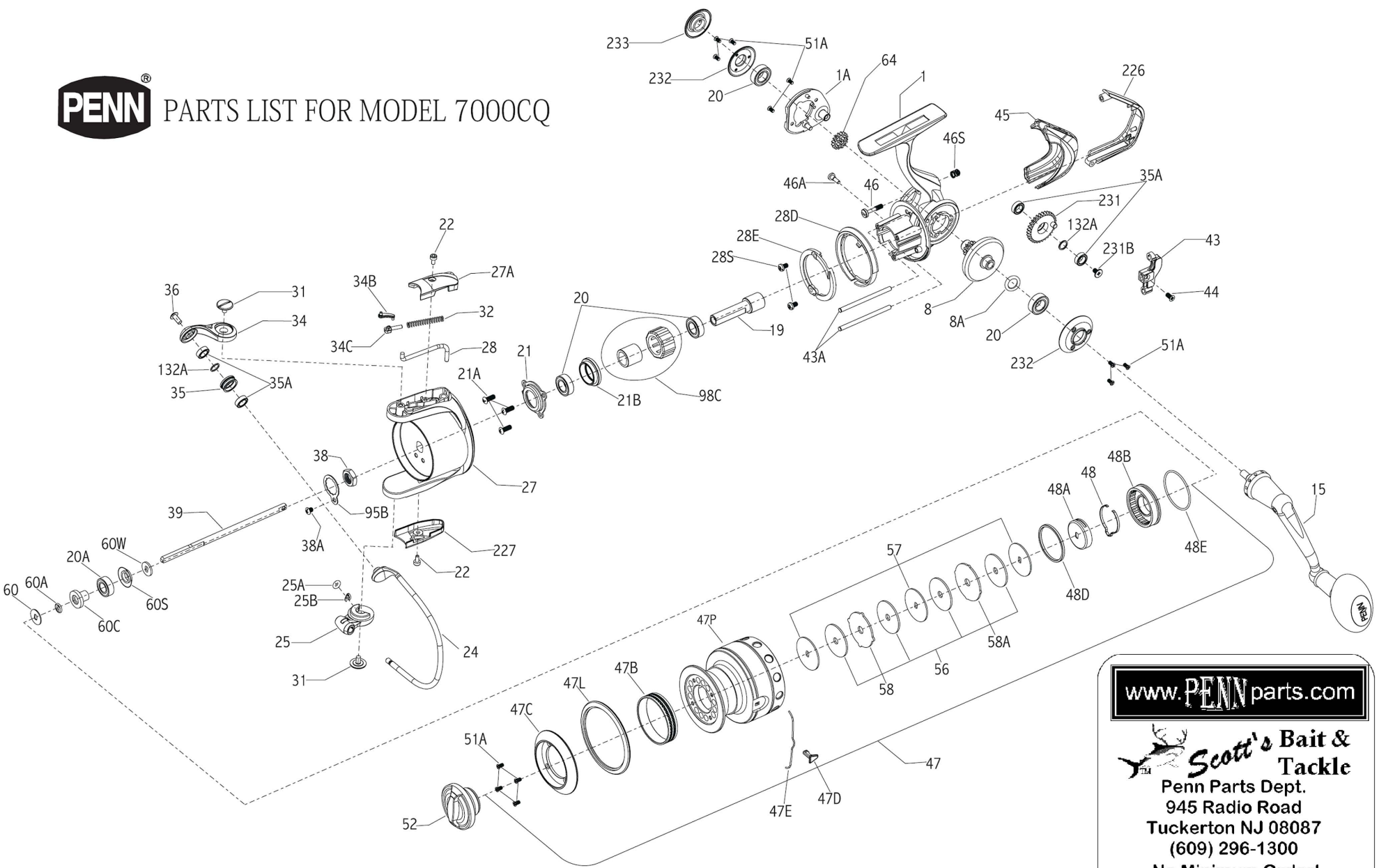

PARTS LIST FOR MODEL 7000CQ



www.PENNparts.com

Scott's Bait & Tackle
Penn Parts Dept.
945 Radio Road
Tuckerton NJ 08087
(609) 296-1300

No Minimum Order!
Plus, Parts in stock
that Penn doesn't
carry anymore.

Penn Reel Parts list for:

Model: 7000CQ (also known as CQR7000) Conquer

KEY	PART	DESCRIPTION	KEY	PART	DESCRIPTION
NO	NO.		NO	NO.	
1	1-7000CQ	HOUSING	46A	46A-7000CQ	SCREW
1A	1A-7000CQ	HOUSING PLATE	46S	46S-2000CQ	SPRING
8	8-7000CQ	MAIN GEAR	47	47-7000CQ	SPOOL ASSEMBLY
8A	8A-7000CQ	SHIM	47P	47P-7000CQ	SPOOL (ONLY)
15	15-7000CQ	HANDLE ASSEMBLY	47B	47B-7000CQ	SPOOL BAND
19	19-7000CQ	PINION	47C	47C-7000CQ	SPOOL LIP COVER
20	20-6500	BALL BEARING (USES 4)	47D	47D-2000CQ	LINE CLIP
20A	20A-5000CQ	BALL BEARING	47E	47E-7000CQ	LINE CLIP SPRING
21	21-760	BEARING RETAINER	47L	47L-7000CQ	SPOOL LIP
21A	21A-2000CQ	SCREW (USES 3)	48	48-7000CQ	SPOOL CLICK
21B	21B-7000CQ	COLLAR	48A	48A-7000CQ	SPOOL CLICK RETAINER
22	22-2000CQ	SCREW (USES 2)	48B	48B-7000CQ	SPOOL CLICK HOUSING
24	24-7000CQ	BAIL WIRE	48D	48D-7000CQ	SPACER RING
25	25-5000CQ	BAIL CAM	48E	48E-7000CQ	O-RING
25A	25A-2000CQ	O-RING	51A	51A-2000CQ	SCREW (12 REQUIRED)
25B	25B-2000CQ	CLIP	52	52-7000CQ	DRAG KNOB ASSEMBLY
27	27-7000CQ	ROTOR	56	56-7000CQ	DRAG WASER HT-100 (4 REQUIRED)
27A	27A-7000CQ	BAIL PIVOT COVER	57	57-7000CQ	KEYED WASHER (3 REQUIRED)
28	28-7000CQ	TRIP LEVER	58	58-7000CQ	EARRED WASHER
28D	28D-7000CQ	FRICITION RING	58A	58A-7000CQ	EARRED WASHER
28E	28E-7000CQ	FRICITION RING COVER	60	60-7000CQ	SPACER WASHER
28S	28S-2000CQ	FRICITION RING SCREW (USES 3)	60A	60A-7000CQ	O-RING
31	31-2000CQ	SCREW (USES 2)	60B	60B-2000CQ	BALL BEARING
32	32-5000CQ	BAIL SPRING	60C	60C-7000CQ	BEARING SLEEVE
34	34-5000CQ	BAIL ARM	60S	60S-7000CQ	SEAL
34B	34B-5000CQ	PIVOT LEVER	60W	60W-7000CQ	SPOOL SHAFT WASHER
34C	34C-2000CQ	PIVOT ARM	64	64-7000CQ	IDLER GEAR
35	35-5000CQ	LINE ROLLER	95B	95B-7000CQ	ROTOR LOCKING PLATE
35A	35A-2000CQ	BALL BEARING (USES 4)	98C	98C-7000CQ	CLUTCH/SLEEVE ASSEMBLY
36	36-2000CQ	SCREW, LINE ROLLER	132A	132A-2000CQ	SPACER (2 REQUIRED)
38	38-7000CQ	ROTOR NUT	226	226-7000CQ	REAR COVER
38A	38A-2000CQ	SCREW, ROTOR LOCKING PLATE	227	227-7000CQ	CAM COVER
39	39-7000CQ	SPOOL SHAFT	231	231-7000CQ	CROSSWIND GEAR
43	43-7000CQ	CROSSWIND BLOCK	231B	231B-2000CQ	CROSSWIND GEAR SCREW
43A	43A-7000CQ	CROSSWIND BLOCK PIN (2 REQUIRED)	232	232-7000CQ	BEARING RETAINER (2 REQUIRED)
44	44-2000CQ	SCREW, CROSSWIND BLOCK	233	233-7000CQ	BEARING COVER
45	45-7000CQ	MAINTENANCE HATCH			
46	46-2000CQ	SCREW			

NOTE: Many of www.pennparts.com schematics include changes that were either made by Penn, or errors found and corrected by our parts dept.
SBT Ver. 020410

It is likely that Penn will only sell the 47-7000CQ spool assembly rather than the 47P bare spool.