

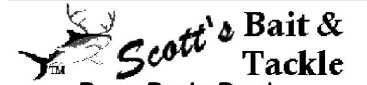

PARTS LIST FOR MODEL CFT2000

www.PENNparts.com



Penn Parts Dept.
945 Radio Road
Tuckerton NJ 08087
(609) 296-1300

No Minimum Order!
Plus, Parts in stock
that Penn doesn't
carry anymore.

SBT Ver. 033014

(Based on Penn's Rev. 1 - 5/13/13)

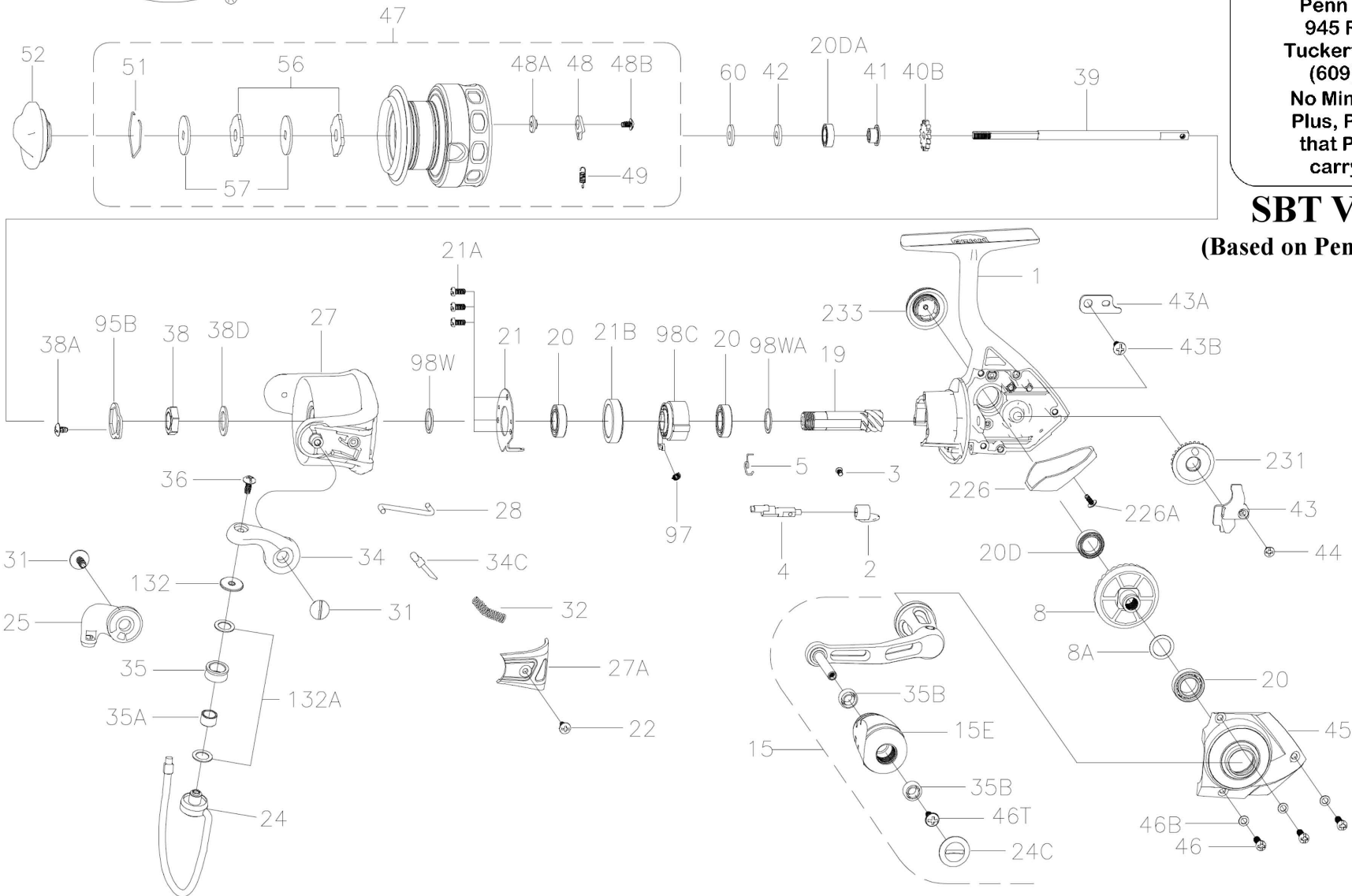

Penn Reel Parts list for Model: CFT2000 Conflict Spinning Series

PUREFISHING PENN PART				PUREFISHING PART			
S NO	NO.	NO.	DESCRIPTION	KEY NO	NO.	NO.	DESCRIPTION
1	1313829	1-CFT2000	HOUSING	39	1313834	39-CFT2000	SPOOL SHAFT
2	1190889	2-2000SG	A/R LEVER (ANTI-REVERSE)	40B	1191778	40B-2000SG	CLICK RATCHET
3	1190922	3-2000SG	A/R LEVER SCREW (ANTI-REVERSE)	41	1211573	41-2000BTL	SPOOL BUSHING
4	1313805	4-CFT2500	A/R SHAFT (ANTI-REVERSE)	42	1249042	42-1000BTL	SPOOL SHAFT WASHER
5	1313806	5-CFT2500	A/R SPRING (ANTI-REVERSE)	43	1313820	43-CFT2500	CROSSWIND BLOCK
8	1308047	8-CFT3000	MAIN GEAR ASSEMBLY	43A	1191818	43A-3000SG	CROSSWIND BLOCK PLATE
8A	1191028	8A-3000SG	MAIN GEAR SHIM	43B	1191826	43B-3000SG	CROSSWIND BLOCK PLATE SCREW
15	1313807	15-CFT2500	HANDLE ASSEMBLY	44	1191843	44-3000SG	CROSSWIND BLOCK SCREW
15E	1316318	15E-CFT2000	HANDLE KNOB	45	1313835	45-CFT2000	HOUSING COVER
19	1313808	19-CFT2500	PINION GEAR	46	1191901	46-3000SG	HOUSING COVER SCREW (3 REQUIRED)
20	1308050	20-CFT3000	BALL BEARING (3 REQUIRED)	46B	1191907	46B-3000SG	HOUSING COVER WASHER (3 REQUIRED)
20D	1211610	20D-5000BTL	HOUSING BALL BEARING	46T	1316411	46T-CFT2000	SCREW
20DA	1211567	20D-2000BTL	SPOOL BALL BEARING	47	1313836	47-CFT2000	SPOOL ASSEMBLY
21	1192629	21-2000SG	BEARING RETAINER	48	1211604	48-3000SG	CLICK TONGUE
21A	1192644	21A-3000SG	BEARING RETAINER SCREW (3 REQUIRED)	48A	1214226	48A-3000SG	CLICK TONGUE WASHER
21B	1192646	21B-2000SG	COLLAR	48B	1211591	48B-3000BTL	SPOOL CLICK SCREW
22	1203978	22-3000PUR	BAIL PIVOT COVER SCREW	49	1211605	49-3000SG	CLICK TONGUE SPRING
24	1313830	24-CFT2000	BAIL WIRE	51	1313823	51-CFT2500	RETAINING SPACER
24C	1316409	24C-CFT2000	HANDLE KNOB CAP	52	1313824	52-CFT2500	DRAG KNOB
25	1313810	25-CFT2500	BAIL HOLDER	56	1313825	56-CFT2500	DRAG WASHER (2 REQUIRED)
27	1313831	27-CFT2000	ROTOR CUP	57	1192041	57-2000SG	KEYED DRAG WASHER (2 REQUIRED)
27A	1313832	27A-CFT2000	BAIL PIVOT COVER	60	1192059	60-2000SG	THRUST WASHER
28	1313833	28-CFT2000	TRIP LEVER	95B	1308081	95B-CFT3000	ROTOR LOCKING PLATE
31	1313814	31-CFT2500	BAIL ARM SCREW (2 REQUIRED)	97	1192189	97-2000SG	CLUTCH SPRING
32	1191583	32-2000SG	BAIL SPRING	98C	1192211	98C-2000SG	CLUTCH/SLEEVE ASSEMBLY
34	1313815	34-CFT2500	BAIL ARM	98W	1192229	98W-3000SG	UPPER CLUTCH WASHER
34C	1313816	34C-CFT2500	PIVOT ARM	98WA	1204004	98W-3000PUR	LOWER CLUTCH WASHER
35	1313817	35-CFT2500	LINE ROLLER	132	1313826	132-CFT2500	ROLLER WASHER
35A	1313818	35A-CFT2500	LINE ROLLER BUSHING	132A	1192301	132A-2000SG	LINE ROLLER WASHER (2 REQUIRED)
35B	1316410	35B-CFT2000	BALL BEARING (2 REQUIRED)	226	1313827	226-CFT2500	REAR COVER
36	1251748	36-1000FRC	BAIL PIVOT COVER SCREW	226A	1192473	226A-3000SG	REAR COVER SCREW
38	1308068	38-CFT3000	ROTOR NUT	231	1313837	231-CFT2000	CROSSWIND GEAR
38A	1203995	38A-3000PUR	ROTOR LOCKING PLATE SCREW	233	1308084	233-CFT3000	BEARING COVER
38D	1308070	38D-CFT3000	ROTOR NUT WASHER				

NOTE: Many of www.pennparts.com schematics include changes that were either made by Penn, or errors found and corrected by our parts dept.
 SBT Ver. 033014 (based on Penn's Rev. 1 - 5/13/13)