

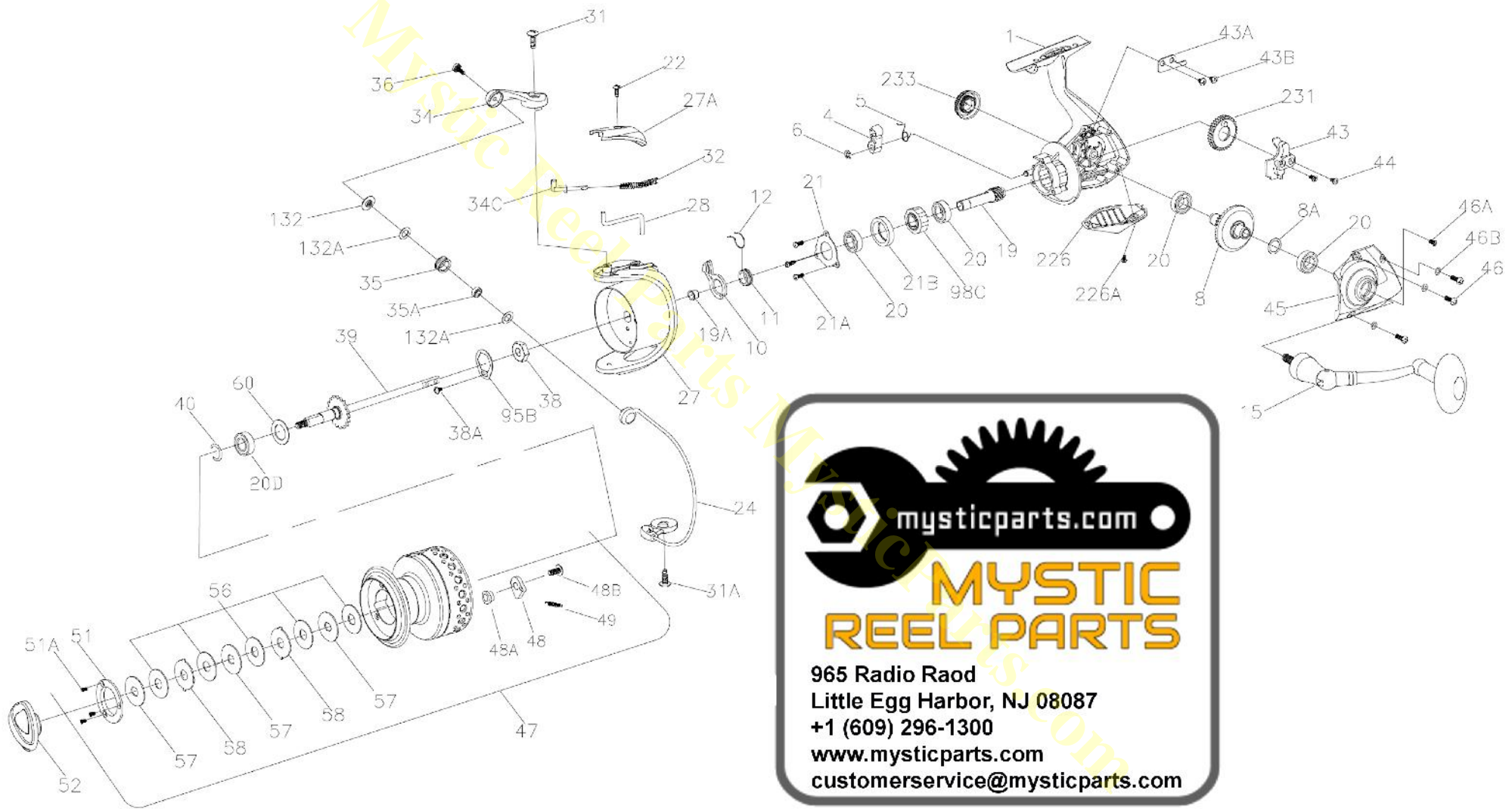

# PARTS LIST FOR MODELS BTL5000



mysticparts.com  
**MYSTIC REEL PARTS**  
965 Radio Raod  
Little Egg Harbor, NJ 08087  
+1 (609) 296-1300  
www.mysticparts.com  
customerservice@mysticparts.com

MRP Ver. 120410  
(based on Penn's Rev.1 - 4/21/10)

Penn Reel Parts list for:

Model: BTL5000 Battle Spinning Series

KEY NO	PureFishing Part #	Penn Part NO.	DESCRIPTION
1	1211647	1-5000BTL	HOUSING
4	1190937	4-5000SG	A/R DOG
5	1190966	5-5000SG	A/R DOG SPRING
6	1190979	6-5000SG	RETAINING CLIP
8	1191019	8-5000SG	MAIN GEAR ASSEMBLY
8A	1204063	8A-7000PUR	MAIN GEAR SHIM
10	1191066	10-5000SG	A/R HOLDER
11	1191085	11-5000SG	BUSHING
12	1191090	12-5000SG	A/R BUSHING SPRING
15	1211609	15-5000BTL	HANDLE ASSEMBLY
19	1191240	19-5000SG	PINION GEAR
19A	1191253	19A-5000SG	PINION BUSHING
20	1192613	20-5000SG	BALL BEARING (4 REQUIRED)
20D	1211610	20D-5000BTL	SPOOL BALL BEARING
21	1192636	21-5000SG	BEARING RETAINER
21A	1192645	21A-5000SG	BEARING RETAINER SCREW (3 REQUIRED)
21B	1192650	21B-5000SG	COLLAR
22	1192661	22-5000SG	BAIL ARM COVER SCREW
27	1211615	27-5000BTL	ROTOR CUP
27A	1191451	27A-5000SG	BAIL PIVOT COVER
28	1191486	28-5000SG	TRIP LEVER
31	1191569	31-5000SG	BAIL ARM SCREW
31A	1191575	31A-5000SG	BAIL CAM SCREW
32	1211617	32-5000BTL	BAIL SPRING
34	1191631	34-5000SG	BAIL ARM
34C	1191652	34C-5000SG	PIVOT ARM
36	1191703	36-5000SG	BAIL STUD SCREW
38	1191729	38-5000SG	ROTOR NUT
38A	1191736	38A-5000SG	ROTOR LOCKING PLATE SCREW
39	1211618	39-5000BTL	SPOOL SHAFT

KEY NO	PureFishing Part #	Penn Part NO.	DESCRIPTION
40	1211620	40-5000BTL	BEARING LOCK SPRING
43	1191805	43-5000SG	CROSSWIND BLOCK
43A	1191820	43A-5000SG	CROSSWIND BLOCK PLATE
43B	1191827	43B-5000SG	CROSSWIND BLOCK PLATE SCREW
44	1191845	44-5000SG	CROSSWIND BLOCK SCREW
45	1211621	45-5000BTL	HOUSING COVER
46	1191903	46-5000SG	HOUSING COVER SCREW (3 REQUIRED)
46A	1191906	46A-3000SG	HOUSING COVER SCREW A
46B	1191908	46B-5000SG	HOUSING COVER WASHER (3 REQUIRED)
47	1211623	47-5000BTL	SPOOL ASSEMBLY
48	1211625	48-5000SG	CLICK TONGUE
48A	1211626	48A-5000SG	CLICK TONGUE WASHER
48B	1211612	48B-5000SG	SPOOL CLICK SCREW
49	1211627	49-5000SG	CLICK TONGUE SPRING
51	1204057	51-5000PUR	RETAINING SPACER
51A	1191986	51A-3000SG	RETAINING SCREW (3 REQUIRED)
52	1211628	52-5000BTL	DRAG KNOB
56	1211630	56-5000BTL	DRAG WASHER HT100 (5 REQUIRED)
57	1192044	57-5000SG	KEYED DRAG WASHER (3 REQUIRED)
58	1192053	58-5000SG	EARRED DRAG WASHER (2 REQUIRED)
60	1211629	60-5000BTL	THRUST WASHER
95B	1192186	95B-5000SG	ROTOR LOCKING PLATE
98C	1192215	98C-5000SG	CLUTCH/SLEEVE ASSEMBLY
132	1192297	132-5000SG	ROLLER WASHER
132A	1192302	132A-3000SG	LINE ROLLER WASHER
226	1192460	226-5000SG	REAR COVER
226A	1192473	226A-3000SG	REAR COVER SCREW
231	1192503	231-5000SG	CROSSWIND GEAR
233	1211631	233-5000BTL	BEARING COVER

**MYSTIC REEL PARTS REVISION!**

NOTE:

Many of [www.mysticparts.com](http://www.mysticparts.com) schematics include changes that were either made by Penn, or errors found and corrected by our parts dept.

MRP Ver. 012613 (based on Penn's 407-5000BTL Rev. 2 - 05-23-11)

**Early BTL Parts**

24	1211613	24-5000BTL	BAIL WIRE
35	1203991	35-3000PUR	LINE ROLLER
35A	1191683	35A-3000SG	LINE ROLLER BEARING (O.D. 5/16")

**Later BTL Parts**

24	1242247	24N-5000BTL	BAIL WIRE
35	1242221	35-5000BTL	LINE ROLLER
35A	1242222	35A-5000BTL	LINE ROLLER BEARING (O.D. 6/16")