

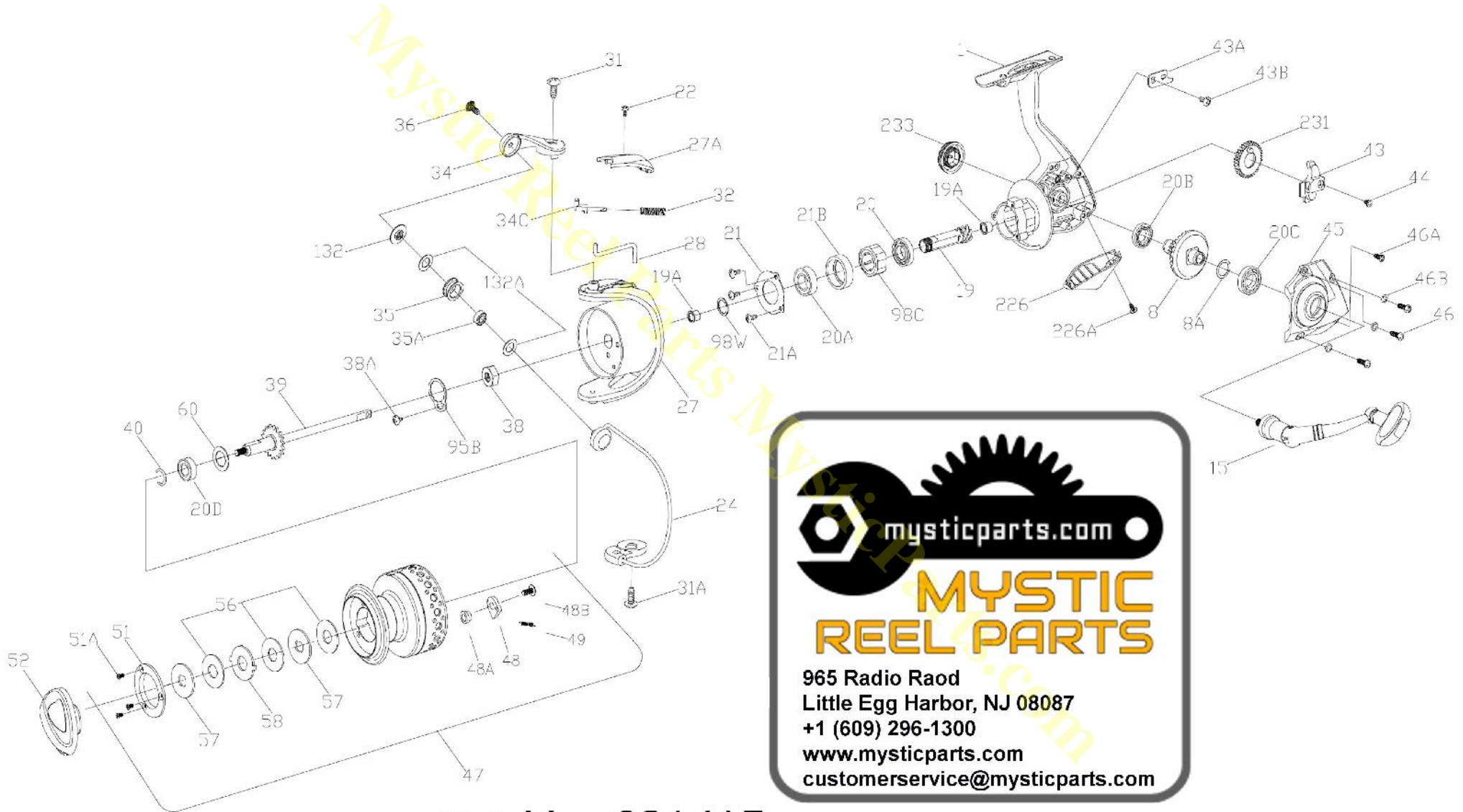

PARTS LIST FOR MODELS BTI 4000



mysticparts.com
MYSTIC REEL PARTS
965 Radio Road
Little Egg Harbor, NJ 08087
+1 (609) 296-1300
www.mysticparts.com
customerservice@mysticparts.com

MRP Ver. 031415
(based on Penn's 407-3000BTL Rev. 3, 6/18/14)

Penn Reel Parts list for:

KEY NO	PUREFISHING NO.	PART NO.	DESCRIPTION
1	1211586	1-4000BTL	HOUSING
8	1191017	8-3000SG	MAIN GEAR ASSEMBLY
8A	1191028	8A-3000SG	MAIN GEAR SHIM
15	1211587	15-3000BTL	HANDLE ASSEMBLY
19	1191231	19-3000SG	PINION GEAR
19A	1191252	19A-3000SG	PINION BUSHING (2 REQUIRED)
20	1192611	20-3000SG	LOWER PINION BALL BEARING
20A	1192617	20A-3000SG	UPPER PINION BALL BEARING
20B	1192619	20B-3000SG	HOUSING BALL BEARING
20C	1192616	20A-2000SG	HOUSING COVER BALL BEARING
20D	1211588	20D-3000BTL	SPOOL BALL BEARING
21	1192631	21-3000SG	BEARING RETAINER
21A	1192644	21A-3000SG	BEARING RETAINER SCREW (3 REQUIRED)
21B	1192648	21B-3000SG	COLLAR
22	1192660	22-3000SG	BAIL ARM COVER SCREW
24	1211593	24-4000BTL	BAIL WIRE
27	1211595	27-4000BTL	ROTOR CUP
27A	1191448	27A-4000SG	BAIL PIVOT COVER
28	1191484	28-4000SG	TRIP LEVER
31	1191567	31-3000SG	BAIL ARM SCREW
31A	1191574	31A-3000SG	BAIL CAM SCREW
32	1191586	32-3000SG	BAIL SPRING
34	1211596	34-3000BTL	BAIL ARM
34C	1191650	34C-3000SG	PIVOT ARM
35	1211572	35-3000BTL	LINE ROLLER
35A	1191682	35A-2000SG	LINE ROLLER BEARING
36	1211597	36-3000BTL	BAIL STUD SCREW
38	1191728	38-3000SG	ROTOR NUT
38A	1191734	38A-3000SG	ROTOR LOCKING PLATE SCREW
39	1211599	39-4000BTL	SPOOL SHAFT

Model: BTL4000 Battle Spinning Series

KEY NO	PUREFISHING NO.	PART NO.	DESCRIPTION
40	1211600	40-3000BTL	BEARING LOCK SPRING
43	1200531	43-4000SG	CROSSWIND BLOCK
43A	1191818	43A-3000SG	CROSSWIND BLOCK PLATE
43B	1191826	43B-3000SG	CROSSWIND BLOCK PLATE SCREW
44	1191843	44-3000SG	CROSSWIND BLOCK SCREW
45	1211601	45-3000BTL	HOUSING COVER
46	1191901	46-3000SG	HOUSING COVER SCREW (3 REQUIRED)
46A	1191906	46A-3000SG	HOUSING COVER SCREW A
46B	1191907	46B-3000SG	HOUSING COVER WASHER (3 REQUIRED)
47	1211603	47-4000BTL	SPOOL ASSEMBLY
48	1211604	48-3000SG	CLICK TONGUE
48A	1214226	48A-3000SG	CLICK TONGUE WASHER
48B	1214189	48B-3000SG	SPOOL CLICK SCREW
49	1211605	49-3000SG	CLICK TONGUE SPRING
51	1204002	51-3000PUR	RETAINING SPACER
51A	1191986	51A-3000SG	RETAINING SCREW (3 REQUIRED)
52	1211606	52-3000BTL	DRAG KNOB
56	1211607	56-3000BTL	DRAG WASHER HT100 (3 REQUIRED)
57	1192043	57-3000SG	KEYED DRAG WASHER (2 REQUIRED)
58	1192052	58-3000SG	EARRED DRAG WASHER
60	1192060	60-3000SG	THRUST WASHER
95B	1192185	95B-3000SG	ROTOR LOCKING PLATE
98C	1192212	98C-3000SG	CLUTCH/SLEEVE ASSEMBLY
98W	1204004	98W-3000PUR	CLUTCH WASHER
132	1211582	132-3000BTL	ROLLER WASHER
132A	1192301	132A-2000SG	LINE ROLLER WASHER
226	1192457	226-3000SG	REAR COVER
226A	1192473	226A-3000SG	REAR COVER SCREW
231	1200522	231-4000SG	CROSSWIND GEAR
233	1211608	233-3000BTL	BEARING COVER

MYSTIC REEL PARTS REVISION!

NOTE:

Many of www.mysticparts.com schematics include changes that were either made by Penn, or errors found and corrected by our parts dept.

MRP Ver. 031415 (based on Penn's 407-3000BTL Rev. 3, 6/18/14)

CHANGES

Key# Part change

20C 20C-3000SG replaced by 20A-2000SG, same bearing