

# SWIVEL BASE ASSEMBLY (for 820)

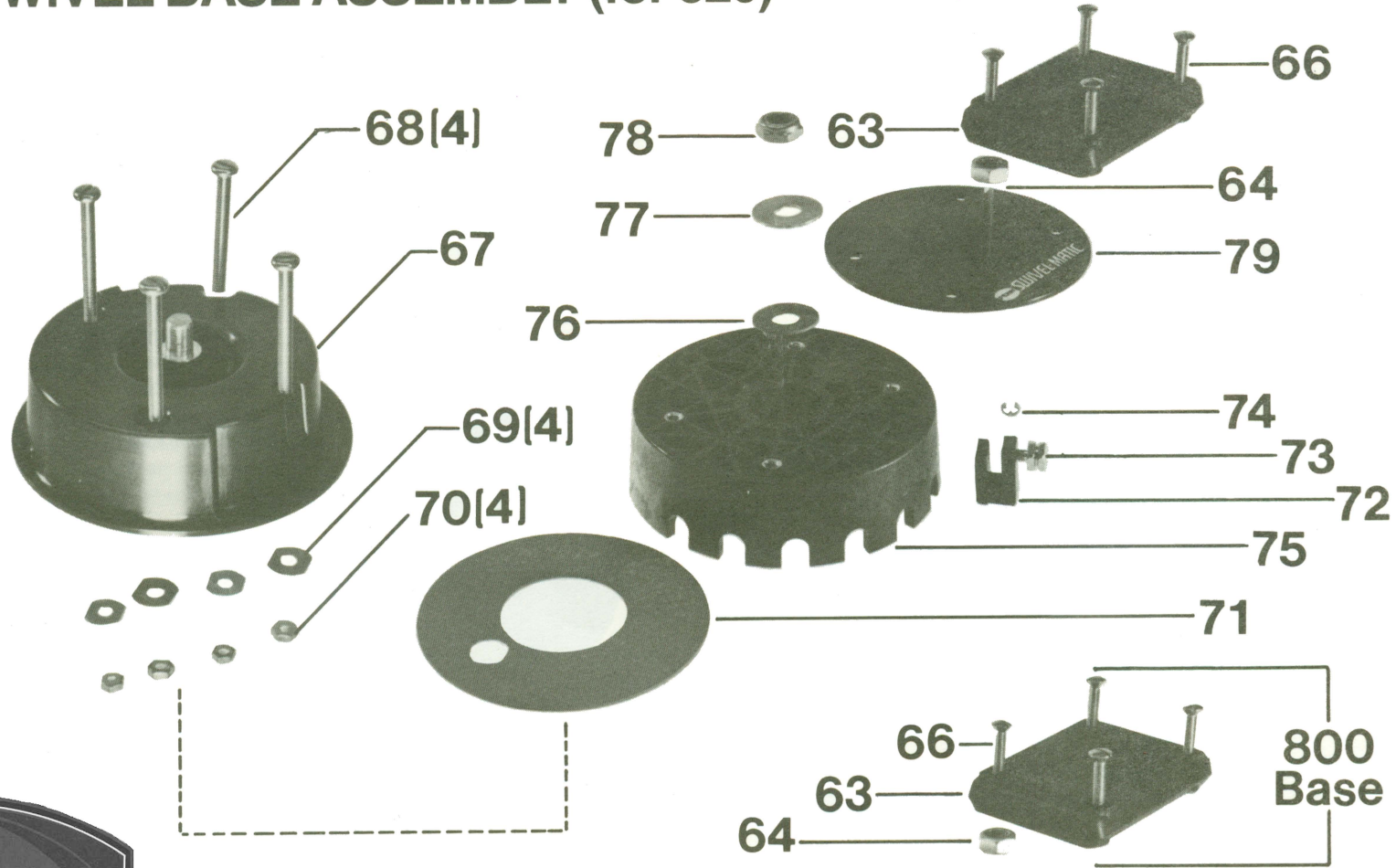

[www.PENNparts.com](http://www.PENNparts.com)

SBT Ver. 041206

**Penn Reel Parts list for:**  
**Model: 820 Swivel Base**

<b>KEY PART</b>		
<b>NO</b>	<b>NO.</b>	<b>DESCRIPTION</b>
63	133-600	BASE PLATE
64	193-600	BASE PLATE NUT
66	209-620	BASE PLATE MOUNTING SCREW (4 REQ.)
67	238-820	SWIVEL BASE BOTTOM
68	250-620	SWIVEL BASE MOUNTING SCREW (4 REQ.)
69	220-600	SWIVEL BASE WASHER (4 REQ.)
70	211-600	SWIVEL BASE NUT (4 REQ.)
71	240-620	SWIVEL BASE WASHER
72	235-820	ADJUSTING CLIP
73	234-820	ADJUSTING CLIP SCREW
74	196-820	CLIP SCREW RETAINING RING
75	237-820	SWIVEL BASE TOP
76	249-620	SWIVEL DRAG WASHER
77	241-620	METAL DRAG WASHER
78	193-662	SWIVEL LOCK NUT
79	239-620	SWIVEL BASE COVER

NOTE: Many of [www.pennparts.com](http://www.pennparts.com) schematics include changes that were either made by Penn, or errors found and corrected by our parts dept.  
SBT Ver. 041206