

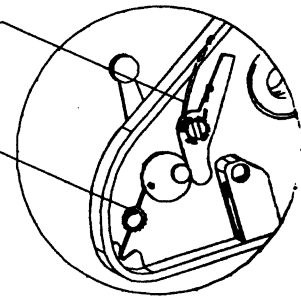

# Penn Schematic 712Z

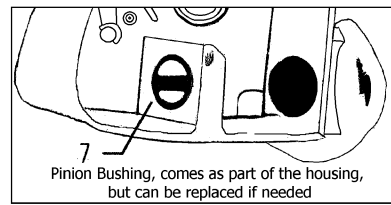

SPRING ASSEMBLY  
DETAIL

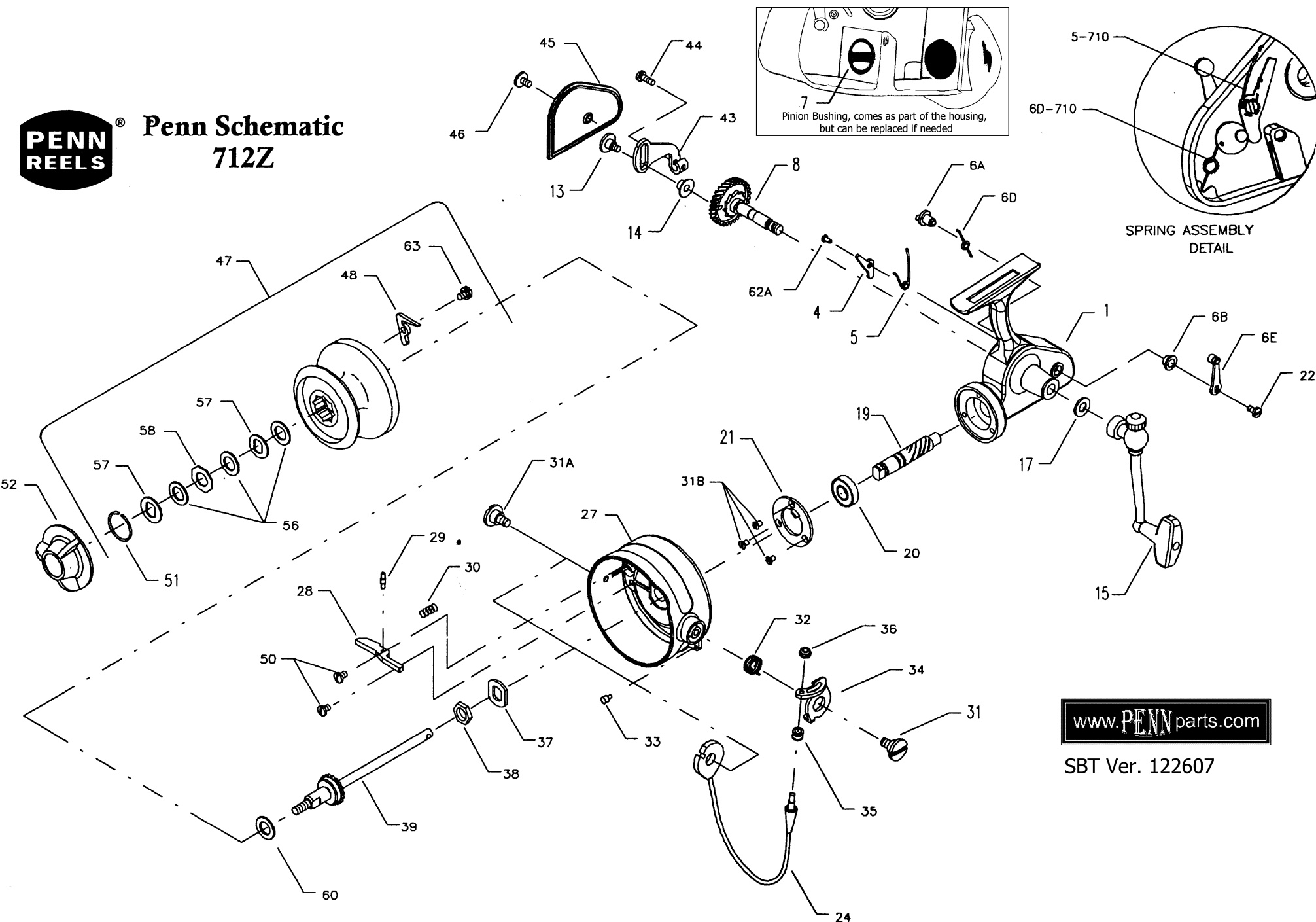

[www.PENNparts.com](http://www.PENNparts.com)

SBT Ver. 122607

## Penn Reel Parts list for:

## Model: 712Z Spinfisher Series

KEY PART			KEY PART		
NO	NO.	DESCRIPTION	NO	NO.	DESCRIPTION
1	1-710	HOUSING W/ BUSHING	32	32-710	BAIL SPRING
4	4-710	DOG	33	33R-712	BAIL ARM BUMPER
5	5-710	DOG SPRING	34	34-712	BAIL ARM
6A	6A-710	ECCENTRIC	35	35-720	LINE ROLLER
6B	6B-700Z	ECCENTRIC LINER	36	36-700	BAIL LOCK NUT
6D	6D-710	ECCENTRIC SPRING	37	37-710	ROTOR CUP WASHER
6E	6E-710	ECCENTRIC LINER	38	38-710	ROTOR CUP NUT
8	8-712	MAIN GEAR W/ RATCHET	39	39-712	SPOOL SHAFT
13	13-710	CROSSWIND SCREW	43	43-710	CROSSWIND ARM
14	14-710	CROSSWIND ROLLER	44	44-710	CROSSWIND SCREW
15	15-710	HANDLE (COMPLETE)	45	45-712	HOUSING PLATE
17	17-710	HANDLE WASHER	46	46-710	HOUSING PLATE SCREW
19	19-712	PINION GEAR	47	47-712	SPOOL (COMPLETE)
20	20-704	PINION BEARING	48	48-720	CLICK TONGUE
21	21-712	BEARING RETAINER	50	50-712	RELEASE ARM SCREW (2 REQ.)
22	22-109	ECCENTRIC SCREW	51	51-710	RETAINING SPRING
24	24-712	BAIL WIRE	52	52-710	DRAG KNOB
27	27-712	ROTOR CUP	56	56-710	DRAG WASHER-HT 100 (3 REQ.)
28	28-712	BAIL RELEASE ARM	57	57-720	METAL KEYED WASHER (2 REQ.)
29	29-712	BAIL RELEASE PIN	58	58-720	METAL WASHER (OCTAGON)
30	30-704	BAIL RELEASE SPRING	60	60-712	REAR DRAG WASHER (TEFLON)
31	31-710	BAIL ARM SCREW	62A	62A-716	DOG SCREW
31A	31A-712	BAIL SCREW	63	63-349	CLICK SCREW
31B	31-19	BEARING COVER SCREW (3 REQ.)			

NOTE: Many of [www.pennparts.com](http://www.pennparts.com) schematics include changes that were either made by Penn, or errors found and corrected by our parts dept.

712Z is the black/gold cosmetics, 712 was the older version that came in green, blue, brown or black w/silver  
All parts are interchangeable

NOTE: On older 712/713 reels, the top washer under the #51 spring used to be dimpled. It was key #57A on the old draw  
57A 57A-712 Washer, Metal, Dimpled This item was replaced by a second smooth 57-730 by Penn