

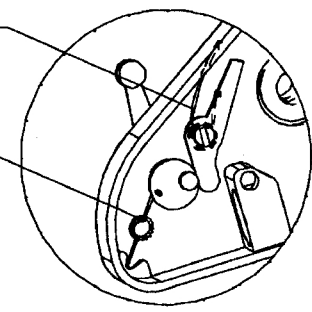

# Penn Schematic 710Z

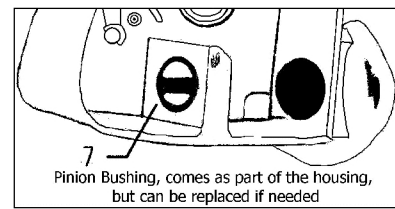

SPRING ASSEMBLY  
DETAIL

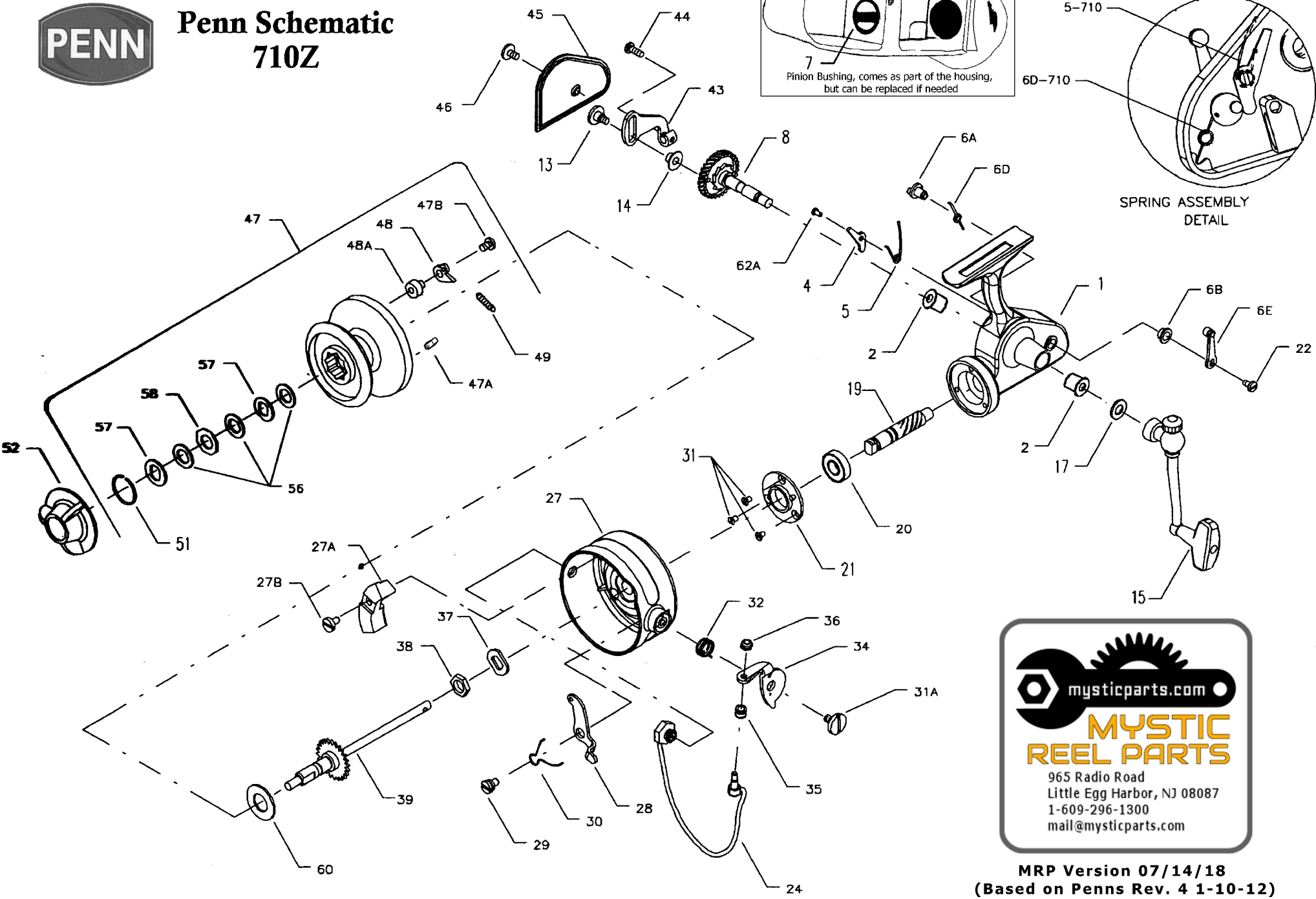

mysticparts.com  
**MYSTIC  
REEL PARTS**  
965 Radio Road  
Little Egg Harbor, NJ 08087  
1-609-296-1300  
mail@mysticparts.com

MRP Version 07/14/18  
(Based on Penns Rev. 4 1-10-12)

**Penn Reel Parts list for:**

**Model: 710Z Spinfisher Series**

KEY PART		PUREFISHING		KEY PART		PUREFISHING	
NO	NO.	NO.	DESCRIPTION	NO	NO.	NO.	DESCRIPTION
1	1-710	1180543	HOUSING W/BUSHING	31A	31-710	1182676	BAIL SCREW
2	2-710	1180650	BUSHING	32	32-710	1182736	BAIL SPRING
4	4-710	1180784	DOG	34	34-710	1182828	BAIL ARM
5	5-710	1180879	DOG SPRING	35	35-720	1182940	LINE ROLLER
6A	6A-710	1180955	ECCENTRIC	36	36-700	1183014	BAIL LOCK NUT
6B	6B-700Z	1180965	ECCENTRIC LINER	37	37-710	1183085	ROTOR CUP WASHER
6D	6D-710	1180977	ECCENTRIC SPRING	38	38-710	1183157	ROTOR CUP NUT
6E	6E-710	1180985	ECCENTRIC LEVER	39	39-710	1183231	SPOOL SHAFT
8	8-710	1181099	MAIN GEAR W/ RATCHET	43	43-710	1183401	CROSSWIND BLOCK
13	13-710	1181354	CROSSWIND SCREW	44	44-710	1183459	CROSSWIND SCREW
14	14-710	1181409	CROSSWIND ROLLER	45	45-710	1183524	HOUSING COVER
15	15-710	1181495	HANDLE (COMPLETE)	46	46-710	1183573	HOUSING COVER SCREW
17	17-710	1181601	HANDLE WASHER	47	47-710	1183660	SPOOL (COMPLETE)
19	19-710	1181709	PINION GEAR	47A	47A-710-S	1183678	CLICK PIN (STAINLESS?)
20	20-704	1181790	PINION BEARING		47A-710-B	1183679	CLICK PIN (BRASS)
21	21-710	1181876	BEARING RETAINER	47B	47B-710	1183685	CLICK SCREW
22	22-109	1181912	ECCENTRIC SCREW	48	48-710	1183711	CLICK TONGUE
24	24-710	1182060	BAIL WIRE	48A	48A-710	1183721	CLICK BUSHING
27	27-710	1182275	ROTOR CUP	49	49-710	1183741	CLICK SPRING
27A	27AN-710	1182335	COUNTERWEIGHT	51	51-710	1183796	RETAINING SPRING
27B	27B-710	1182339	SCREW	52	52-710	1183833	DRAG KNOB
28	28-710	1182407	BAIL RELEASE ARM	56	56-710	1183907	DRAG WASHER-HT 100 (3 REQ)
29	29-710	1182463	BAIL RELEASE SCREW	57	57-710	1183938	METAL KEYED WASHER (2 REQ.)
30	30-710	1182638	BAIL RELEASE SPRING	58	58-710	1183961	METAL WASHER (OCTAGON)
31	31-19	1182654	BEARING COVER SCREW (3 REQ.)	60	60-710	1184004	THRUST WASHER (TEFLON)
				62A	62A-716	1184034	DOG SCREW

**NOTE:** Many of [www.pennparts.com](http://www.pennparts.com) schematics include changes that were either made by Penn, or errors found and corrected by our parts dept.  
MRP Version 07/14/18 (Based on Penns Rev. 4 1-10-12)

710Z is the black/gold cosmetics 710 older versions came in grea, blue, brown or black w/silver  
All parts are interchangeable

NOTE: On older 710/711 reels, the top washer under the #51 spring used to be dimpled. It was key #57A on the old drawing  
57A 57A-710 Washer, Metal, Dimpled This item was replaced by a second smooth 57-710 by Penn

**THE PARTS BELOW HAVE SOME CONFUSION AS PENN CHANGED THE NUMBER ON THE BUSHING TO USE FOR THE PIN**

47A	47A-710-S	1183678	CLICK PIN (STAINLESS?)
	47A-710-B	1183679	CLICK PIN (BRASS)
48A	48A-710	1183721	CLICK BUSHING