

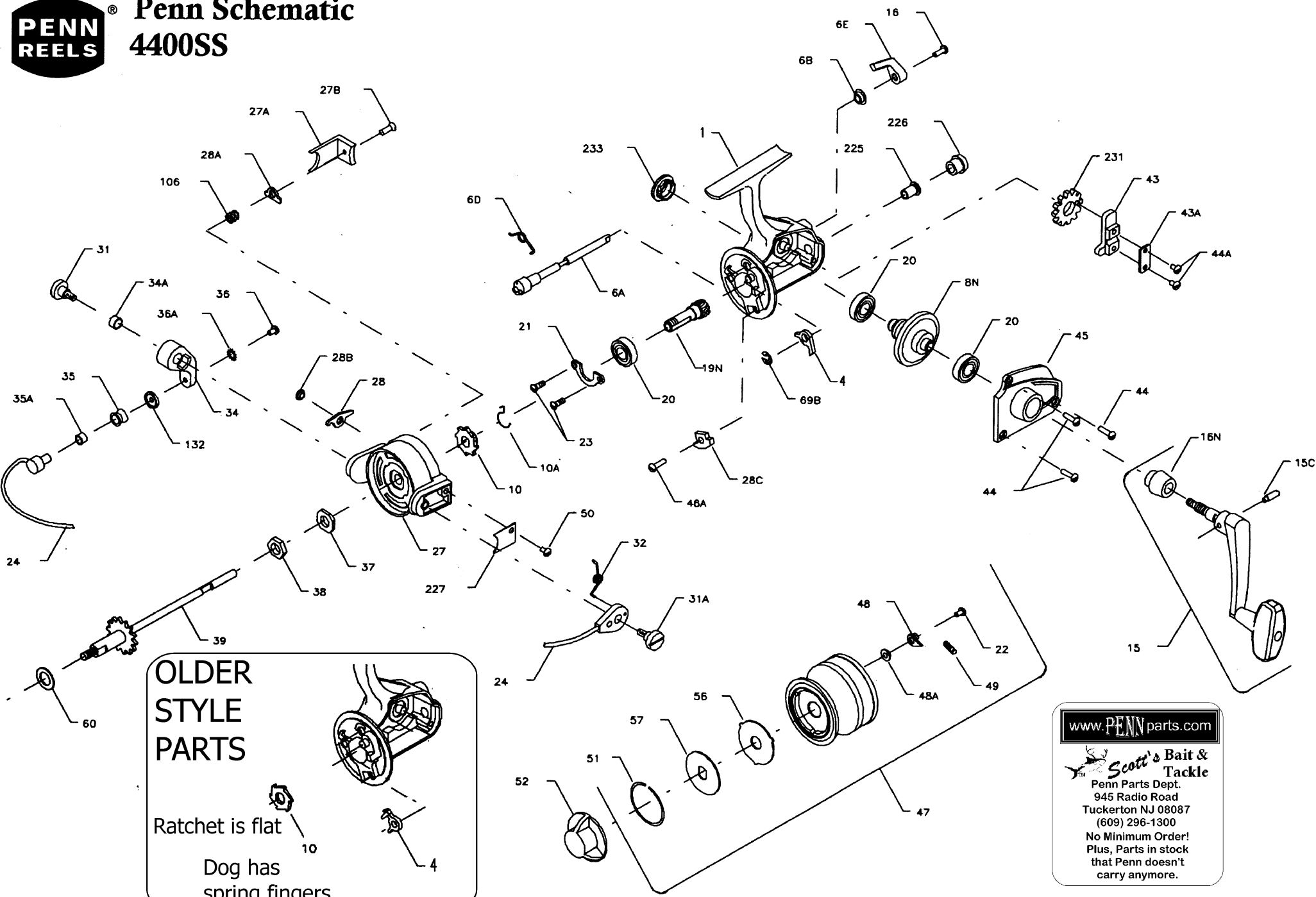

Penn Schematic 4400SS

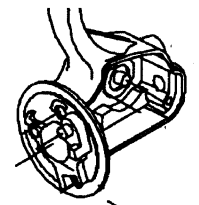

**OLDER
STYLE
PARTS**



Ratchet is flat

Dog has
spring fingers

www.PENNparts.com

Scott's Bait & Tackle
 Penn Parts Dept.
 945 Radio Road
 Tuckerton NJ 08087
 (609) 296-1300
 No Minimum Order!
 Plus, Parts in stock
 that Penn doesn't
 carry anymore.

Penn Reel Parts list for:

Model: 4400SS

KEY PART

NO	NO.	DESCRIPTION
6A	6A-440	ECCENTRIC
6B	6B-750	ECCENTRIC LINER
6D	6D-710	ECCENTRIC SPRING
6E	6E-750	ECCENTRIC LEVER
15	15-4400	HANDLE (COMPLETE)
15C	15C-650	HANDLE PIVOT SCREW
16	16-910	ECCENTRIC SCREW
16N	16-4400	HANDLE COLLAR
19A	19A-550	PINION SPACER
20	20-722	BALL BEARING (3 REQ.)
21	21-450	BEARING COVER
22	22-750	SPOOL CLICK SCREW
23	23-750	BEARING COVER SCREW (2 REG.)
24	24-440	BAIL WIRE
27	27-4400	ROTOR
27A	27A-440	BAIL TRIP COVER
27B	27B-420	ROTOR END SCREW
28	28-440	TRIP LEVER
28A	28A-440	CAM LEVER
28B	28B-440	TRIP LEVER BUSHING
28C	28C-440	TRIP CAM
31	31-550	BAIL ARM SCREW
31A	31A-450	BAIL CAM SCREW
32	32-440	BAIL SPRING
34	34-450	BAIL ARM
34A	34A-550	BAIL ARM BUSHING
35	35-704	LINE ROLLER
35A	35A-704	LINE ROLLER BRUSHING

KEY PART

NO	NO.	DESCRIPTION
36	36-750	BAIL STUD SCREW
36A	36A-750	LOCK WASHER
37	37-450	ROTOR WASHER
38	38-550	ROTOR NUT
39	39-440	SPOOL SHAFT
43	43-440	CROSSWIND BLOCK
43A	43A-4400	CROSSWIND BLOCK PLATE
44	44-704	HOUSING COVER SCREW (3 REQ.)
44A	44-4400	CROSSWIND BLOCK SCREW (2 REQ.)
45	45-4400	HOUSING COVER
46A	46A-704	TRIP CAM SCREW
47	47-4400	SPOOL (COMPLETE)
48	48-450	CLICK TONGUE
48A	48A-750	CLICK TONGUE WASHER
49	49-710	CLICK TONGUE SPRING
50	50-712	BAIL SPRING COVER SCREW
51	51-440	RETAINING RING
52	52-440	DRAG KNOB
56	56-440	DRAG WASHER
57	57-440	METAL KEYED WASHER
60	60-450	THRUST WASHER (TEFLON)
69B	69B-4400	RETAINING RING
106	106-5500	LEVER SPRING
132	132-450	ROLLER WASHER
225	225-440	CROSSWIND SHAFT BUSHING
226	226-450	BUSHING CAP COVER
227	227-440	BAIL SPRING COVER
233	233-440	BEARING COVER

NOTE: Many of www.pennparts.com schematics include changes that were either made by Penn, or errors found and corrected by our parts dept.

SBT Ver. 052512

OLDER SYSTEM

1	1-4400 Housing (original)
4	4-450 Dog (old style with spring fingers)
8N	8N-4400 Main Gear (replaces old 8-4400)
10	10-440 Ratchet (flat)
19N	19N-4400 Pinion (replaces old 19-4400)

INTERMEDIATE SYSTEM

1	1N-4400 Housing (Intermediate)
4	4N-4400 DOG (has slot for the 230N spring to sit in)
10A	230N-4400 Anti-Reverse Spring
8N	8N-4400 Main Gear
10	10N-4400 Ratchet (has groove for spring to wrap around)
19N	19N-4400 Pinion
69B	69B-4400 C-Clip (fits on groove on the dog post)

NEWER SYSTEM

1	1P-4400 Housing (Newer)
4	4N-4400 DOG (has slot for the 230N spring to sit in)
10A	230N-4400 Anti-Reverse Spring
8N	8N-4400 Main Gear
10	10N-4400 Ratchet (has groove for spring to wrap around)
19N	19N-4400 Pinion
69B	69B-4400 C-Clip (fits on groove on the dog post)

231 Discontinued 231-440 crosswind gear is replaced by compatible from SSg series:
 231-440G Crosswind Gear
 43-440G Crosswind Block
MUST CHANGE BOTH PIECES!

Dog type and housing # (stamped inside under main gear) are the best way to identify which version.