

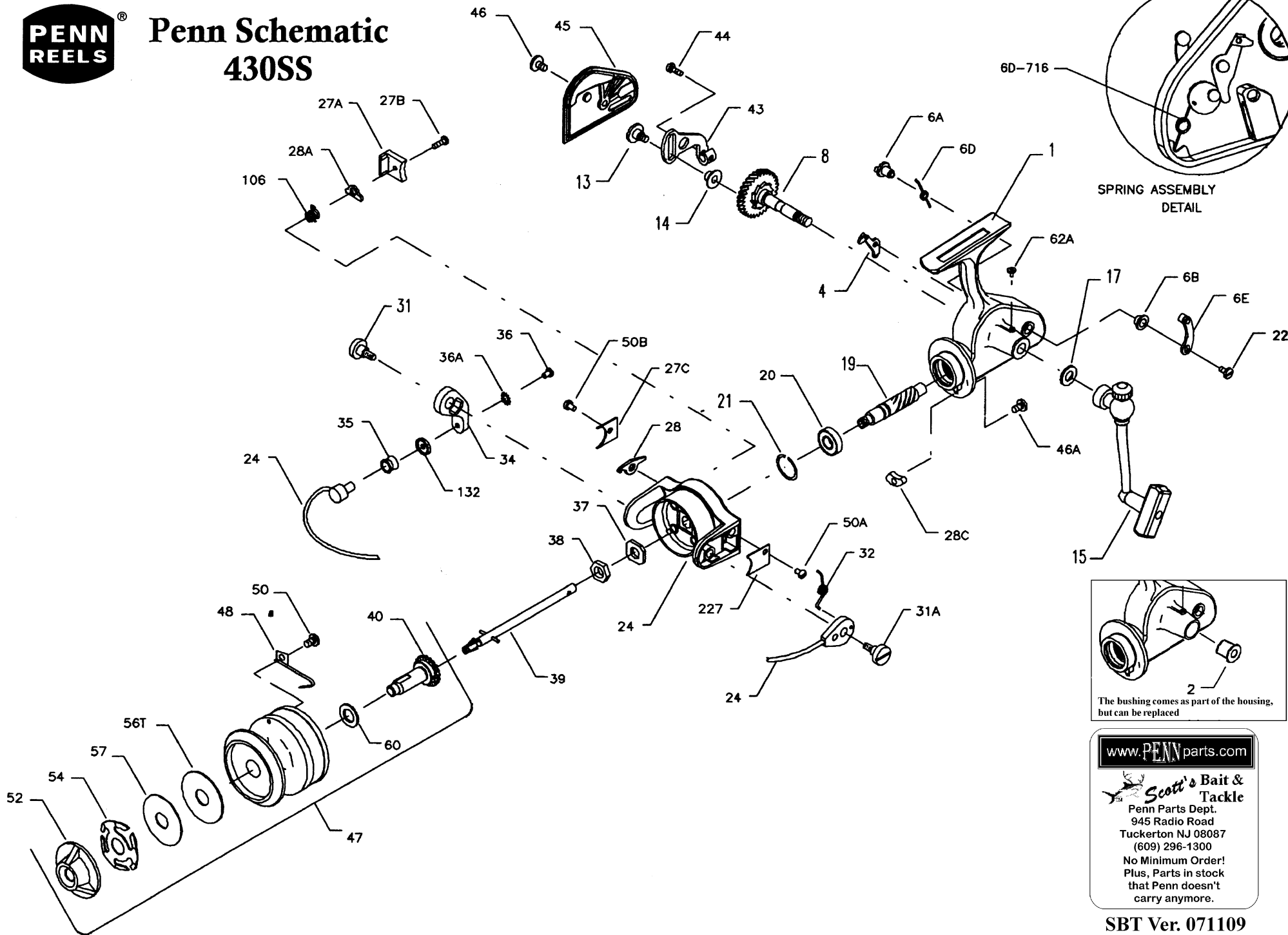

Penn Schematic 430SS



SPRING ASSEMBLY
DETAIL

The bushing comes as part of the housing,
but can be replaced

www.PENNparts.com

Scott's Bait & Tackle
Penn Parts Dept.
945 Radio Road
Tuckerton NJ 08087
(609) 296-1300
No Minimum Order!
Plus, Parts in stock
that Penn doesn't
carry anymore.

Penn Reel Parts list for:

Model: 430SS

KEY PART			KEY PART		
NO	NO.	DESCRIPTION	NO	NO.	DESCRIPTION
1	1-430	HOUSING W/ BUSHING	34	34-420	BAIL ARM
2	2-420	BUSHING F/HOUSING	35	35-420	LINE ROLLER
4	4-420	DOG	36	36-420	BAIL STUD SCREW
6A	6A-716	ECCENTRIC	36A	36A-750	LOCK WASHER
6B	6B-700Z	ECCENTRIC LINER	37	37-420	ROTOR CUP WASHER
6D	6D-716	ECCENTRIC SPRING	38	38-720	ROTOR CUP NUT
6E	6E-716	ECCENTRIC LEVER	39	39-420	SPOOL SHAFT (COMPLETE)
7	7-716	PINION BUSHING	40	40-716	SPOOL SLEEVE (COMPLETE)
8	8-420	MAIN GEAR RATCHET & SHAFT	43	43-716	CROSSWIND ARM
13	13-716	CROSSWIND SCREW	44	44-716	CROSSWIND SHAFT SCREW
14	14-716	CROSSWIND ROLLER	45	45-430	HOUSING COVER
15	15-714Z	HANDLE COMPLETE	46	46-716	HOUSING COVER SCREW
17	17-716	HANDLE WASHER	46A	46A-704	HOUSING PLATE SCREW
19	19-716	PINION GEAR	47	47-430	SPOOL (COMPLETE)
20	20-722	BALL BEARING	48	48-430	CLICK SPRING
21	21-722	BEARING RETAINER	50	50-420	CLICK SPRING SCREW
22	22-109	ECCENTRIC SCREW	50A	50-712	BAIL SPRING COVER SCREW
24	24-4300	BAIL WIRE (old #24-430)	50B	50-716	TRIP LEVER COVER SCREW
27	27-430	ROTOR CUP	52	52-714	DRAG KNOB
27A	27A-420	BAIL TRIP COVER	54	54-714	DRAG SPRING
27 B	27B-420	BAIL TRIP COVER SCREW	56	56T-714	DRAG WASHER (TEFLON)
27C	27C-420	TRIP LEVER COVER	57	57-430	METAL KEYED WASHER
28	28-420	TRIP LEVER	60	60-716	REAR DAG WASHER
28A	28A-450	CAM LEVER	62A	62A-716	OILER SCREW
28C	28C-420	TRIP CAM	106	106-450	LEVER SPRING
31	31-420	BAIL ARM SCREW	132	132-420	ROLLER WASHER
31A	31A-420	CAIL CAM SCREW	227	227-420	BAIL SPRING COVER
32	32-420	BAIL SPRING			

NOTE: Many of www.pennparts.com schematics include changes that were either made by Penn, or errors found and corrected by our parts dept.
 SBT Ver. 071109