

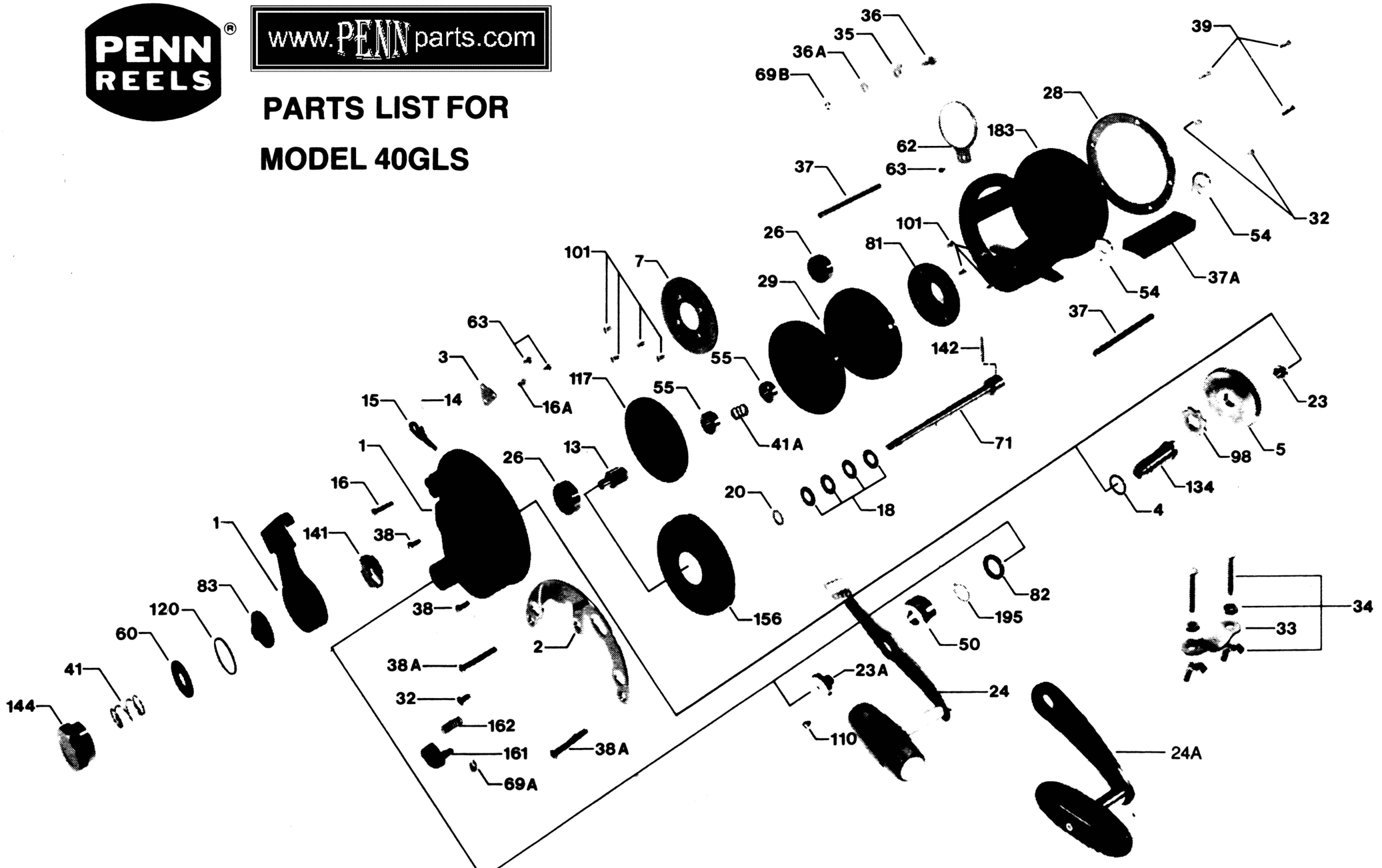

www.PENNparts.com

PARTS LIST FOR MODEL 40GLS



Penn Reel Parts list for:

Model: 40GLS

KEY NO	PART NO.	DESCRIPTION	KEY NO	PART NO.	DESCRIPTION
1	1-40	RIGHT SIDE PLATE	38	38-8	LOWER PLATE SCREW (2)
2	2-40	QUADRANT RING	38A	38-40	R.S. POST SCREW (2)
3	3-40	BRIDGE RATCHET	39	39-9	L.S. POST SCREW (3 REQ.)
4	4-40	GEAR STUD WASHER	41	41-40	PRE-SET KNOB SPRING
5	5-40	MAIN GEAR	41A	41-109	BEARING SPRING
7	7-40	METAL DRAG WASHER	50	50-50S	GEAR STUD COVER
13	13-40	PINION GEAR	54	54-113	HARNES LUG (2 REQ.)
14	14-40	DOG SPRING	55	55-6	R.S. SPOOL BALL BEARING (2)
15	15-40	DOG	60	60-40	LEVER BACKING WASHER
16	16-9	TOP R.S. PLATE SCREW	62	62-40	CLICK SPRING
16A	63-349	BRIDGE SCREW	63	63-500S	CLICK SPRING MTG. SCREW (1)
18	18-40	CLUTCH SPRING (4 REQ.)	63A	63-500S	BRIDGE MTG. SCREW (2)
20	20-40	THRUST WASHER	69A	69B-50	STRIKE BUTTON RETAINING RING
23	23-6	GEAR MOUNTING SCREW	69B	69B-600	CLICK TONGUE RETAINING RING
23A	23-114	HANDLE SCREW	71	71-40	SPOOL SPINDLE ASSEMBLY
24	24-40	COUNTERBALANCED HANDLE	81	81-40	CLICK RATCHET
24A	24-40P	POWER HANDLE	82	82-40	HANDLE SHIM
26	26-40	BALL BEARING (2)	98	98-40	MAIN GEAR RATCHET
28	28-40	L.S. RING	101	101-30	DRIVE PLATE SCREW (4 REQ.)
29	29L-40	SPOOL	101A	101-30	CLICK RATCHET SCREW (4)
32	110-50	R.S. QUADRANT SCREW (1)	110	110-60	HANDLE LOCK SCREW
32A	32-17	LEFT SIDE RING SCREW (2)	117	117-40	DRIVE PLATE ASSEMBLY
33	33-200	ROD CLAMP	134	134-40	GEAR STUD
33R	33R-200	RINGED ROD CLAMP	142	142-40	SPINDLE FOLLOWER PIN
34	34C-200	ROD CLAMP SCREW W/NUTS	144	144-40	PRE-SET KNOB
35	35-40	CLICK TONGUE	156	156-40	DRAG COVER
36	36N-209	CLICK BUTTON	161	161-40	STRIKE BUTTON
36A	36A-40	CLICK TONGUE WASHER	162	162-50	STRIKE BUTTON SPRING
37	37-40	FRAME POST (2 REQ.)	183	183-40	FRAME W/STAND
37A	37A-40	TOP SPACER BAR	195	195-40	GEAR STUD RETAINING RING

NOTE: Many of www.pennparts.com schematics include changes that were either made by Penn, or errors found and corrected by our parts dept.

Last update 2/24/05

DRAG LEVER ASSEMBLY CHANGE

KEY

NO	NEW DESIGN PART NUMBERS #:	Old#
21	21-245 DRAG LEVER ASSEMBLY	21-40
83	83-245 PRE-SET COLLAR	83-40
141	141-245 LEVER CAM FOLLOWER	141-40
120	120-245 O'RING (not used with original cam lever#)	