

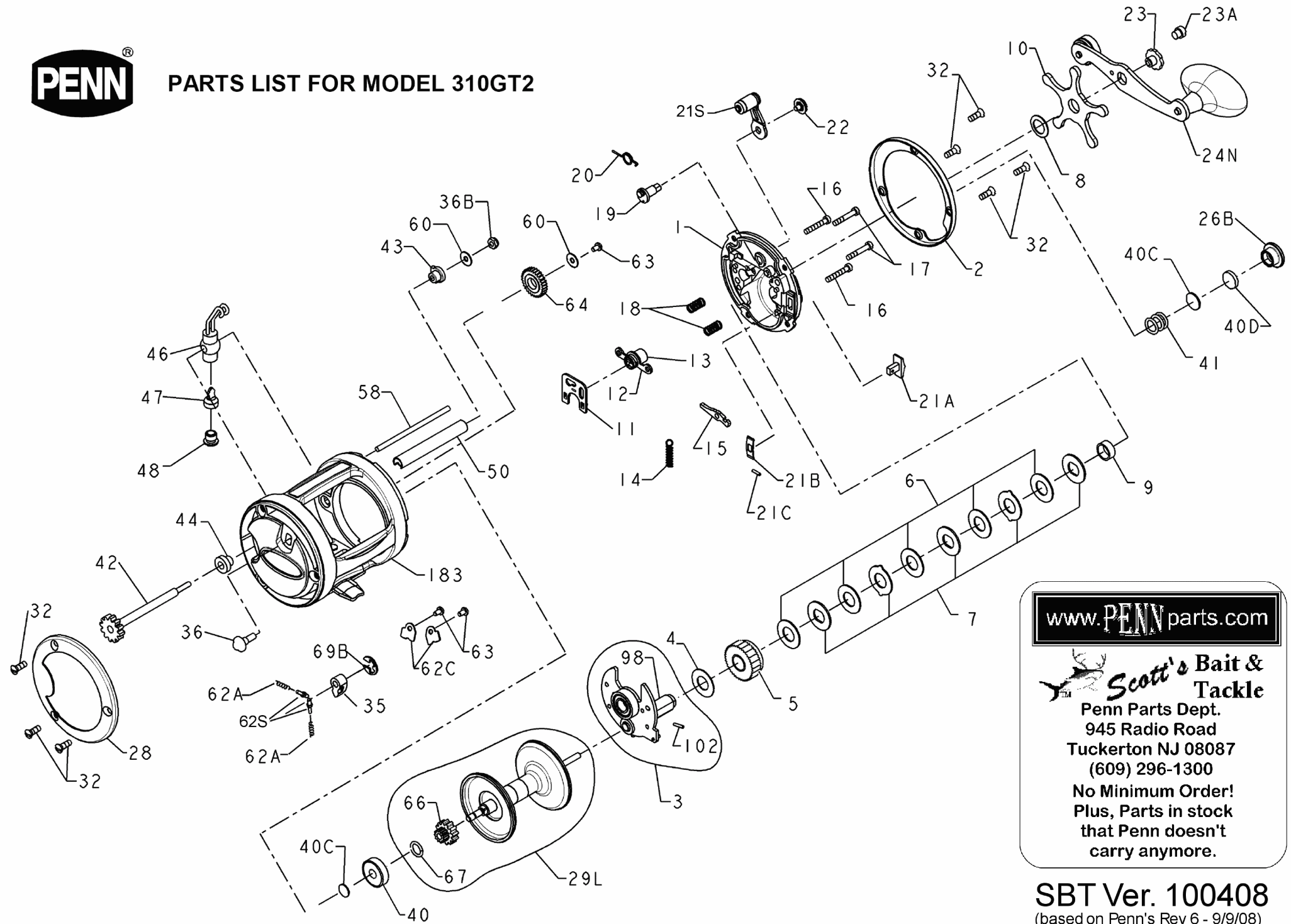

PARTS LIST FOR MODEL 310GT2



www.PENNparts.com

Scott's Bait & Tackle
Penn Parts Dept.
945 Radio Road
Tuckerton NJ 08087
(609) 296-1300

No Minimum Order!
Plus, Parts in stock
that Penn doesn't
carry anymore.

SBT Ver. 100408
(based on Penn's Rev 6 - 9/9/08)

Penn Reel Parts list for:

Model: 310GT2

KEY PART			KEY PART		
NO	NO.	DESCRIPTION	NO	NO.	DESCRIPTION
1	1-310GT2	RIGHT SIDE PLATE	28	28-310GT2	LEFT SIDE RING
2	2-310	RIGHT SIDE RING	29L	29L-310GT2	SPOOL
3	3B-310	BRIDGE ASSEMBLY	32	32-310GT2	SIDE PLATE SCREW (7 REQUIRED)
4	4-155	FIBER WASHER	35	35-310GT2	CLICK TONGUE
5	5-310	MAIN GEAR	36	36-310	CLICK BUTTON
6	6-60	FRICTION DRAG WASHER (5 REQUIRED)	36B	36-700	WORM SHAFT NUT
7	7c-310	METAL DRAG WASHER (SET OF 5)	40	40-320	LEFT SIDE BEARING
8	8-60	TENSION SPRING	40C	40C-320	METAL THRUST WASHER (LEFT/RIGHT)
9	9-310	SPACING SLEEVE	40D	40D-320	RUBBER THRUST WASHER
10	10-505	STAR DRAG	41	41-330	RIGHT SIDE THRUST SPRING
11	11-310	ECCENTRIC JACK	42	42-310	WORM ASSEMBLY
12	12-9	PINION YOKE	43	43-330	RIGHT SIDE WORM BEARING
13	13-310	PINION GEAR	44	44-330	LEFT SIDE WORM BUSHING
14	14-10	DOG SPRING	46	46-310	LINE GUIDE CARRIAGE
15	15-310	DOG	47	47-975	PAWL
16	16-310	LOWER BRIDGE SCREW (2 REQUIRED)	48	48-330N	PAWL COVER SCREW
17	17-310	UPPER BRIDGE SCREW (2 REQUIRED)	50	50T-310	WORM SHEILD
18	18-9	CLUTCH SPRING (2 REQUIRED)	58	58-310	LINE GUIDE POST
19	19-310GT2	ECCENTRIC CAM	60	60-320	IDLE GEAR WASHER
20	20-109	ECCENTRIC SPRING	62A	62A-310	CLICK SPRING (2 REQUIRED)
21S	21S-310	ECCENTRIC LEVER	62C	62C-321LH	CLICK SPRING COVER (2 REQUIRED)
21A	21A-310	DIRECT DRIVE BUTTON	62S	62S-310GT2	CLICK PIN (2 REQUIRED)
21B	21B-310	DIRECT DRIVE BUTTON SPRING	63	63-500S	SCREW, CLICK SPRING AND IDLER GEAR
21C	21C-310	DIRECT DRIVE BUTTON PIN	64	64-310GT2	IDLE GEAR
22	22-310GT2	ECCENTRIC SCREW	66	66-310	SPOOL GEAR
23	23-60	HANDLE ASSEMBLY SCREW	67	67-9	LOCK SPRING
23A	110-60	HANDLE LOCK SCREW	69B	69B-600	RETAINING RING
24	24N-310	HANDLE ASSEMBLY	98	98-310	GEAR SLEEVE
26B	26B-320	SPOOL TENSION CONTROL CAP	183	183-310GT2	FRAME ASSEMBLY

NOTE: Many of www.pennparts.com schematics include changes that were either made by Penn, or errors found and corrected by our parts dept.

SBT Ver. 100408 (Penn's REV 6, 9/9/08)