

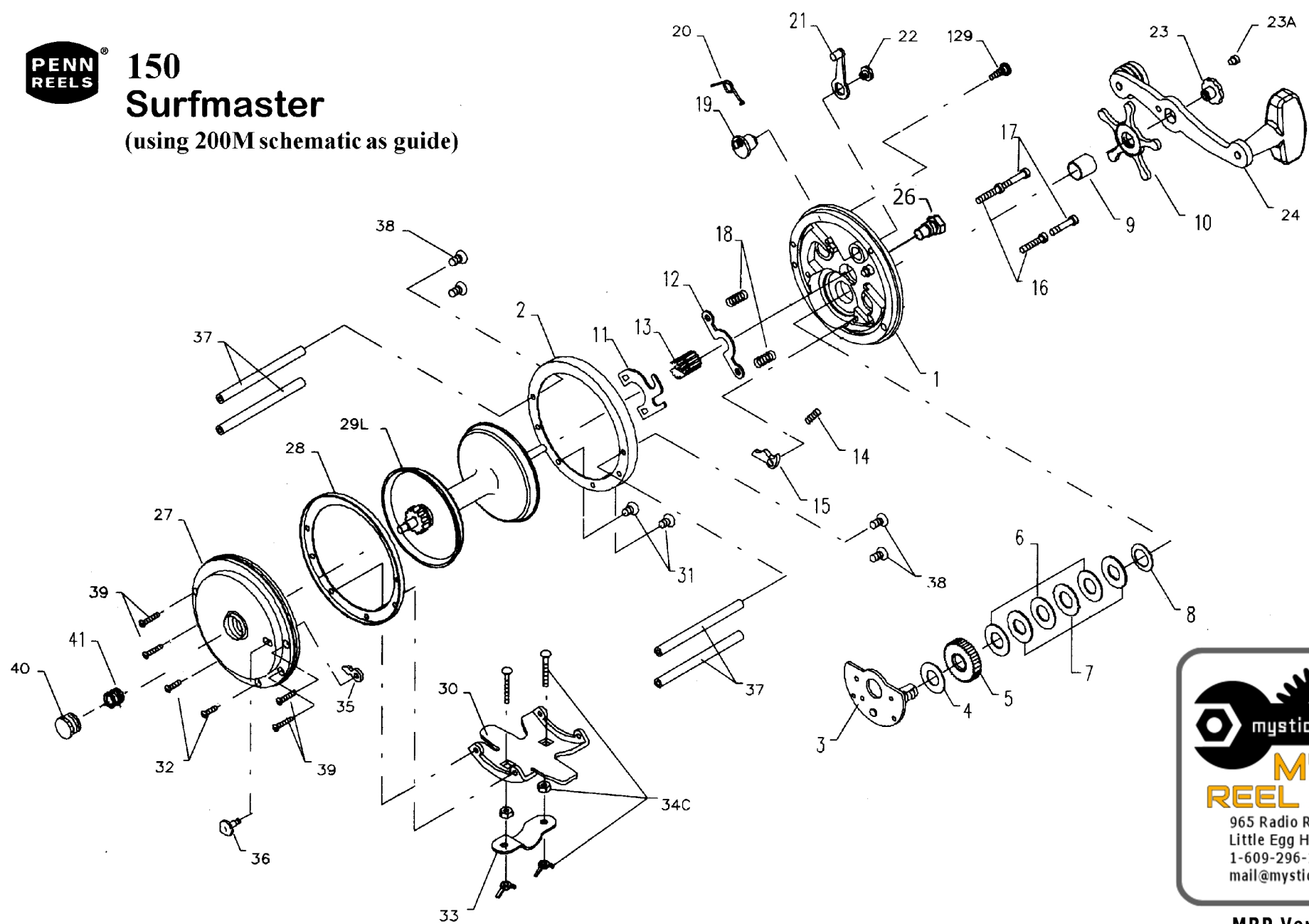

150 Surfmaster

(using 200M schematic as guide)



mysticparts.com
**MYSTIC
REEL PARTS**
965 Radio Road
Little Egg Harbor, NJ 08087
1-609-296-1300
mail@mysticparts.com

MRP Ver. 060318

Penn Reel Parts list for:

Model: 150

Surfmaster

KEY NO	PART NO.	DESCRIPTION	KEY NO	PART NO.	DESCRIPTION
2	2-200	INNER R.S. RING	22	22-99	ECCENTRIC SCREW
3	3-200	BRIDGE W/ SLEEVE	23	23-60	HANDLE SCREW
4	4-155	FIBER WASHER	23A	110-60	HANDLE LOCK SCREW
5	5-60	MAIN GEAR	24	24-155	COMPLETE HANDLE
6	6-60	DRAG WASHER	26	26-155	R.S. BEARING
7	7C-60	METAL DISC SET	28	2-155	INNER L.S. RING
8	8-60	TENSION SPRING	29	29L-150	ALUMINUM SPOOL
9	9-60490	SPACING SLEEVE	29M	29M-150	METAL SPOOL
10	10-60	STAR DRAG	30	30-66	STAND
11	11-200	ECCENTRIC JACK	31	31-19	R.S. STAND SCREW
12	12-155	PINION YOKE	32	32-16CH	L.S. STAND SCREW
13	13-200	PINION	33	33-200	ROD CLAMP
14	14-155	DOG SPRING	34C	34C-200	CLAMP SCREW w/hex and wing nut
15	15-200	DOG	35	35-155	CLICK TONGUE
16	16-60CH	LOWER BRIDGE SCREW	37	37-160	POST FRAME
17	17-70CH	UPPER BRIDGE SCREW	38	38-7	R.S. POST SCREW
18	18-60	CLUTCH SPRING	39	39-5	L.S. POST SCREW
19	19-200	ECCENTRIC	40	40-60	L.S. BEARING
20	20-155	ECCENTRIC SPRING	41	41-60	SPRING
21	21-200	ECCENTRIC LEVER			

NOTE: Many of www.pennparts.com schematics include changes that were either made by Penn, or errors found and corrected by our parts dept.

MRP Ver. 060318 (revision notes below for differences in plates)

Design change plates:

<u>1990's +</u>			<u>1960's</u>		
1	1N-150	R.S. PLATE no oiler	1	1-150	R.S. PLATE with oiler port
27	27-200	L.S. PLATE w/riveted clickspring	27	27-200	older plate was thicker? USED DIFF BUTTON
36	36-155CH	CLICK BUTTON SHORTER	36	36-60CH	CLICK BUTTON LONGER
		BUTTON (neck measures: 5.08 mm or .200 in)			BUTTON (neck measures: 6.35 mm or .248 in)

Installation Notes for Peen style click buttons:

Use a dremel drill to remove the old click button.

Peen new button into place.